

BRIDGEWAY TO FERRY LANDING IMPROVEMENTS



ROYSTON HANAMOTO ALLEY & ABEY

R H A A

LANDSCAPE ARCHITECTS & PLANNERS
225 Mill Avenue Mill Valley, CA 94041 415.383.7500
323 Green Street, #202 San Francisco, CA 94102 415.381.1900

CSW ST2

CSW/Stuber-Stroeh Engineering Group, Inc.
45 Leveroni Court
Novato, CA 94949
tel: 415.883.9850
fax: 415.883.9835

Civil & Structural Engineers
Surveying & Mapping
Environmental Planning
Land Planning
Construction Management
Landscape Architecture
© 2010



Rev	Date	Issues and Revisions
	12-10-09	Check Set
	12-17-09	Check Set
	01-15-10	Bid Documents

- Design Development
- Progress
- Bidding
- Permit
- Construction
- OTHER

Sheet Title:

EROSION AND SEDIMENTATION CONTROL PLAN

Plot Date: January 15, 2010
Drawn by:
Checked by:
Job Number: 3.1607.00
Sheet Number:

BID DOCUMENTS
NOT FOR CONSTRUCTION

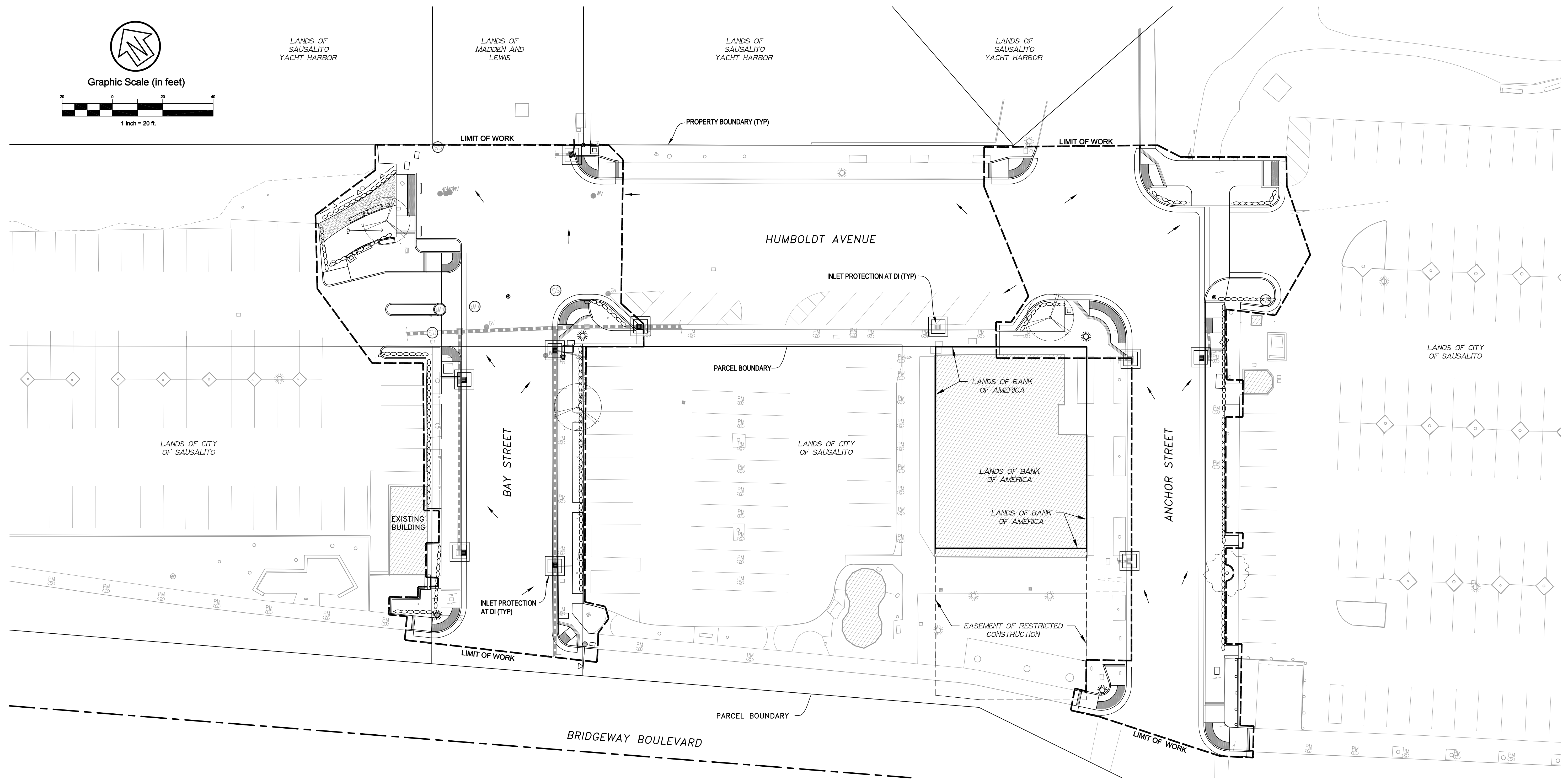

EROSION CONTROL LEGEND

- | | | | |
|--|-------------------------------------|--|------------------------|
| | SWALE OR DITCH | | ROCK DIKE OR FILTER |
| | FLOW LINE | | TIRE WASH PIT |
| | DIRECTION OF FLOW OR SLOPE | | VEHICLE FUEL STORAGE |
| | EXISTING DIRECTION OF FLOW OR SLOPE | | NON HAZARDOUS STORAGE |
| | EARTH BERM | | DELIVERY AREA |
| | BANK CUT FOR FOUNDATION | | CONCRETE WASHDOWN AREA |
| | HYDRO-MULCHING | | |
| | STRAW & TACKIFIER | | |
| | PERMANENT 3-STEP HYDROSEED | | |
| | EROSION CONTROL BLANKETS | | |
| | UNDISTURBED AREA | | |
| | AREA TO BE GRADED | | |
| | BASE ROCK | | |
| | CONSTRUCTION ENTRANCE | | |
| | FIBER ROLLS | | |
| | CONSTRUCTION FENCING | | |
| | STRAW BALE DIKE | | |
| | SAND/GRAVEL BAG BARRIER | | |
| | STORM DRAIN INLET PROTECTION | | |

POLLUTION CONTROL NOTES

- Export of material is anticipated.
- All streets will be rough graded in accordance with the grading plans prepared by CSW/ST2. Future finish grading shall direct all storm water runoff to the streets or inlets shown on this plan and ultimately to the City-Maintained storm drain system. All storm water from this site is intended to be directed to the city storm drains.
- If significant sediment or other visual symptoms of impurities are noticed in the storm water, contact the Civil Engineer immediately.
- Contractor is responsible for inspection and restoration of all aspects of this plan. Sediment on sidewalks and gutters shall be removed by shovel or broom and placed in stockpiles.
- Catch basin tops shall be stamped to read, "No dumping - Flows to Bay".
- All employees, contractors, and subcontractors are responsible for conforming to the elements shown on this plan or related documents. Any contractor planning to do work on-site shall be responsible for obtaining and reviewing all erosion and sediment control information from owner prior to start of work and educating all of their employees or subcontractors as to the contents of this erosion and sediment control.
- The contractor is responsible for obtaining all permits and filing all plans with related agencies associated with their work. This shall include, but not be limited to, permits for storage of hazardous materials, business plans, permits for storage of flammable liquids, grading permits, or other plans or permits required by the City of Sausalito or other agencies. All property owners, contractors, or subcontractors working on-site are individually responsible for obtaining and submitting any business plans or permits required by city, state or local agencies.
- Contractor may relocate storage, delivery, or wash-out areas, to suit their operations. Relocated location to be shown on plans maintained at jobsite. Contact Civil Engineer for any plan revisions. Plan revisions shall be submitted to City if requested. Contractor to maintain secondary containment as necessary to prohibit pollution and toxic materials from entering storm drain.
- After completion of the curb, gutter, and paving, silt fences shall be modified to burlap sacks filled with 3/4" drain rock or other accepted BMP positioned surrounding each catch basin.

EROSION CONTROL NOTES

- No vehicles shall be allowed to track or spread soil from the construction areas onto existing paved public streets. Any vehicle operating within the project area and off the paved street shall cross a construction entrance as shown herein. The entrance may be modified by the contractor to facilitate his operations.
- The erosion and sediment control measures will be operable during the rainy season, October 1st to April 15th. No grading will occur between October 1st and April 15th, unless authorized by the Director of Public Works.
- Changes to this storm water pollution prevention plan to meet field conditions will be made only with the approval of, or at the direction of the City of Sausalito. Changes made to suit field conditions shall be brought to the immediate attention of the Civil Engineer and the City Engineer.
- During the rainy season, all paved areas will be kept clear of earth material and debris. The site will be maintained so that a minimum of sediment-laden runoff enters the storm drain system. These plans shall remain in effect until the improvements are accepted by the city, and all slopes are stabilized from erosion.
- Straw and tackifier will be applied by October 1st to all disturbed areas. All exposed slopes adjacent to public rights of way shall also receive straw and tackifier. Straw and tackifier to be applied per manufacturer's specifications and shall be applied at a rate of 2 tons per acre minimum.
- Rough graded ditches shall be lined with erosion control blankets and then hydroseeded.
- After installation of concrete in ditches, install one sacked rock filter dam at inlet until slopes are stabilized from erosion.
- Prior to start of any construction or demolition, install inlet protection measures.
- This plan assumes the completion of grading and storm drain facilities. If facilities are not completed, contact the Civil Engineer for plan revisions.
- All banks and all graded areas shall be hydroseeded to control erosion by October 1st.

URBAN RUNOFF POLLUTION NOTES

- Stabilize all denuded areas and maintain erosion control measures continuously between October 1 and April 1.
- Remove spoils promptly and avoid stockpiling of fill materials when rain is forecast. If rain threatens, stock-piled soils and other materials shall be tarped, at the request of the City Engineer.
- Store, handle and dispose of construction materials and wastes so as to prevent their entry to the storm drain system. Contractor must not allow concrete, washwaters, slurries, paint or other materials to enter catch basins or to enter site runoff.
- Use filtration or other measures to remove sediment from dewatering effluent.
- No cleaning, fueling or maintaining vehicles on site shall be permitted in any manner that allows deleterious materials to enter catch basins or to enter site runoff.
- Use of pesticides and/or fertilizers shall be applied and controlled to prevent pollution runoff.
- In the event grading operations are suspended by weather conditions and if the storm drain system is incomplete, install additional rock filters and other facilities as directed by City and Engineer.
- Contractor to relocate concrete washdown, vehicle storage delivery, and non hazardous waste areas as necessary to facilitate their operation and promote pollution control.
- Hydromulch & tackifier may be eliminated within building foot print if construction is imminent.

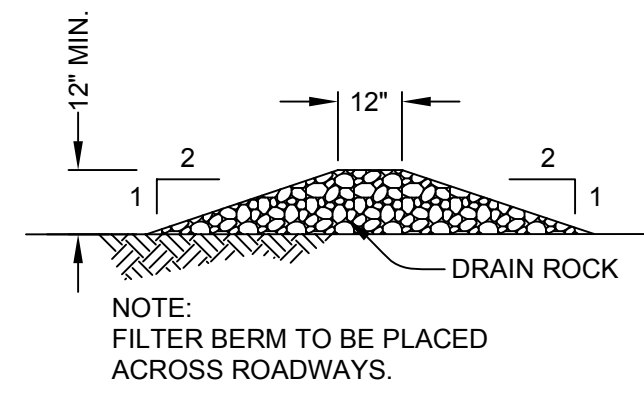

1 TYPICAL ROCK FILTER
SCALE: NTS

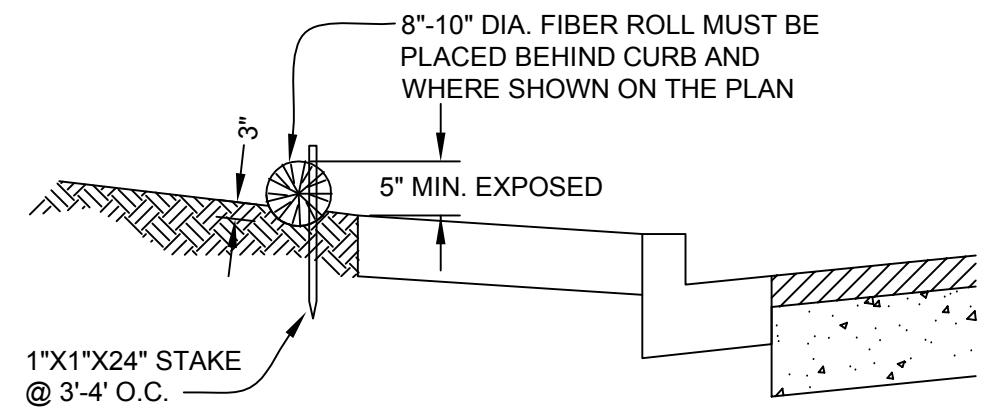

2 FIBER ROLL INSTALLATION DETAILS
SCALE: NTS

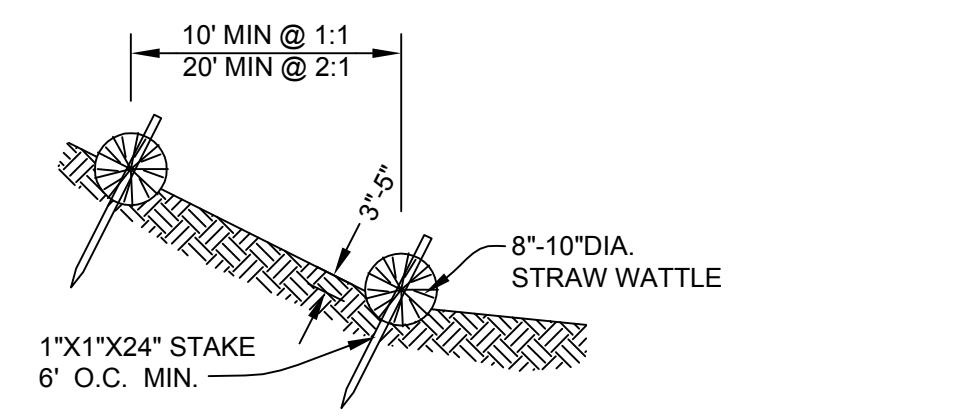
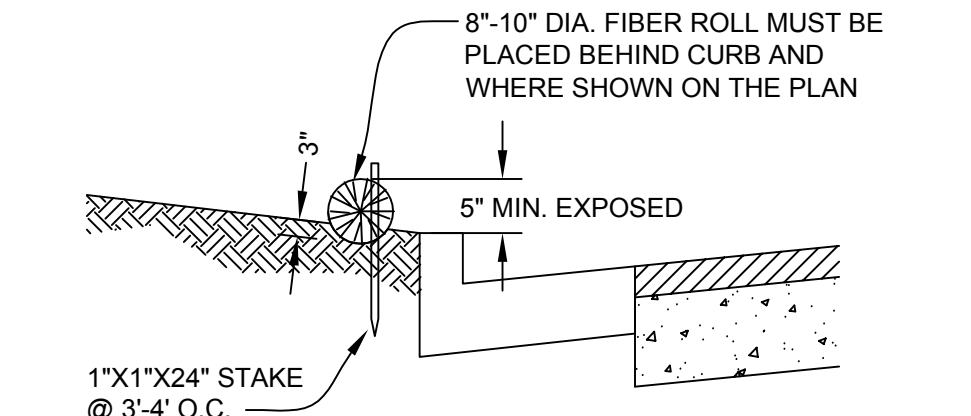

5 GRAVEL BAG FILTER IN TRAFFIC AREAS
SCALE: NTS

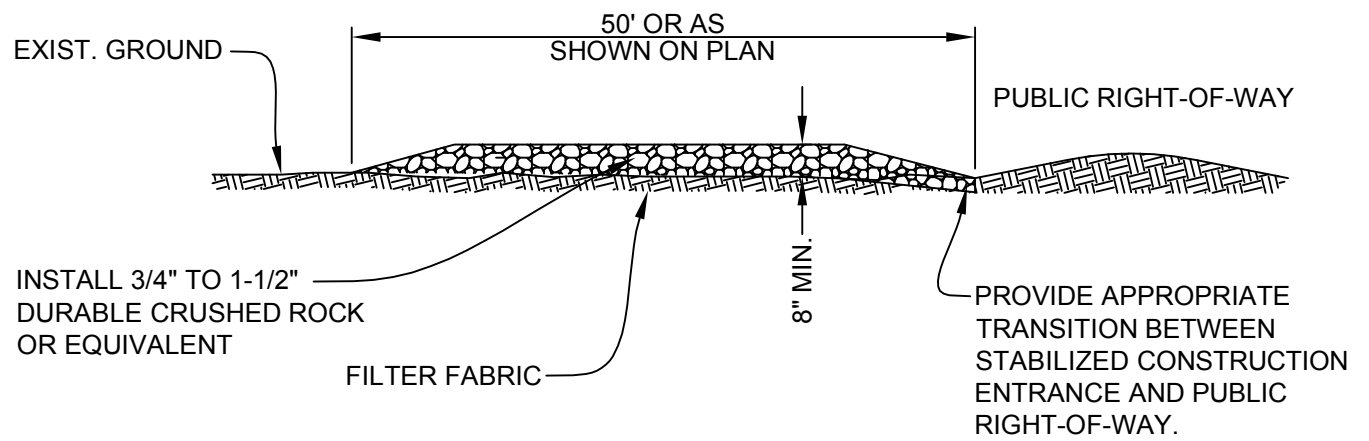

3 TEMPORARY STABILIZED CONSTRUCTION ENTRANCE
SCALE: NTS

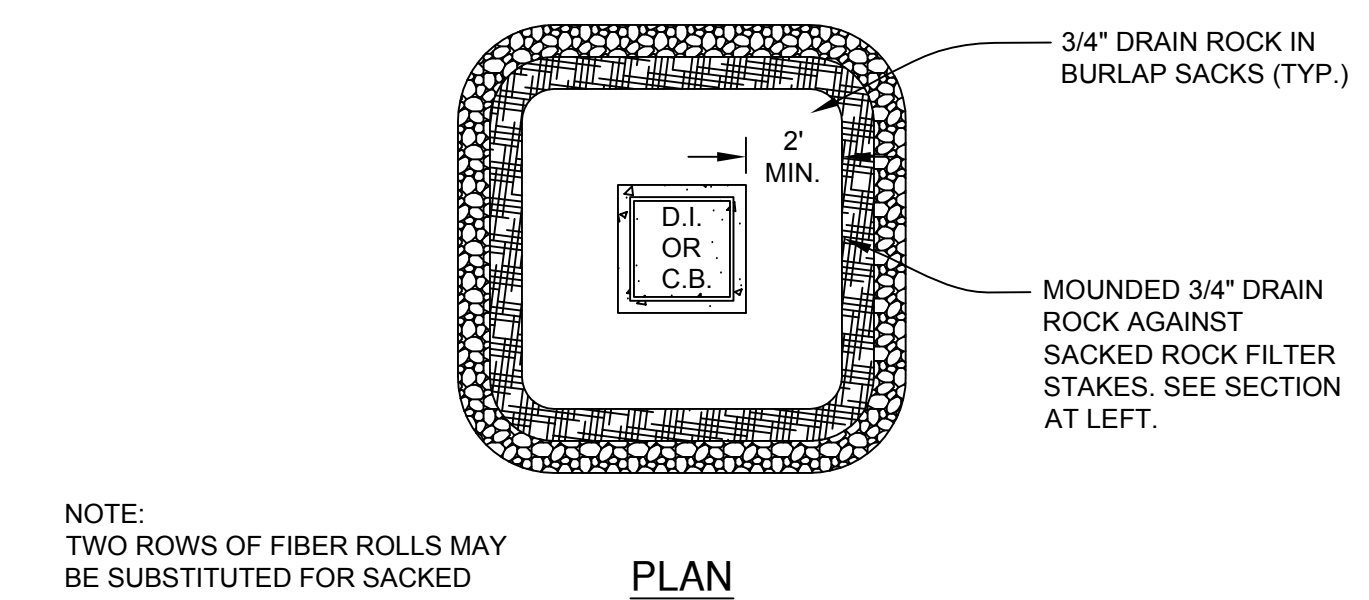

4 SILT FENCE DETAIL
SCALE: NTS

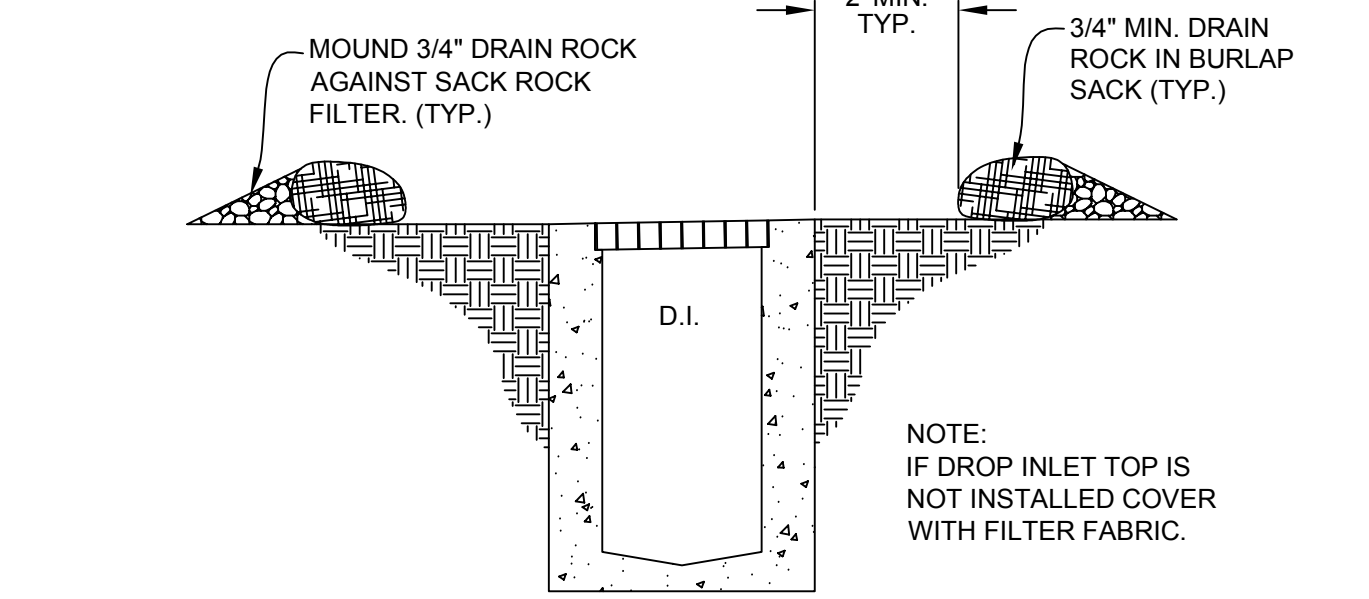

6 GRAVEL BAG FILTER IN TRAFFIC AREAS
SCALE: NTS

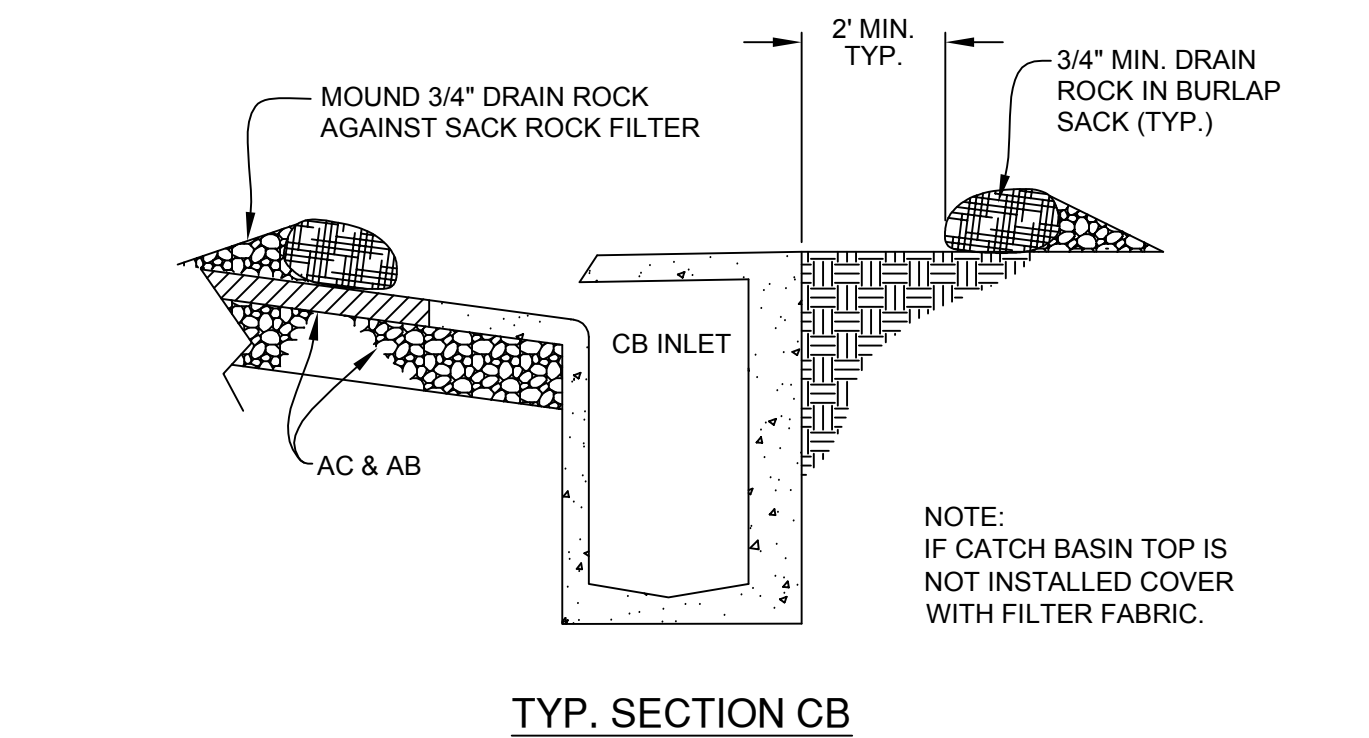

7 VEHICLE AND EQUIPMENT SERVICE AND FUELING AREA
SCALE: NTS

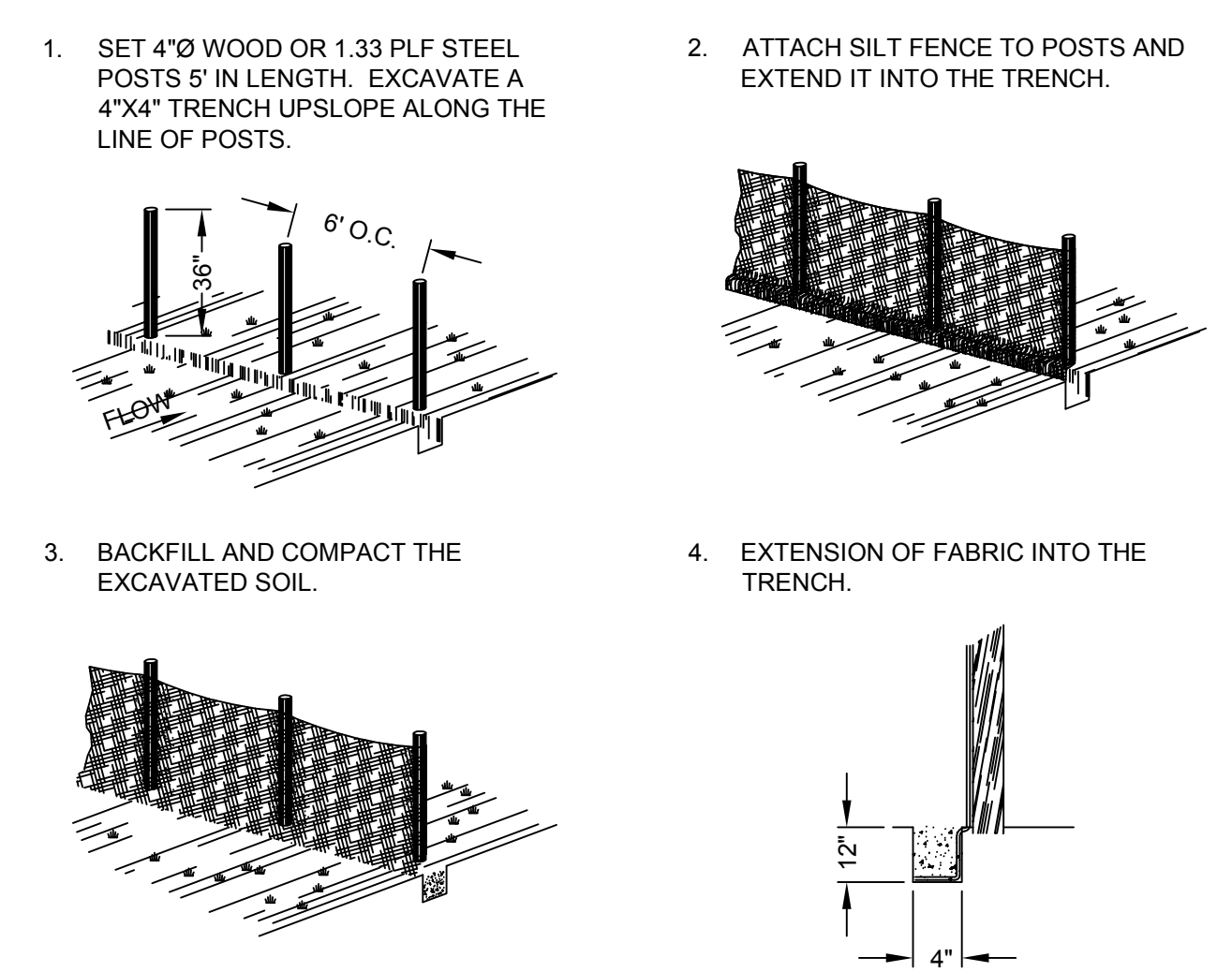

8 INLET PROTECTION DETAIL
SCALE: NTS

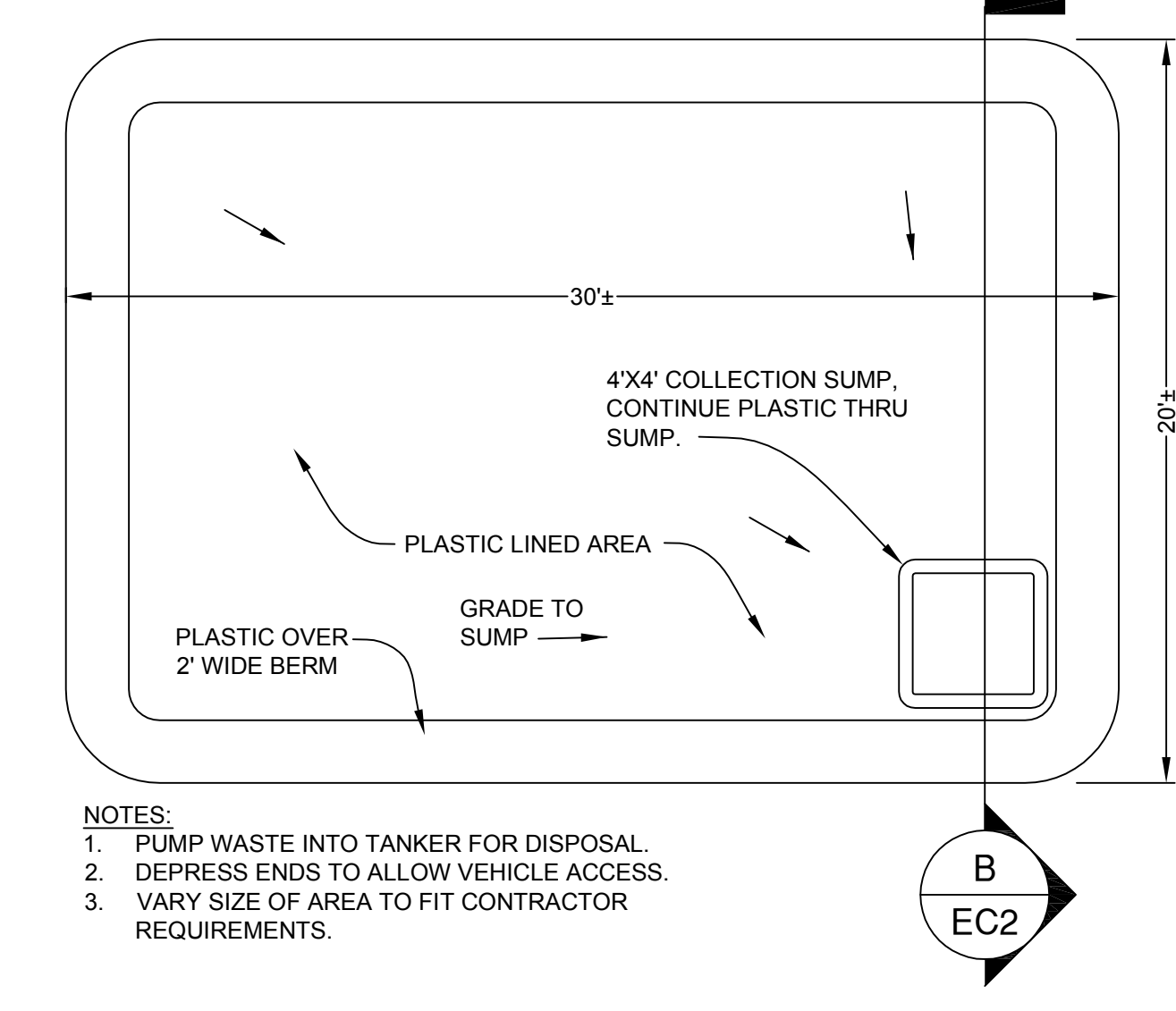
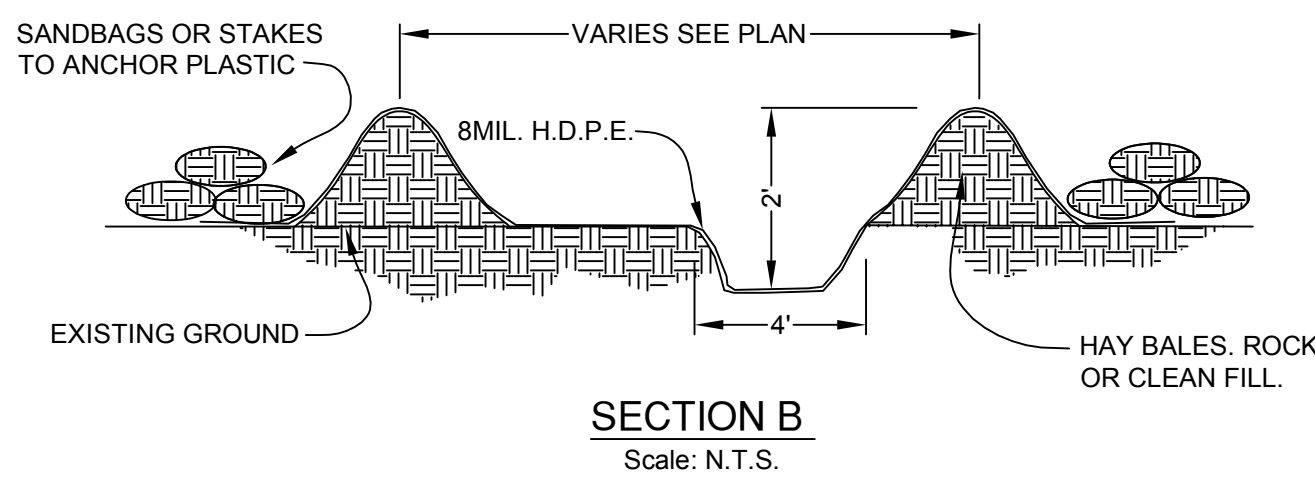

7 VEHICLE AND EQUIPMENT SERVICE AND FUELING AREA
SCALE: NTS

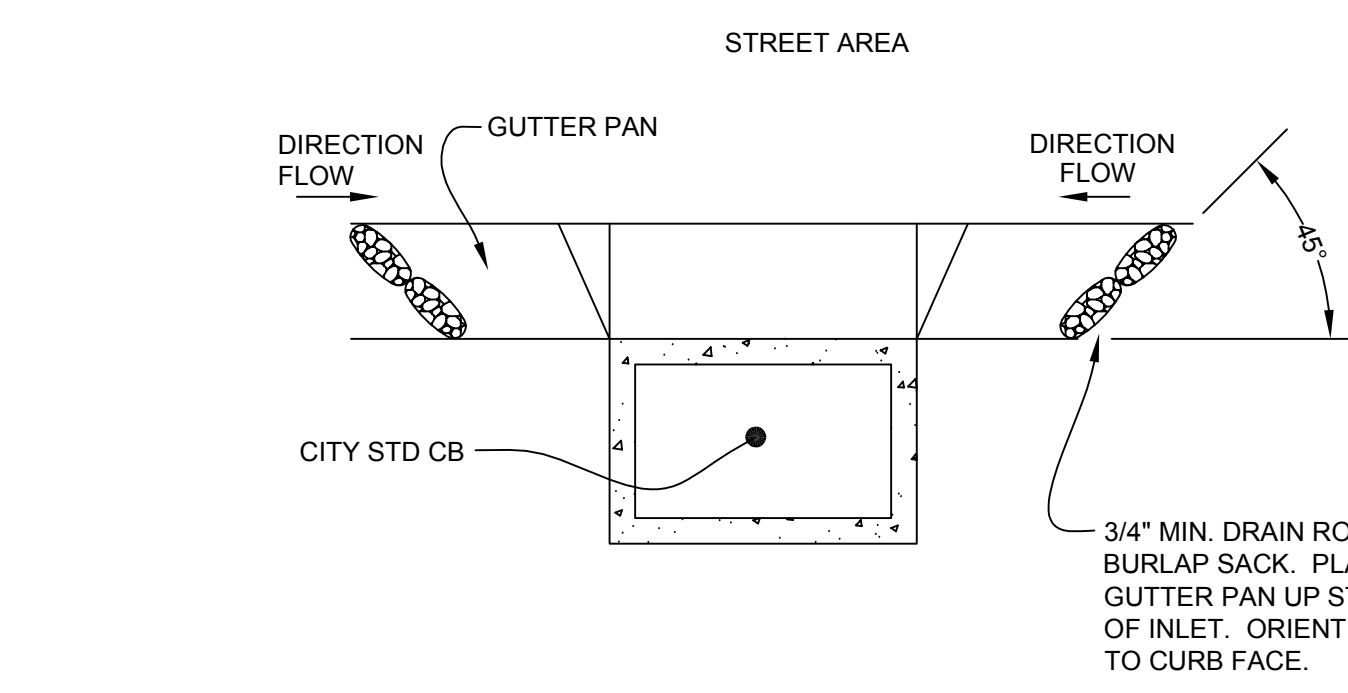

5 GRAVEL BAG FILTER IN TRAFFIC AREAS
SCALE: NTS

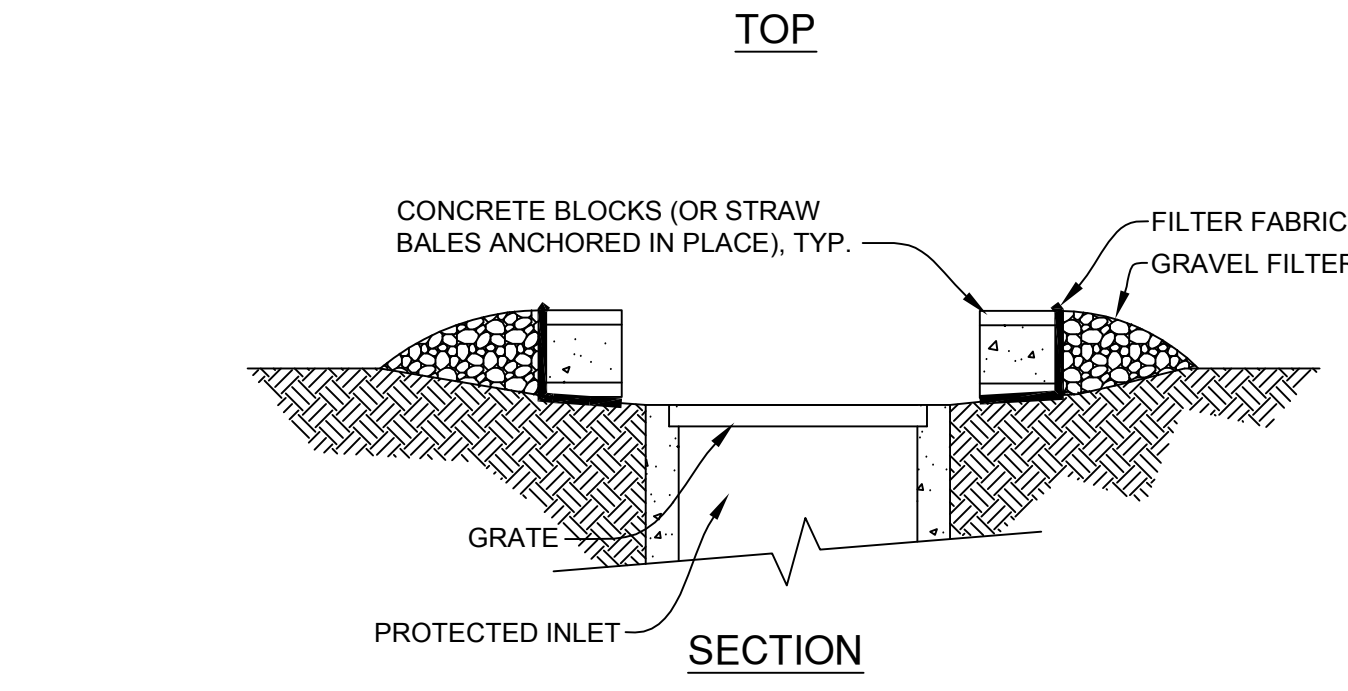
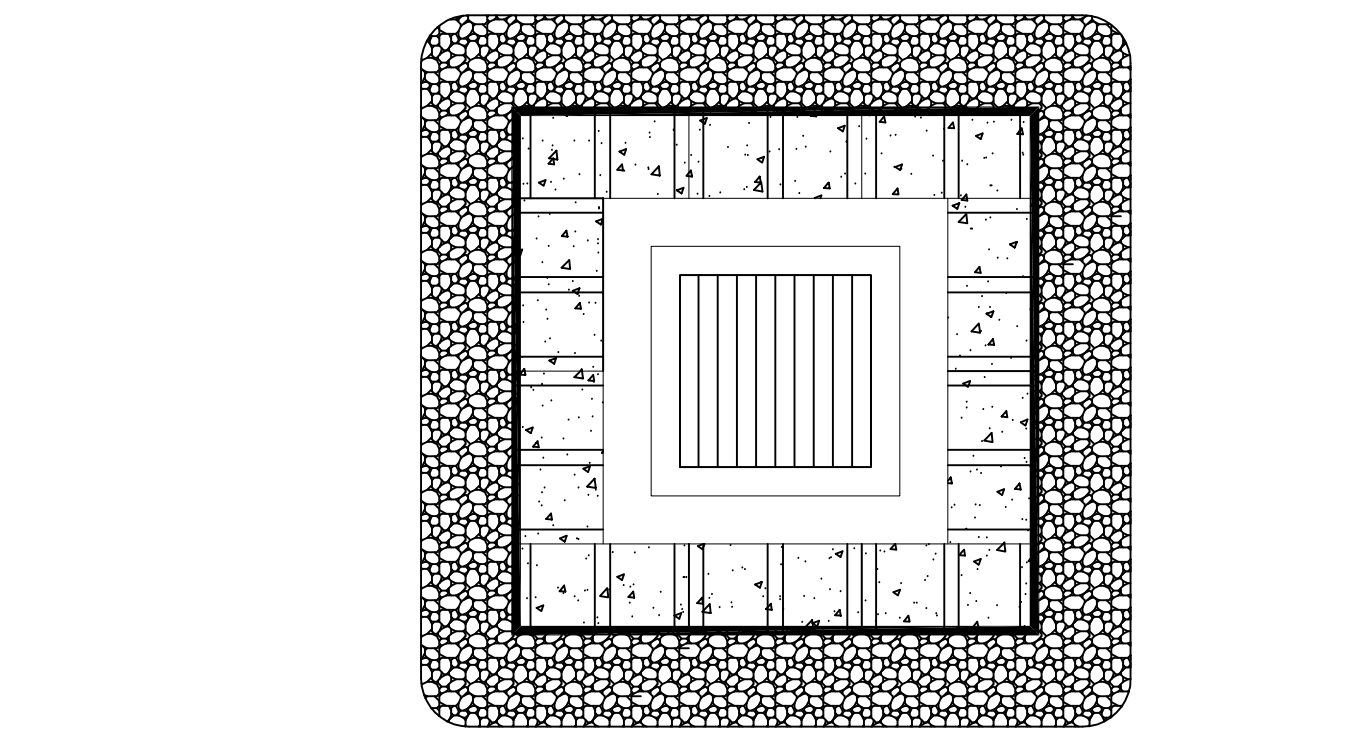

8 INLET PROTECTION DETAIL
SCALE: NTS



Rev	Date	Issues and Revisions
	12-10-09	Check Set
	12-17-09	Check Set
	1-15-10	Bid Documents

- Design Development
- Progress
- Bidding
- Permit
- Construction
- OTHER

Sheet Title:

EROSION AND SEDIMENTATION NOTES AND DETAILS

Plot Date: January 15, 2010

Drawn by:

Checked by:

Job Number: 3.1607.00

Sheet Number:



BRIDGEWAY TO FERRY LANDING IMPROVEMENTS



ROYSTON HANAMOTO ALLEY & ABEY

R H A A

LANDSCAPE ARCHITECTS & PLANNERS
225 Mill Avenue Mill Valley, CA 94041 415.883.7900
323 Green Street, #102 San Francisco, CA 94102 415.881.1900

CSW ST 2

CSW/Stuber-Stroeh
Engineering Group, Inc.
45 Leveroni Court
Novato, CA 94949
tel: 415.883.9850
fax: 415.883.9835

Civil & Structural Engineers
Surveying & Mapping
Environmental Planning
Land Planning
Construction Management
Landscape Architecture

© 2010



Rev	Date	Issues and Revisions
	12-10-09	Check Set
	12-17-09	Check Set
	1-15-10	Bid Documents

- Design Development
- Progress
- Bidding
- Permit
- Construction
- OTHER

Sheet Title:

STORMWATER CONTROL PLAN

Plot Date: January 15, 2009

Drawn by:

Checked by:

Job Number: 3.1607.00

Sheet Number:

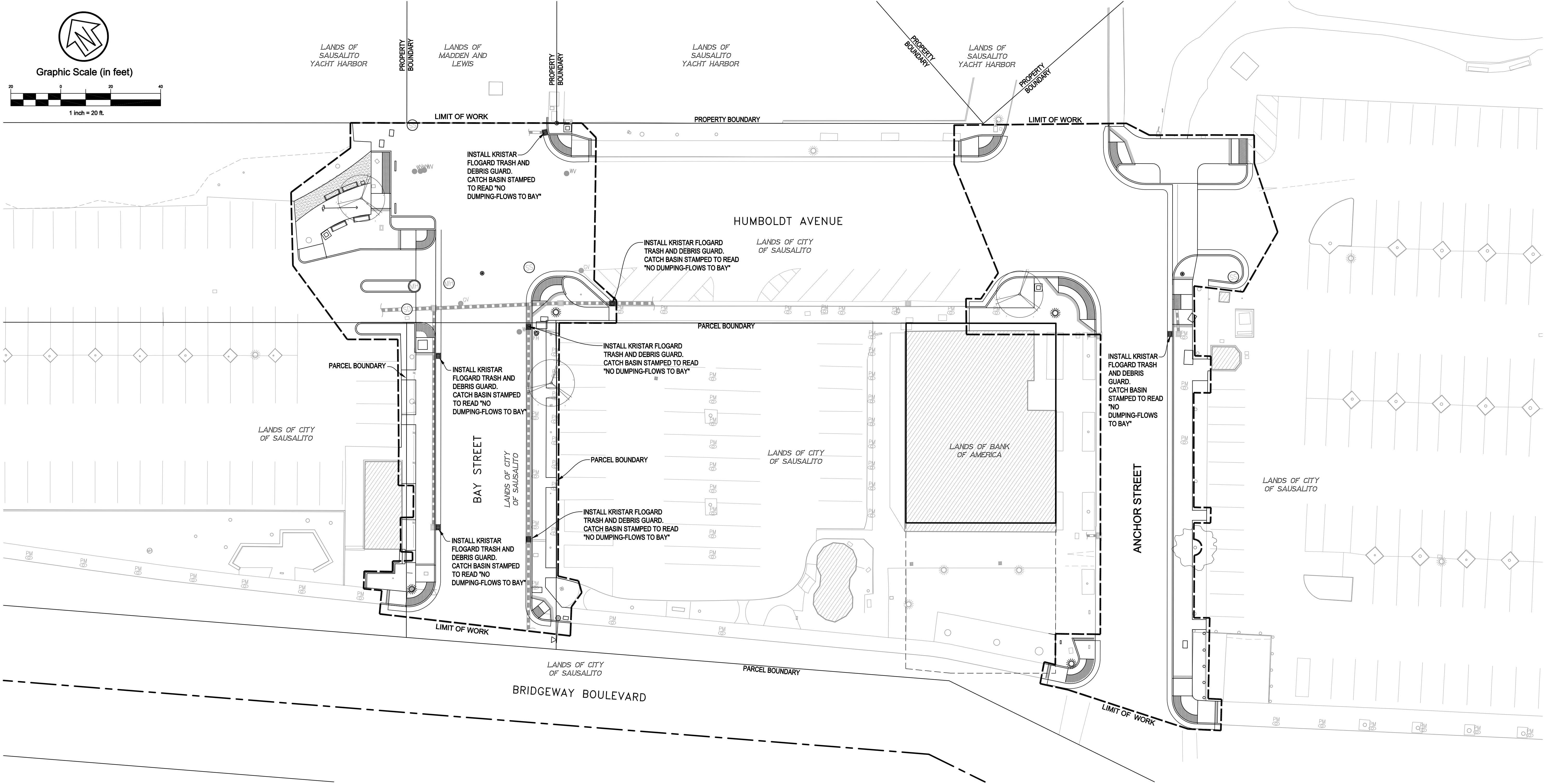

**BID DOCUMENTS
NOT FOR CONSTRUCTION**

BRIDGEWAY TO FERRY LANDING IMPROVEMENTS



ROYSTON HANAMOTO ALLEY & ABEY
R | H | A | A
 LANDSCAPE ARCHITECTS & PLANNERS
 225 Mill Avenue Mill Valley, CA 94041 415.383.7500
 323 Geary Street, #602 San Francisco, CA 94102 415.381.1900

CSW ST 2

CSW/Stuber-Stroeh Engineering Group, Inc.
 45 Leveroni Court
 Novato, CA 94949
 tel: 415.883.9850
 fax: 415.883.9835

Civil & Structural Engineers
 Surveying & Mapping
 Environmental Planning
 Land Planning
 Construction Management
 Landscape Architecture

© 2010



Rev	Date	Issues and Revisions
	12-10-09	Check Set
	12-17-09	Check Set
	1-15-10	Bid Documents

- Design Development
- Progress
- Bidding
- Permit
- Construction
- OTHER

Sheet Title:

STRIPING PLAN

Plot Date: January 15, 2010

Drawn by:

Checked by:

Job Number:

Sheet Number:

C8

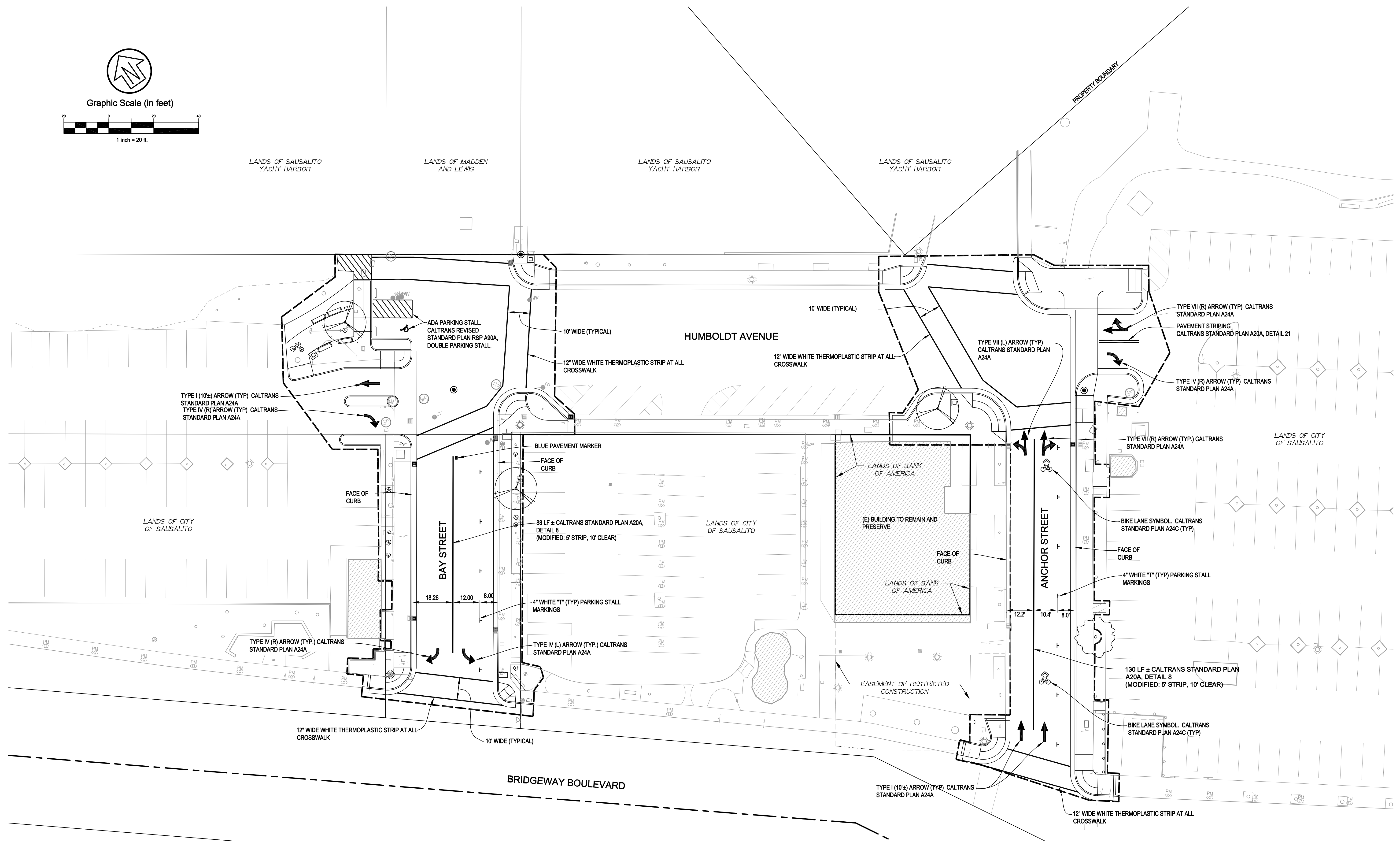

- NOTES:**
- ALL STRIPING SHALL CONFORM TO CALTRANS STANDARD PLANS CURRENT EDITION.
 - ALL FIRE HYDRANTS SHALL BE MARKED WITH A BLUE "BOX DOT" PAVEMENT MARKER CONFORMING TO CALTRANS STANDARDS.

**BID DOCUMENTS
 NOT FOR CONSTRUCTION**

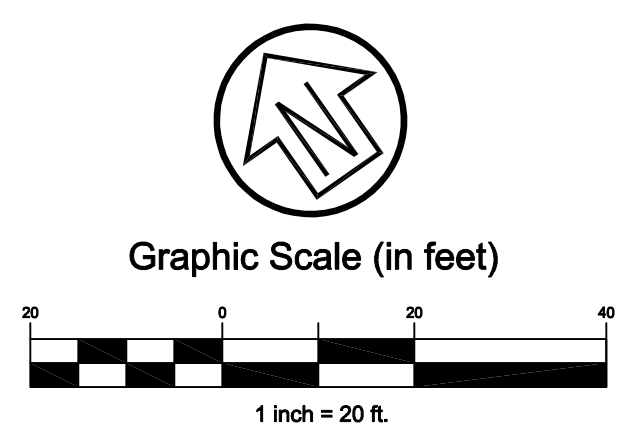

BRIDGEWAY TO FERRY LANDING IMPROVEMENTS



ROYSTON HANAMOTO ALLEY & ABEY
R | H | A | A
 LANDSCAPE ARCHITECTS & PLANNERS
 225 Millar Avenue Mill Valley, CA 94041 415.383.7900
 323 Geary Street, #102 San Francisco, CA 94102 415.881.7900

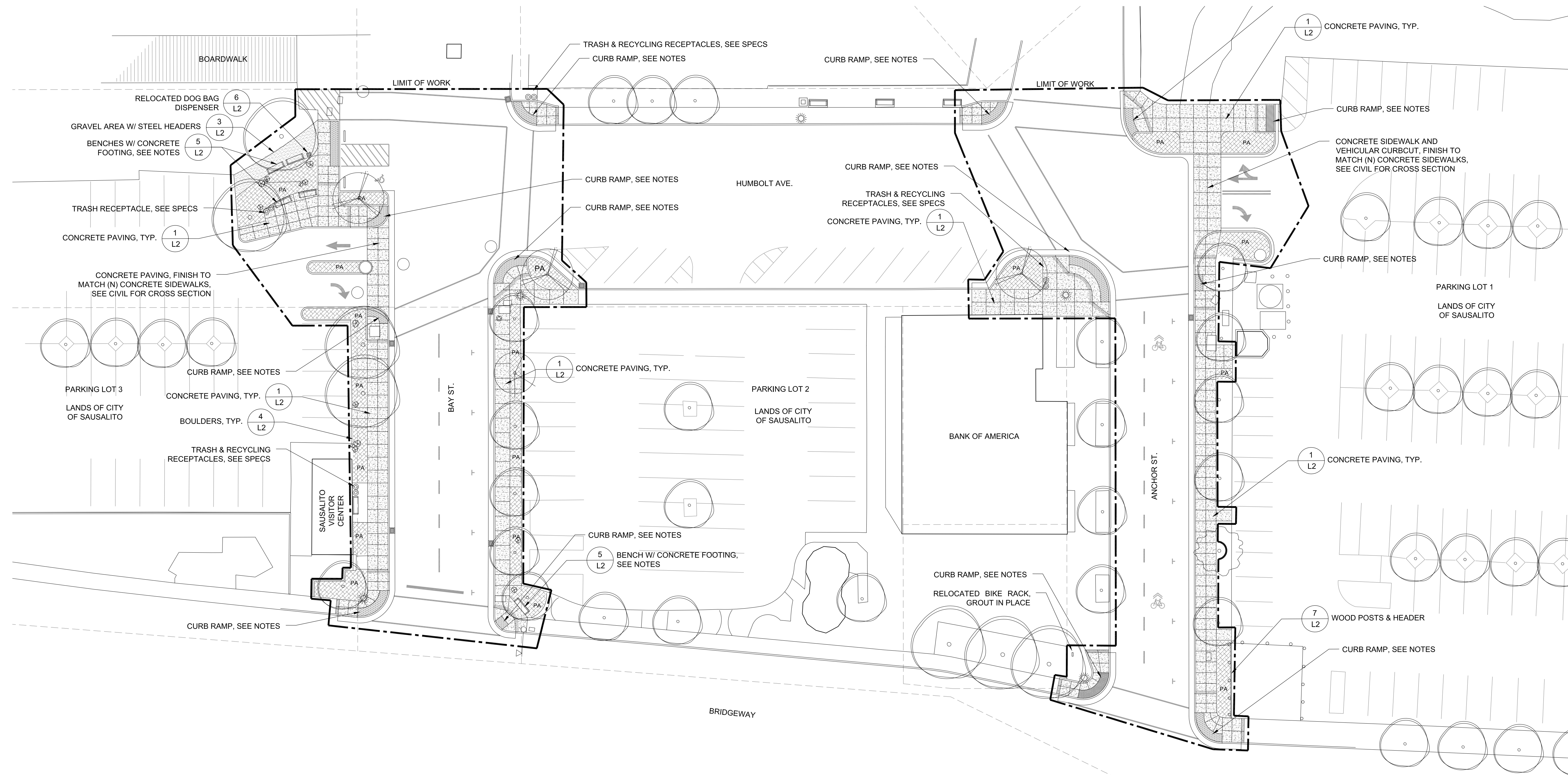

LEGEND

	(E) BOULDERS, RELOCATED (SEE DETAIL 4, L2)
	(E) BENCHES, RELOCATED (SEE DETAIL 5, L2)
	(N) TRASH/RECYCLING BINS
	PA PLANTING AREA TO RECEIVE NEW PLANTING
	(N) CONCRETE
	TRUNCATED DOMES (SEE DETAIL 2, L2)
	--- PROPERTY BOUNDARY LINES

NOTES:
 1. SEE CIVIL FOR CURB RAMP TYPES (FOR TRUNCATED DOMES SEE DETAIL 2, L2).
 2. EXISTING BENCHES TO BE REFINISHED AND RELOCATED AS SHOWN (FOR FOOTING SEE DETAIL 5, L2)

BID DOCUMENTS NOT FOR CONSTRUCTION

Rev	Date	Issues and Revisions
	12-10-09	Check Set
	1-15-09	Bid Documents

- Design Development
- Progress
- Bidding
- Permit
- Construction
- OTHER

Sheet Title:

LANDSCAPE CONSTRUCTION PLAN

Plot Date: Jan 15, 2010
 Drawn by:
 Checked by:
 Job Number:
 Sheet Number:

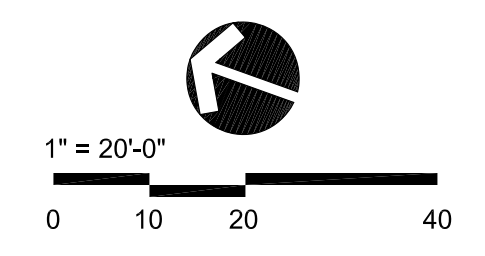

L1