

**TRAFFIC CONTROL NOTES:**

1. MAINTAIN AT LEAST ONE LANE OF TRAFFIC ON HUMBOLDT AVENUE AT ALL TIMES.
2. MAINTAIN AT LEAST ONE LANE OF TRAFFIC ON ANCHOR STREET BETWEEN 11AM AND 11PM.
3. PROVIDE "NO PARKING" SIGNS FOR HUMBOLDT AVENUE LISTING DATES AND TIMES THAT HUMBOLDT WILL BE AFFECTED 48 HOURS IN ADVANCE OF CONSTRUCTION.
4. MAINTAIN INGRESS AND EGRESS LANES TO PARKING LOT 1, LOT 1 TO REMAIN OPEN AT ALL TIMES.

**HUMBOLDT AVENUE  
PLAN  
SCALE: 1"=20'**

POTHOLE #	CUT SIZE	ASPHALT	CONCRETE	SOIL	DEPTH	COMMENTS
P1	1X1'	4.5"		DIRT SAND	23.5"	
P2	1X2.5'	8"		ROCK BALLAST DIRT	TOP-22.5" BOTTOM 32.5"	HIT CONCRETE AT 22.5". OPENED HOLE 1X2.5 AND STILL HIT CONCRETE AT 32.5"
P2A	1X1'	6"		GRAVEL	FORCE MAIN	NO LOCATE ON LINES. NO VISUAL DUE TO GRAVEL CAVING IN. CLEARED TO 43"
P3	1X1'	4"		DIRT ROCKS	17"	
P4	1X1'	5"		DIRT ROCKS	28"	
P5	1X1'	5"		DIRT ROCKS, DIRTY LOTS OF DIRTY	42"	

**HUMBOLDT AVENUE  
PLAN  
SCALE: 1"=20'**

1. LATERALS ARE SHOWN AS PER CCTV INSPECTION BY ROTO ROOTER, LOCATION IS APPROXIMATE. FIELD VERIFY ALL LATERALS.
2. AERIAL PHOTO COURTESY OF THE COUNTY OF MARIN, 2006, AND DOES NOT REFLECT ACTUAL SITE CONDITIONS.
3. SEWER SHALL REMAIN IN SERVICE AT ALL TIMES. CONTRACTOR SHALL CONTROL FLOW AND/OR BYPASS AS NECESSARY. SEE NOTE 12 ON G02.
4. PROTECT EXISTING UTILITIES IN PLACE UNLESS NOTED OTHERWISE. EXISTING UTILITIES NOT SHOWN IN PROFILE SEE NOTE 7 ON G02.
5. COORDINATE DIRECTLY WITH P.G.&E. REGARDING GAS MAIN ON HUMBOLDT AVENUE, INCLUDING BUT NOT LIMITED TO REQUEST FOR P.G.&E. FIELD OBSERVATION AND P.G.&E. CONTROL OF GAS FLOW. FIELD VERIFY LOCATION AND DEPTH. SUPPORT GAS LINE IN PLACE DURING CONSTRUCTION.
6. MOVE RESTROOMS TO LOT #2 SEE C01 AND SPECIFICATIONS.
7. REMOVE EXISTING CURB GUTTER AND SIDEWALK AS NECESSARY (APPROX 20 FT.) RESTORE ORIGINAL CONDITIONS OR BETTER UPON COMPLETION OF PROJECT.

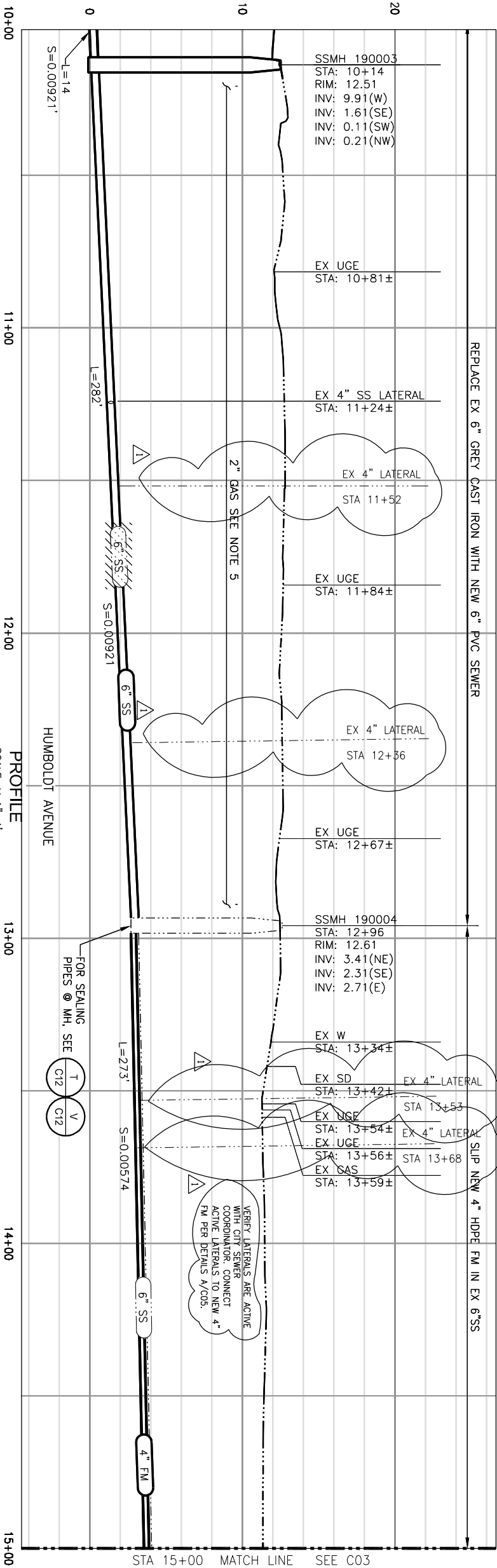

**PROFILE  
SCALE: V. 1"=4'  
H. 1"=20'**



SUBMITTED: *[Signature]*  
DATE: 9/11/12  
APPROVED: \_\_\_\_\_  
DATE: \_\_\_\_\_

THIS LINE IS 1 INCH AT FULL SCALE IF NOT SCALE ACCORDINGLY  
SCALE: AS SHOWN  
DRAWN BY: ALN  
DESIGNED BY: TTT  
PROJ. MGR.: \_\_\_\_\_

ADDENDUM NO. 2	PDF	10/12
REVISIONS	BR	DATE



2020 Research Park Drive  
Suite 100  
Daly City, California 94018  
(530) 756-5905  
FAX (530) 756-5991



**CITY OF SAUSALITO PRIORITY 1 SEWER REPLACEMENT PROJECT 1B**  
HUMBOLDT AVENUE  
STA 10+00 TO 15+00  
PLAN & PROFILE

JOB NUMBER	454-02-09-02
DRAWING NUMBER	C02
SHEET NUMBER	5 OF 28
REVISION	