

CAPITAL IMPROVEMENT PROJECT STRIPING MAINTENANCE

SAUSALITO, CALIFORNIA

LEGEND:

	Found Survey Marker
	Gas Meter
	Gas Valve
	PG&E Manhole
	Power Pole
	Sign
	Sanitary Sewer Manhole
	Telephone Manhole
	Storm Drain Manhole
	Water Meter
	Fire Hydrant
	Water Valve
	Street Light
	Drainage Inlet
	Rock Retaining Wall
	Conc Retaining Wall



VICINITY MAP
N.T.S.

BASIS OF TOPOGRAPHY:

The topography for the improvement areas depicted on aerial photos from MarinMaps.

SHEET INDEX:

ST1	COVER SHEET
ST2	STRIPING PLAN - ALEXANDER TO SOUTH ST
ST3	STRIPING PLAN - 2ND TO RICHARDSON ST
ST4	STRIPING PLAN - BRIDGEWAY BLVD

GENERAL NOTES:

- Work shown hereon shall be done in accordance with the City of Sausalito standard construction plans and specifications, latest edition, the Standard Specifications for the State of California Department of Transportation, and utility company's standard plans and specifications as applicable, latest edition.
- Contractor shall refer to 2010 Caltrans Standard Plans where the delineation callout is not identified in the 2006 Caltrans Standard Plans.
- The contractor shall assume sole and complete responsibility for the job site conditions, including safety of all persons and property, during the course of construction of this project. This requirement shall apply continuously, and shall not be limited to normal working hours. The Contractor further agrees to hold design professional harmless from any and all liability, real or alleged, in connection with the performance of work on this project, excepting liability arising from the sole negligence of the design professional.
- Contractor shall hold harmless the City of Sausalito and its authorized representatives from all liabilities and damages resulting from his construction operations.
- Prior to commencing construction operations, the contractor shall verify all interfaces between existing conditions and new construction for striping including location and elevation of existing underground or at grade facilities at crossings with proposed underground facilities. If conditions differ from those shown on the plans, the contractor shall notify the design engineer and shall not begin construction operations until the changed conditions have been evaluated.
- The Contractor shall be responsible for the review and coordination of all contract documents prior to the start of construction. Any discrepancies that occur shall be brought to the attention of the design engineer prior to the start of construction so that a clarification can be issued. Any work performed in conflict with the contract documents shall be corrected by the contractor at their own expense.
- The Engineer preparing these plans will not be responsible for, or liable for, unauthorized changes to or uses of these plans. All changes to the plans must be in writing and must be approved by the preparer of these plans.
- Notes and details on drawings shall take precedence over general notes and typical details. Where no details are given, construction shall be as shown for similar work.
- All easements or other encumbrances shown or referenced in these plans or disclosed in the title report are subject to inherent or explicit restrictions. The contractor is responsible for determining the impact of these restrictions on his or her intent for the property.
- The Contractor shall obtain all necessary permits including encroachment permit from the City of Sausalito prior to any work in the public right-of-way.
- Outdoor noise-generating construction activities (including but not limited to Rapid Impact Compaction (RIC) grading, trenching, concrete placement, sawing and hammering) shall be limited to the hours between 8 AM. and 5 PM, Monday through Friday. For questions regarding construction hours and/or related noise, please contact the City Engineer.
- All ramps and other accessibility accommodations are intended to comply with the current standards under the Americans with Disabilities Act. The Contractor shall notify the Civil Engineer if any proposed improvements are not consistent with the standards.
- All streets shall be swept and kept clean at the end of each day and shall comply with all applicable RWQCB requirements for the duration of the project work.
- Utilities as shown conform to available record data. The existence, location and characteristics of underground utility information shown on these plans have been obtained from a review of available record data. No representation is made as to the accuracy or completeness of said utility information. It is the Contractor's responsibility to verify location and depths by potholing of all utilities with appropriate agencies, and to take precautionary measures to protect the utility lines shown and any other lines not of record or not shown on these plans. Any conflicts shall be reported immediately to the agency and to the Civil Engineer.
- This survey does not reflect a final boundary determination. The boundary shown hereon is depicted for graphical purposes only.
- Topographic information is based on MarinMaps orthophotos and field measurements and are approximate only.
- All layout, spotting, or cat tracking shall be performed by the Contractor and approved by the Engineer prior to placement of thermoplastic markings.
- Contractor shall coordinate with City for use of 6" letters and numbers stencil for Caltrans standard pavement markings too wide for the proposed Street width.

ABBREVIATIONS

AB	Aggregate Base	GB	Grade Break	STD	Standard
AC	Asphalt Concrete	GV	Gate Valve	SD	Storm Drain
BC	Begin Curve	HDPE	High Density Polyethylene	SDMH	Storm Drain Manhole
BW	Back of Walk	HP	High Point	SF	Square Feet
bw	Bottom of Walk	IMP	Integrated Management Practices	SSMH	Sanitary Sewer Manhole
CB	Catch Basin	JT	Joint Trench	SS	Sanitary Sewer
CATV	Cable Television	LF	Linear Feet	STA	Station
C&G	Curb & Gutter	POC	Point of Connection	S/W	Sidewalk
C.L.	Centerline/Control line	(N)	New	TEL	Telephone
CR	Curb Return	NTS	Not to Scale	TW	Top of Wall
DB	Diversion Box	PC	Point of Curve	TC	Top of Curb
DI	Drainage Inlet	PCC	Point of Compound Curve	TELE	Telephone
EG	Existing Grade	PCC	Portland Cement Concrete	TG	Top of Grate
EP	Edge of Pavement	PB	Pull Box	TP	Top of Pavement
(E)	Existing	PKM	Parking Meter	VC	Vertical Curve
EB	Electrical Box	PT	Point of Tangent	W	Water
FG	Finished Grade	PVC	Polyvinyl Chloride	WM	Water Meter
FH	Fire Hydrant	RCP	Reinforced Concrete Pipe	W/WL	Water Line
FS	Finish Surface	RC	Relative Compaction		
		ROW	Right of Way		



CSW ST 2

CSW/Stuber-Stroh
Engineering Group, Inc.
45 Leveroni Court
Novato, CA 94949
tel: 415.883.9850
fax: 415.883.9835 © 2010

Rev	Date	Description	Designed	Drawn	Checked
C	11/07/12	100% CONSTRUCTION DOCUMENT	RJS	RJS	JDS
B	02/24/12	90% CONSTRUCTION DOCUMENT	RJS	RJS	JDS
A	04/16/10	65% CONSTRUCTION DOCUMENT	RJS	RJS	JDS

SAUSALITO CAPITAL IMPROVEMENTS
COVER SHEET
SAUSALITO, CALIFORNIA

City Of
Sausalito
County Of
Marin
State Of
California

Prepared Under the Direction of:

Sheet
ST1

Scale:	N.T.S.
Date:	April 2010
File:	4.1137.00
Plan File:	D-4928



CSW ST2

CSW/Stuber-Stroeh
Engineering Group, Inc.
45 Leveroni Court
Novato, CA 94949
tel: 415.883.9850
fax: 415.883.9835 © 2012

Rev	Date	Description	Designed	Drawn	Checked
C	11/07/12	100% CONSTRUCTION DOCUMENT	RJS	RJS	JDS
B	02/24/12	90% CONSTRUCTION DOCUMENT	RJS	RJS	JDS
A	04/16/10	65% CONSTRUCTION DOCUMENT	RJS	RJS	JDS

SAUSALITO CAPITAL IMPROVEMENTS STRIPING PLAN ALEXANDER AVE. & SOUTH ST.

City Of
Sausalito
County Of
Marin
State Of
California

Prepared Under the Direction of:

ST2

Scale: 1 inch = 30 ft.
Date: April 2010
File: 4.1137.00
Plan File: D-4928

SEE SHEET ST3

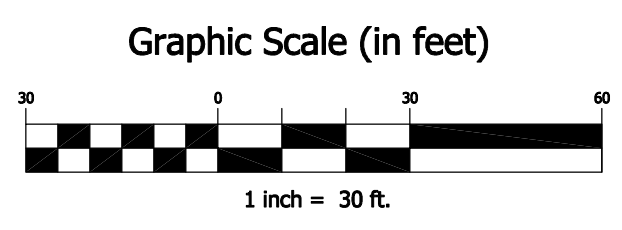
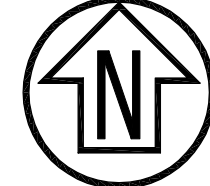
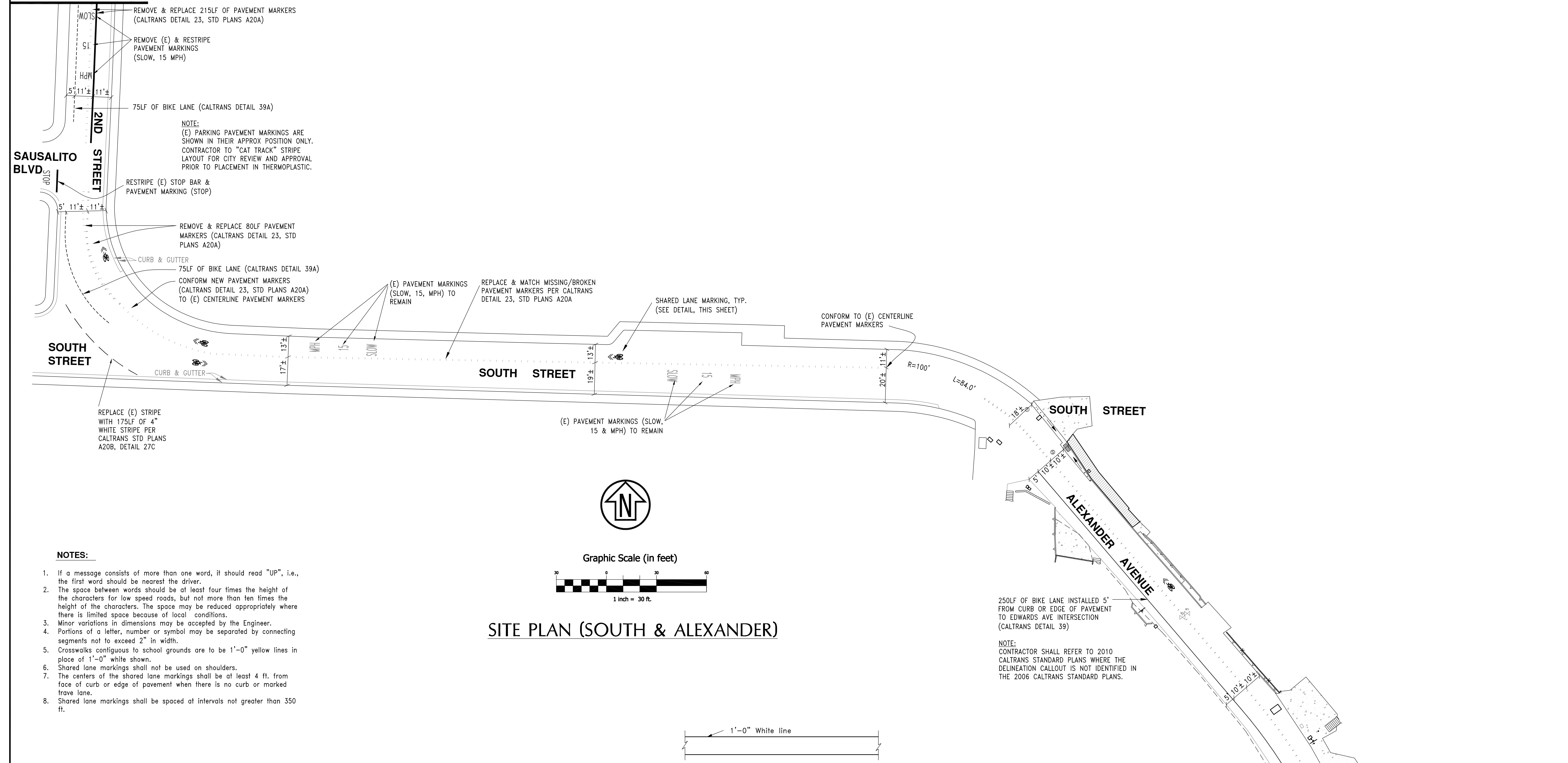

SITE PLAN (SOUTH & ALEXANDER)

- NOTES:**
- If a message consists of more than one word, it should read "UP", i.e., the first word should be nearest the driver.
 - The space between words should be at least four times the height of the characters for low speed roads, but not more than ten times the height of the characters. The space may be reduced appropriately where there is limited space because of local conditions.
 - Minor variations in dimensions may be accepted by the Engineer.
 - Portions of a letter, number or symbol may be separated by connecting segments not to exceed 2" in width.
 - Crosswalks contiguous to school grounds are to be 1'-0" yellow lines in place of 1'-0" white shown.
 - Shared lane markings shall not be used on shoulders.
 - The centers of the shared lane markings shall be at least 4 ft. from face of curb or edge of pavement when there is no curb or marked travel lane.
 - Shared lane markings shall be spaced at intervals not greater than 350 ft.

Figure 9C-9. Shared Lane Marking

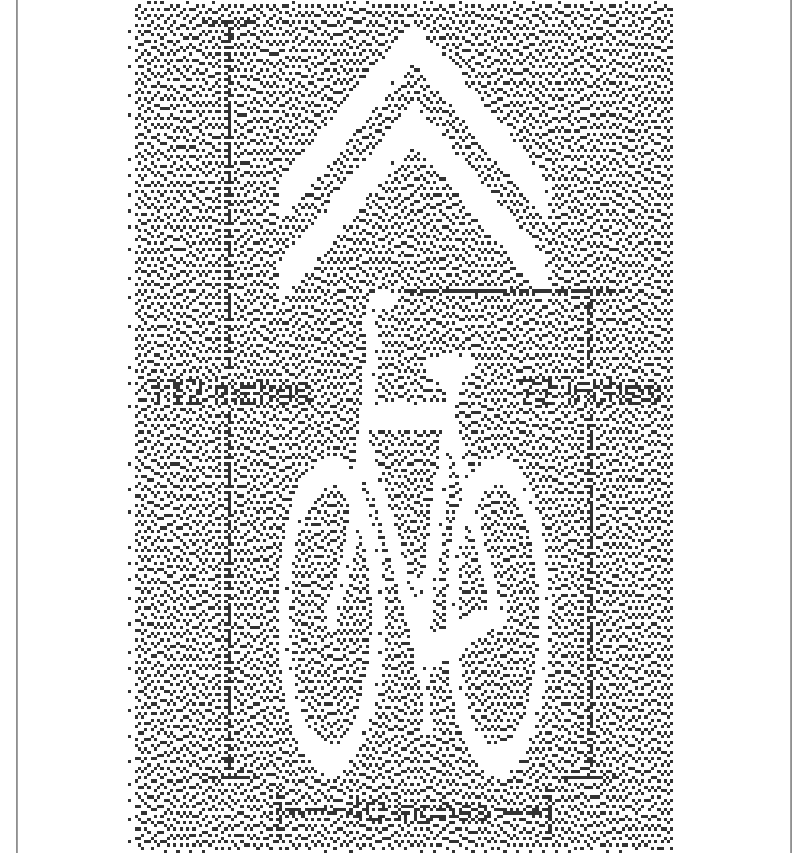

SHARED LANE MARKING

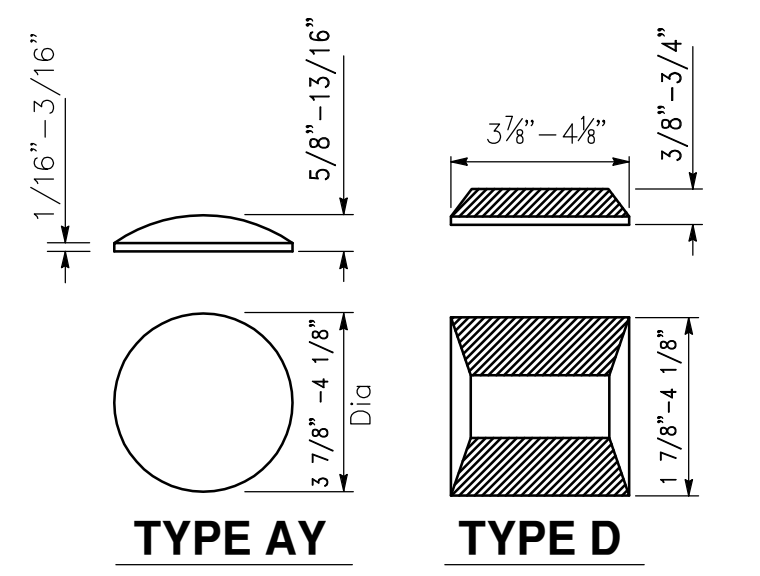

CALTRANS STD PLAN A20B

PAVEMENT MARKER

CROSSWALK AND LIMIT LINE

CALTRANS STD PLAN A24E

DETAIL 27B

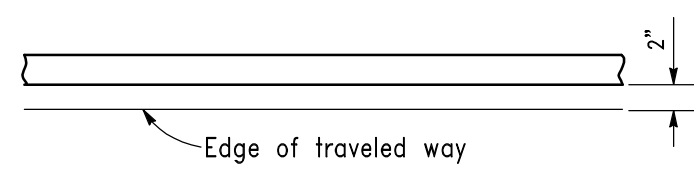

DETAIL 27C

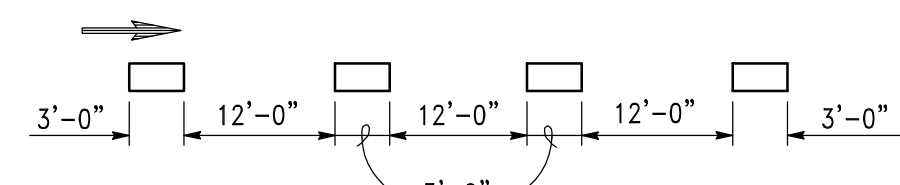

CALTRANS STD PLAN A20B

STRIPING DETAIL

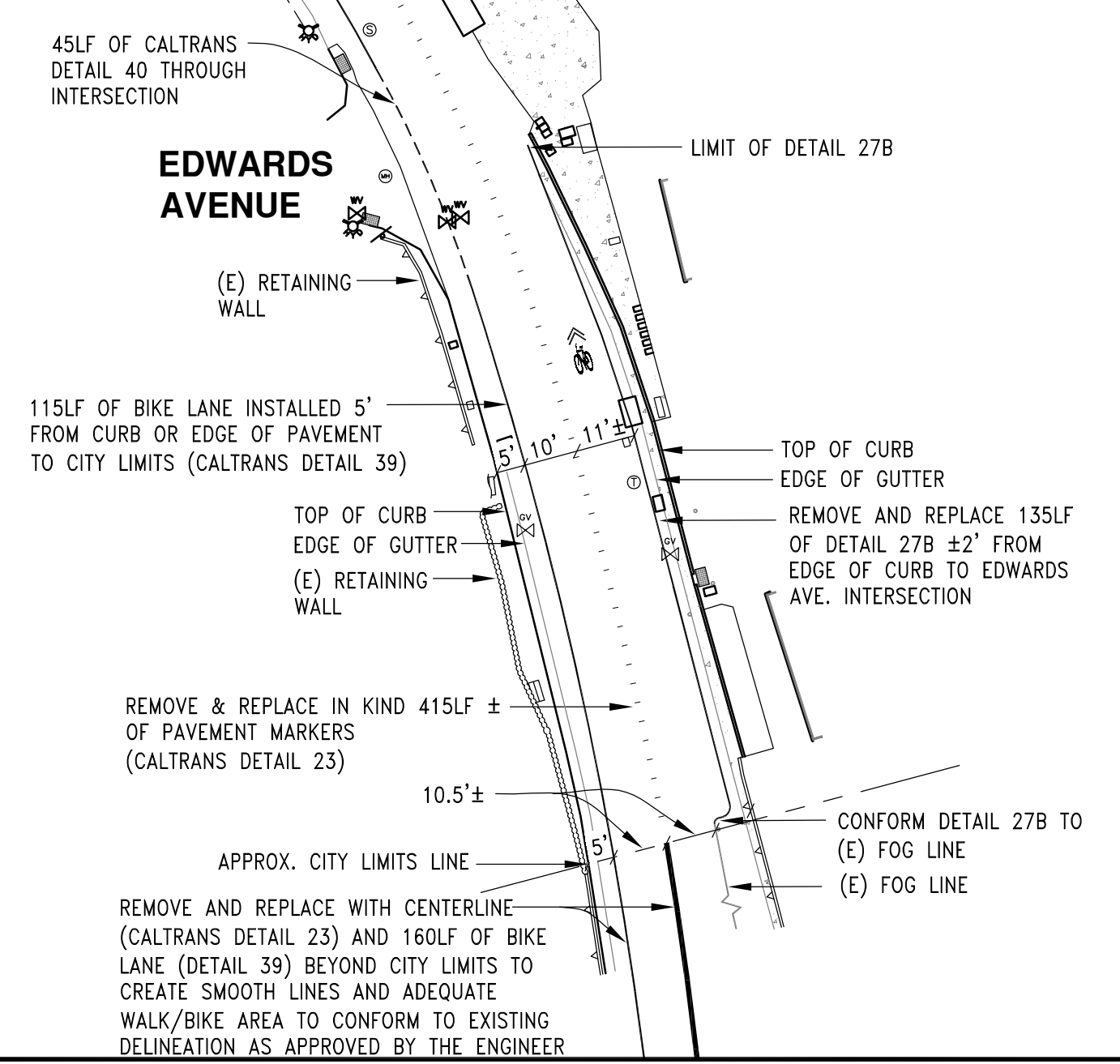



CSW ST2

CSW/Stuber-Stroeh Engineering Group, Inc. 45 Leavenworth Court Novato, CA 94949 tel: 415.883.9850 fax: 415.883.9835 © 2012

Rev	Date	Description	Designed	Drawn	Checked
C	11/07/12	100% CONSTRUCTION DOCUMENT	RJS	RJS	JDS
B	02/24/12	90% CONSTRUCTION DOCUMENT	RJS	RJS	JDS
A	04/16/10	65% CONSTRUCTION DOCUMENT	RJS	RJS	JDS

SAUSALITO CAPITAL IMPROVEMENTS
STRIPING PLAN
BRIDGEWAY (RICHARDSON - PRINCESS)

City Of Sausalito
County Of Marin
State Of California

Prepared Under the Direction of:

Sheet **ST4**

Scale: 1 inch = 30 ft.
Date: April 2010
File: 4.1137.00
Plan File: D-4928

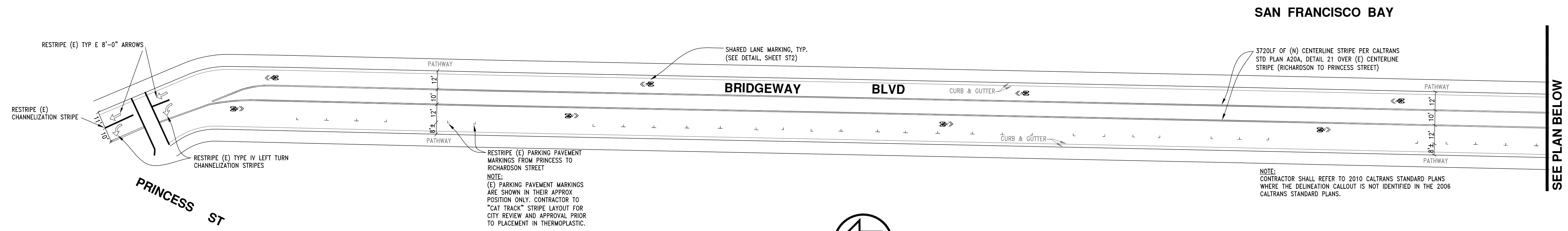

SITE PLAN (BRIDGEWAY BLVD)

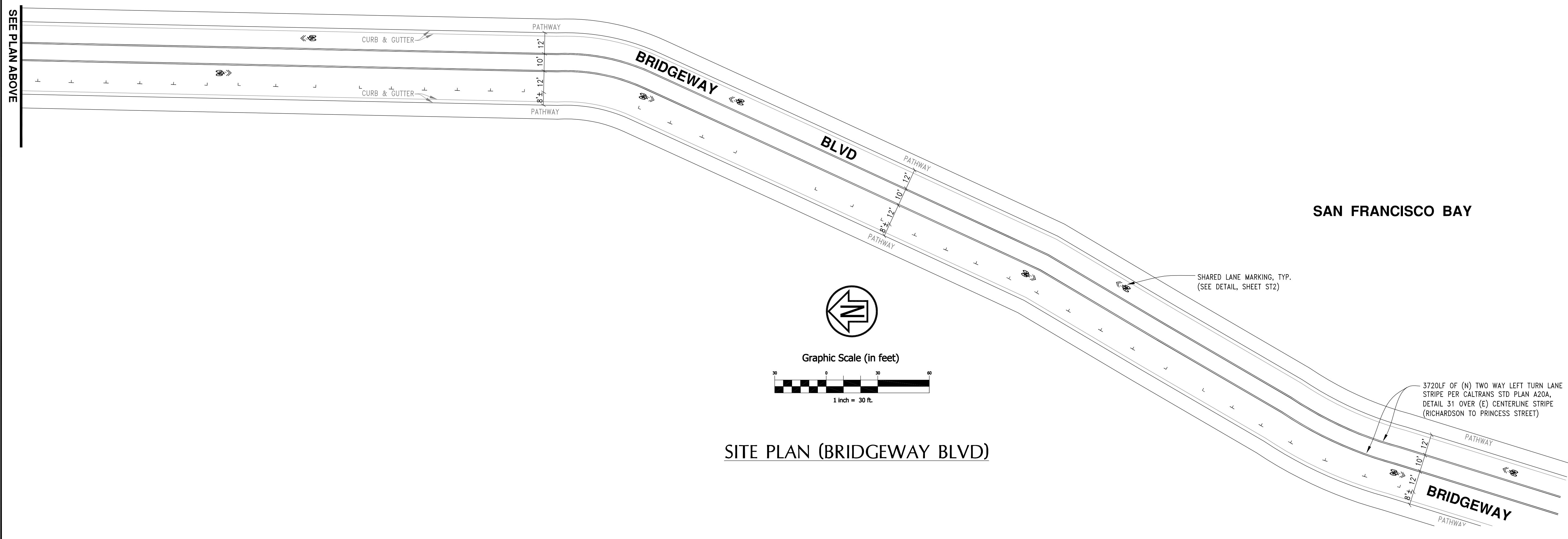

SITE PLAN (BRIDGEWAY BLVD)