







This document, together with the concepts and designs presented herein, is intended only for the specific purpose and client for which it was prepared. Reuse of and/or reliance on this document without written authorization and approval by Kimley-Horn and Associates, Inc. shall be without liability to Kimley-Horn and Associates, Inc.

**LEGEND:**

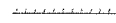
-  AREA OF TREATMENT
-  FAILURE REPAIR AREA
-  SAWCUT
-  BASE FAILURE REPAIR  
SEE CD-02 FOR DETAILS
-  PCC FAILURE REPAIR  
SEE CD-02 FOR DETAILS
-  PAVEMENT FAILURE REPAIR  
SEE CD-02 FOR DETAILS
-  DETAIL NUMBER
-  SHEET NUMBER
-  STANDARD DETAIL NUMBER  
CALTRANS STANDARD PLANS

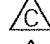
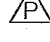
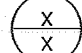

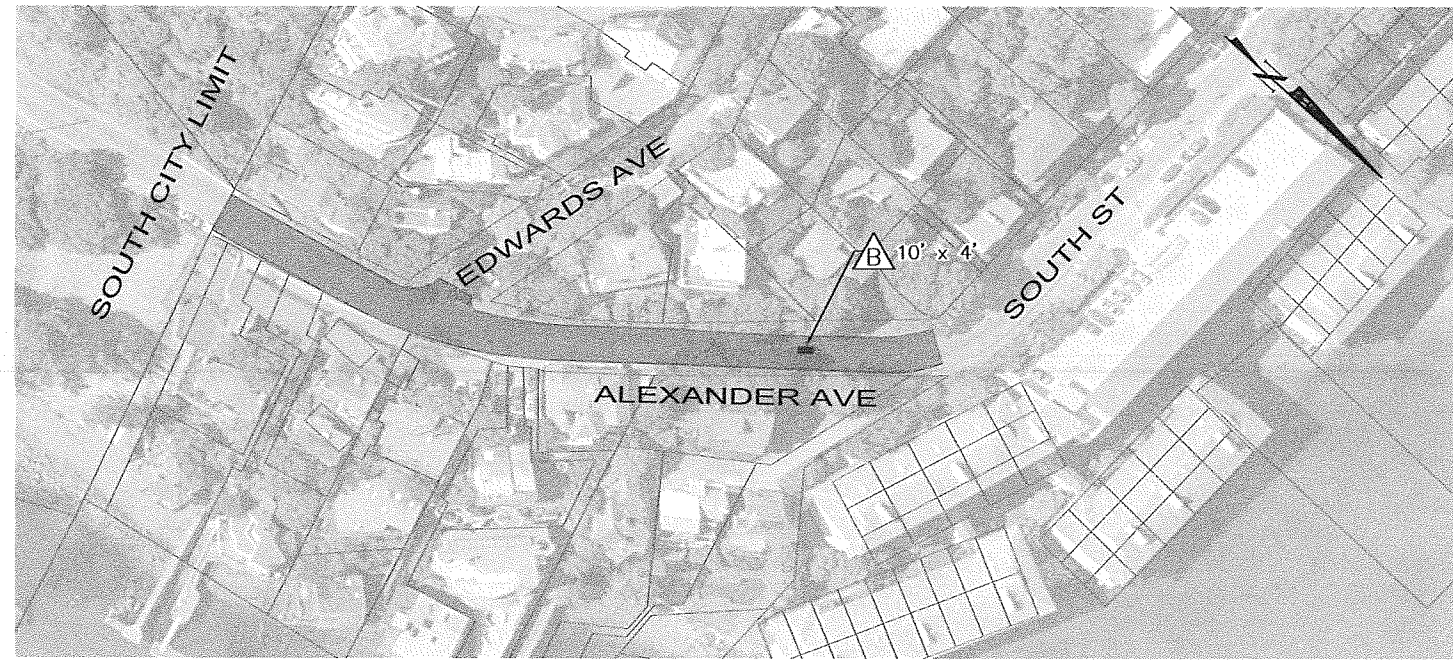
**SECTION 1: ALEXANDER AVE (SOUTH ST TO SOUTH CITY LIMIT)**  
TREATMENT: CRACK SEAL  
NTS

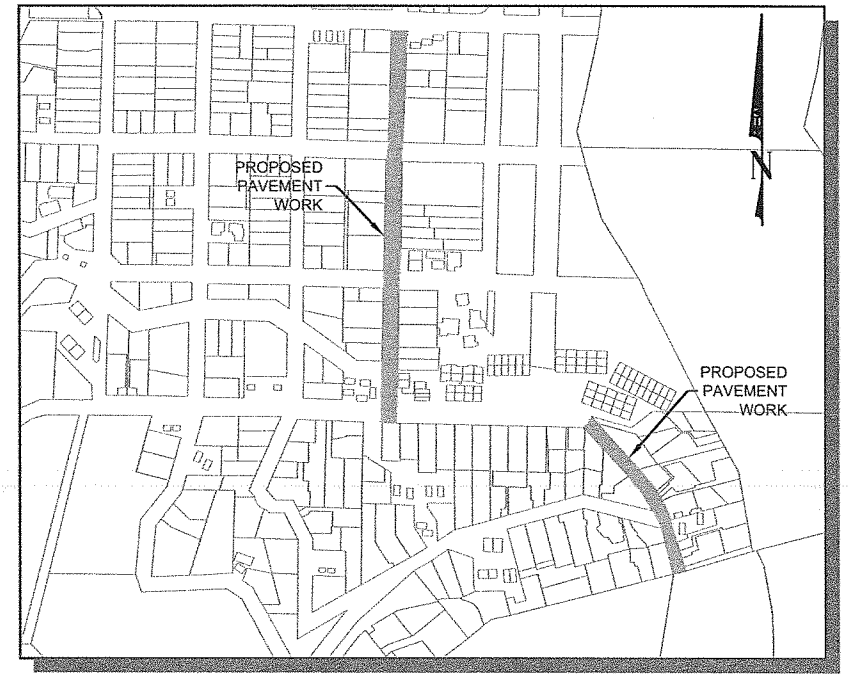

**LOCATION MAP**  
NTS

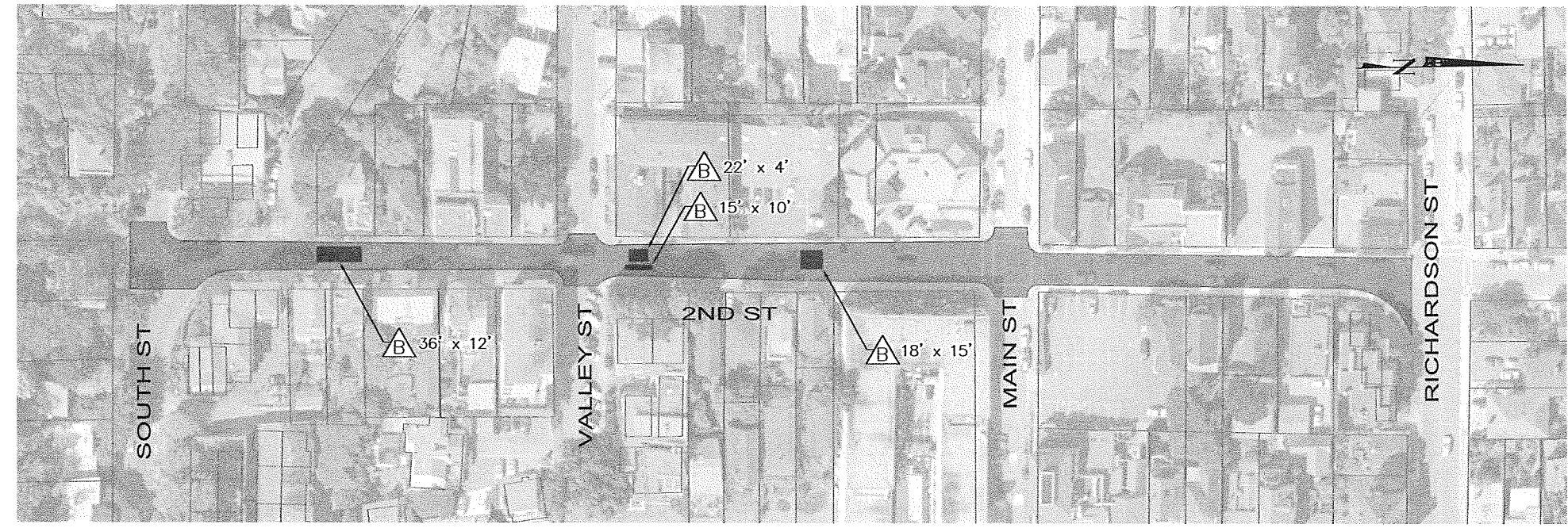

**SECTION 2: 2ND ST (SOUTH ST TO RICHARDSON ST)**  
TREATMENT: CRACK SEAL & CAPE SEAL  
NTS

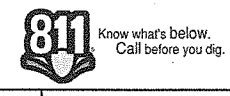

No.	REVISIONS	DATE	BY

**Kimley-Horn and Associates, Inc.**  
 © 2013 KIMLEY-HORN AND ASSOCIATES, INC.  
 6130 STONERIDGE MALL RD., STE 370 PLEASANTON, CA 94588  
 PHONE: 925-398-4840 FAX: 925-398-4849  
 WWW.KIMLEY-HORN.COM

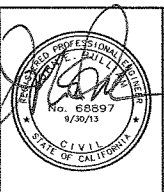

DESIGNED BY TH/JP	DRAWN BY TH/CG	CHECKED BY JP
PLANS PREPARED UNDER SUPERVISION OF:		
JOHN PULLIAM, P.E. REGISTERED CIVIL ENGINEER		
APRIL 2013 DATE	68897 RCE NO.	



**PROJECT LAYOUT PLANS**  
**ALEXANDER AVE AND 2ND ST**  
 CITY OF SAUSALITO 2013 STREET IMPROVEMENT PROJECT

DRAWING NO PL-01
SHEET 04 of 27
JOB No. 097901001

K:\BAY\_ROW\9097901001 - Sausalito Street Repair\Design\CAD\Plan\_Sheets\04\_PL-01 - ALEXANDER AVE & 2ND ST.dwg, Layout:04\_PL-01 - ALEXANDER AVE AND 2ND ST - Apr 18, 2013 - 8:57am Plotted by: donalcolley