



**SAUSALITO CERTIFICATES OF PARTICIPATION OVERSIGHT COMMITTEE**

420 Litho Street, Sausalito, CA

**Certificates of Participation (CoP) Oversight Committee Meeting**

**May 10, 2016**

**6:00-6:30 PM Litho Street Patio**

**6:30PM-8:00PM City Hall Conference Room**

**A. Call To Order**

**B. Members**

Bob Gould  
John Lerner  
Bob Zadek

Mike Kelly  
Christene Scarpino

**C. Items from Public Not On Agenda**

**D. Discussion Items:**

	<b>Min.</b>
1. Visual Overview of Robin Sweeny Park	30
2. Administrative Tasks: Chair, Notes Format	05
3. Requested Materials: Carducci Invoice/Contract Timing	10
4. Robin Sweeny Park Invoices to Date	30
5. Dunphy Park Invoices to Date	10
6. Reporting to City Council	15
7. Confirm Meeting Schedule	05

**E. Adjournment**

1. Next regular scheduled meeting tentatively for: Thursday, June 2, 2016 at 6:30 p.m.

**How to obtain CoP Oversight Committee Agendas**

**Posted Agendas:** Agendas are posted at least 72 hours prior to the meeting time at the entrance to the City Hall at 420 Litho Street.

**Clerk's Office:** Go to the Administration Office at the City Hall at 420 Litho Street, Sausalito.

**Special Needs**

In compliance with the Americans with Disabilities Act (28 C.F.R. 35.102-35.104, ADA Title 11), if you need special assistance to participate in a City Council meeting, please call 289-4165 or 289-4106. Notification 48 hours prior to the meeting will enable the City to make reasonable arrangements to ensure accessibility to this meeting



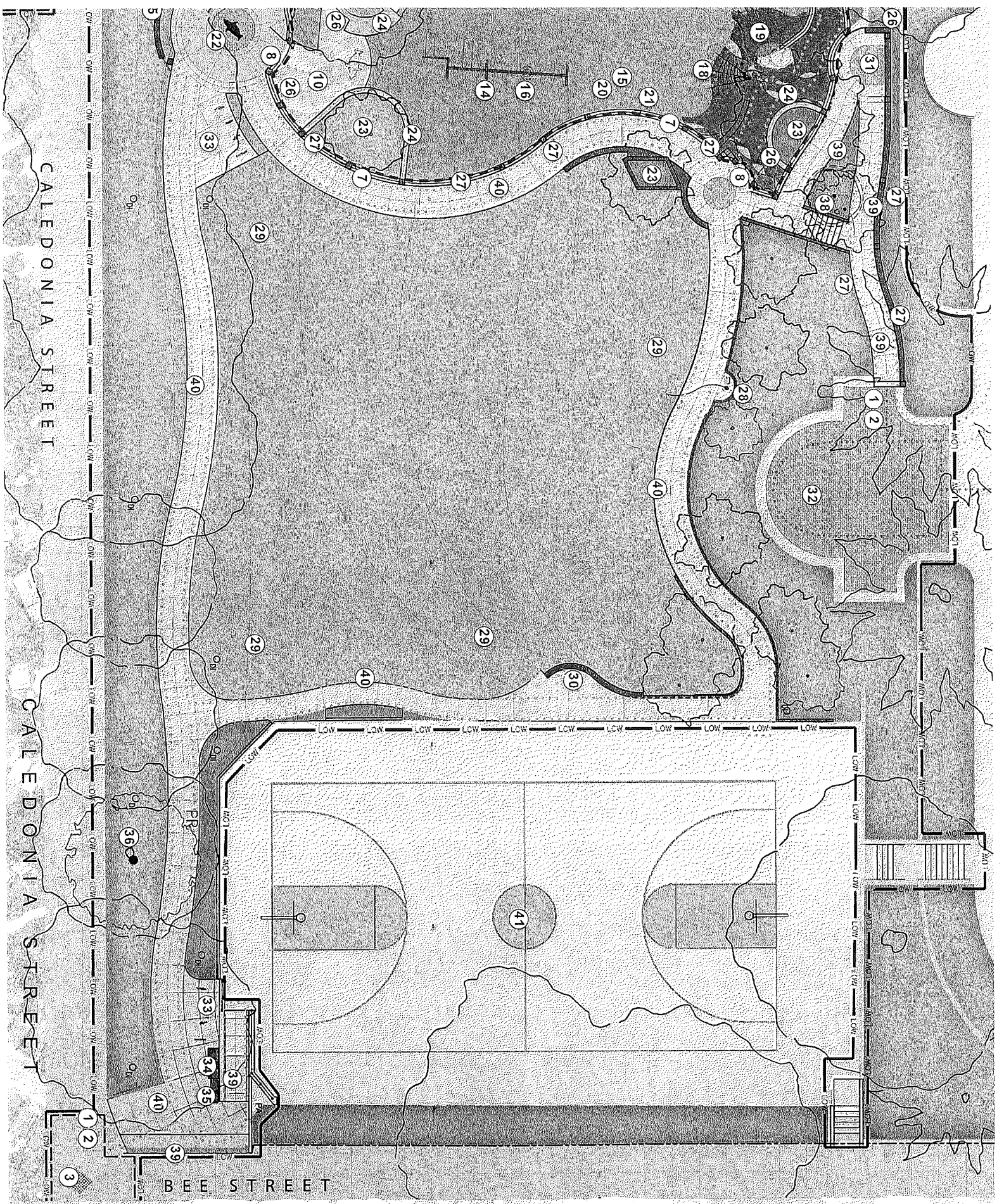

- 4 NEW ADA P...
- 3 EXISTING R...
- 6 ENTRANCE F...
- 7 42" HIGH OF...
- 8 RELOCATED T...
- 9 RELOCATED P...
- 10 RELOCATED P...
- 11 RELOCATED P...
- 12 SOUND PLA...
- 13 CITY HALL...
- 14 SWINGS CH...
- 15 TODDLER...
- 16 SYNTHETIC...
- 17 RUBBER PLA...
- 18 TREE SWIN...
- 19 CLIMB & S...
- 20 ELEMENT...
- 21 CLIMBING...
- 22 TRIPLE CH...
- 23 LITTLE WIL...
- 24 FOREST WIT...
- 25 MIWOK CAV...
- 26 SEAL ART

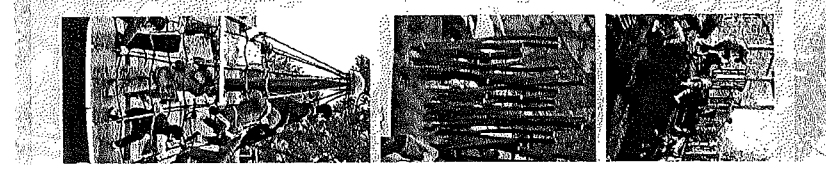

# General Ledger

## Budget Status

User: mpurcell  
 Printed: 5/3/2016 - 11:50 AM  
 Period: 1 to 14, 2016

# CITY OF SAUSALITO

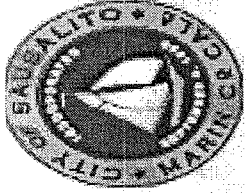

420 Lilloo Street  
 Sausalito, CA 94965  
 tel (415) 289-4100  
 fax (415) 289-4167

Account Number	Description	Budget Amount	Period Amount	YTD Amount	YTD Var	Encumbered Amount	Available	% Available
Fund 140	General Capital Proj							
Dept 140-410	Engineering	1,855,333.00	481.35	481.35	1,854,851.65	10,000.00	1,844,851.65	99.44
E93	Construction	0.00	0.00	0.00	0.00	0.00	0.00	0.00
140-410-4203-450	Dunphy Park							
140-410-4203-451	Dunphy Park (non-CoP)							
	E93 Sub Totals:	1,855,333.00	481.35	481.35	1,854,851.65	10,000.00	1,844,851.65	99.44
	Expense Sub Totals:	1,855,333.00	481.35	481.35	1,854,851.65	10,000.00	1,844,851.65	99.44
	Dept 410 Sub Totals:	1,855,333.00	481.35	481.35	1,854,851.65	10,000.00	1,844,851.65	99.44
	Fund Revenue Sub Totals:	0.00	0.00	0.00	0.00	0.00	0.00	0.00
	Fund Expense Sub Totals:	1,855,333.00	481.35	481.35	1,854,851.65	10,000.00	1,844,851.65	99.44
	Fund 140 Sub Totals:	1,855,333.00	481.35	481.35	1,854,851.65	10,000.00	1,844,851.65	99.44
	Revenue Totals:	0.00	0.00	0.00	0.00	0.00	0.00	0.00
	Expense Totals:	1,855,333.00	481.35	481.35	1,854,851.65	10,000.00	1,844,851.65	99.44
	Report Totals:	1,855,333.00	481.35	481.35	1,854,851.65	10,000.00	1,844,851.65	99.44

# General Ledger

## Detailed Trial Balance

User: mpurell  
 Printed: 05/03/2016 - 11:50AM  
 Period: 01 to 11, 2016

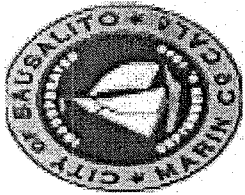

# CITY OF SAUSALITO

420 Litho Street  
 Sausalito, CA 94965  
 Tel (415) 289-4100  
 Fax (415) 289-4167

Account Number	Description	Budget	Beginning Balance	Debit This Period	Credit This Period	Ending Balance
140	General Capital Proj					
EXPENSE						
140-410	Engineering	1,855,333.00				
140-410-4203-450	Dumphy Park			481.35	0.00	
3/15/2016 AP	9 51 CALCARD - Cal Card US Bank					
	140-410-4203-450 Totals:		0.00	481.35	0.00	481.35
	Var: 1,854,851.65					
140-410-4203-451	Dumphy Park (non-CoP)	0.00				
	140-410-4203-451 Totals:		0.00	0.00	0.00	0.00
	140-410 EXPENSE Totals:	1,855,333.00	0.00	481.35	0.00	481.35
	EXPENSE Totals:	1,855,333.00	0.00	481.35	0.00	481.35
	140 Totals:	-1,855,333.00	0.00	481.35	0.00	481.35
	Report Totals:	-1,855,333.00	0.00	481.35	0.00	481.35

**Kent Basso**

---

**From:** Les James  
**Sent:** Wednesday, February 10, 2016 2:34 PM  
**To:** Kent Basso  
**Subject:** Fwd: Transaction Receipt from Lawn Nation for 481.35 (USD)

Sent from my iPhone

Begin forwarded message:

**From:** Auto-Receipt <[noreply@mail.authorize.net](mailto:noreply@mail.authorize.net)>  
**Date:** February 10, 2016 at 1:19:52 PM PST  
**To:** LES JAMES <[LJAMES@CI.SAUSALITO.CA.US](mailto:LJAMES@CI.SAUSALITO.CA.US)>  
**Subject:** Transaction Receipt from Lawn Nation for 481.35 (USD)  
**Reply-To:** Justin Roberts <[info@lawnnation.com](mailto:info@lawnnation.com)>

**Order Information**

Description: 100 NATIVE BENTGRASS + 100 NATIVE MOW FREE  
Invoice Number: 4222 PO Number: 000000  
Customer ID: JAMES

**Billing Information**

LES JAMES  
420 LITHO  
SAUSALITO, CA 94965  
USA  
[LJAMES@CI.SAUSALITO.CA.US](mailto:LJAMES@CI.SAUSALITO.CA.US)  
415-850-3891

**Shipping Information**

LES JAMES  
530 NEVADA STREET  
SAUSALITO, CA 94965  
USA

Shipping: 75.00 (USD)  
Tax: 28.35 (USD)  
**Total: 481.35 (USD)**

**Payment Information**

Date/Time: 10-Feb-2016 14:19:52 MST  
Transaction ID: 7971483472  
Payment Method: Visa xxxx6801  
Transaction Type: Purchase  
Auth Code: 085409

**Merchant Contact Information**

Lawn Nation  
Fair Oaks, CA 95628  
US  
[info@lawnnation.com](mailto:info@lawnnation.com)  
Important Links: Sod Care All Articles Ordering Terms

**COP Oversight Committee Discussion Notes from Christene for the  
May 5, 2016 Meeting**

**Committee Administrative Action Items**

**1. Confirm the wording within the COP documents for the Committee's scope** to "review the expenditure of the 2016 CoP revenues to ensure that funds were spent in accordance with the 2016 CoP and provide a recommendation to the City council on project revisions and/or requests for additional funding that require City Council approval". Found on page 7 & 10 of 102 "Preliminary Official Statement Dated December 4, 2015. Is this it or are there other pertinent areas for us to read? As follows:

*"Proceeds of the Certificates will be used to (a) finance capital improvements to the City's MLK campus and Robin Sweeny, Southview and Dunphy Parks, including, but not limited to, site improvements, roofing, exterior enclosure, plumbing, electrical systems and equipment upgrades (collectively, the "Project") and (b) pay delivery costs incurred in connection with the execution, delivery and sale of the Certificates. See "THE PROJECT".*

*THE PROJECT (page 10 of 102)*

*"Proceeds of the Certificates will be used to (a) finance the costs of the Project (estimated to total \$ \_\_\_\_\_) and (b) pay delivery costs incurred in connection with the execution, delivery and sale of the Certificates."*

*"The Project includes all public capital improvements relating to the City owned "MLK campus" located at 100 Ebbtide Avenue and three (3) City of Sausalito Public Parks: Robin Sweeney, Southview and Dunphy Park. Such public capital improvements include, but are not limited to: Site Improvements, Roofing, Exterior Enclosure, Plumbing, Electrical Systems and Equipment Upgrades as well as compliance with current ADA code".*

**2. Confirm the date that the COP expenses should be counted.**

As discussed, does the scope of our work begin when the CoP's closed?

What was that date? December 15? Or do we include expenses from the beginning?

**3. After #1 and #2 are agreed, the Committee to go over each invoice from Melanie to date to include in CoP expenses or not.** And then agree these to the account print out from Melanie from the City Accounting system. Expenses not under the CoP scope should be categorized and tracked separately, such as "Prior to CoP ", "ADA expense" or "City Funded Park Expense" etc. Confirm the RFP's went out last week for all other projects.

**4. Confirm a reporting process for each project to the City Council.** "The Committee shall issue quarterly written reports to the City Council and community on the expenditure of the 2016 CoP funds for the immediate preceding quarter."

How often and what to include in those reports. Suggestions were discussed at the April meeting. Include – CoP expenses, non-CoP expenses, ADA expenses, prior CoP Robin

Sweeney expenses? (Example for Robin Sweeney as we discussed attached – NUMBERS INCLUDED ARE NOT VERIFIED OR ACTUAL – just an example)

## Robin Sweeney as of x/x/xx

### 1. Expense Report

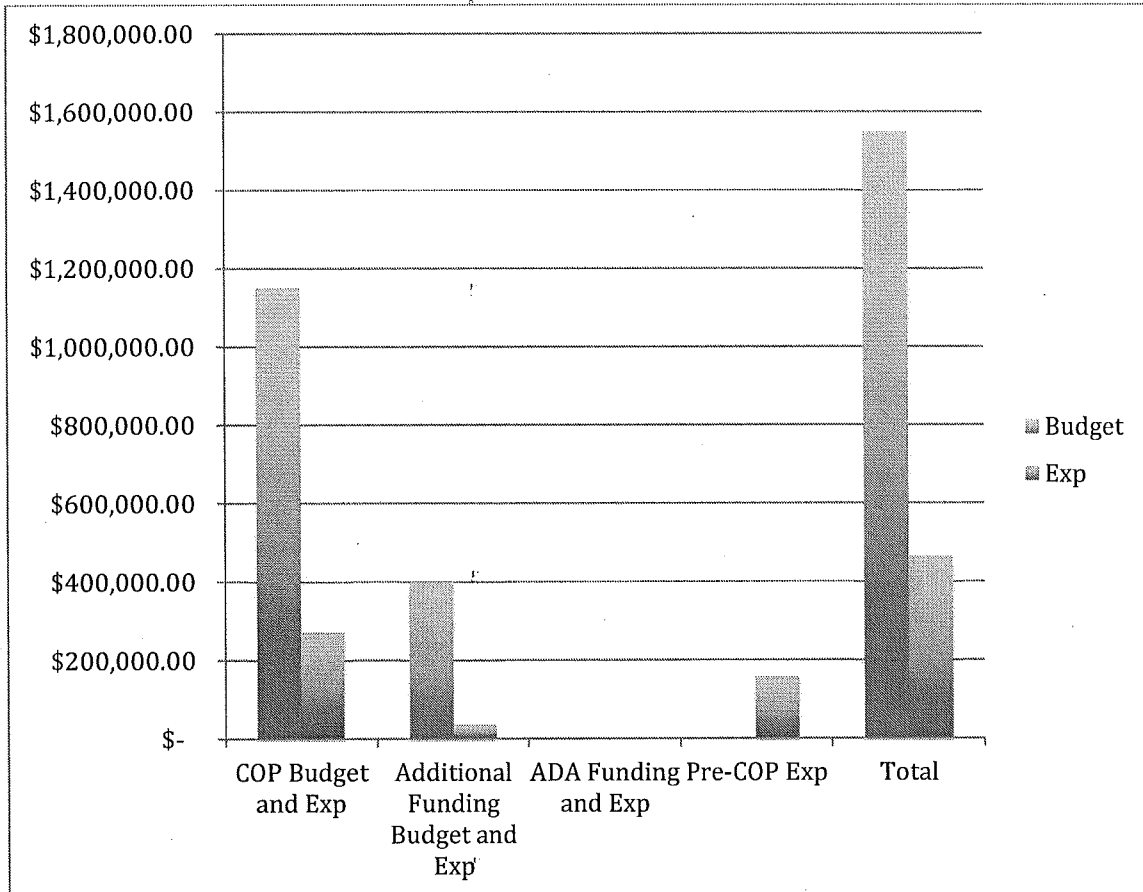

### 2. Robin Sweeney - X% Complete

### 3. Committee Conclusion:



# General Ledger

## Budget Status

User: npurcell  
 Printed: 5/3/2016 - 11:46 AM  
 Period: 9 to 11, 2016

# CITY OF SAUSALITO



420 Lirbo Street  
 Sausalito, CA 94965

tel (415) 289-4100  
 fax (415) 289-4167

Account Number	Description	Budget Amount	Period Amount	YTD Amount	YTD Var	Encumbered Amount	Available	% Available
Fund 140	General Capital Proj							
Dept 140-410	Engineering							
E04	Operations		219,532.42	288,413.26	1,345,314.74	1,539,640.10	-194,325.36	0.00
140-410-4134-450	Robin Sweeney Playground	1,633,728.00	37,513.28	37,513.28	362,486.72	0.00	362,486.72	90.62
140-410-4134-451	Robin Sweeney Park Non-CoP	400,000.00						
	E04 Sub Totals:	2,033,728.00	257,045.70	325,926.54	1,707,801.46	1,539,640.10	168,161.36	8.27
	Expense Sub Totals:	2,033,728.00	257,045.70	325,926.54	1,707,801.46	1,539,640.10	168,161.36	8.27
	Dept 410 Sub Totals:	2,033,728.00	257,045.70	325,926.54	1,707,801.46	1,539,640.10		
	Fund Revenue Sub Totals:	0.00	0.00	0.00	0.00	0.00	0.00	0.00
	Fund Expense Sub Totals:	2,033,728.00	257,045.70	325,926.54	1,707,801.46	1,539,640.10	168,161.36	8.27
	Fund 140 Sub Totals:	2,033,728.00	257,045.70	325,926.54	1,707,801.46	1,539,640.10		
	Revenue Totals:	0.00	0.00	0.00	0.00	0.00	0.00	0.00
	Expense Totals:	2,033,728.00	257,045.70	325,926.54	1,707,801.46	1,539,640.10	168,161.36	8.27
	Report Totals:	2,033,728.00	257,045.70	325,926.54	1,707,801.46	1,539,640.10		



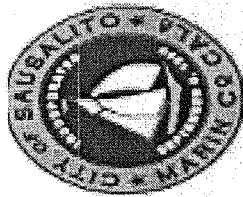

# CITY OF SAUSALITO

420 Libro Street  
Sausalito, CA 94965  
tel (415) 289-4100  
fax (415) 289-4167

## General Ledger

### Detailed Trial Balance

User: mpurcell  
Printed: 05/03/2016 - 11:47AM  
Period: 09 to 11, 2016

Account Number	Description	Budget	Beginning Balance	Debit This Period	Credit This Period	Ending Balance
140	General Capital Proj					
EXPENSE						
140-410	Engineering					
140-410-4134-450	Robin Sweeney Playground	1,633,728.00				
3/11/2016 AP 9	41 BAUMAN - Bauman Landscape, Inc. Ck# 144712			125,042.23	0.00	
3/11/2016 AP 9	41 CARDUCCI - Carducci & Associates, Inc Ck# 144717			246.00	0.00	
3/11/2016 AP 9	41 CARDUCCI - Carducci & Associates, Inc Ck# 144717			1,589.53	0.00	
3/11/2016 AP 9	41 RIEDINGE - Constance Riedinger dba Riedinger Ct Ck# 144746			35,484.00	0.00	
3/11/2016 AP 9	41 RIEDINGE - Constance Riedinger dba Riedinger Ct Ck# 144746			0.00	24,999.00	
3/11/2016 GL 9	48 R/C Sweeny non-COP from 4134-450			0.00	20,929.19	
3/14/2016 GL 9	49 CalCard-Fast Blue Reprographics R/C from 4134-450			0.00	1,379.94	
4/1/2016 AP 10	5 BAUMAN - Bauman Landscape, Inc. Ck# 144871			82,351.79	0.00	
4/1/2016 AP 10	5 CARDUCCI - Carducci & Associates, Inc Ck# 144874			3,940.75	0.00	
4/22/2016 AP 10	83 RIEDINGE - Constance Riedinger dba Riedinger Ct Ck# 145065			18,186.25	0.00	
140-410-4134-450 Totals:			68,880.84	266,840.55	47,308.13	288,413.26
Robin Sweeny Park Non-Cop		400,000.00				
3/11/2016 GL 9	48 R/C Sweeny non-COP from 4134-450			20,929.19	0.00	
3/14/2016 GL 9	49 CalCard-Fast Blue Reprographics R/C from 4134-450			1,379.94	0.00	
3/18/2016 AP 9	63 CARDUCCI - Carducci & Associates, Inc Ck# 144773			15,000.00	0.00	
4/18/2016 AP 10	68 CALCARD - Cal Card US Bank Ck# 145026			54.82	0.00	
4/22/2016 AP 10	83 MARINSN - Marin Scope News, Inc Ck# 145058			149.33	0.00	
140-410-4134-451 Totals:		400,000.00	0.00	37,513.28	0.00	37,513.28
140-410 EXPENSE Totals:		2,033,728.00	68,880.84	304,353.83	47,308.13	325,926.54
EXPENSE Totals:		2,033,728.00	68,880.84	304,353.83	47,308.13	325,926.54
140 Totals:		-2,033,728.00	68,880.84	304,353.83	47,308.13	325,926.54

Account Number	Description	Budget	Beginning Balance	Debit This Period	Credit This Period	Ending Balance
	Report Totals:	-2,033,728.00	68,880.84	304,353.83	47,308.13	325,926.54

# Riedinger Consulting

3030 Bridgeway Blvd, Suite 118  
 Sausalito, CA 94965-  
 Tel: (415) 331-2112 Fax: (415) 331-2122  
 info@riedingerconsulting.com  
 www.riedingerconsulting.com

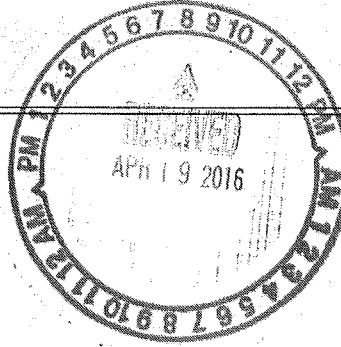

Mr. Jonathon Goldman  
 City of Sausalito  
 420 Litho Street  
 Sausalito, CA 94965

## Invoice

Invoice Date: Apr 14, 2016  
 Invoice Num: 2016-440  
 Billing Through: Mar 31, 2016

Robin Sweeny Park - PO #2032 (SausalitoPark:) - Managed by (CSR)

**Employee Title - Employee Name**      **Week Ending**    **Total Hours**    **Rate/ Hour**      **Amount**

Information Mgmt. Consultant

▶ Kimberly S. Maynard

3/13/2016      0.25      \$80.00      \$20.00

Principal

▶ Constance S. Riedinger

3/6/2016      2.75      \$240.00      \$660.00

3/13/2016      6.00      \$240.00      \$1,440.00

3/20/2016      10.75      \$240.00      \$2,580.00

3/27/2016      10.50      \$240.00      \$2,520.00

ProjMngr / Inspector

▶ Art Gibney

3/6/2016      7.50      \$175.00      \$1,312.50

3/13/2016      9.50      \$175.00      \$1,662.50

3/20/2016      9.75      \$175.00      \$1,706.25

3/27/2016      7.00      \$175.00      \$1,225.00

4/3/2016      7.00      \$175.00      \$1,225.00

Senior Consultant

▶ Greg Paulson

3/6/2016      2.00      \$130.00      \$260.00

3/13/2016      0.50      \$130.00      \$65.00

3/20/2016      21.25      \$130.00      \$2,762.50

3/27/2016      5.00      \$130.00      \$650.00

4/3/2016      0.75      \$130.00      \$97.50

Total Services: **\$18,186.25**

Amount Due This Invoice: **\$18,186.25**

This invoice is due upon receipt

### Account Summary

Services BTD	Expenses BTD	Last Inv Num	Last Inv Date	Last Inv Amt	Last Pay Amt	Prev Unpaid Amt
\$ 63,407.50	\$ 81.10	2016-434	3/4/2016	\$ 10,485.00	\$ 10,485.00	\$ 0.00

Total Amount Due Including This Invoice: **\$18,186.25**

Remit Payment to: Riedinger Consulting  
 3030 Bridgeway Blvd, Suite 118  
 Sausalito, CA 94965-  
 Tel: (415) 331-2112 Fax: (415) 331-2122

Item 4c Attachment 1

6/14/16 Page 1 of 2

Page 11 of 21

# Riedinger Consulting

3030 Bridgeway Blvd. Suite 118

Sausalito, CA 94965

Tel: (415) 331-2112 Fax: (415) 331-2122

info@riedingerconsulting.com

www.riedingerconsulting.com

## Invoice

Invoice Date: Apr 14, 2016

Invoice Num: 2016-440

Billing Through: Mar 31, 2016

Mr. Jonathon Goldman  
City of Sausalito  
420 Litho Street  
Sausalito, CA 94965

Robin Sweeny Park - PO #2032 (SausalitoPark:) - Managed by (CSR)

<u>Employee Title - Employee Name</u>	<u>Week Ending</u>	<u>Total Hours</u>	<u>Rate/ Hour</u>	<u>Amount</u>
---------------------------------------	--------------------	--------------------	-------------------	---------------

Payment due within 30 days of invoice date.

A late payment charge of 1.5% calculated monthly will be charged for payments not received by 6/14/16

# Riedinger Consulting

3030 Bridgeway Blvd. Suite 118  
 Sausalito, CA 94965-  
 Tel: (415) 331-2112 Fax: (415) 331-2122

## Hours Detail by Employee & Project with Memos

Printed on: 4/14/2016  
 Page 1 of 6

**Filters Used:**

- Time Entry Date: 3/1/2016 to 3/31/2016
- Time Entry Project ID: SausalitoPark: to SausalitoPark:

**Employee Name: Art Gibney**

Date	Activity ID	Description	Hours	B-Hrs	Billable	Approved
<b>SausalitoPark: - Robin Sweeny Park - PO #2032</b>						
TUES 3/1/2016	PCON:INSP	Construction Inspection	0.75	0.75	<input checked="" type="checkbox"/>	<input checked="" type="checkbox"/>
WED 3/2/2016	PCON:INSP	Construction Inspection	0.75	0.75	<input checked="" type="checkbox"/>	<input checked="" type="checkbox"/>
WED 3/2/2016	PCON:MISC	Construction Mgmt Miscellaneous	2.00	2.00	<input checked="" type="checkbox"/>	<input checked="" type="checkbox"/>
develop mock-up list						
THUR 3/3/2016	PCON:INSP	Construction Inspection	2.50	2.50	<input checked="" type="checkbox"/>	<input checked="" type="checkbox"/>
FRI 3/4/2016	PCON:INSP	Construction Inspection	1.50	1.50	<input checked="" type="checkbox"/>	<input checked="" type="checkbox"/>
MON 3/7/2016	PPM:TMTG	Project Mgmt - Team Meetings	3.50	3.50	<input checked="" type="checkbox"/>	<input checked="" type="checkbox"/>
TUES 3/8/2016	PCM:MIN	Prepare and Review Mtg Minutes & Agenda	2.25	2.25	<input checked="" type="checkbox"/>	<input checked="" type="checkbox"/>
Weekly meeting minutes writing						
TUES 3/8/2016	PCON:MISC	Construction Mgmt Miscellaneous	1.00	1.00	<input checked="" type="checkbox"/>	<input checked="" type="checkbox"/>
Review of submittals and ASIs						
TUES 3/8/2016	PCON:INSP	Construction Inspection	0.75	0.75	<input checked="" type="checkbox"/>	<input checked="" type="checkbox"/>
WED 3/9/2016	PCM:MIN	Prepare and Review Mtg Minutes & Agenda	2.00	2.00	<input checked="" type="checkbox"/>	<input checked="" type="checkbox"/>
MON 3/14/2016	PCON:INSP	Construction Inspection	0.50	0.50	<input checked="" type="checkbox"/>	<input checked="" type="checkbox"/>
MON 3/14/2016	PPM:MTG	Project Mgmt - Project Meeting	1.00	1.00	<input checked="" type="checkbox"/>	<input checked="" type="checkbox"/>
TUES 3/15/2016	PCON:INSP	Construction Inspection	0.75	0.75	<input checked="" type="checkbox"/>	<input checked="" type="checkbox"/>
THUR 3/17/2016	PCON:INSP	Construction Inspection	2.00	2.00	<input checked="" type="checkbox"/>	<input checked="" type="checkbox"/>
THUR 3/17/2016	PPM:MTG	Project Mgmt - Project Meeting	1.00	1.00	<input checked="" type="checkbox"/>	<input checked="" type="checkbox"/>
Meeting at Sweeny Park with Miller Pacific and City						
FRI 3/18/2016	PCON:INSP	Construction Inspection	1.50	1.50	<input checked="" type="checkbox"/>	<input checked="" type="checkbox"/>
FRI 3/18/2016	PCON:MISC	Construction Mgmt Miscellaneous	3.00	3.00	<input checked="" type="checkbox"/>	<input checked="" type="checkbox"/>
review of ASI's develop agenda items for weekly meeting etc.						
MON 3/21/2016	PCON:RVW	Constructability Review	0.50	0.50	<input checked="" type="checkbox"/>	<input checked="" type="checkbox"/>
MON 3/21/2016	PPM:TMTG	Project Mgmt - Team Meetings	2.50	2.50	<input checked="" type="checkbox"/>	<input checked="" type="checkbox"/>
weekly meeting Sweeny						
TUES 3/22/2016	PCON:MISC	Construction Mgmt Miscellaneous	1.25	1.25	<input checked="" type="checkbox"/>	<input checked="" type="checkbox"/>
WED 3/23/2016	PCON:MISC	Construction Mgmt Miscellaneous	0.75	0.75	<input checked="" type="checkbox"/>	<input checked="" type="checkbox"/>
reviwe of emails and plan updates						
WED 3/23/2016	PPM:TMTG	Project Mgmt - Team Meetings	1.00	1.00	<input checked="" type="checkbox"/>	<input checked="" type="checkbox"/>
site meeting with Vince and city						
FRI 3/25/2016	PCON:MISC	Construction Mgmt Miscellaneous	1.00	1.00	<input checked="" type="checkbox"/>	<input checked="" type="checkbox"/>
MON 3/28/2016	PPM:TMTG	Project Mgmt - Team Meetings	1.50	1.50	<input checked="" type="checkbox"/>	<input checked="" type="checkbox"/>
MON 3/28/2016	PCON:INSP	Construction Inspection	1.00	1.00	<input checked="" type="checkbox"/>	<input checked="" type="checkbox"/>
TUES 3/29/2016	PCON:INSP	Construction Inspection	1.50	1.50	<input checked="" type="checkbox"/>	<input checked="" type="checkbox"/>
WED 3/30/2016	PCON:INSP	Construction Inspection	1.50	1.50	<input checked="" type="checkbox"/>	<input checked="" type="checkbox"/>
THUR 3/31/2016	PCON:INSP	Construction Inspection	1.50	1.50	<input checked="" type="checkbox"/>	<input checked="" type="checkbox"/>
<b>Project Total:</b>			<b>40.75</b>	<b>40.75</b>		
<b>Employee Total:</b>			<b>40.75</b>	<b>40.75</b>		

Signature.....

# Riedinger Consulting

3030 Bridgeway Blvd. Suite 118  
 Sausalito, CA 94965-  
 Tel: (415) 331-2112 Fax: (415) 331-2122

## Hours Detail by Employee & Project with Memos

Printed on: 4/14/2016

Page 2 of 6

Filters Used:

- Time Entry Date: 3/1/2016 to 3/31/2016
- Time Entry Project ID: SausalitoPark: to SausalitoPark:

**Employee Name: Constance S. Riedinger**

Date	Activity ID	Description	Hours	B-Hrs	Billable	Approved
<b>SausalitoPark: - Robin Sweeny Park - PO #2032</b>						
WED 3/2/2016	PPM:EML	Project Mgmt - Emails Emails; mock up list, discuss w/ Art	0.50	0.50	<input checked="" type="checkbox"/>	<input checked="" type="checkbox"/>
THUR 3/3/2016	PCON:RFI	Requests for Information Field question re: permeable drain rock around perforated pipe	0.50	0.50	<input checked="" type="checkbox"/>	<input checked="" type="checkbox"/>
THUR 3/3/2016	PPM:MTG	Project Mgmt - Project Meeting Meet w/ Art to draft VE item list for mtg. on Monday	0.50	0.50	<input checked="" type="checkbox"/>	<input checked="" type="checkbox"/>
THUR 3/3/2016	PPM:EML	Project Mgmt - Emails Emails, spec/plan review	0.25	0.25	<input checked="" type="checkbox"/>	<input checked="" type="checkbox"/>
FRI 3/4/2016	PCST:BDG	Cost - Budget Estimates Cost spreadsheet review & mark edits	0.50	0.50	<input checked="" type="checkbox"/>	<input checked="" type="checkbox"/>
FRI 3/4/2016	PCON:MISC	Construction Mgmt Miscellaneous Finalize cost spreadsheet & email it and mock-up list to Loren	0.50	0.50	<input checked="" type="checkbox"/>	<input checked="" type="checkbox"/>
MON 3/7/2016	PCM:MIN	Prepare and Review Mtg Minutes & Agenda Meeting prep; print minutes, etc. to run meeting for Loren	0.75	0.75	<input checked="" type="checkbox"/>	<input checked="" type="checkbox"/>
MON 3/7/2016	PCON:SBM	Submittal Review Submittals, RFI's	0.50	0.50	<input checked="" type="checkbox"/>	<input checked="" type="checkbox"/>
MON 3/7/2016	PPM:TMTG	Project Mgmt - Team Meetings Weekly meeting	2.25	2.25	<input checked="" type="checkbox"/>	<input checked="" type="checkbox"/>
TUES 3/8/2016	PPM:SITE	Site Visit Look at storm drain inlet re: silty water	0.25	0.25	<input checked="" type="checkbox"/>	<input checked="" type="checkbox"/>
WED 3/9/2016	PPM:EML	Project Mgmt - Emails Emails re: pending cost adjustments	0.25	0.25	<input checked="" type="checkbox"/>	<input checked="" type="checkbox"/>
WED 3/9/2016	PCM:MIN	Prepare and Review Mtg Minutes & Agenda Meeting minutes - edit	0.75	0.75	<input checked="" type="checkbox"/>	<input checked="" type="checkbox"/>
THUR 3/10/2016	PCM:MIN	Prepare and Review Mtg Minutes & Agenda Finalize meeting minutes & attachments & email to Loren & Andy	1.25	1.25	<input checked="" type="checkbox"/>	<input checked="" type="checkbox"/>
TUES 3/15/2016	PPM:EML	Project Mgmt - Emails Emails - review	0.50	0.50	<input checked="" type="checkbox"/>	<input checked="" type="checkbox"/>
WED 3/16/2016	PPM:MTG	Project Mgmt - Project Meeting Discuss field items w/ Art	0.50	0.50	<input checked="" type="checkbox"/>	<input checked="" type="checkbox"/>
WED 3/16/2016	PPM:EML	Project Mgmt - Emails	0.25	0.25	<input checked="" type="checkbox"/>	<input checked="" type="checkbox"/>
WED 3/16/2016	PPM:MTG	Project Mgmt - Project Meeting Meeting re: retaining wall footing design	1.50	1.50	<input checked="" type="checkbox"/>	<input checked="" type="checkbox"/>
THUR 3/17/2016	PPM:MTG	Project Mgmt - Project Meeting Meeting re: retaining wall	1.00	1.00	<input checked="" type="checkbox"/>	<input checked="" type="checkbox"/>
THUR 3/17/2016	PPM:MTG	Project Mgmt - Project Meeting Go over RFP's to draft w/ Greg	0.25	0.25	<input checked="" type="checkbox"/>	<input checked="" type="checkbox"/>
THUR 3/17/2016	PCON:SBM	Submittal Review	1.00			

Item 4c Attachment 1  
6/14/16

Page 14 of 21

# Riedinger Consulting

3030 Bridgeway Blvd. Suite 118  
 Sausalito, CA 94965-  
 Tel: (415) 331-2112 Fax: (415) 331-2122

## Hours Detail by Employee & Project with Memos

Printed on: 4/14/2016

Page 3 of 6

Filters Used:

- Time Entry Date: 3/1/2016 to 3/31/2016
- Time Entry Project ID: SausalitoPark: to SausalitoPark:

**Employee Name: Constance S. Riedinger**

Date	Activity ID	Description	Hours	B-Hrs	Billable	Approved
<b>SausalitoPark: - Robin Sweeny Park - PO #2032</b>						
Emails & submittal review						
THUR	3/17/2016	PPM:TEL	Project Mgmt - Teleconference	0.50	0.50	<input checked="" type="checkbox"/>
Telecon w/ Angela re: schedule & submittals						
THUR	3/17/2016	PSCH:BASE	Project Sched-baseline	1.25	1.25	<input checked="" type="checkbox"/>
Review schedule						
FRI	3/18/2016	PPM:EML	Project Mgmt - Emails	0.50	0.50	<input checked="" type="checkbox"/>
Emails; print meeting minutes & revised retaining wall detail						
FRI	3/18/2016	PDEV:COM	Development - Change Order Mgmt	1.50	1.50	<input checked="" type="checkbox"/>
Review RFP drafts w/ Greg & Art						
FRI	3/18/2016	PPM:MTG	Project Mgmt - Project Meeting	1.00	1.00	<input checked="" type="checkbox"/>
Discuss field items & agenda items w/ Art						
FRI	3/18/2016	PPM:EML	Project Mgmt - Emails	0.50	0.50	<input checked="" type="checkbox"/>
FRI	3/18/2016	PPM:EML	Project Mgmt - Emails	0.50	0.50	<input checked="" type="checkbox"/>
MON	3/21/2016	PCM:MIN	Prepare and Review Mtg Minutes & Agenda	1.50	1.50	<input checked="" type="checkbox"/>
Review mtg. notes & revised retaining wall detail, etc.						
MON	3/21/2016	PCON:MISC	Construction Mgmt Miscellaneous	1.25	1.25	<input checked="" type="checkbox"/>
MON	3/21/2016	PPM:EML	Project Mgmt - Emails	0.50	0.50	<input checked="" type="checkbox"/>
MON	3/21/2016	PPM:TMTG	Project Mgmt - Team Meetings	2.50	2.50	<input checked="" type="checkbox"/>
Owner/Contractor meeting						
TUES	3/22/2016	PPM:MTG	Project Mgmt - Project Meeting	1.00	1.00	<input checked="" type="checkbox"/>
Review emails; discuss issues w/ Art; review RFP's 1-6						
TUES	3/22/2016	PDEV:COM	Development - Change Order Mgmt	1.25	1.25	<input checked="" type="checkbox"/>
Revise RFP's 1-4 per Loren's comments						
WED	3/23/2016	PPM:SITE	Site Visit	1.50	1.50	<input checked="" type="checkbox"/>
Field meeting re: walls; follow-up email re: ASI-03						
THUR	3/24/2016	PPM:EML	Project Mgmt - Emails	0.25	0.25	<input checked="" type="checkbox"/>
Email re: ASI-03						
FRI	3/25/2016	PPM:EML	Project Mgmt - Emails	0.25	0.25	<input checked="" type="checkbox"/>
FRI	3/25/2016	PPM:MTG	Project Mgmt - Project Meeting	0.50	0.50	<input checked="" type="checkbox"/>
Meet w/ Greg & Art to discuss tasks						
<b>Project Total:</b>			<b>30.00</b>	<b>30.00</b>		
<b>Employee Total:</b>			<b>30.00</b>	<b>30.00</b>		

Signature.....

# Riedinger Consulting

3030 Bridgeway Blvd. Suite 118  
 Sausalito, CA 94965-  
 Tel: (415) 331-2112 Fax: (415) 331-2122

## Hours Detail by Employee & Project with Memos

Printed on: 4/14/2016

Page 4 of 6

Filters Used:

- Time Entry Date: 3/1/2016 to 3/31/2016
- Time Entry Project ID: SausalitoPark: to SausalitoPark:

**Employee Name: Greg Paulson**

Date	Activity ID	Description	Hours	B-Hrs	Billable	Approved
<b>SausalitoPark: - Robin Sweeny Park - PO #2032</b>						
THUR 3/3/2016	PDEV:SBM	Development - Submittal Process Update submittal binder	0.50	0.50	<input checked="" type="checkbox"/>	<input checked="" type="checkbox"/>
FRI 3/4/2016	PCST:BDG	Cost - Budget Estimates Pending cost savings spreadsheet	1.00	1.00	<input checked="" type="checkbox"/>	<input checked="" type="checkbox"/>
FRI 3/4/2016	PCST:CO	Change Order Review Trex take-off	0.50	0.50	<input checked="" type="checkbox"/>	<input checked="" type="checkbox"/>
MON 3/7/2016	PCON:SPEC	Specification Review Concrete spec review	0.50	0.50	<input checked="" type="checkbox"/>	<input checked="" type="checkbox"/>
MON 3/14/2016	PDEV:SBM	Development - Submittal Process Create Project Submittal Log from Bauman submittal log	7.50	7.50	<input checked="" type="checkbox"/>	<input checked="" type="checkbox"/>
TUES 3/15/2016	PDEV:SBM	Development - Submittal Process Bauman submittals and submittal log update	1.75	1.75	<input checked="" type="checkbox"/>	<input checked="" type="checkbox"/>
THUR 3/17/2016	PDEV:SBM	Development - Submittal Process Submittal Log Update	1.00	1.00	<input checked="" type="checkbox"/>	<input checked="" type="checkbox"/>
THUR 3/17/2016	PDEV:COM	Development - Change Order Mgmt RFPs 1-4, CO Log	2.75	2.75	<input checked="" type="checkbox"/>	<input checked="" type="checkbox"/>
THUR 3/17/2016	PDEV:COM	Development - Change Order Mgmt Turf take-off for ASI-03 Sand Edging	2.00	2.00	<input checked="" type="checkbox"/>	<input checked="" type="checkbox"/>
THUR 3/17/2016	PSCH:BASE	Project Sched-baseline Review Project Baseline Schedule	0.50	0.50	<input checked="" type="checkbox"/>	<input checked="" type="checkbox"/>
FRI 3/18/2016	PDEV:COM	Development - Change Order Mgmt RFPs 1-5 + CO Log	4.25	4.25	<input checked="" type="checkbox"/>	<input checked="" type="checkbox"/>
FRI 3/18/2016	PDEV:SBM	Development - Submittal Process Submittals, Specs, & RFPs	1.50	1.50	<input checked="" type="checkbox"/>	<input checked="" type="checkbox"/>
MON 3/21/2016	PCST:CO	Change Order Review Footing Change and Quantity Difference	1.00	1.00	<input checked="" type="checkbox"/>	<input checked="" type="checkbox"/>
MON 3/21/2016	PDEV:COM	Development - Change Order Mgmt RFP 6 - Retaining Wall Footing	0.50	0.50	<input checked="" type="checkbox"/>	<input checked="" type="checkbox"/>
MON 3/21/2016	PDES:CRD	Design - Team Coordination RFIs / ASIs	0.75	0.75	<input checked="" type="checkbox"/>	<input checked="" type="checkbox"/>
MON 3/21/2016	PDEV:COM	Development - Change Order Mgmt RFPs 1 - 6	1.25	1.25	<input checked="" type="checkbox"/>	<input checked="" type="checkbox"/>
TUES 3/22/2016	PDEV:COM	Development - Change Order Mgmt RFP 3 ; ASI 3 Qty	0.50	0.50	<input checked="" type="checkbox"/>	<input checked="" type="checkbox"/>
TUES 3/22/2016	PDEV:COM	Development - Change Order Mgmt RFPs 1-6	1.00	1.00	<input checked="" type="checkbox"/>	<input checked="" type="checkbox"/>
MON 3/28/2016	PDEV:SBM	Development - Submittal Process Submittals 4a & 22	0.25	0.25	<input checked="" type="checkbox"/>	<input checked="" type="checkbox"/>
WED 3/30/2016	PSCH:BASE	Project Sched-baseline	0.25	0.25	<input checked="" type="checkbox"/>	<input checked="" type="checkbox"/>

Rem 4c Attachment 1  
6/14/16

Page 16 of 21



# Riedinger Consulting

3030 Bridgeway Blvd. Suite 118  
Sausalito, CA 94965-  
Tel: (415) 331-2112 Fax: (415) 331-2122

## Hours Detail by Employee & Project with Memos

Printed on: 4/14/2016

Page 5 of 6

### Filters Used:

- Time Entry Date: 3/1/2016 to 3/31/2016
- Time Entry Project ID: SausalitoPark: to SausalitoPark:

**Employee Name: Greg Paulson**

Date	Activity ID	Description	Hours	B-Hrs	Billable	Approved
------	-------------	-------------	-------	-------	----------	----------

SausalitoPark: - Robin Sweeny Park - PO #2032

convert baseline from MPP to PDF

THUR 3/31/2016	PSCH:BASE	Project Sched-baseline	0.25	0.25	<input checked="" type="checkbox"/>	<input checked="" type="checkbox"/>
Schedule format						

Project Total: 29.50 29.50

Employee Total: 29.50 29.50

Signature.....

**Riedinger Consulting**

3030 Bridgeway Blvd. Suite 118  
 Sausalito, CA 94965-  
 Tel: (415) 331-2112 Fax: (415) 331-2122

Hours Detail by Employee & Project with Memos

Printed on: 4/14/2016  
 Page 6 of 6

Filters Used:

- Time Entry Date: 3/1/2016 to 3/31/2016
- Time Entry Project ID: SausalitoPark: to SausalitoPark:

**Employee Name: Kimberly S. Maynard**

Date	Activity ID	Description	Hours	B-Hrs	Billable	Approved
<b>SausalitoPark: - Robin Sweeny Park - PO #2032</b>						
TUES 3/8/2016	PADM:DOC	Project Admin - Document Control	0.25	0.25	<input checked="" type="checkbox"/>	<input checked="" type="checkbox"/>

Make RFI binder, and tabs, for CSR

<b>Project Total:</b>	<b>0.25</b>	<b>0.25</b>
<b>Employee Total:</b>	<b>0.25</b>	<b>0.25</b>

Signature.....

RECEIVED  
CITY OF SAUSALITO

APR 19 2016

DEPARTMENT OF  
PUBLIC WORKS



3030 Bridgeway  
Suite 118  
Sausalito, CA 94965  
Ph 415.331.2112  
Fx 415.331.2122

April 18, 2016

Mr. Jonathon Goldman  
Director of Public Works  
City of Sausalito  
420 Litho Street  
Sausalito, CA 94965

Re: City of Sausalito / Robin Sweeny Park Project – P.O.#2032  
Invoice # 2016-440: March 2016

Dear Jonathon,

Attached is a summary of the professional fees incurred during the period from March 1 through 31, 2016 on the above referenced project. During this period, we performed the following tasks:

- Attended weekly Project Meetings on 3/7, 3/14, 3/21, and 3/28.
- Ongoing construction inspection and resolution of field issues.
- Created submittal log and reviewed selected submittals.
- Created list of required mock-ups.
- Prepared spreadsheet of pending cost adjustments for value engineering items discussed to date.
- Ran 3/7 meeting and prepared meeting minutes for Loren.
- On 3/16 and 3/17, met re: retaining wall footing design change.
- Teleconference with Angela on 3/17 regarding baseline schedule, outstanding submittals, and forthcoming RFP's.
- Drafted RFP's 1-6 and emailed to Loren.
- On 3/23, attended field meeting re: walls.
- Reviewed and provided comments on ASI's from Carducci.
- Emails and telecons with City staff, Carducci, and Bauman.

Mr. Jonathon Goldman, Dir. of Public Works  
Robin Sweeny Park Project  
April 18, 2016  
Pg. 2

If you have any questions, please call. We look forward to working with the City to achieve a successful project.

Sincerely,

A handwritten signature in cursive script that reads "Constance Riedinger". The signature is fluid and extends to the right.

CONSTANCE RIEDINGER, P.E.

Mike Langford

5

**From:** GoDaddy <donotreply@godaddy.com>  
**Sent:** Friday, February 26, 2016 10:49 AM  
**To:** Mike Langford  
**Subject:** MIke, your order confirmation is inside



24/7 Support: (480) 505-8877

Mike Langford — Customer Number: 33592242

# Thank you.

Here's your confirmation for order number 942794966. Review your receipt and [get started](#) using your products.

Product	Quantity	Term	Price
.COM Bulk Domain Renewal <a href="#">ROBINSWEENYPARK.COM</a> <a href="#">Manage</a>	1 Domain	2 Years	\$26.02
.INFO Bulk Domain Renewal <a href="#">ROBINSWEENYPARK.INFO</a> <a href="#">Manage</a>	1 Domain	2 Years	\$28.80
.COM Bulk Domain Renewal <a href="#">SAUSALITOFERRYLANDING.COM</a> <a href="#">Manage</a>	1 Domain	2 Years	\$30.34
.INFO Bulk Domain Renewal <a href="#">SAUSALITOFERRYLANDING.INFO</a>	1 Domain	2 Years	\$30.34