

VIA ELECTRONIC MAIL



August 18, 2016

Mr. Adam Politzer
City Manager
City of Sausalito
429 Litho Street
Sausalito, CA 94965

Re: Golden Gate Ferry: Sausalito Terminal Vessel Boarding Rehabilitation Project

Dear Mr. Politzer:

The Golden Gate Bridge, Highway and Transportation District's (District) Golden Gate Ferry Sausalito Terminal Vessel Boarding Rehabilitation Project ("Project") is intended to replace the aging District-owned vessel boarding structures with structures that comply with the current design codes and guidelines and are fully accessible to individuals with disabilities, as mandated by both state and federal law.

As you know, in February, 2015, the District offered to voluntarily participate in a process that would allow City residents and officials to weigh in on the design of the facility, while still conforming to the 45-day review process outlined in Section 5.4 of the of the December 1, 1995 lease between the City and the District (the "Lease"). The submittal of Project plans to the City on March 24, 2015 triggered the 45-day period under the Lease for the City to consent to or reject such plans. On June 6, 2015, the City informed the District that it would not consent to the proposed design of the project.

Over the next six months, the District participated in multiple meetings with interested stakeholders in an attempt to refine the design in a manner that would be acceptable to the community. In March 2016, the District submitted a proposed design to address these community concerns. In addition, District staff appeared before joint meetings of the Planning Commission and Historic Landmarks Board on March 16 and 29, 2016, and the Sustainability Commission on March 17, 2016. Following those meetings, from April 2016 through July 2016, the District made multiple submittals to the City's peer reviewer and answered numerous questions.

With this letter, the District is submitting, as a supplement to the plans submitted on March 24, 2015, additional drawings and renderings that modify the original proposal in order to satisfy the requests of the City and its residents. At this point, the District requests that the City initiate another 45-day review under Section 5.4 of the lease and decide whether or not it will consent to the revised project design.

Correspondence to Mr. Adam Politzer
August 18, 2016
Page 2

Please note that the District has delayed this project for over 17 months while seeking agreement from the City for this project, which will provide a fully-accessible facility in place of one that is badly in need of replacement.

Sincerely,



Denis J. Mulligan
General Manager

Attachments: Sausalito Ferry Terminal Improvements - Updated Drawing Set
Sausalito Ferry Terminal Improvements Project - Graphics and Photo Renderings

cc: Mary Wagner, City Attorney



Golden Gate Bridge, Highway and Transportation District

SAUSALITO FERRY TERMINAL IMPROVEMENTS

CONTRACT NO. 2010-FT-3

(HALF-SIZE)

CUT SCALE ON DRAWINGS IN HALF

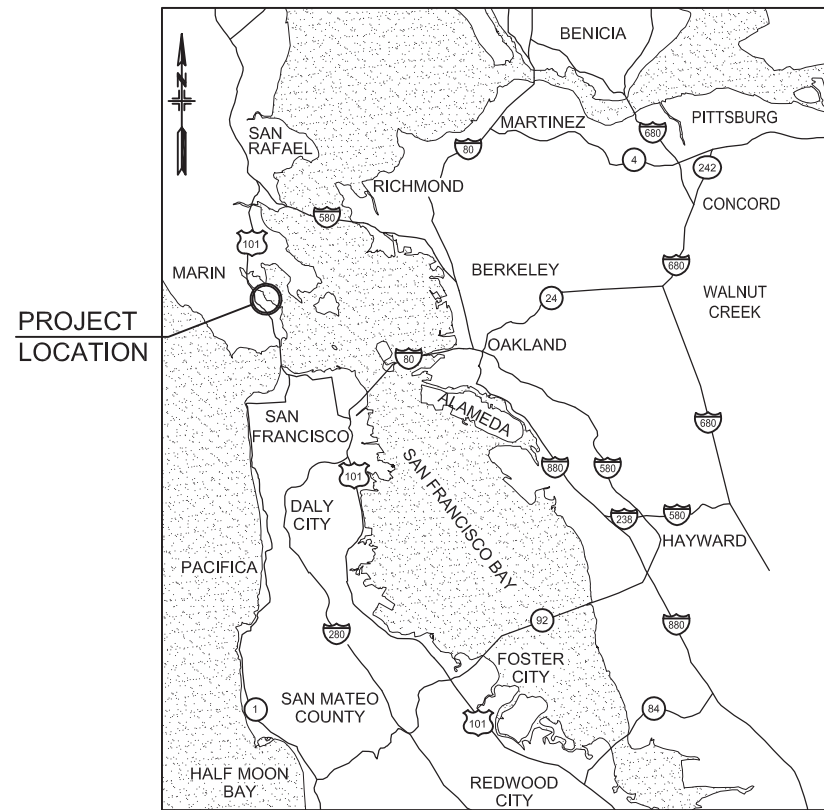

VICINITY MAP
SCALE IN MILES
0 5 10

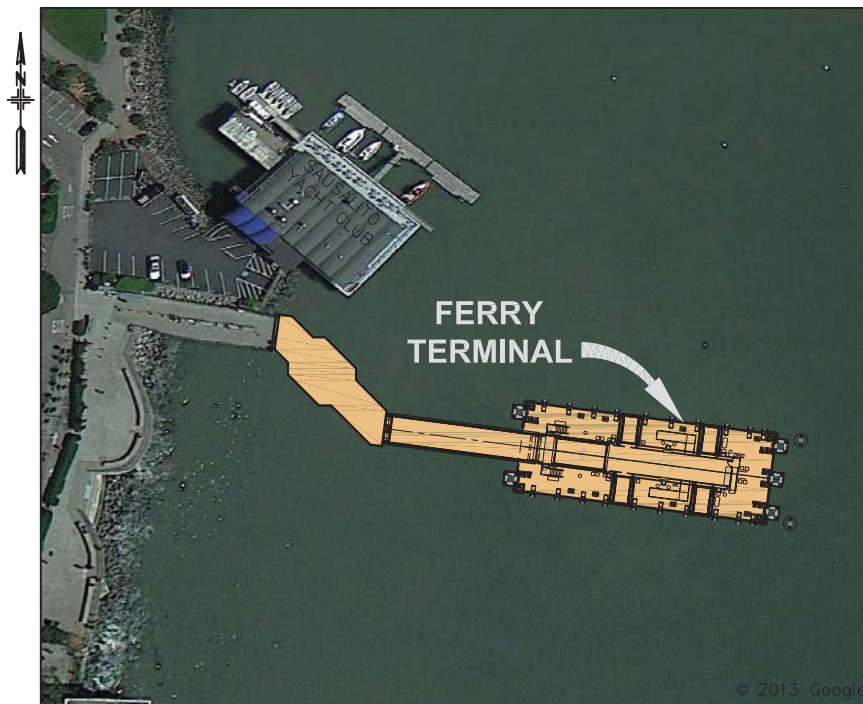

SAUSALITO FERRY TERMINAL
NO SCALE



LOCATION PLAN
NO SCALE

The attached drawings are revised drawings to the March 2015 drawing set submitted to the City of Sausalito

**CITY OF SAUSALITO SUBMITTAL
NOT FOR CONSTRUCTION
AUGUST 18, 2016**

GOLDEN GATE BRIDGE
HIGHWAY & TRANSPORTATION DISTRICT
BOX 9000, PRESIDIO STATION
SAN FRANCISCO, CA 94129

APN 065-073-05 AND APN 065-133-22

DESIGN	BY AB	CHECKED BJ	BO JENSEN PROJECT MANAGER
DRAWN	BY TE	CHECKED	
QUANTITIES	BY	CHECKED	

moffatt & nichol
2185 N. California Blvd., Suite 500
Walnut Creek, CA 94596

REGISTERED CIVIL ENGINEER
07/18/2014
PLANS APPROVAL DATE

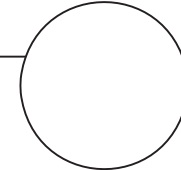

NO. REVISIONS	BY	DATE
CONTRACT NO. 2011-B-2	DRAWING NO.	GP.1
CADD FILE 703800_GP.1.dwg	DATE	

APPROVED BY

DISTRICT ENGINEER
DATE

PROJECT TITLE
GOLDEN GATE SAUSALITO FERRY TERMINAL IMPROVEMENTS

SHEET TITLE
TITLE SHEET



P:\7038 GGBD Ferry Terminals\500 Cadd\560 Working\SAUSALITO\CADD\703800_GP.1.dwg Mar 23, 2015 4:13pm

ORIGINAL SCALE IN INCHES FOR REDUCED PLANS
0 1 2 3

**REVISED FROM
MARCH 2015
SUBMITTAL**

REV. NO.	SHEET NO.	TOTAL SHEETS
---	---	---

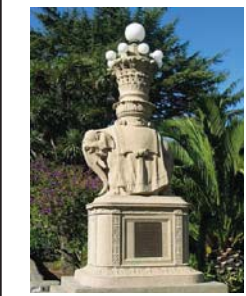
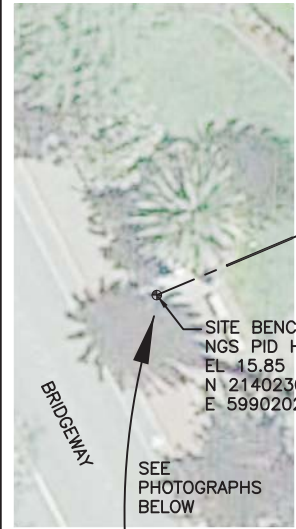
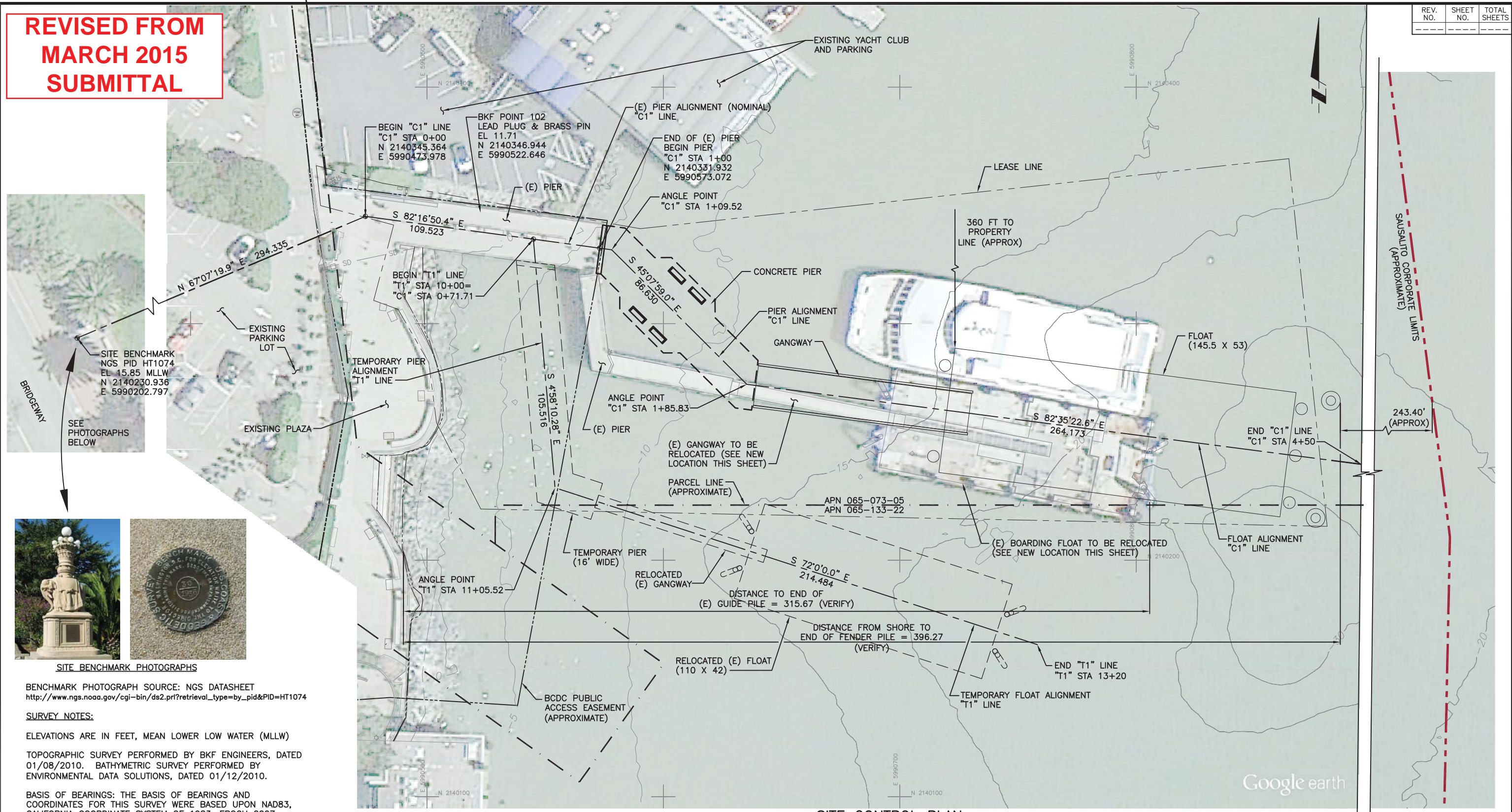

SITE BENCHMARK PHOTOGRAPHS

BENCHMARK PHOTOGRAPH SOURCE: NGS DATASHEET
http://www.ngs.noaa.gov/cgi-bin/ds2.pl?retrieval_type=by_pid&PID=HT1074

SURVEY NOTES:
ELEVATIONS ARE IN FEET, MEAN LOWER LOW WATER (MLLW)
TOPOGRAPHIC SURVEY PERFORMED BY BKF ENGINEERS, DATED 01/08/2010. BATHYMETRIC SURVEY PERFORMED BY ENVIRONMENTAL DATA SOLUTIONS, DATED 01/12/2010.

BASIS OF BEARINGS: THE BASIS OF BEARINGS AND COORDINATES FOR THIS SURVEY WERE BASED UPON NAD83, CALIFORNIA COORDINATE SYSTEM OF 1983, EPOCH 2007.

BENCHMARK: FOUND DISK STAMPED "30 1936" HAVING THE NGS PID HT1074 & NOAA VM #8414, PER TIDAL BENCHMARK REPORT #9414806, AND AN ELEVATION ABOVE MEAN LOWER LOW WATER IN US SURVEY FEET OF 15.85'.

GOLDEN GATE BRIDGE
HIGHWAY & TRANSPORTATION DISTRICT
BOX 9000, PRESIDIO STATION
SAN FRANCISCO, CA 94129

APN 065-073-05 AND APN 065-133-22

DESIGN	BY NN	CHECKED BJ	BO JENSEN PROJECT MANAGER
DRAWN	BY NN	CHECKED	
QUANTITIES	BY	CHECKED	

moftatt & nichol
2185 N. California Blvd., Suite 500
Walnut Creek, CA 94596

REGISTERED CIVIL ENGINEER
07/18/2014
PLANS APPROVAL DATE

For Discussion Purposes Only

NO. REVISIONS	BY	DATE
CONTRACT NO. 2011-B-2	DRAWING NO.	C.1
CADD FILE 703800_C.1.dwg	DATE	

APPROVED BY

DISTRICT ENGINEER
DATE

PROJECT TITLE
GOLDEN GATE SAUSALITO FERRY TERMINAL IMPROVEMENTS
SHEET TITLE
SITE CONTROL PLAN

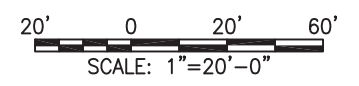

P:\7038 GGBD Ferry Terminals\500 Cadd\560 Working\SAUSALITO\CADD\703800_C.1.dwg May 04, 2016 - 3:21pm

REVISED FROM
MARCH 2015
SUBMITTAL

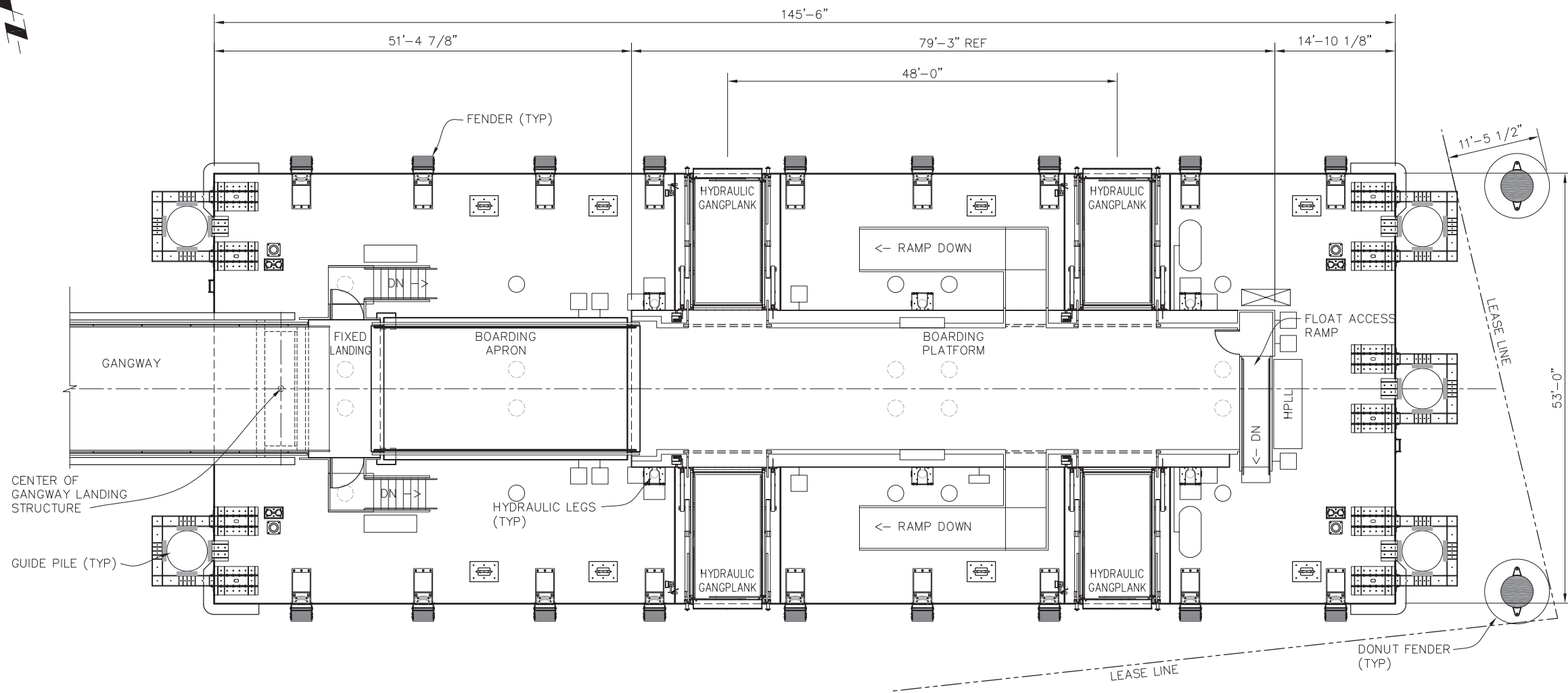

FLOAT PLAN
SCALE: 1/8" = 1'-0"

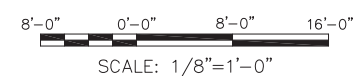

P:\7038 GGBD Ferry Terminals\500 Cadd\560 Working\SAUSALITO\CADD\703800_S1.2.dwg Mar 01, 2016 - 1:41pm

GOLDEN GATE BRIDGE
HIGHWAY & TRANSPORTATION DISTRICT
BOX 9000, PRESIDIO STATION
SAN FRANCISCO, CA 94129

APN 065-073-05 AND APN 065-133-22

DESIGN	BY MJW	CHECKED BJ	BO JENSEN PROJECT MANAGER
DRAWN	BY TE	CHECKED	
QUANTITIES	BY	CHECKED	



2185 N. California Blvd., Suite 500
Walnut Creek, CA 94596

REGISTERED CIVIL ENGINEER
07/18/2014
PLANS APPROVAL DATE

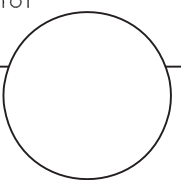

NO. REVISIONS	BY	DATE
CONTRACT NO. 2011-B-2	DRAWING NO.	S1.2
CADD FILE 703800_S1.2.dwg	DATE	

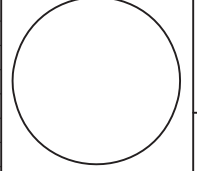
APPROVED BY

DISTRICT ENGINEER
DATE

PROJECT TITLE
GOLDEN GATE SAUSALITO FERRY TERMINAL IMPROVEMENTS

SHEET TITLE
145'-6 x 53'-0" FLOAT PLAN



ORIGINAL SCALE IN INCHES FOR REDUCED PLANS

**REVISED FROM
MARCH 2015
SUBMITTAL**

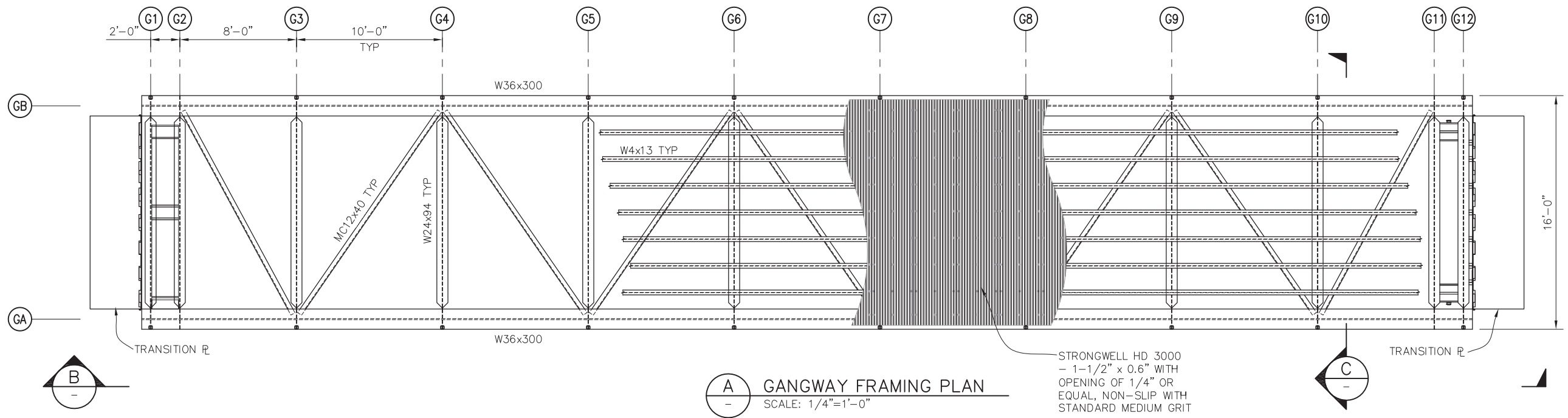

A GANGWAY FRAMING PLAN
SCALE: 1/4"=1'-0"

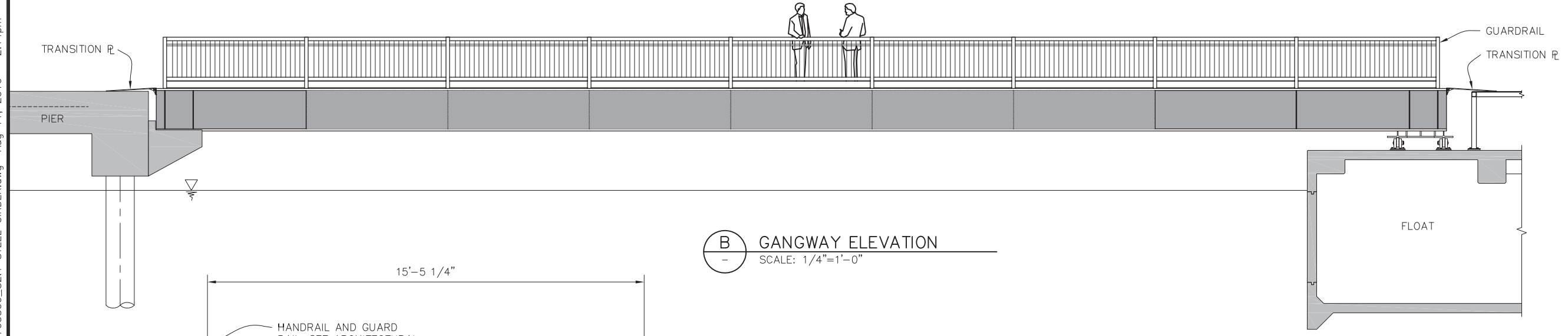

B GANGWAY ELEVATION
SCALE: 1/4"=1'-0"

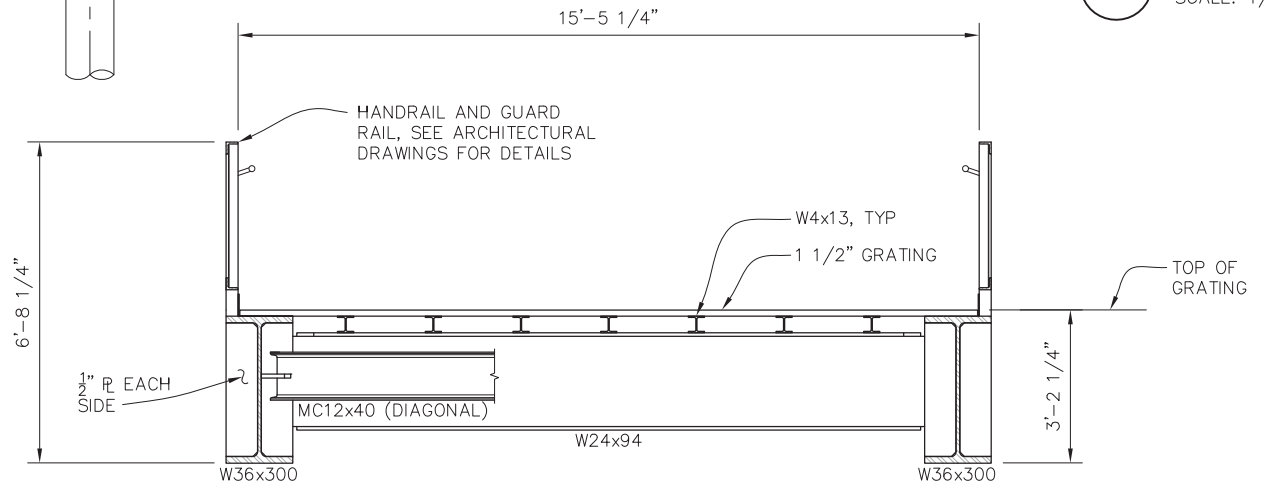

STEEL GIRDER CROSS SECTION
SCALE: 1/2" = 1'-0"

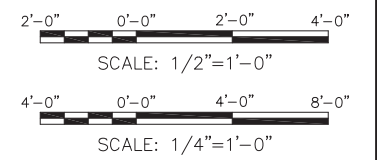

GOLDEN GATE BRIDGE
HIGHWAY & TRANSPORTATION DISTRICT
BOX 9000, PRESIDIO STATION
SAN FRANCISCO, CA 94129

APN 065-073-05 AND APN 065-133-22

DESIGN	BY AB	CHECKED BJ	BO JENSEN PROJECT MANAGER
DRAWN	BY EBD	CHECKED	
QUANTITIES	BY	CHECKED	

moffatt & nichol
2185 N. California Blvd., Suite 500
Walnut Creek, CA 94596

REGISTERED CIVIL ENGINEER
07/18/2014
PLANS APPROVAL DATE

NO. REVISIONS	BY	DATE
CONTRACT NO. 2011-B-2	DRAWING NO.	
CADD FILE 703800_S2.1 STEEL GIRDER.dwg	DATE	

APPROVED BY

DISTRICT ENGINEER

PROJECT TITLE
GOLDEN GATE SAUSALITO FERRY TERMINAL IMPROVEMENTS

SHEET TITLE
GANGWAY STEEL GIRDER CONCEPT PLAN AND ELEVATION



P:\7038 GGBD Ferry Terminals\500 Cadd\560 Working\SAUSALITO\CADD\703800_S2.1 STEEL GIRDER.dwg Aug 11, 2016 2:14pm

**REVISED FROM
MARCH 2015
SUBMITTAL**

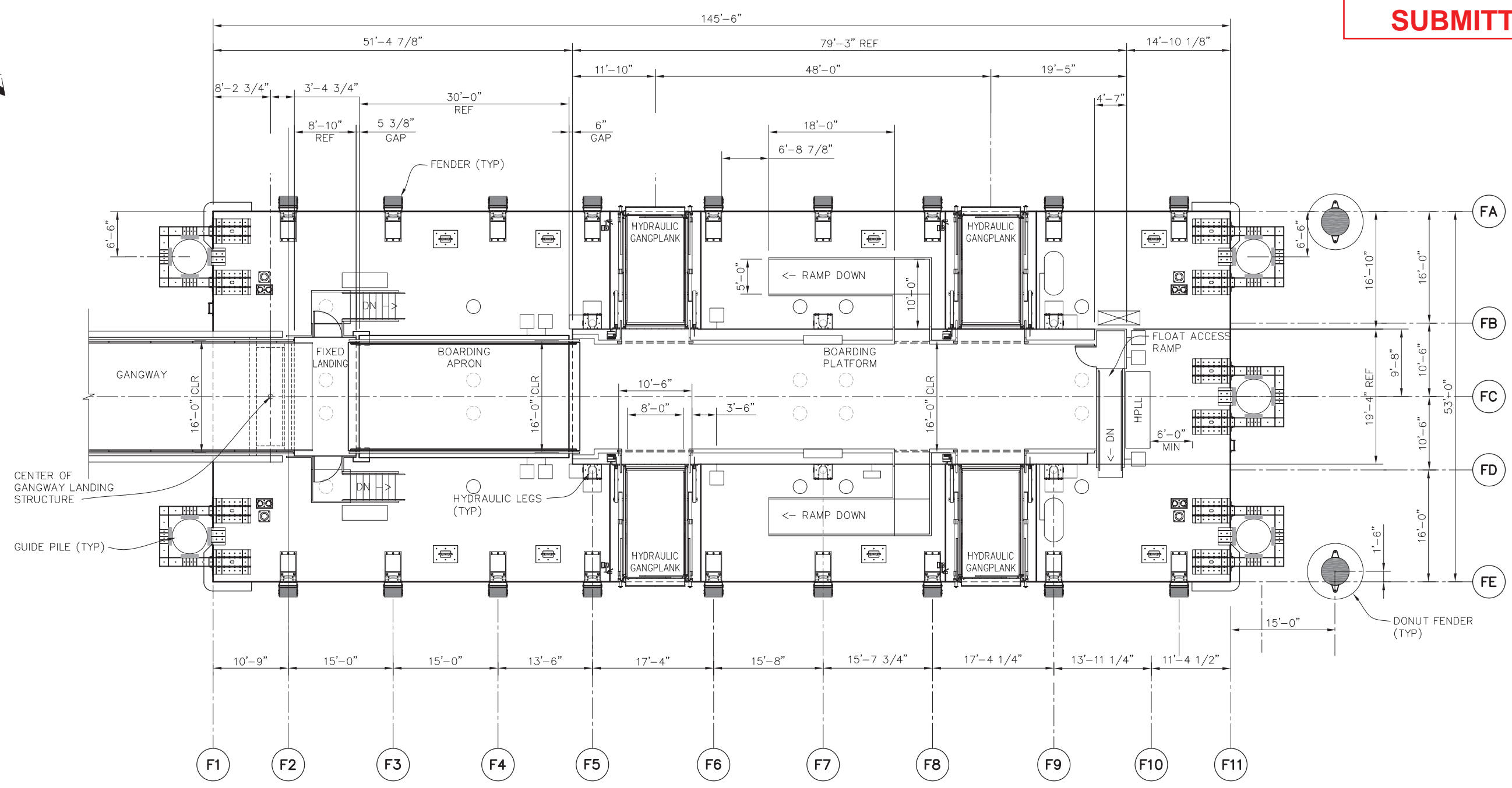

FLOAT DIMENSION PLAN
SCALE: 1/8" = 1'-0"

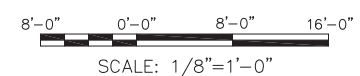

P:\7038 GGBD Ferry Terminals\500 Cadd\560 Working\SAUSALITO\CADD\703800_S1.2.dwg Feb 26, 2016 - 12:09pm

GOLDEN GATE BRIDGE
HIGHWAY & TRANSPORTATION DISTRICT
BOX 9000, PRESIDIO STATION
SAN FRANCISCO, CA 94129

APN 065-073-05 AND APN 065-133-22

DESIGN	BY MJW	CHECKED BJ	BO JENSEN PROJECT MANAGER
DRAWN	BY TE	CHECKED	
QUANTITIES	BY	CHECKED	

moffatt & nichol
2185 N. California Blvd., Suite 500
Walnut Creek, CA 94596

REGISTERED CIVIL ENGINEER
07/18/2014
PLANS APPROVAL DATE

NO. REVISIONS	BY	DATE
CONTRACT NO. 2011-B-2	DRAWING NO.	S1.2
CADD FILE 703800_S1.2.dwg	DATE	

APPROVED BY

DISTRICT ENGINEER
DATE

PROJECT TITLE
**GOLDEN GATE SAUSALITO FERRY TERMINAL
IMPROVEMENTS**

SHEET TITLE
**145'-6 x 53'-0" FLOAT
DIMENSION PLAN**



ORIGINAL SCALE IN INCHES
FOR REDUCED PLANS



GOLDEN GATE BRIDGE HIGHWAY & TRANSPORTATION DISTRICT

**SAUSALITO FERRY TERMINAL IMPROVEMENTS PROJECT
GRAPHICS AND PHOTO RENDERINGS**

AUGUST 18, 2016

AERIAL VIEW OF SITE

EXISTING

PROPOSED

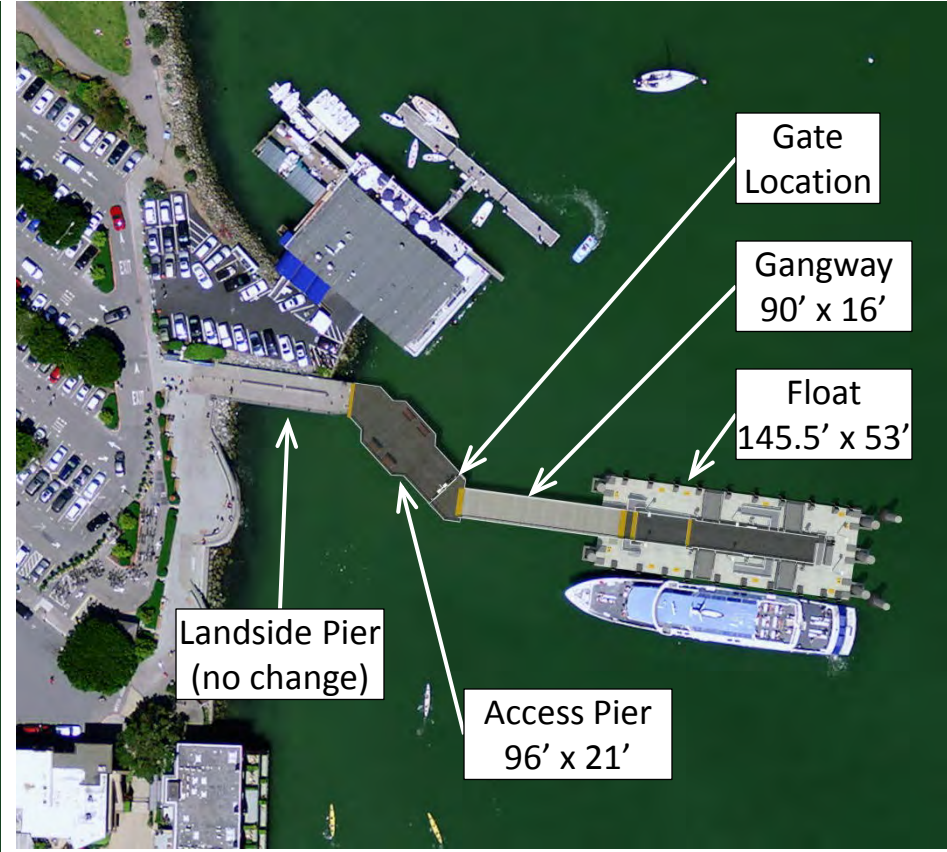
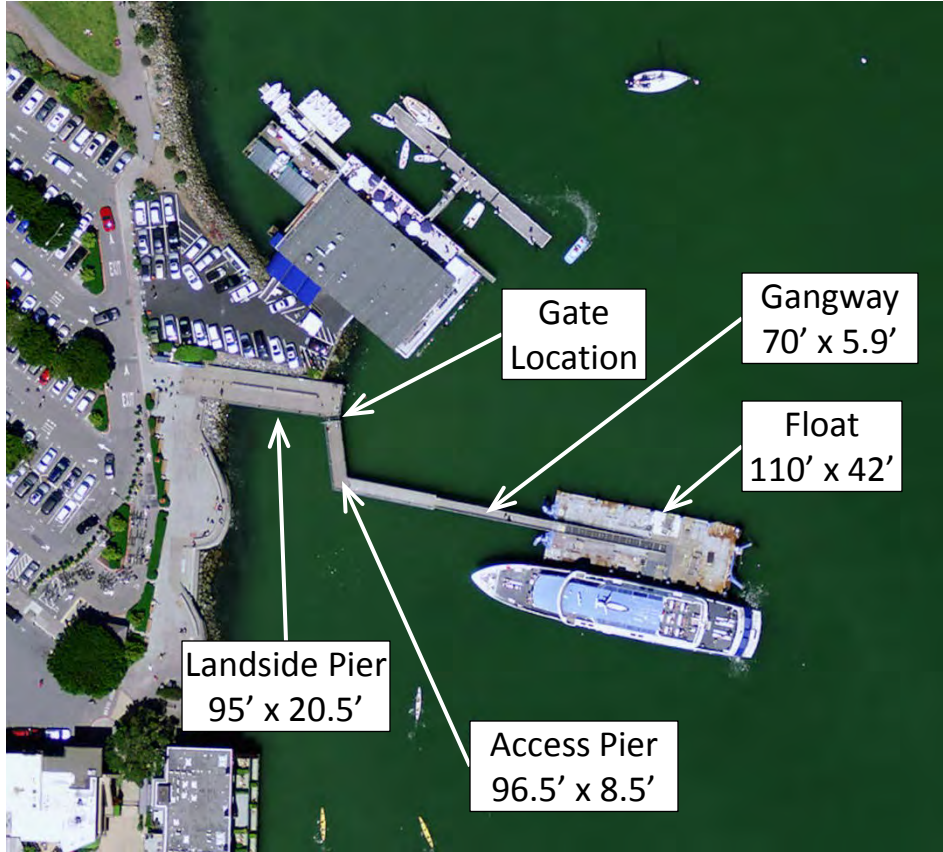

PROJECT ELEVATIONS

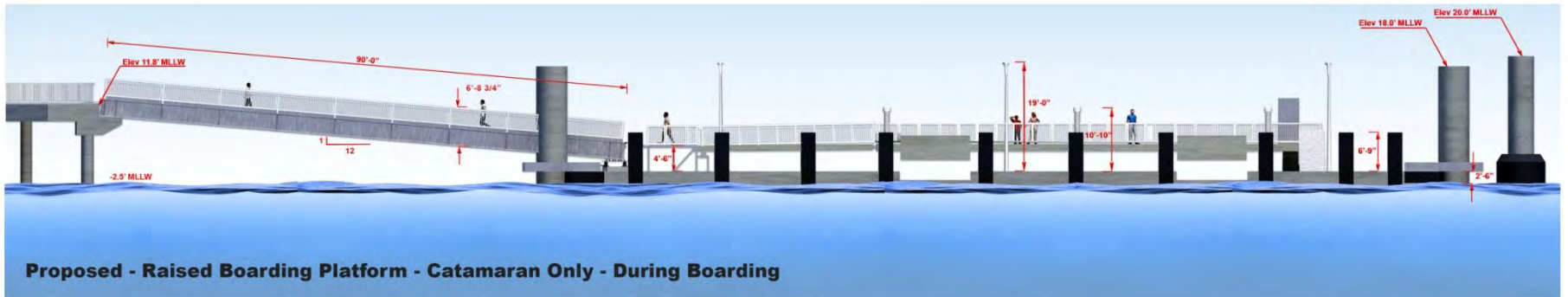
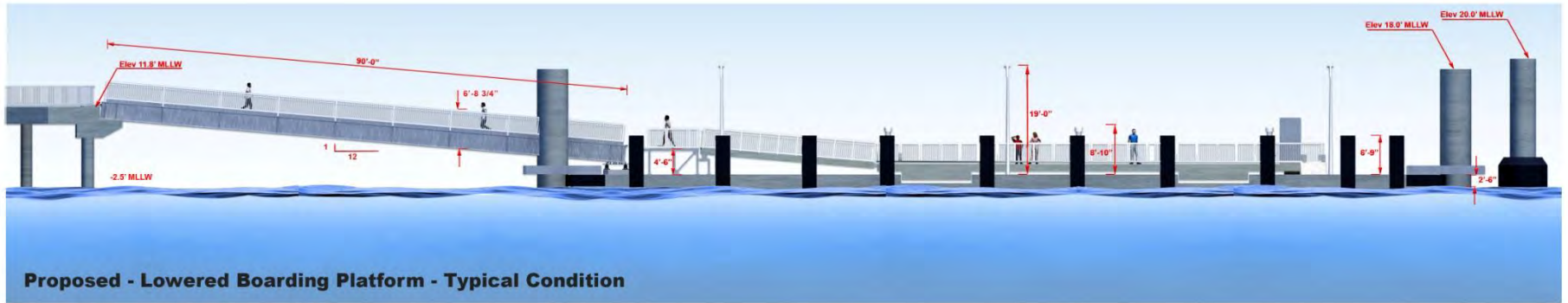
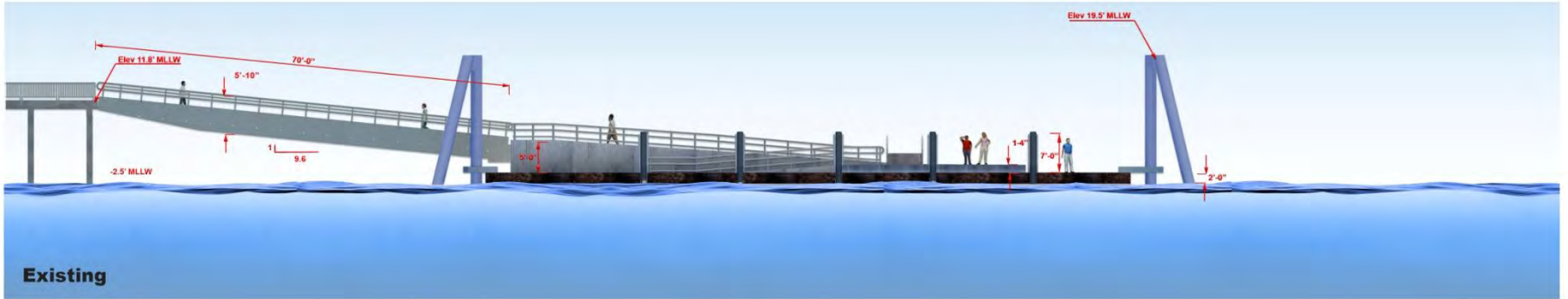

LOW WATER

PROJECT ELEVATIONS

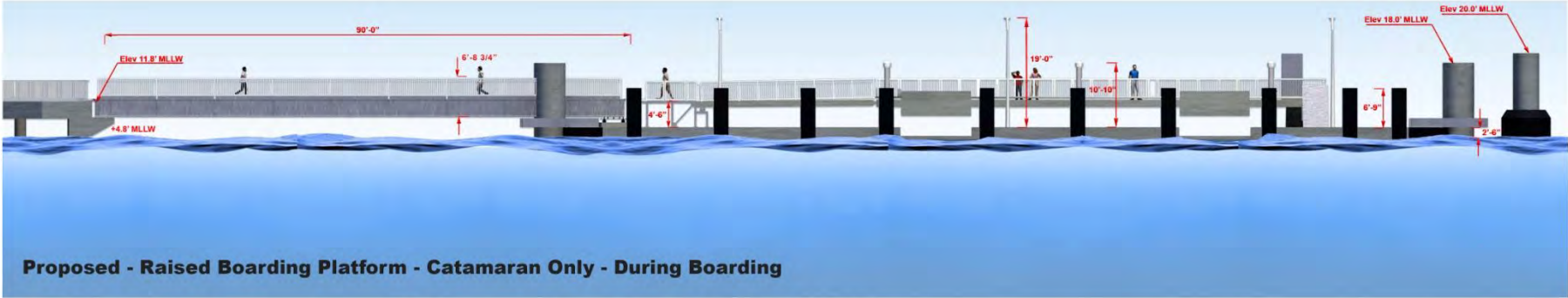
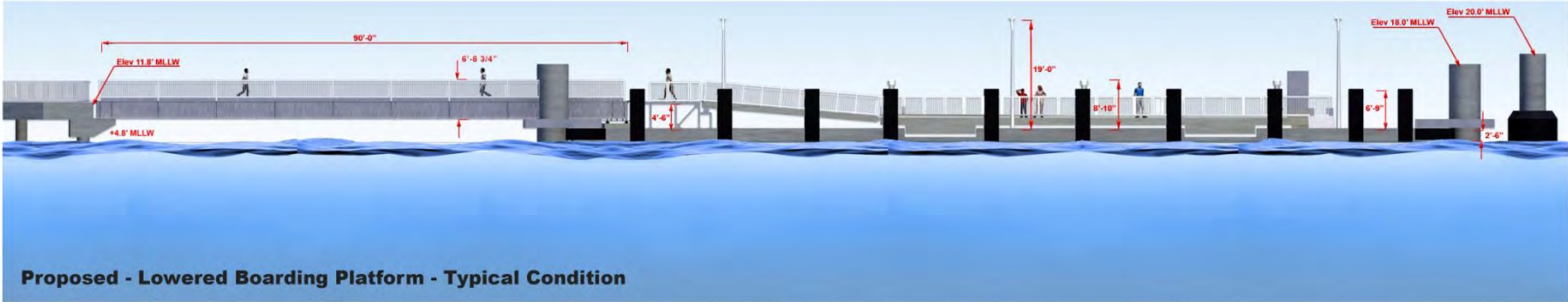
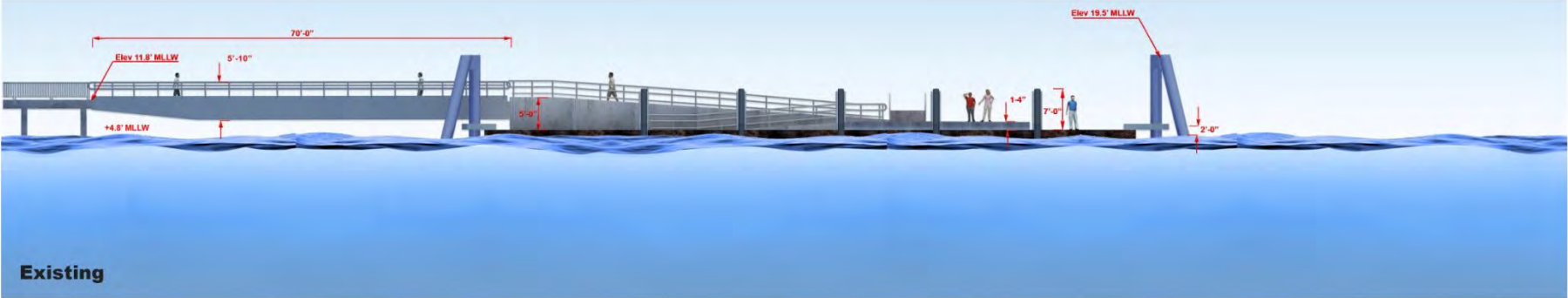

HIGH WATER

PROPOSED FLOAT – LOWERED FOR ARRIVAL OF SPAULDING CLASS



PROPOSED FLOAT – RAISED FOR ARRIVAL OF CATAMARAN CLASS

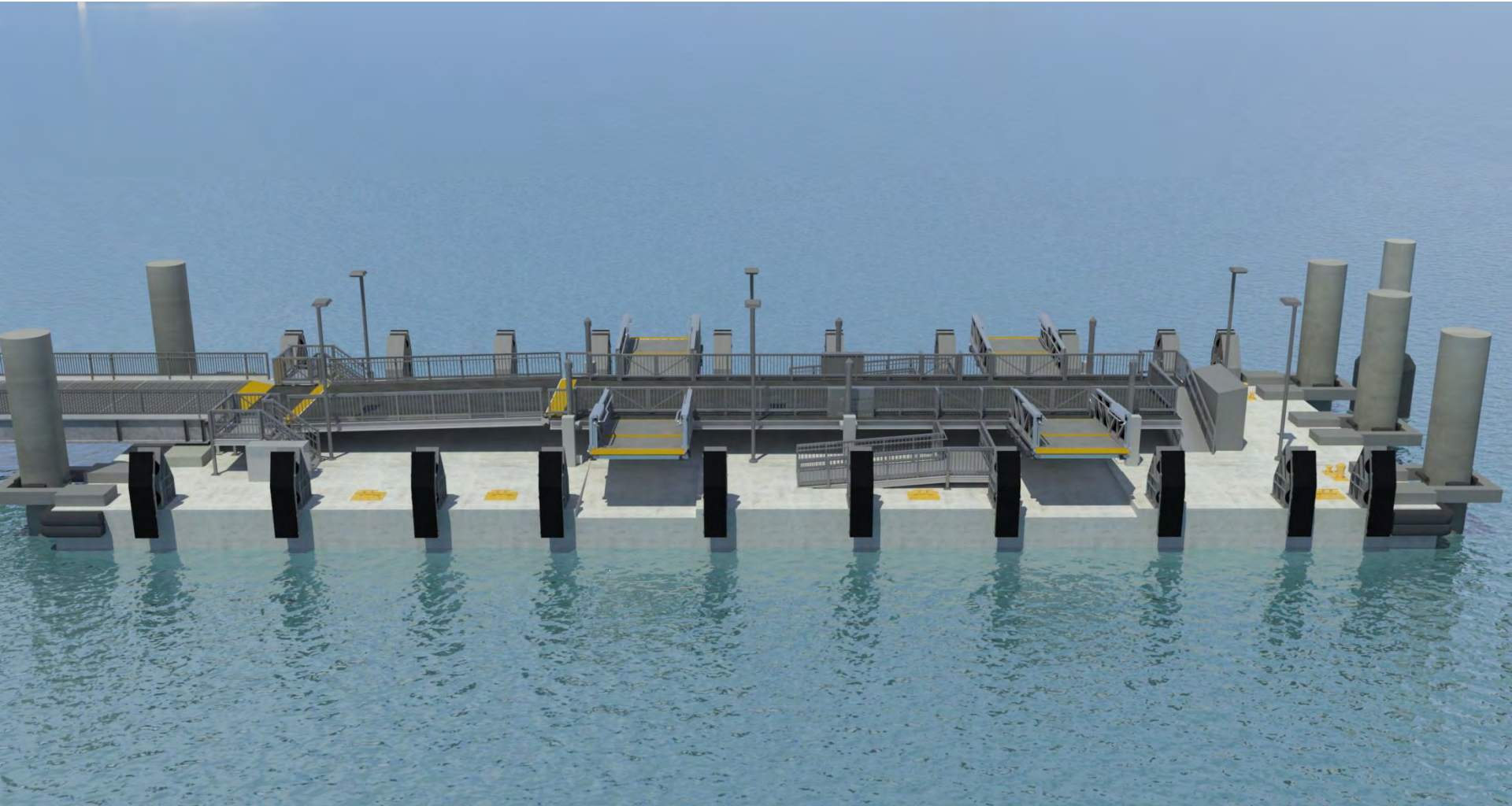

PROPOSED FLOAT – LOWERED FOR ARRIVAL OF SPAULDING CLASS



PROPOSED FLOAT – RAISED FOR ARRIVAL OF CATAMARAN CLASS



PROPOSED COLOR – GRAY (GALVANIZED STEEL)



PROPOSED GATE – SIMPLE SWING GATE WITH TRANSPARENT DOORS



PROPOSED LIGHTING – WARM LIGHTING WITH SPOT LIGHTING ALONG RAILS



BIRD'S EYE VIEW – FERRY NOT IN SERVICE CONDITION

PROPOSED LIGHTING – WARM LIGHTING WITH SPOT LIGHTING ALONG RAILS



EYE LEVEL VIEW – FERRY IN SERVICE CONDITION

PROPOSED LIGHTING – WARM LIGHTING WITH SPOT LIGHTING ALONG RAILS



EYE LEVEL VIEW – FERRY NOT IN SERVICE CONDITION

ACCESS PIER DESIGN CHANGES

Existing Access Pier

96.5' long x 8.5' wide

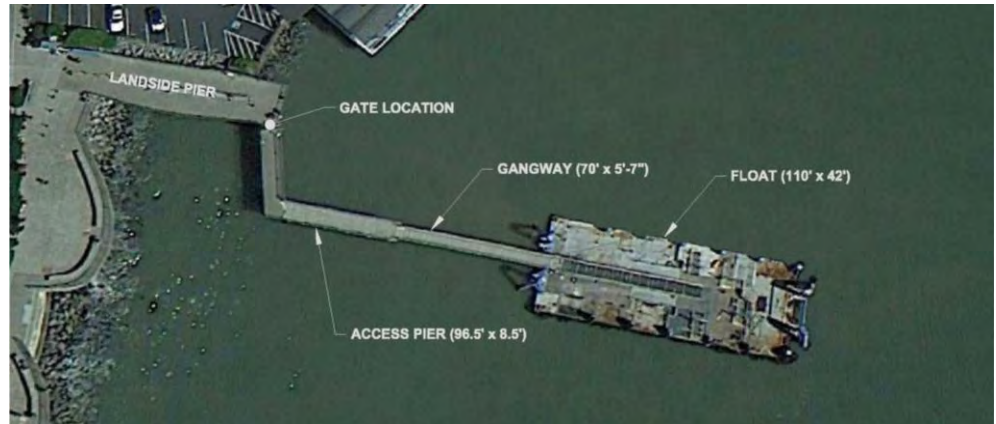

December 2014 Proposed Access Pier

96' long x 25' wide



Proposed Access Pier

96' long x 21' wide



GANGWAY DESIGN CHANGES



Existing Gangway

70' long x 5.9' wide x 3.5' above walking surface



December 2014 Proposed Gangway

90' long x 21' wide x 9.1' above walking surface



March 2015 Proposed Gangway

90' long x 18.3' wide x 5.1' above walking surface



Proposed Gangway

90' long x 16' wide x 3.5' above walking surface

FLOAT DESIGN CHANGES

Existing Steel Float
110' long x 42' wide

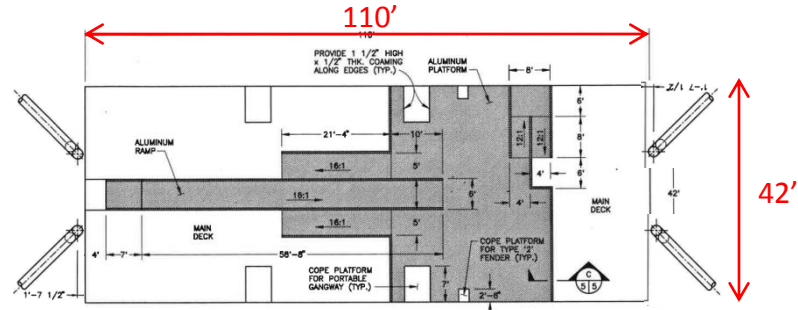

March 2015 Proposed Concrete Float
150' long x 53' wide

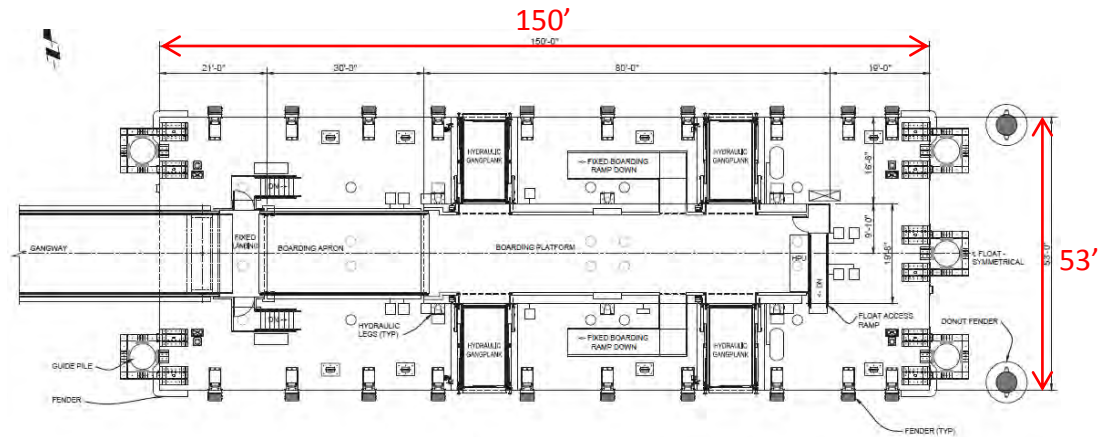

Proposed Concrete Float
145.5' long x 53' wide

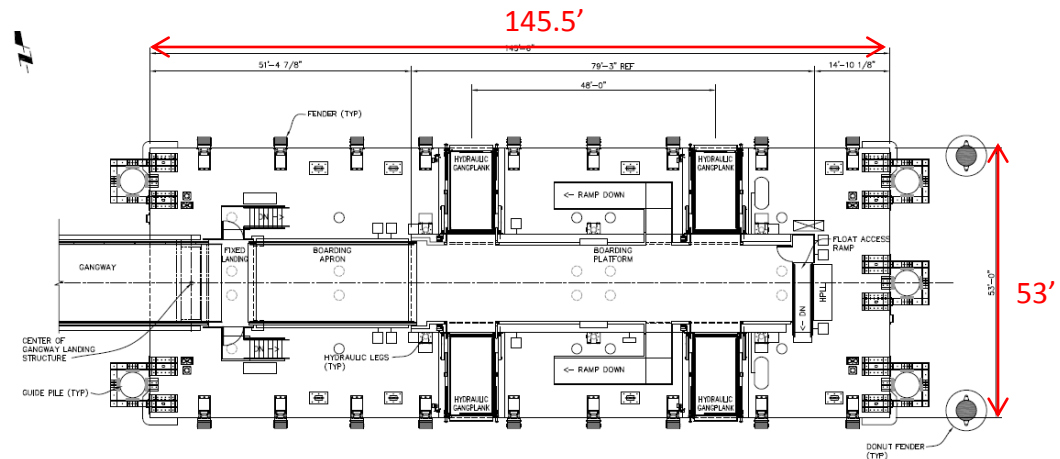

GATE DESIGN CHANGES



Existing Gate

Steel Swing Gate with Diamond Pattern Grating



December 2014 Proposed Gate

Rollup Doors



March 2015 Proposed Gate

Simple Swing Gate with Grating



Proposed Gate

Simple Transparent Swing Gate

SUMMARY OF DESIGN CHANGES BASED ON CITY OF SAUSALITO REQUESTS

	EXISTING	PROPOSED DECEMBER 2014	PROPOSED MARCH 2015	CURRENT PROPOSED
FLOAT	110' long x 42' wide	150' long x 53' wide	150' long x 53' wide	145.5' long x 53' wide
GANGWAY	70' long x 5.9' wide x 5.8' high	90' long x 21' wide x 12' high	90' long x 18.3' wide x 8' high	90' long x 16' wide x 6.7' high
ACCESS PIER	96.5' long x 8.5' wide	96' long x 25' wide	96' long x 21' wide	96' long x 21' wide
LANDSIDE PIER	95' long x 20.5' wide	No change to existing	No change to existing	No change to existing
BELVEDERES	None	Yes, per BCDC	Yes, per BCDC	Yes, per BCDC
GATE	Swing gate with steel grating	Roll up doors	Simple swing gate with steel grating	Simple transparent swing gate
COLOR	Gray, blue	White, blue	Gray	Gray

GUIDE TO RENDERINGS

VIEW POINTS
REQUESTED BY
COMMUNITY



VIEW 1 – EXISTING – EDGE OF GABRIELSON PARK



VIEW 1 – PROPOSED – EDGE OF GABRIELSON PARK



VIEW 2 – EXISTING AND PROPOSED – GABRIELSON PARK (NO CHANGE TO VIEW)



VIEW 3 – EXISTING – OCTOBER 2015 PHOTO – YACHT CLUB – HIGH TIDE ≈ 6.0'



VIEW 3 – PROPOSED – JUNE 2016 UPDATED MODEL – YACHT CLUB – HIGH TIDE ≈ 6.0'



VIEW 3 – EXISTING – JUNE 2016 PHOTO – YACHT CLUB – LOW TIDE ≈ -0.8'



VIEW 3 – PROPOSED – JUNE 2016 UPDATED MODEL – YACHT CLUB – LOW TIDE ≈ -0.8'



VIEW 4 – EXISTING – YACHT CLUB PARKING LOT



VIEW 4 – PROPOSED – YACHT CLUB PARKING LOT

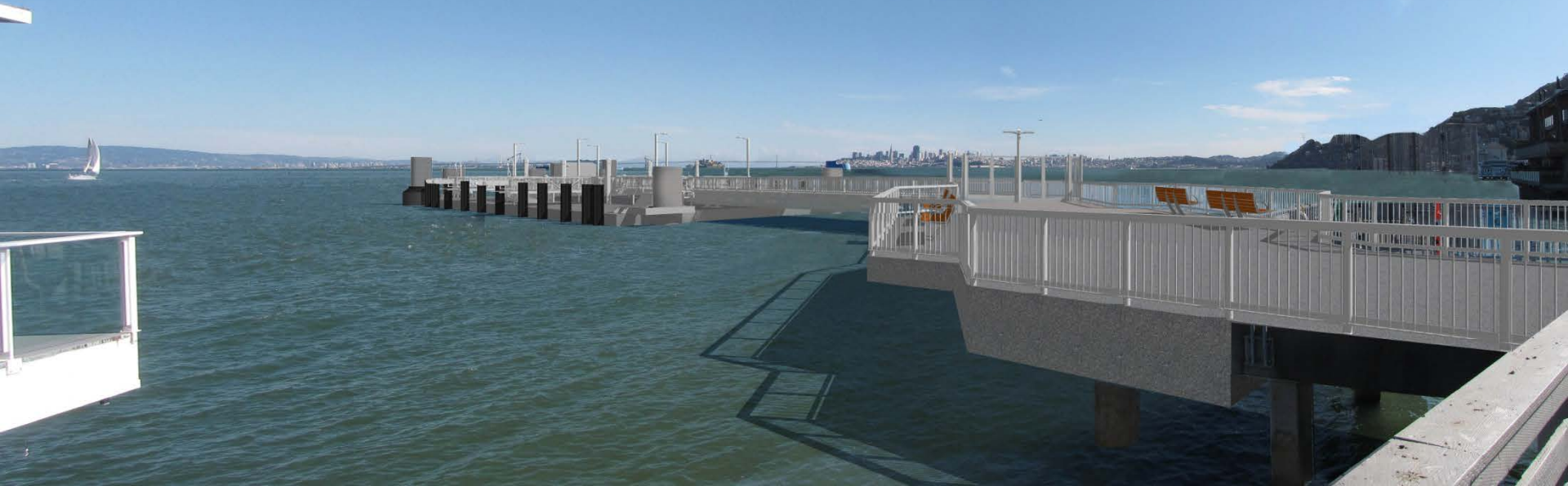

VIEW 5 – EXISTING – NORTH END OF PLAZA



VIEW 5 – PROPOSED – NORTH END OF PLAZA



VIEW 6 – EXISTING – MIDDLE OF PLAZA



VIEW 6 – PROPOSED – MIDDLE OF PLAZA



VIEW 7 – EXISTING – SOUTH END OF PLAZA



VIEW 7 – PROPOSED – SOUTH END OF PLAZA



VIEW 8 – EXISTING – FROM BRIDGEWAY



VIEW 8 – PROPOSED – FROM BRIDGEWAY

