

MUNI LOT 2 IMPROVEMENT PROJECT

CITY OF SAUSALITO
MARIN COUNTY, CA

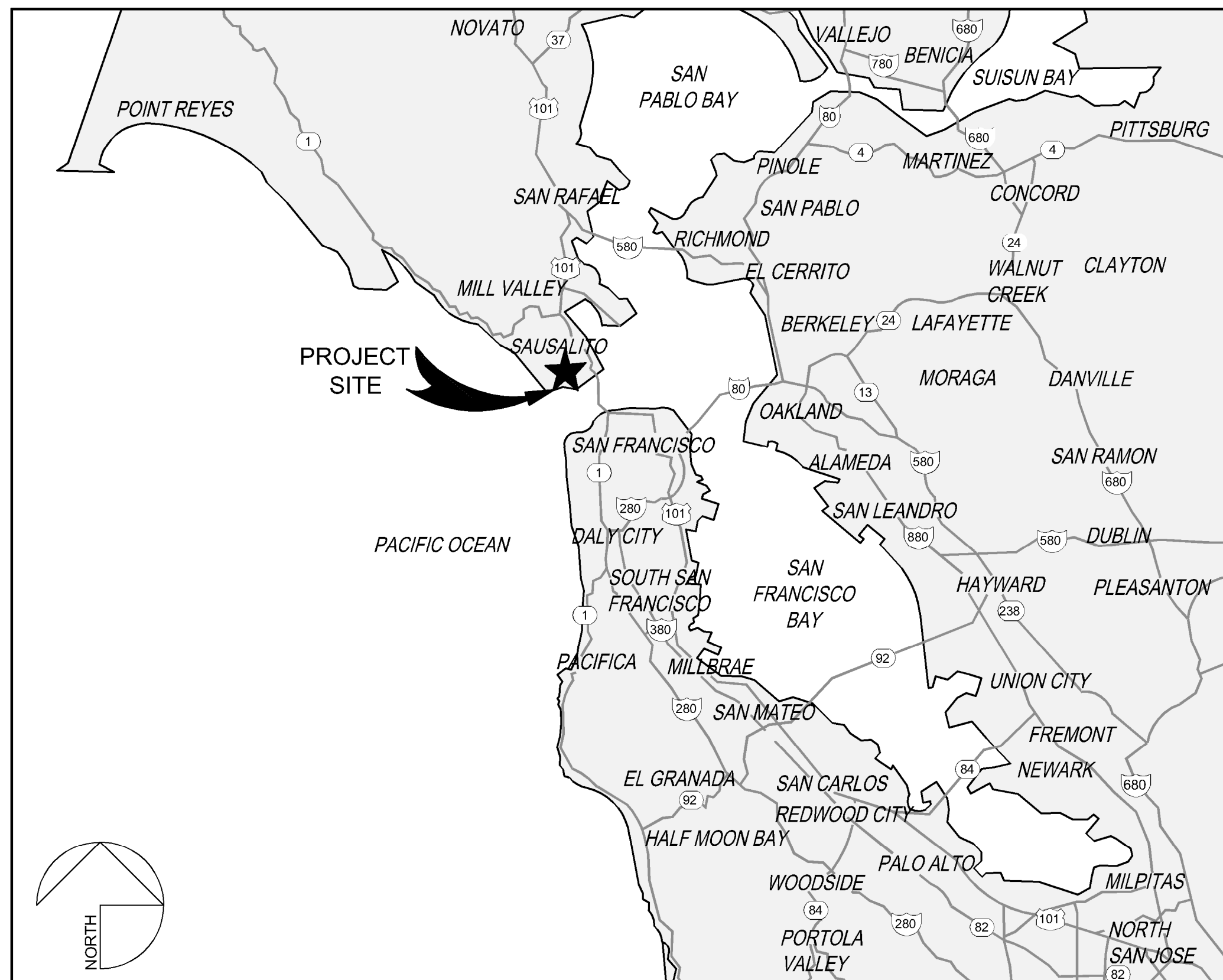

LOCATION MAP
NOT TO SCALE

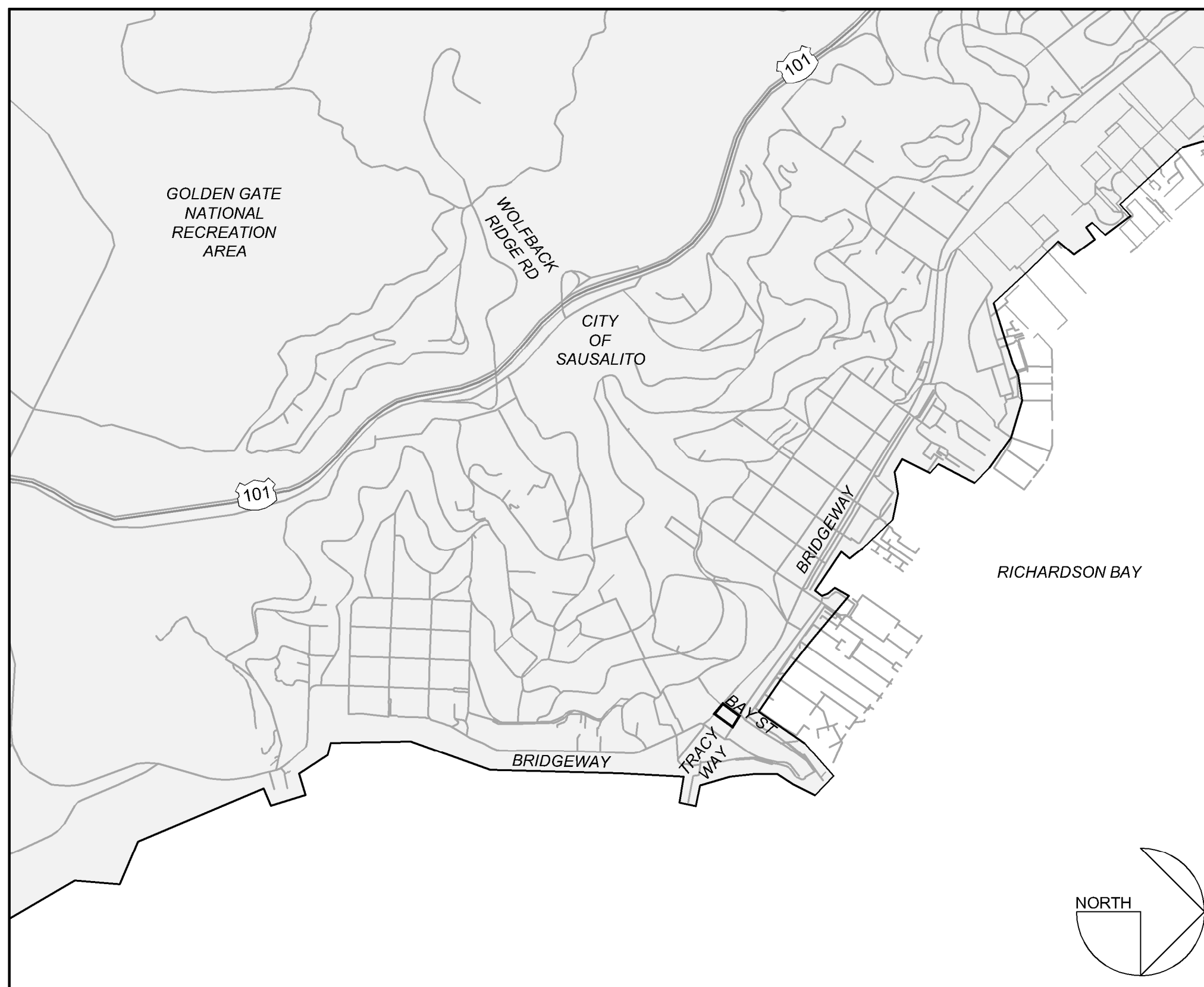

PROJECT MAP
NOT TO SCALE

SHEET INDEX

SHEET NAME	DWG NO.	SHEET NO.
TITLE SHEET	TS.01	1
GENERAL NOTES	GN-01	2
EXISTING CONDITIONS	EX-01	3
DEMOLITION PLAN	DE-01	4
IMPROVEMENT PLAN	IM-01	5
LANDSCAPE PLAN	LS-01	6
EROSION CONTROL	EC-01	7-8
CONSTRUCTION DETAILS	CD.01-CD.03	9-11

STATEMENT OF APPROVAL

APPROVAL OF THESE PLANS DOES NOT RELEASE THE CONTRACTOR OF THE RESPONSIBILITY FOR CORRECTIONS OF MISTAKES, ERRORS OR OMISSIONS CONTAINED THEREIN. IF DURING THE COURSE OF CONSTRUCTION OF THE IMPROVEMENTS, PUBLIC INTEREST REQUIRES A MODIFICATION FOR A DEPARTURE FROM SPECIFICATIONS AND DETAILS OF THE CITY OF SAUSALITO OR THESE PLANS, THE PUBLIC WORKS DIRECTOR SHALL HAVE THE AUTHORITY TO REQUIRE SUCH MODIFICATION OR DEPARTURE AND TO SPECIFY SUCH MODIFICATION OR DEPARTURE AND TO SPECIFY THE MANNER IN WHICH THE SAME IS TO BE MADE.

APPROVED FOR THE CITY OF SAUSALITO

BY: _____ DATE _____
DIRECTOR OF PUBLIC WORKS

CITY OF SAUSALITO

ANDREW A. DAVIDSON
CITY OF SAUSALITO SENIOR ENGINEER
415.289.4180
AADAVIDSON@SAUSALITO.COV
420 LITHO STREET
SAUSALITO, CA 94965

CIVIL ENGINEER

DAYNE JOHNSON
925.940.2208
DJOHNSON@BKF.COM
BKF ENGINEERS
4040 CIVIC CENTER DR SUITE 530
SAN RAFAEL, CA 94903

REVISIONS

NO.	DESCRIPTION	BY	DATE	APP'D

4040 CIVIC CENTER DRIVE
SUITE 530
SAN RAFAEL, CA 94903
415-352-7880 (TEL)
415-352-7979 (FAX)

ENGINEERS / SURVEYORS / PLANNERS

DESIGNED:	DK	DBJ
CHECKED:	DK	DBJ
APPROVED:	CL	DBJ

MUNI LOT 2 IMPROVEMENT PROJECT

TITLE SHEET

MARIN COUNTY
SAUSALITO

CALIFORNIA

DATE	SCALE
SEP 2019	AS SHOWN

BKF PROJECT NO. 20165272

CLIENT: CITY OF SAUSALITO

SHEET NO. 1 OF 11

DRAWING NO. TS.01

K:\2016\165272_Sausalito 2016-2019 Street Rehab\ENG\SHEETS\Lot 2\00_Lot 2_TS.dwg 9-04-19 03:06:31 PM swif
PLOT SCALE: 1 = 1'
VIEWPORT ROTATION: XX



GENERAL PROJECT NOTES

- THE CONTRACTOR AGREES THAT, IN ACCORDANCE WITH GENERALLY ACCEPTED CONSTRUCTION PRACTICES, THE CONTRACTOR WILL ASSUME SOLE AND COMPLETE RESPONSIBILITY FOR JOB SITE CONDITIONS DURING THE COURSE OF CONSTRUCTION OF THE PROJECT, INCLUDING SAFETY OF ALL PERSONS AND PROPERTY. THIS REQUIREMENT SHALL BE MADE TO APPLY CONTINUOUSLY AND NOT LIMITED TO NORMAL WORKING HOURS.
- ALL EXISTING FEATURES ARE SHOWN IN THEIR APPROXIMATE LOCATIONS. IT SHALL BE THE CONTRACTOR'S RESPONSIBILITY TO FIELD VERIFY LOCATIONS, ELEVATIONS, ETC. OF EXISTING FACILITIES AND TO IMMEDIATELY NOTIFY THE ENGINEER IN WRITING OF ANY FIELD CONFLICTS.
- IT IS THE RESPONSIBILITY OF THE CONTRACTOR TO OBTAIN ALL PERMITS NECESSARY TO PERFORM THE WORK SHOWN IN THESE PLANS FROM THE APPROPRIATE AGENCIES, PRIOR TO PERFORMING ANY WORK, INCLUDING A CITY OF SAUSALITO ENCRoACHMENT PERMIT
- CONTRACTOR SHALL MEET WITH CITY PRIOR TO START OF CONSTRUCTION. 48 HOURS NOTICE IS REQUIRED ON ALL INSPECTIONS.
- DUST CONTROL DURING ALL PHASES OF CONSTRUCTION IS THE RESPONSIBILITY OF THE CONTRACTOR. ADJOINING STREETS AND PRIVATE DRIVEWAYS SHALL BE KEPT CLEAN OF PROJECT DIRT, MUD, MATERIALS AND DEBRIS, TO THE SATISFACTION OF THE ENGINEER.
- PRIOR TO CONSTRUCTION, THE CONTRACTOR SHALL SUBMIT FOR APPROVAL THE PROPOSED ROUTES FOR ALL CONSTRUCTION TRAFFIC RELATED TO THE PROJECT. UPON APPROVAL, THE CONTRACTOR SHALL STRICTLY ADHERE TO THE ROUTES ONLY. IN ADDITION TO THE CONTRACTOR'S PROPOSED ROUTES, A DETOUR PLAN SHALL BE SUBMITTED FOR APPROVAL BY THE CITY.
- CONTRACTOR SHALL MAINTAIN ACCESS TO RESIDENCES AND BUSINESSES AFFECTED BY THE PROJECT THROUGHOUT THE DURATION OF THE CONTRACT ACCORDING TO THE SPECIFICATIONS. THE CONTRACTOR SHALL AT NO TIME BLOCK ACCESS TO RESIDENCES AND BUSINESSES WITHOUT THE ADVANCE APPROVAL OF THE ENGINEER AND NOTIFICATION OF THE RESIDENT AND BUSINESS PERSONS.
- THE CONTRACTOR SHALL BE REQUIRED TO KEEP ALL CONSTRUCTION ACTIVITIES WITHIN THE RIGHTS-OF-WAY AND MUNICIPAL LOT 2 UNLESS OTHERWISE SHOWN. THIS SHALL INCLUDE, BUT NOT BE LIMITED TO, VEHICLES AND EQUIPMENT, LIMITS OF TRENCH EXCAVATIONS, AND STOCKPILED NEW MATERIAL.
- CONTRACTOR SHALL NOTIFY THE UNDERGROUND SERVICES ALERT (U.S.A) 811 TWO WORKING DAYS PRIOR TO THE START OF ANY EXCAVATION OR DEMOLITION OF IMPROVEMENTS.
- CONTRACTOR SHALL EXERCISE DUE CAUTION DURING CONSTRUCTION TO PROTECT ANY EXISTING LANDSCAPING, FIXTURES, EQUIPMENT, CONCRETE SIDEWALK, CONCRETE CURB AND GUTTER, EXISTING IMPROVEMENTS, UTILITY FEATURES, BOXES, OR VAULTS, AND AC PAVING TO REMAIN. ANY DAMAGE RESULTING FROM CONTRACTOR OPERATIONS SHALL BE REPAIRED AS DIRECTED BY THE ENGINEER, AT NO ADDITIONAL COST TO THE CITY.
- TRAFFIC CONTROL DURING CONSTRUCTION SHALL BE THE CONTRACTOR'S RESPONSIBILITY AND IN ACCORDANCE WITH THE CONTRACT DOCUMENTS. CONTRACTOR SHALL PROVIDE ALL LIGHTS, SIGNS, BARRICADES, FLAGMEN, AND OTHER DEVICES NECESSARY TO ENSURE PUBLIC SAFETY WITHIN THE PROJECT SITE.
- PRIOR TO CONSTRUCTION, THE CONTRACTOR SHALL PERFORM A SITE WALK OF AREA OF WORK TO IDENTIFY ANY SURVEY MONUMENTS WITHIN THE PROJECT LIMITS. THE CONTRACTOR SHALL HIRE A LICENSED LAND SURVEYOR TO FILE A CORNER RECORD FOR THE CITY OF SAUSALITO MONUMENT IN ACCORDANCE WITH SECTION 8771 OF THE PROFESSIONAL LAND SURVEYORS ACT.
- ALL PAVEMENT CUTS SHALL BE SAWCUT, SMOOTH AND VERTICAL. THE PAVEMENT AREA BEING REMOVED SHALL BE RECTANGULAR, UNLESS SHOWN OTHERWISE ON PLANS.
- LOCATIONS AND SIZE OF LOCAL AC REPAIRS SHOWN ON THE PLANS ARE APPROXIMATE. ACTUAL LOCATIONS AND SIZE TO BE DETERMINED BY THE ENGINEER PRIOR TO CONSTRUCTION.
- CONTRACTOR SHALL RESTORE ALL EXISTING PRIVATE AND PUBLIC IMPROVEMENTS DAMAGED BY THEIR OPERATIONS TO THEIR EXISTING CONDITION OR BETTER. THIS INCLUDES, BUT IS NOT LIMITED TO ALL LANDSCAPING, IRRIGATION, DRIVEWAYS, AC PAVING, CONCRETE WORK AND UTILITIES UNLESS NOTED OR DIRECTED OTHERWISE BY THE CITY'S REPRESENTATIVE.
- RIMS OF EXISTING UTILITY BOXES AND OTHER RELATED APPURTENANCES THAT ARE TO REMAIN SHALL BE PROTECTED DURING CONSTRUCTION AND SHALL BE ADJUSTED TO FINISH GRADES.
- ALL MANHOLES, VALVES AND MONUMENT FRAMES SHALL BE SET TO FINISH GRADE SUCH THAT THERE ARE NO IRREGULARITIES WITH FINISHED GRADES.
- PROVIDE SMOOTH CONFORM TO EXISTING AC PAVEMENT AT ALL TRANSITIONS.
- SHALLOW UTILITIES MAY BE PRESENT. CONTRACTOR SHALL IDENTIFY AND LOCATE ALL UTILITIES IN PROJECT AREA PRIOR TO CONSTRUCTION.
- THE CONTRACTOR AGREES THAT, IN ACCORDANCE WITH GENERALLY ACCEPTED CONSTRUCTION PRACTICES, THE CONTRACTOR WILL BE REQUIRED TO ASSUME SOLE AND COMPLETE RESPONSIBILITY FOR JOB SITE CONDITIONS DURING THE COURSE OF CONSTRUCTION OF THE PROJECT, INCLUDING SAFETY OF ALL PERSONS AND PROPERTY. THIS REQUIREMENT SHALL BE MADE TO APPLY CONTINUOUSLY AND NOT BE LIMITED TO NORMAL WORKING HOURS.
- THE GENERAL CONTRACTOR IS RESPONSIBLE FOR COORDINATING ALL OF THE WORK PERFORMED BY HIS SUBCONTRACTORS, WITHOUT EXCEPTION.
- THE CONTRACTOR SHALL IDENTIFY A RESPONSIBLE CONTACT, WHO IS AN EMPLOYEE OF THE CONTRACTOR, AND A 24-HOUR TELEPHONE NUMBER TO CALL TO RESOLVE PROBLEMS WITH NOISE, DUST OR OTHER CONSTRUCTION-RELATED ISSUES.
- CONSTRUCTION ACTIVITY SHALL BE RESTRICTED TO THE HOURS APPROVED BY THE CITY OF SAUSALITO.

DEMOLITION NOTES:

- CONTRACTOR SHALL PROTECT ALL EXISTING FENCES, WALLS, TREES, PRIVATE LANDSCAPING, CURBS, ABOVEGROUND UTILITIES (JOINT POLES, STREET LIGHTS), AND UNDERGROUND UTILITIES (STORM DRAIN, SANITARY SEWER, TELECOMMUNICATION, WATER & GAS) UNLESS OTHERWISE NOTED.
- EXISTING SIGNING AND STRIPING BEYOND PROJECT LIMITS ARE TO REMAIN. IF DAMAGED, CONTRACTOR SHALL RESTORE AT THEIR OWN EXPENSE.
- ALL VAULTS, VALVE AND MANHOLE LIDS ARE TO BE PROTECTED UNLESS OTHERWISE NOTED.
- ASPHALT REMOVAL SHALL EXTEND ENTIRE WIDTH OF MUNICIPAL LOT 2. SEE DE.01 FOR MORE INFORMATION.
- ALL EXISTING UTILITIES HAVE BEEN PLOTTED FROM RECORD INFORMATION AND FIELD TOPOGRAPHIC SURVEY. THE TYPES, LOCATION, SIZES AND DEPTH OF EXISTING UNDERGROUND UTILITIES SHOWN ON THESE PLANS MAY VARY AND ADDITIONAL FACILITIES MAY EXIST. IT IS THE CONTRACTORS RESPONSIBILITY TO VERIFY PRIOR TO COMMENCEMENT OF CONSTRUCTION.
- ALL STRIPING SHALL BE REMOVED PRIOR TO DEMOLITION ACTIVITIES.
- PROTECT ALL MONUMENTS.

ABBREVIATIONS

AB	AGGREGATE BASE
AC	ASPHALT CONCRETE
APRX.	APPROXIMATE
AVE	AVENUE
BLVD	BOULEVARD
BVCE	BEGINNING OF VERTICAL CURB ELEVATION
BVCS	BEGINNING OF VERTICAL CURB STATION
BW	BACK OF WALK
C&G	CURB AND GUTTER
C.O.M.	COUNTY OF MARIN
CONC	CONCRETE
DR	DRIVE
E	ELECTRIC OR EAST
EG	EXISTING GRADE
EP	EDGE OF PAVEMENT
EX	EXISTING
EVCE	END OF VERTICAL CURB ELEVATION
EVCS	END OF VERTICAL CURB STATION
FH	FIRE HYDRANT
FL	FLOW LINE
FS	FINISHED SURFACE
GB	GRADE BREAK
H	HORIZONTAL
HDPE	HIGH DENSITY POLYETHYLENE
HMA	HOT MIX ASPHALT
INV	INVERT
LF	LINEAR FEET
N	NORTH
NTS	NOT TO SCALE
PA	PAVEMENT
PCC	PORTLAND CEMENT CONCRETE
PL	PLACE
POC	POINT OF CURVATURE
PR	PROPOSED
PVI	POINT OF VERTICAL INTERSECTION
RCP	REINFORCED CONCRETE PIPE
SD	STORM DRAIN
ST	STREET
STA	STATION
SS	SANITARY SEWER
SSMH	SANITARY SEWER MANHOLE
TC	TOP OF CURB
TG	TOP OF GRATE
TP	TOP OF AC PAVING
TS	TOP OF CONC. SLAB
TYP	TYPICAL
TW	TOP OF WALK
V	VERTICAL
W	WATER
WV	WATER VALVE

REVISIONS			
NO.	DESCRIPTION	BY	DATE

--	--

4040 CIVIC CENTER DRIVE SUITE 630 SAN RAFAEL, CA 94903 415-330-7980 (TEL) 415-330-7979 (FAX)	CHECKED: DBJ	APPROVED: DBJ
--	-----------------	------------------

**MUNI LOT 2
IMPROVEMENT PROJECT**
LEGEND, ABBREVIATIONS, AND GENERAL NOTES
SAUSALITO MARIN COUNTY CALIFORNIA

DATE SEP 2019	SCALE AS SHOWN
BKF PROJECT NO. 20165272	
CLIENT CITY OF SAUSALITO	
SHEET NO. 2 OF 11	
DRAWING NO. GN.01	



K:\2016\165272-Sausalito\2016-2019 Street Rehab\ENG\SHEETS\Lot 2\02_Lot 2_EX.dwg 9-04-19 03:10:01 PM swif
 VIEWPORT ROTATION: XX
 PLOT SCALE: 1 = 1

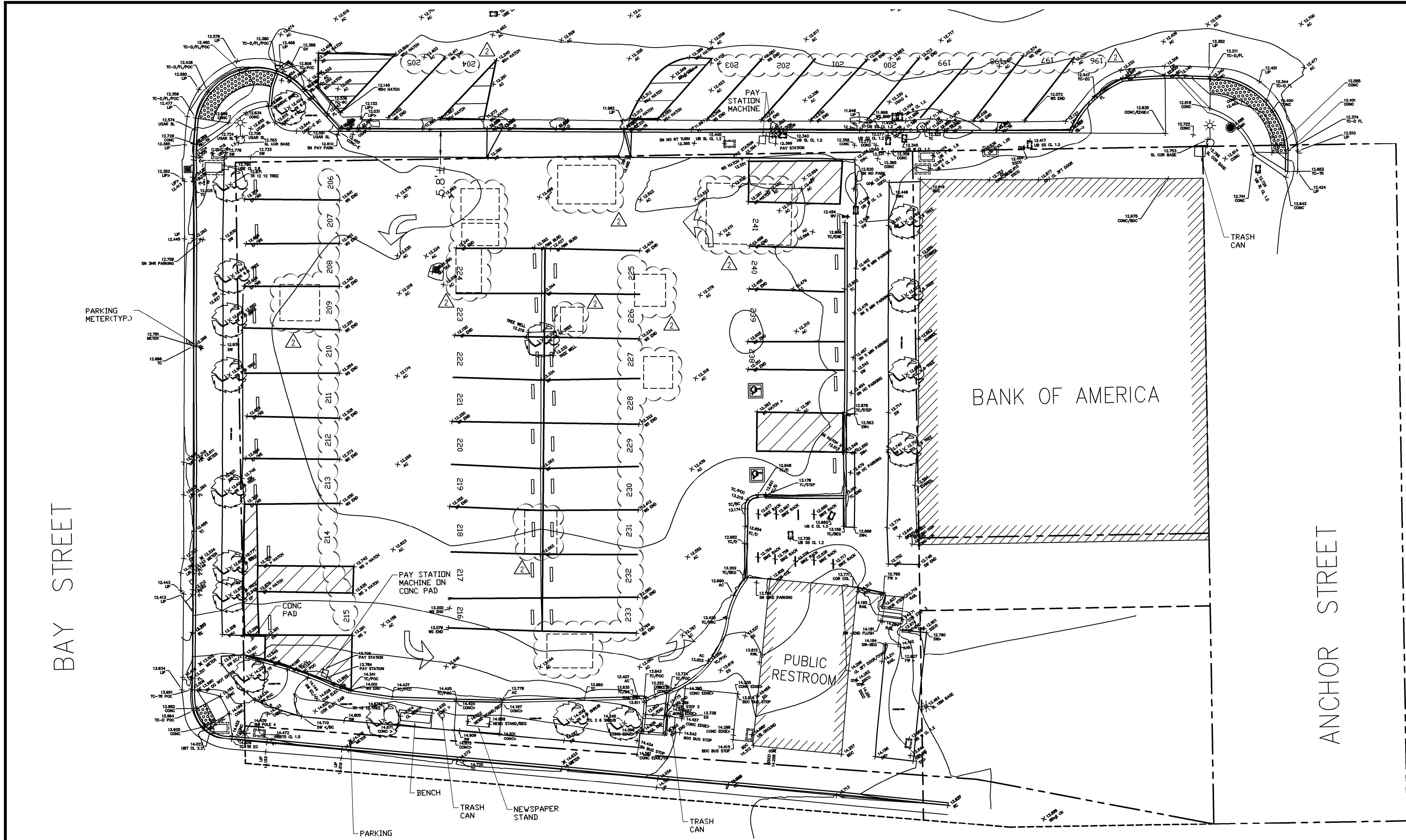

EXISTING CONDITIONS
 SCALE: 1" = 10'

EXISTING CONDITIONS LEGEND

- | | | | |
|---|----------------------------|----|---------------------------|
| W | WATER VALVE | CO | CLEANOUT |
| S | SIGN | GV | GAS VALVE |
| ☀ | LIGHT POLE | ☐ | MISCELLANEOUS UTILITY BOX |
| ☀ | STREET LIGHT/ SIGNAL LIGHT | ☐ | DIGGOUT |
| ☀ | FIRE HYDRANT | ○ | PARKING METER |
| ☀ | STORM DRAIN INLET | ○ | TREE |

ABBREVIATIONS

- | | | | | | | | |
|------|------------------|-----|--------------------|------|-------------------------|-----|--------------|
| AC | ASPHALT CONCRETE | E | ELECTRICAL | PM | PARKING METER | TYP | TYPICAL |
| ACR | ACCESSIBLE RAMP | EC | EDGE OF CURVE | POC | POINT OF CURVATURE | UB | UTILITY BOX |
| BC | BACK OF CURB | EG | EXISTING GRADE | RIM | RIM ELEVATION | WS | WHITE STRIPE |
| BEG | BEGINNING | EP | EDGE OF PAVEMENT | SD | STORM DRAIN | WV | WATER VALVE |
| BLRD | BOLLARD | FF | FINISH FLOOR | SIG | SINGLA LIGHT POLE | | |
| BW | BACK OF WALK | FH | FIRE HYDRANT | SL | STREET LIGHT | | |
| CO | CLEANOUT | FL | FLOW LINE | SN | SIGN | | |
| COR | CORNER | GV | GAS VALVE | SS | SANITARY SEWER | | |
| CB | CATCH BASIN | HC | HANDICAPPED | SSCO | SANITARY SEWER CLEANOUT | | |
| COL | COLUMN | LIP | LIP OF GUTTER | SW | SIDEWALK | | |
| CONC | CONCRETE | L/S | LANDSCAPING | TC | TOP OF CURB | | |
| DI | DRAIN INLET | P | PAVEMENT ELEVATION | TEL | TELECOMMUNICATIONS | | |

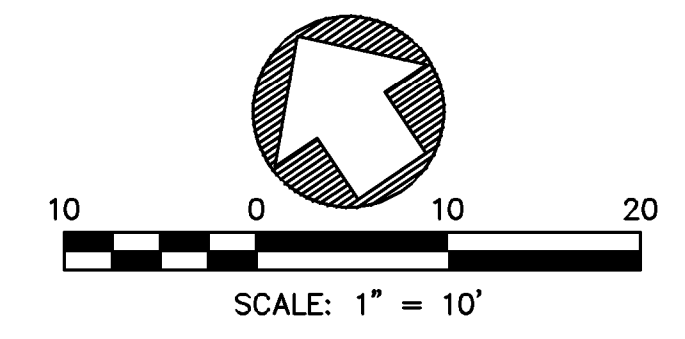

NO.	DESCRIPTION	BY	DATE	APP'D
			9/04/19	

4040 CIVIC CENTER DRIVE
 SUITE 530
 SAN RAFAEL, CA 94903
 415-330-7880 (TEL)
 415-330-7979 (FAX)

BKF
 ENGINEERS / SURVEYORS / PLANNERS

DESIGNED:	CL	CHECKED:	DBJ
DRAWN:	DK	APPROVED:	DBJ

CALIFORNIA
 MARIN COUNTY

MUNI LOT 2
IMPROVEMENT PROJECT
EXISTING CONDITIONS

DATE	SEP 2019	SCALE	AS SHOWN
BKF PROJECT NO.	20165272		
CLIENT	CITY OF SAUSALITO		
SHEET NO.	3 OF 11		
DRAWING NO.	EX.01		

K:\2016\165272_Sausalito\2016-2019 Street Rehab\ENG\SHEETS\Lot 2\03_Lot 2_DE.dwg 9-04-19 03:10:16 PM swif
 VIEWPORT ROTATION: XX
 PLOT SCALE: 1 = 1

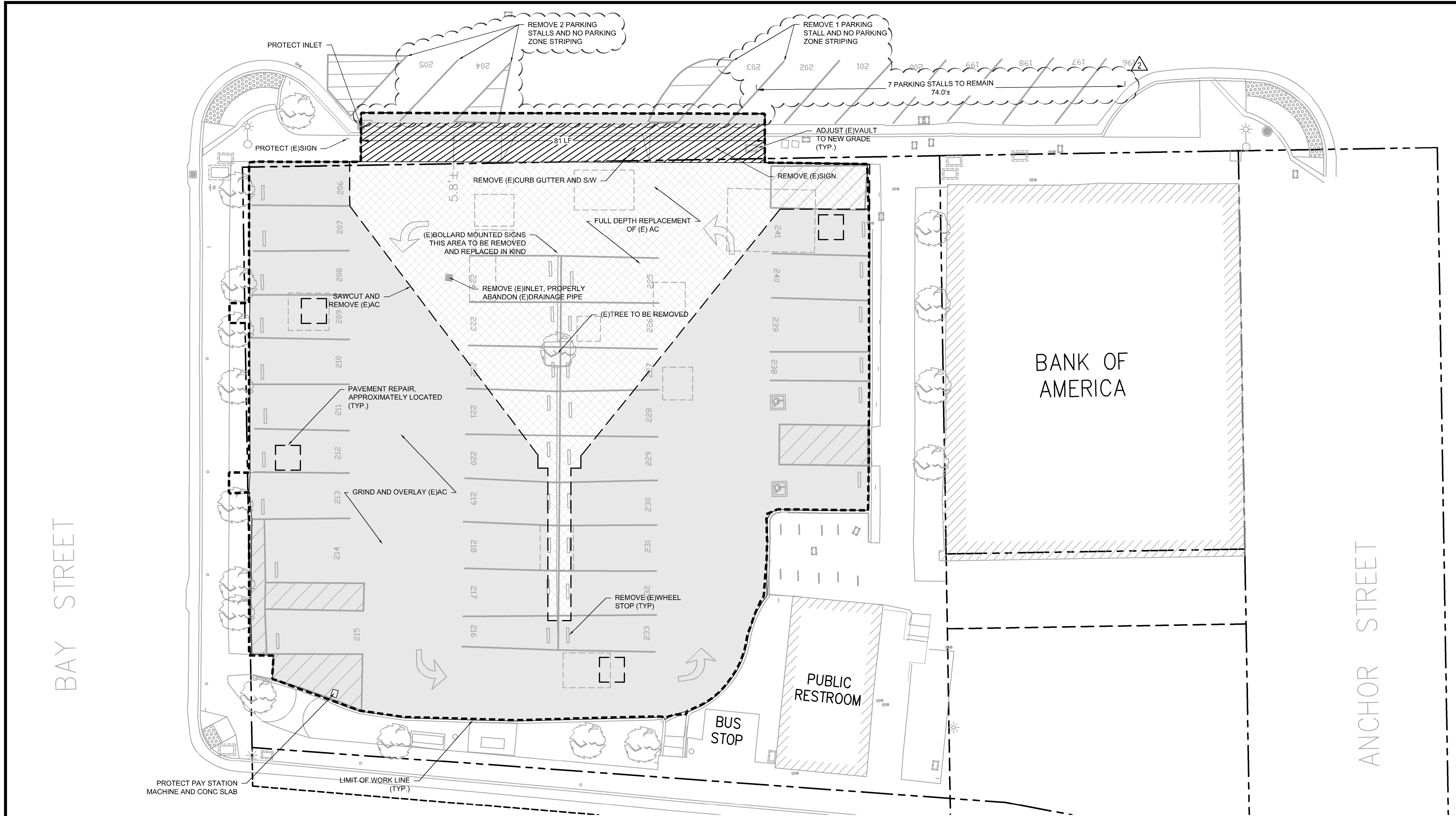

DEMOLITION PLAN
 SCALE: 1" = 10'

DEMOLITION LEGEND

- GRIND ASPHALT CONCRETE, 2"
- FULL DEPTH REPLACEMENT OF ASPHALT CONCRETE
- REMOVE CURB GUTTER AND SIDEWALK
- SAWCUT LINE
- PAVEMENT REPAIR, 4'x4' U.O.N. SEE 8/CD.01

ABBREVIATIONS

- LF LINEAR FOOT

DEMOLITION NOTES

1. ALL EXISTING UTILITIES HAVE BEEN PLOTTED FROM RECORD INFORMATION AND FIELD TOPOGRAPHIC SURVEY. THE TYPES, LOCATION, SIZES AND DEPTH OF EXISTING UNDERGROUND UTILITIES SHOWN ON THESE PLANS MAY VARY AND ADDITIONAL FACILITIES MAY EXIST. IT IS THE CONTRACTOR'S RESPONSIBILITY TO VERIFY PRIOR TO COMMENCEMENT OF CONSTRUCTION.
2. CONTRACTOR SHALL PROTECT ALL EXISTING FENCING, WALLS, TREES, PRIVATE LANDSCAPING, CURBS, ABOVEGROUND UTILITIES (JOINT POLES, STREET LIGHTS), AND UNDERGROUND UTILITIES (STORM DRAIN, SANITARY SEWER, WATER AND GAS) UNLESS OTHERWISE NOTED.
3. SHALLOW UTILITIES MAY BE PRESENT. CONTRACTOR SHALL IDENTIFY AND LOCATE ALL UTILITIES IN PROJECT AREA PRIOR TO CONSTRUCTION.
4. CONTRACTOR IS RESPONSIBLE TO LEGALLY DISPOSE OF ALL REMOVED MATERIALS AT THE CONTRACTORS EXPENSE.
5. CONTRACTOR TO PROTECT ALL TREES NOT DESIGNATED TO BE REMOVED, INCLUDING BUT NOT LIMITED TO TREES WITHIN AND OUTSIDE OF THE PROJECT LIMIT OF WORK.
6. THE CONTRACTOR AGREES THAT, IN ACCORDANCE WITH GENERALLY ACCEPTED CONSTRUCTION PRACTICES, THE CONTRACTOR WILL BE REQUIRED TO ASSUME SOLE AND COMPLETE RESPONSIBILITY FOR JOB SITE CONDITIONS DURING THE COURSE OF CONSTRUCTION OF THE PROJECT, INCLUDING SAFETY OF ALL PERSONS AND PROPERTY. THIS REQUIREMENT SHALL BE MADE TO APPLY CONTINUOUSLY AND NOT BE LIMITED TO NORMAL WORKING HOURS.
7. THE GENERAL CONTRACTOR IS RESPONSIBLE FOR COORDINATING ALL OF THE WORK PERFORMED BY HIS SUBCONTRACTORS, WITHOUT EXCEPTION.
8. THE CONTRACTOR SHALL IDENTIFY A RESPONSIBLE CONTACT, WHO IS AN EMPLOYEE OF THE CONTRACTOR, AND A 24-HOUR TELEPHONE NUMBER TO CALL TO RESOLVE PROBLEMS WITH NOISE, DUST OR OTHER CONSTRUCTION-RELATED ISSUES.
9. CONSTRUCTION ACTIVITY SHALL BE RESTRICTED TO THE HOURS APPROVED BY THE CITY OF SAUSALITO.
10. ALL EXISTING UTILITY BOXES, STRUCTURES, MANHOLES AND VALVES WITHIN THE LIMIT OF WORK SHALL BE ADJUSTED TO FINAL GRADE UNLESS OTHERWISE NOTED.
11. IF CONTRACTOR DISCOVERS WITHIN THE PAVEMENT SECTION PILES OR OTHER OBJECTS WHICH MAY LEAD TO VOIDS OR CAVING OF PAVEMENT, CONTRACTOR SHALL REMOVE OBJECT TO A DEPTH OF FIVE FEET BELOW THE BOTTOM OF SUBGRADE, AND BACKFILL WITH A SLURRY SOLUTION.

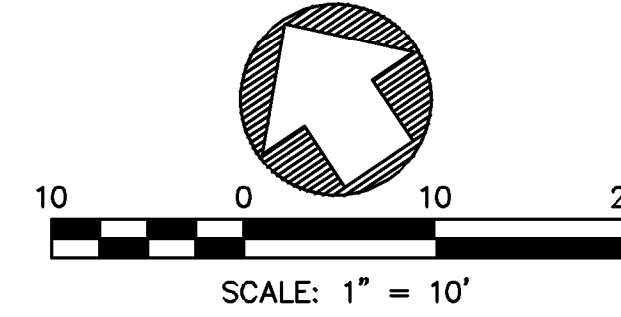

REVISIONS

NO.	DESCRIPTION	BY	DATE	APP'D
1	ADDENDUM #2		9/04/19	

4040 CIVIC CENTER DRIVE
 SUITE 530
 SAN RAFAEL, CA 94903
 415-330-7980 (TEL)
 415-330-7979 (FAX)

DESIGNED:	CL	CHECKED:	DBJ
DRAWN:	DK	APPROVED:	DBJ

MUNI LOT 2 IMPROVEMENT PROJECT DEMOLITION PLAN MARIN COUNTY		CALIFORNIA SAUSALITO	
DATE:	SEP 2019	SCALE:	AS SHOWN
BKF PROJECT NO.:	20165272		
CLIENT:	CITY OF SAUSALITO		
SHEET NO.:	4 OF 11		
DRAWING NO.:	DE.01		

K:\2016\165272_Sausalito\2016-2019 Street Rehab\ENG\SHEETS\Lot 2\04_Lot 2_1M.dwg 9-04-19 03:10:36 PM swf
 PLOT SCALE: 1 = 1 VIEWPORT ROTATION: XX

BAY STREET



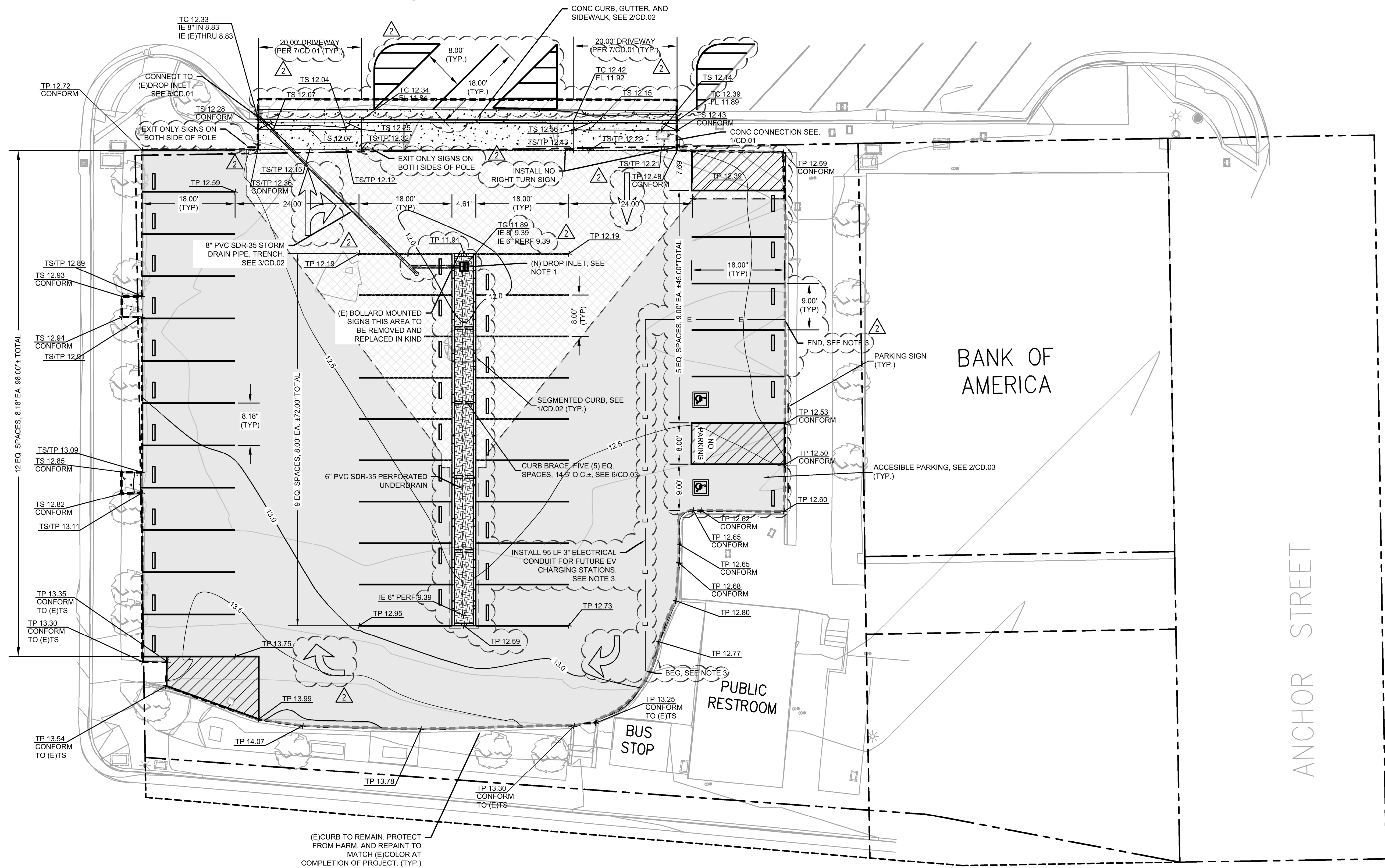



ANCHOR STREET

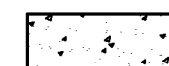

IMPROVEMENT PLAN

SCALE: 1" = 10'

IMPROVEMENTS LEGEND (SEE PROJECT SPECIFICATIONS)

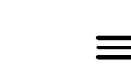
-  CONCRETE
-  VEGETATED SWALE, SEE 6/CD.03
-  FULL DEPTH AC REPLACEMENT, SEE 4/CD.02
-  AC PLUG, SEE 3/CD.01
-  2" ASPHALT GRIND AND MIN. 2" OVERLAY, SEE 2/CD.01
-  18"x18" DROP INLET
-  STORM DRAIN PIPE
-  STORM DRAIN CLEANOUT

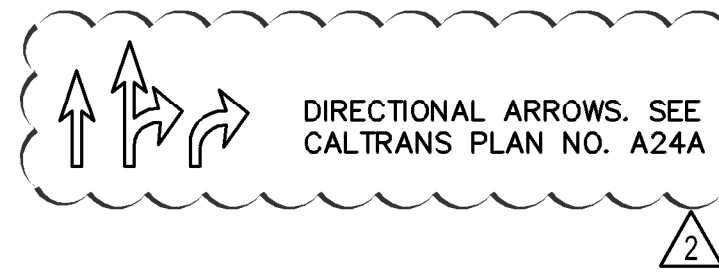

IMPROVEMENT NOTES:

1. DROP INLET TO BE 18"x18", JENSEN PRECAST OR APPROVED EQUAL.
2. CONTRACTOR TO WORK WITH THE CITY TO RE-STRIPE THE NUMBER OF THE PARKING STALLS BASED ON THE EXISTING NUMBERING SYSTEM.
3. CONTRACTOR TO INSTALL 3" CONDUIT FOR FUTURE ELECTRICAL VEHICLE (EV) CHARGING STATION AT A 24" MINIMUM DEPTH OF COVER AND 30" MINIMUM DEPTH TRENCH. CONTRACTOR TO CAP THE ENDS OF THE CONDUIT RUN AND PROVIDE TRACING WIRE. REFER TO PG&E GREEN BOOK FOR FURTHER INFORMATION.

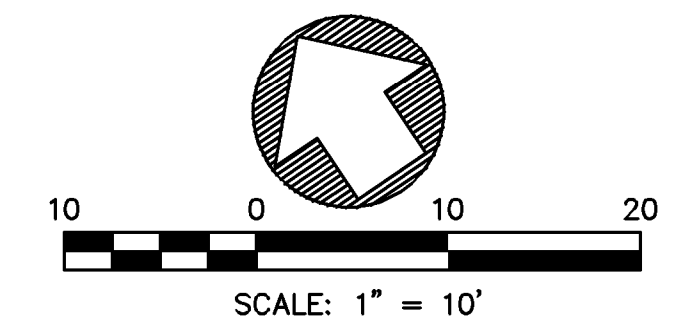

REVISIONS		DATE	BY	APP'D
		9/04/19		

4040 CIVIC CENTER DRIVE SUITE 530 SAN RAFAEL, CA 94903 415-330-7980 (TEL) 415-330-7979 (FAX)			
BKF			
ENGINEERS / SURVEYORS / PLANNERS			
DRAWN: DK	CHECKED: DBJ	APPROVED: DBJ	
DESIGNED: CL			

MUNI LOT 2
 IMPROVEMENT PROJECT
 IMPROVEMENT PLAN
 MARIN COUNTY
 CALIFORNIA
 SAUSALITO

DATE: SEP 2019	SCALE: AS SHOWN
BKF PROJECT NO.: 20165272	
CITY OF SAUSALITO	
SHEET NO.: 5 OF 11	
DRAWING NO.: IM.01	

K:\2019\165272_Sausalito\2019-2019 Street Rehab\ENG\SHEETS\Lot 2\05_Lot 2_L15.dwg 9-04-19 03:10:55 PM swif
 VIEWPORT ROTATION: XX
 PLOT SCALE: 1 = 1

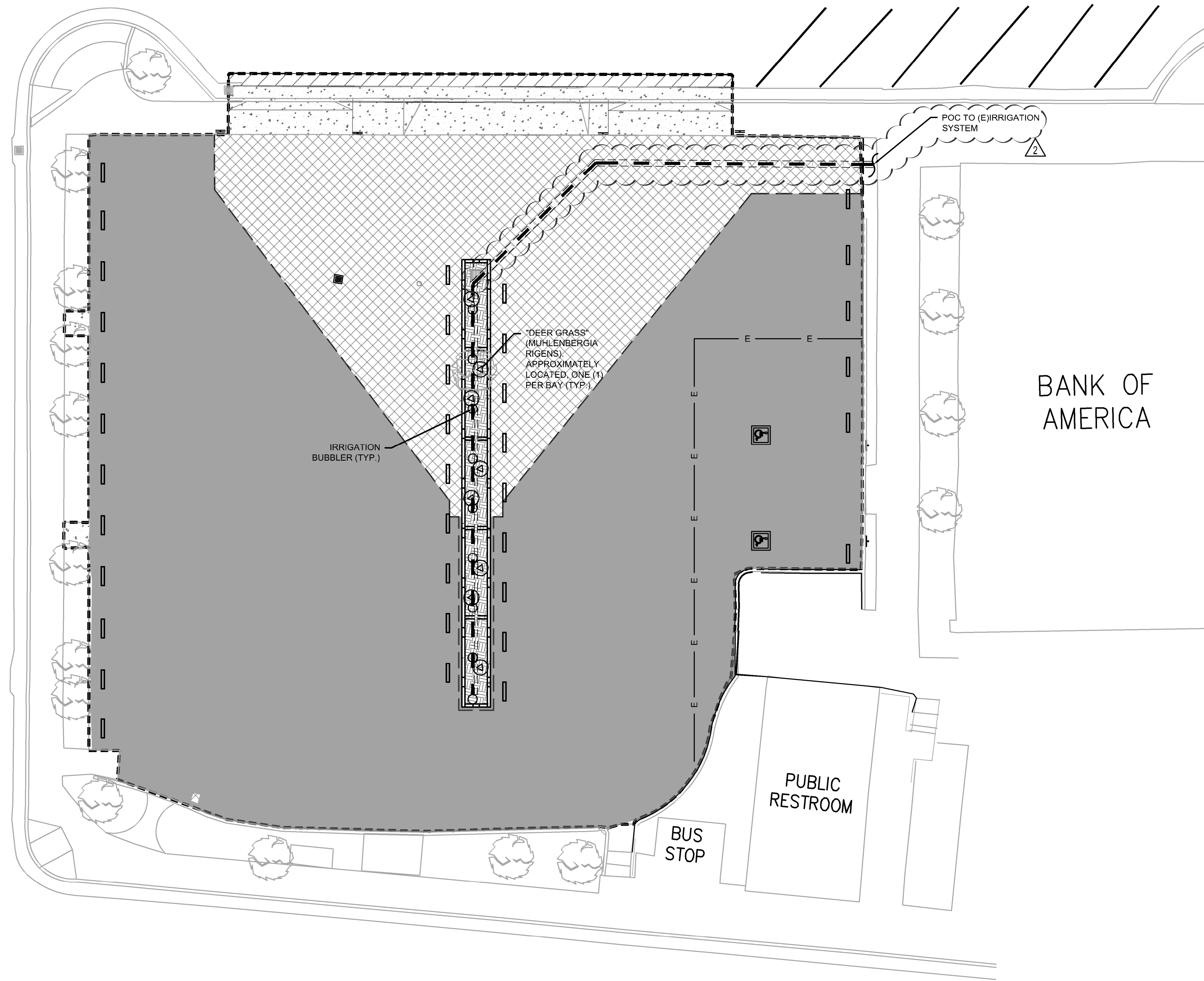

PLAN VIEW
 SCALE: 1" = 10'

LANDSCAPE LEGEND (SEE PROJECT SPECIFICATIONS)

- MUHLENBERGIA RIGENS, "DEER GRASS". PLANT MIN. ±6" O.C.
- IRRIGATION LINE
- IRRIGATION BUBBLER

PLANTING NOTES:

1. BLACK WOOD MULCH TO BE PLACED IN ALL LANDSCAPED AREAS INCLUDING THE VEGETATED SWALE AREA.
2. ALL WORK SHALL BE PERFORMED BY PERSONS FAMILIAR WITH PLANTING WORK AND UNDER THE SUPERVISION OF A QUALIFIED PLANTING FOREMAN.
3. PLANT MATERIAL LOCATIONS SHOWN ARE DIAGRAMMATIC AND MAY BE SUBJECT TO CHANGE IN THE FIELD BY THE LANDSCAPE ARCHITECT BEFORE THE MAINTENANCE PERIOD BEGINS DUE TO UNFORESEEN CONFLICTS.
4. PLANT MATERIAL LOCATIONS ARE TO BE ADJUSTED IN THE FIELD AS NECESSARY AROUND BOXES AND UTILITIES BUT NOT TO BLOCK WINDOWS, PEDESTRIAN SIGHT LINES, NOR IMPEDE ACCESS.

ACCESS.

5. CONTRACTOR SHALL VERIFY THE LOCATION OF UNDERGROUND UTILITIES AND BRING CONFLICTS WITH PLANT MATERIAL LOCATIONS TO THE ATTENTION OF THE ENGINEER OR THE CITY FOR A DECISION BEFORE PROCEEDING WITH THE WORK.

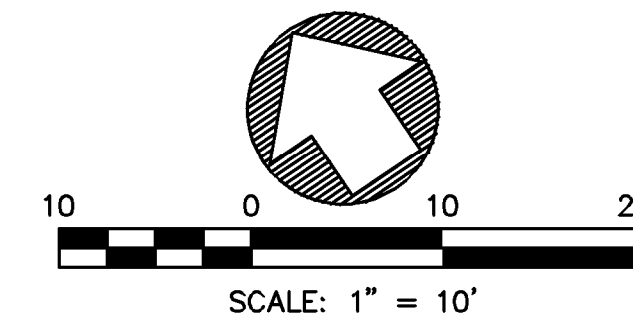

REVISIONS

NO.	DESCRIPTION	BY	DATE	APP'D
1	ADDENDUM #2		9/04/19	

BKF
 ENGINEERS / SURVEYORS / PLANNERS

4040 CIVIC CENTER DRIVE
 SUITE 530
 SAN RAFAEL, CA 94903
 415-330-7800 (TEL)
 415-330-7979 (FAX)

DESIGNED: CL	CHECKED: DBJ
DRAWN: DK	APPROVED: DBJ

MUNI LOT 2
 IMPROVEMENT PROJECT
 LANDSCAPE PLAN
 MARIN COUNTY
 CALIFORNIA

SAUSALITO

DATE SEP 2019	SCALE AS SHOWN
BKF PROJECT NO. 20165272	
CLIENT CITY OF SAUSALITO	
SHEET NO. 6 OF 11	
DRAWING NO. LS.01	



K:\2016\165272_Sausalito\2016-2019 Street Rehab\ENG\SHEETS\Lot 2\05_Lot 2_EC.dwg 9-04-19 03:11:11 PM swif
 PLOT SCALE: 1 = 1 VIEWPORT ROTATION: XX

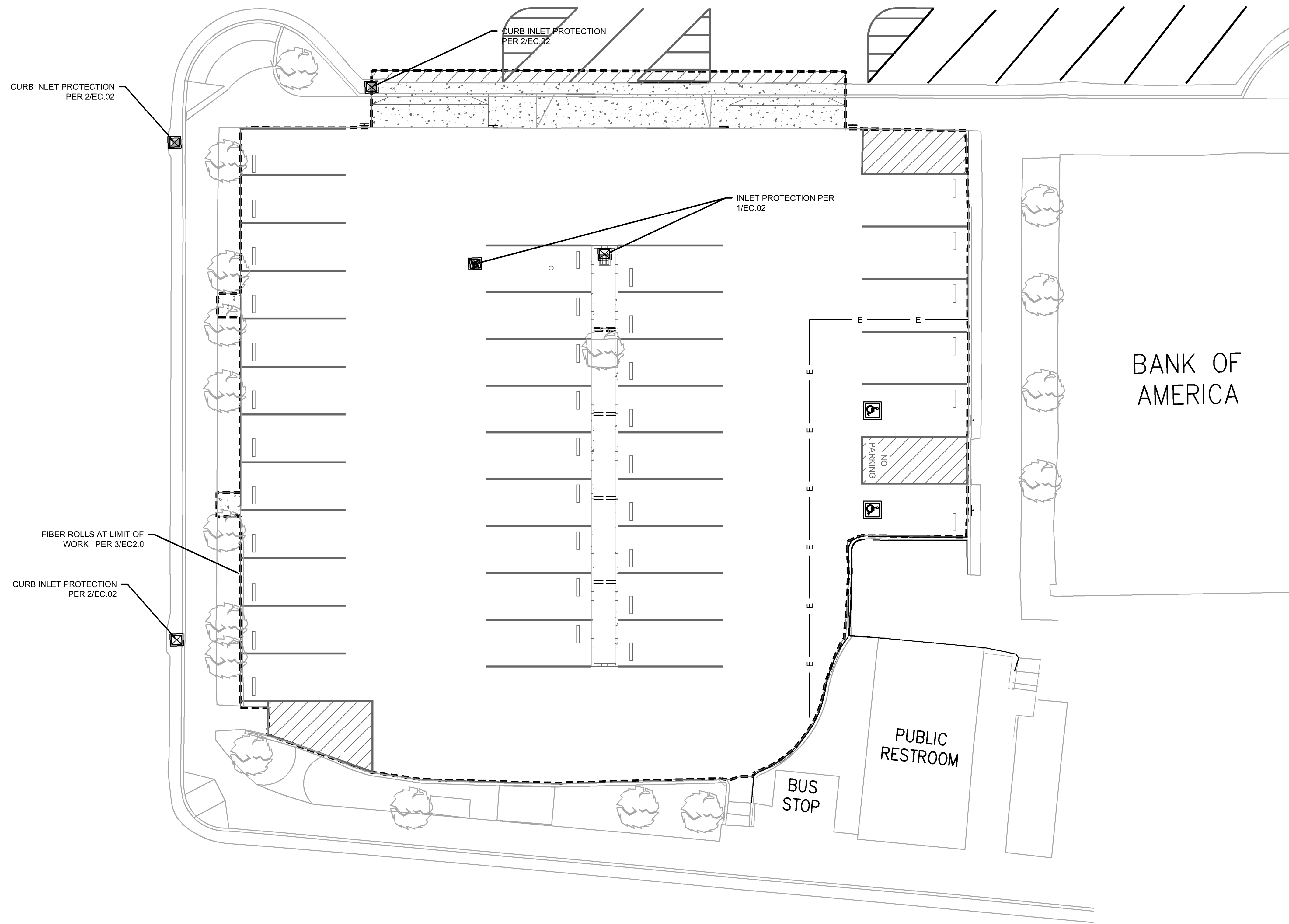

PLAN VIEW
 SCALE: 1" = 10'

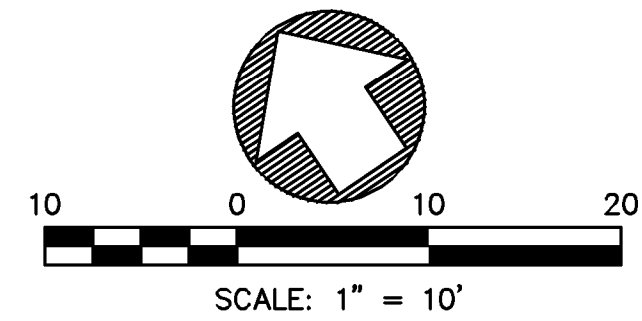

REVISIONS			
NO.	DESCRIPTION	BY	DATE
1	ADDENDUM #2		9/04/19

4040 CIVIC CENTER DRIVE
 SUITE 530
 SAN RAFAEL, CA 94903
 415-330-7880 (TEL)
 415-330-7979 (FAX)

 BKF ENGINEERS / SURVEYORS / PLANNERS	DRAWN: DK DESIGNED: CL	CHECKED: DBJ APPROVED: DBJ
	SAUSALITO MARIN COUNTY CALIFORNIA	MUNI LOT 2 IMPROVEMENT PROJECT EROSION CONTROL PLAN

DATE	SCALE
SEP 2019	AS SHOWN
BKF PROJECT NO.	20165272
CLIENT	CITY OF SAUSALITO
SHEET NO.	7 OF 11
DRAWING NO.	EC.01

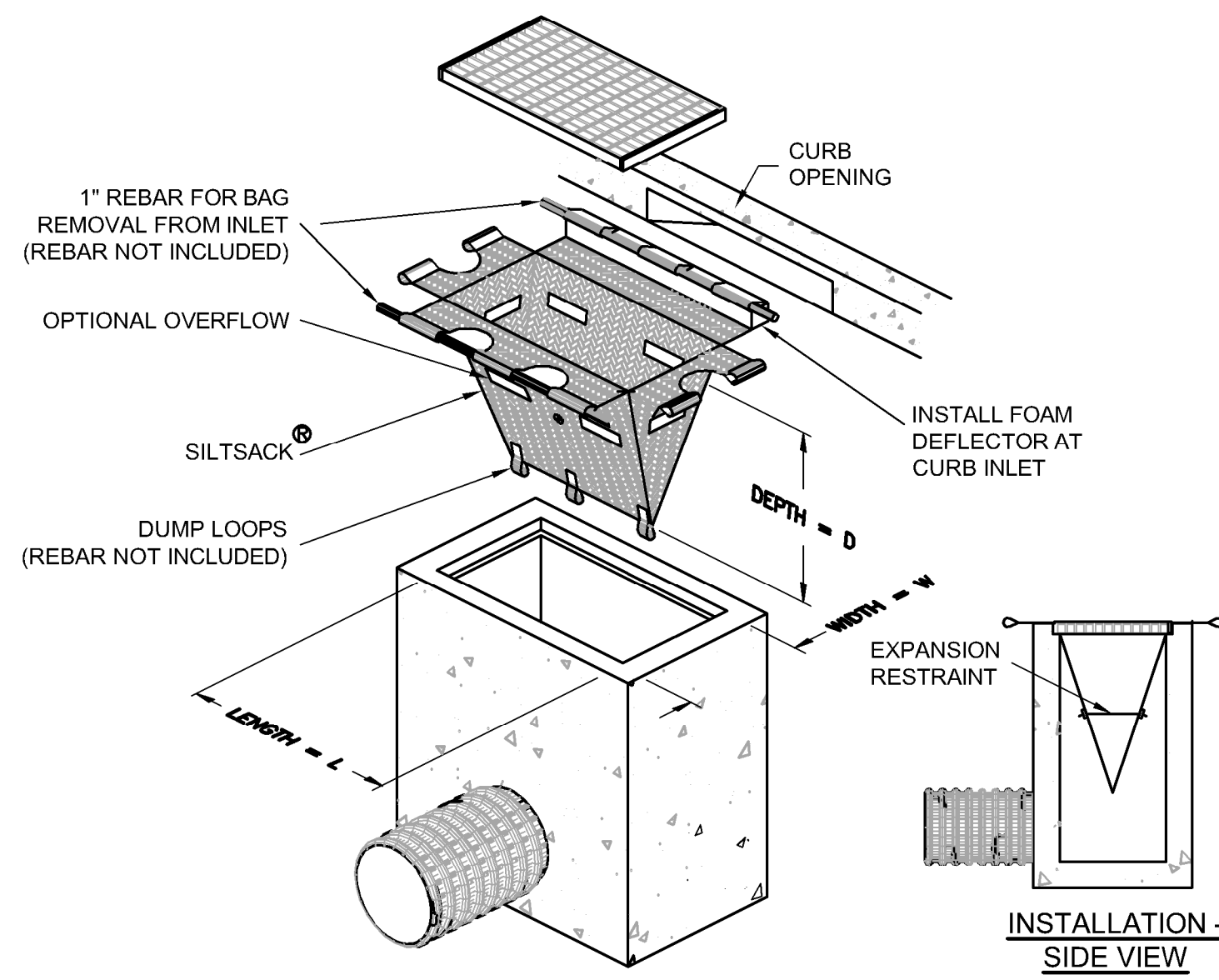

1 SEDIMENT CONTROL FILTER
 NOT TO SCALE

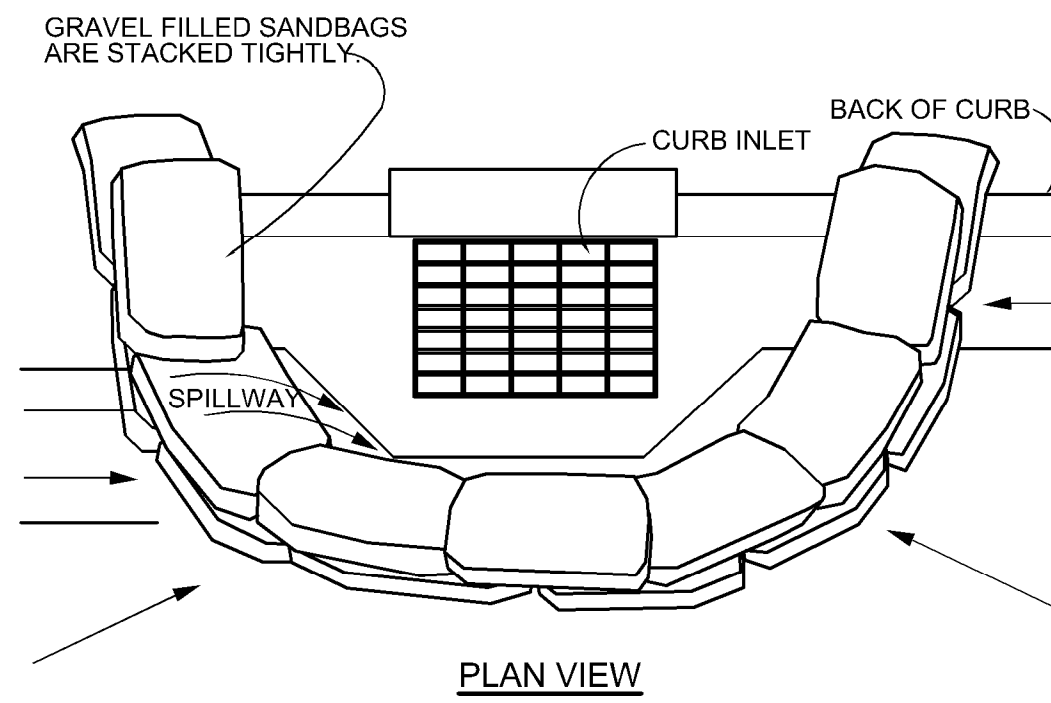

- NOTES:**
1. PLACE CURB TYPE SEDIMENT BARRIERS ON GENTLY SLOPING STREET SEGMENTS, WHERE WATER CAN POND AND ALLOW SEDIMENT TO SEPARATE FROM RUNOFF.
 2. SANDBAGS OF EITHER BURLAP OR WOVEN 'GEOTEXTILE' FABRIC, ARE FILLED WITH GRAVEL LAYERED AND PACKED TIGHTLY.
 3. LEAVE A ONE SANDBAG GAP IN THE TOP ROW TO PROVIDE A SPILLWAY FOR OVERFLOW.
 4. INSPECT BARRIERS AND REMOVE SEDIMENT IMMEDIATELY BEFORE AND AFTER EACH STORM EVENT. SEDIMENT AND GRAVEL MUST BE REMOVED FROM THE TRAVELED WAY IMMEDIATELY.

2 CURB INLET SEDIMENT BARRIER
 NOT TO SCALE

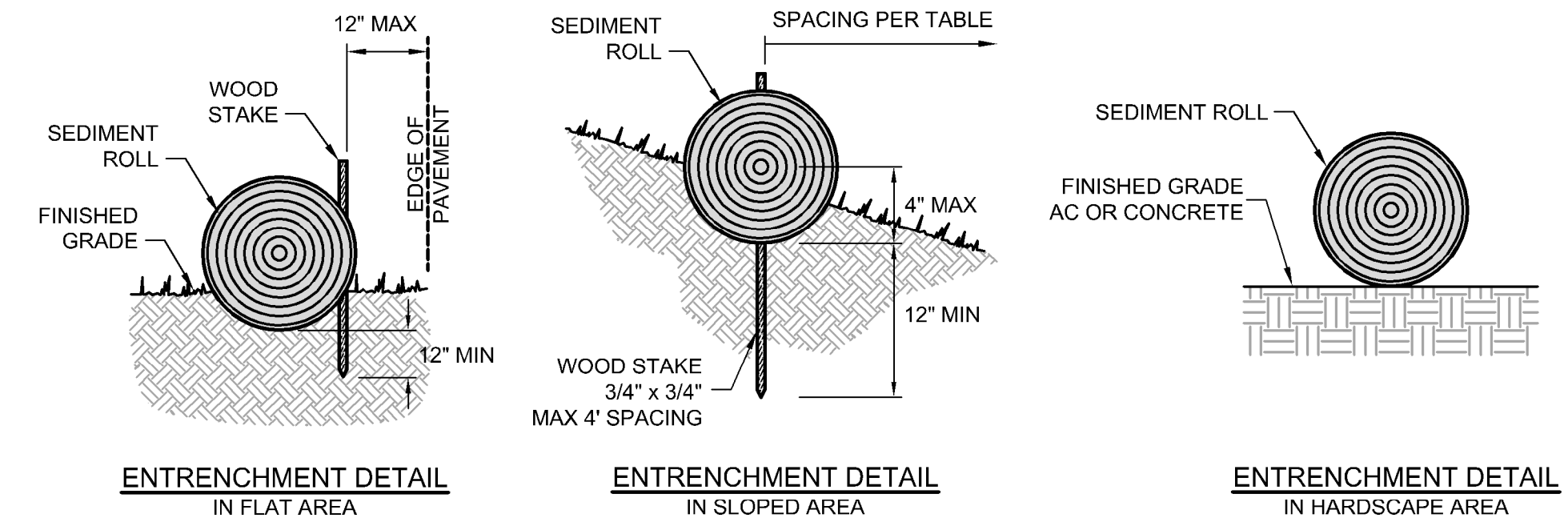

BANK SLOPE	INTERVAL
LESS THAN 4:1	20 FEET
4:1 TO 2:1	15 FEET
GREATER THAN 2:1	10 FEET

- NOTES:**
1. FIBER ROLLS ARE TUBES MADE FROM POROUS BIODEGRADABLE FIBER STUFFED IN A PHOTO-DEGRADABLE OPEN WEAVE NETTING. THEY ARE APPROXIMATELY 8" DIAMETER.
 2. FIBER ROLL INSTALLATION REQUIRES THE PLACEMENT AND SECURE STAKING OF THE ROLL IN A TRENCH, 2"-4" DEEP, DUG ON CONTOUR. RUNOFF MUST NOT BE ALLOWED TO RUN UNDER OR AROUND ROLL. ROLLS SHOULD BE ABUTTED SECURELY TO PROVIDE A TIGHT JOINT, NOT OVERLAPPED.
 3. FIBER ROLLS LOCATED ON PAVEMENT SHALL BE SECURED AS NEEDED WITH GRAVEL-FILLED BAGS AS DIRECTED BY THE ENGINEER.

3 FIBER ROLL
 NOT TO SCALE

REVISIONS		DATE	BY	APP'D
NO.	DESCRIPTION			
ADDENDUM #2		9/04/19		

BKF
 ENGINEERS / SURVEYORS / PLANNERS

4040 CIVIC CENTER DRIVE
 SUITE 530
 SAN RAFAEL, CA 94903
 415-392-7880 (TEL)
 415-392-7879 (FAX)

CHECKED: DBJ
 APPROVED: DBJ
 DRAWN: DK
 DESIGNED: CL

MUNI LOT 2
 IMPROVEMENT PROJECT
 EROSION CONTROL DETAILS
 MARIN COUNTY
 SAUSALITO
 CALIFORNIA

DATE	SCALE
SEP 2019	AS SHOWN
BKF PROJECT NO.	20165272
CLIENT	CITY OF SAUSALITO
SHEET NO.	8 OF 11
DRAWING NO.	EC.02



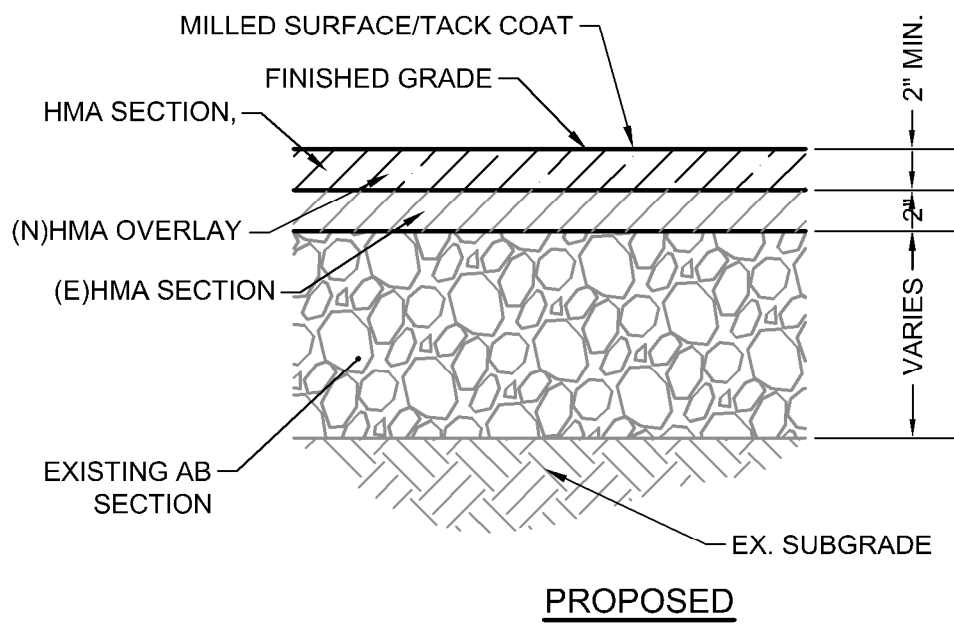
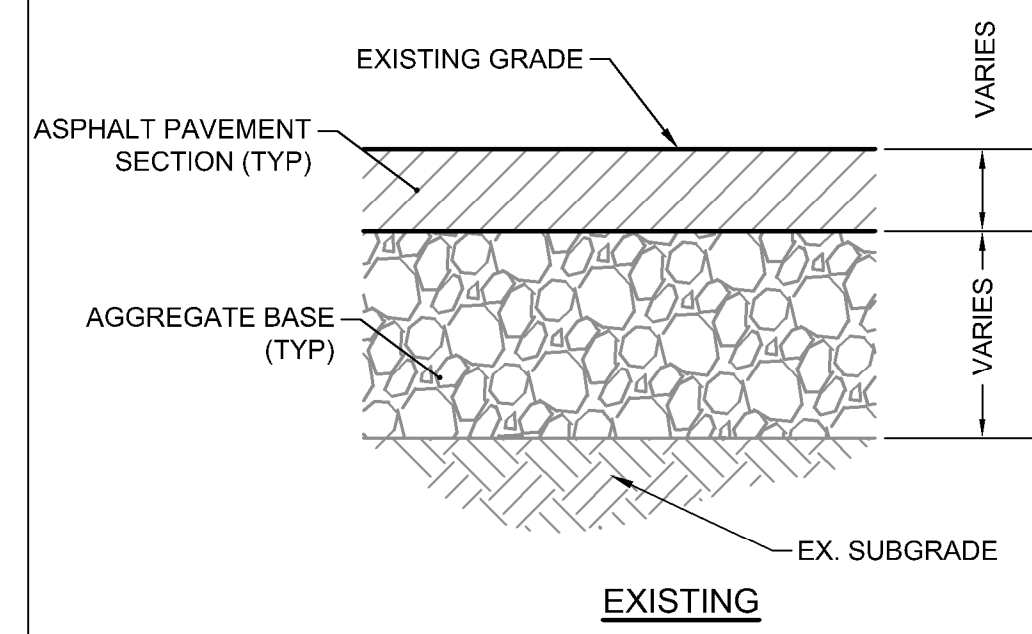
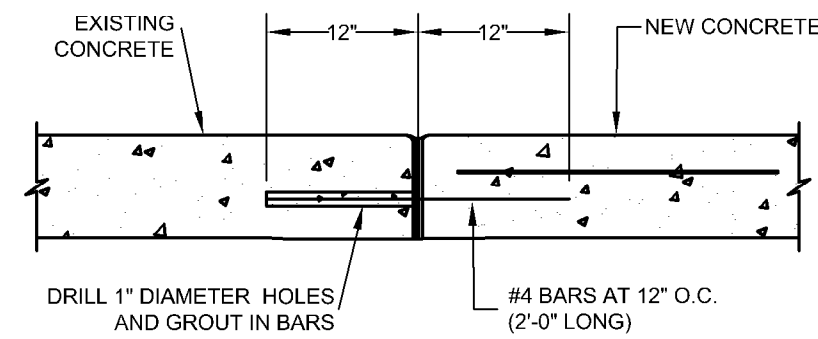

NOTES

1. FINISHED AC GRADE SHALL MATCH EXISTING SURFACE UNLESS OTHERWISE SHOWN ON THE GRADING PLANS OR DIRECTED BY THE PROJECT ENGINEER. SEE GRADING PLAN CONTOURS AND FINISH SURFACE ELEVATIONS.
2. FINISHED GRADE HMA SHALL REMAIN 3/8" ABOVE LIP OF GUTTER.
3. AFTER GRINDING, CONTRACTOR SHALL INSPECT AREAS OF PROPOSED DIGOUTS FOR HEAVING. IF HEAVING IS OBSERVED CONTRACTOR SHALL PERFORM FULL DEPTH AC REPLACEMENT IN THE SPECIFIED AREAS PER DETAIL 4, SHEET CD.01.

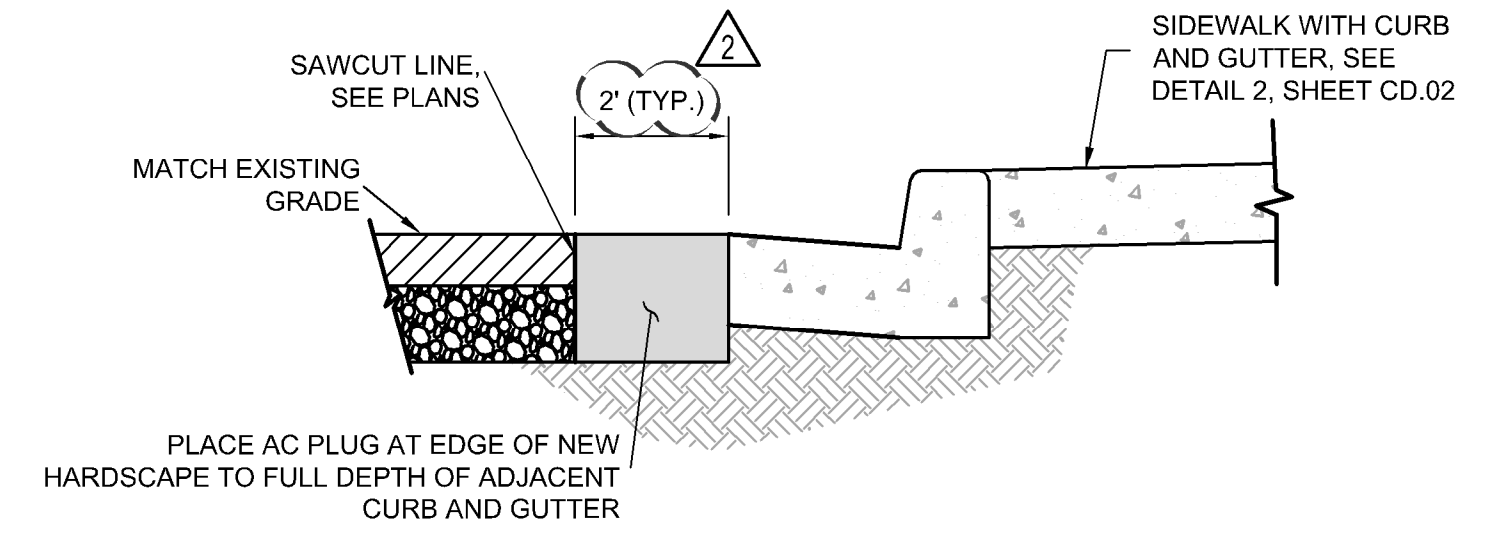

CONNECT TO EXISTING CONCRETE
NOT TO SCALE

1

ASPHALT GRIND AND OVERLAY
NOT TO SCALE

2

FULL DEPTH ASPHALT PLUG
NOT TO SCALE

3

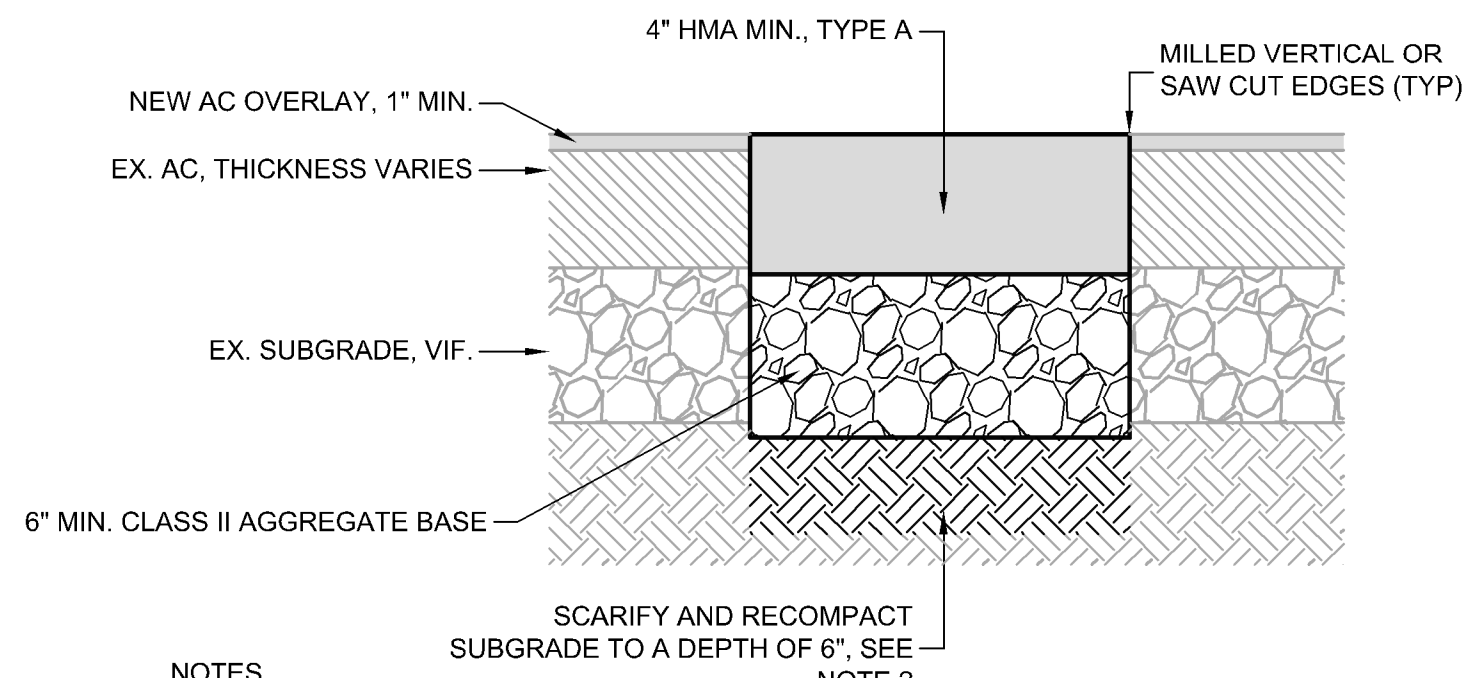

NOTES

1. FOR FULL DEPTH AC PAVING REPLACEMENT AREAS AND LOCATIONS, REFER TO CONSTRUCTION DRAWINGS
2. IF PCC IS ENCOUNTERED DURING BASE FAILURE REPAIR OPERATIONS, THE CONTRACTOR SHALL FULLY REMOVE THE PCC PRIOR TO SCARIFICATION AND RECOMPACT.
3. IF CONTRACTOR DISCOVERS WITHIN THE PAVEMENT SECTION PILES OR OTHER OBJECTS WHICH MAY LEAD TO VOIDS OR CAVING OF PAVEMENT, CONTRACTOR SHALL REMOVE OBJECT TO A DEPTH OF FIVE FEET BELOW THE BOTTOM OF SUBGRADE, AND BACKFILL WITH A SLURRY SOLUTION.

FULL DEPTH AC PAVING REPLACEMENT
NOT TO SCALE

4

NOT USED
NOT TO SCALE

5

CONNECT NEW PIPE TO EXISTING STRUCTURE
NOT TO SCALE

6

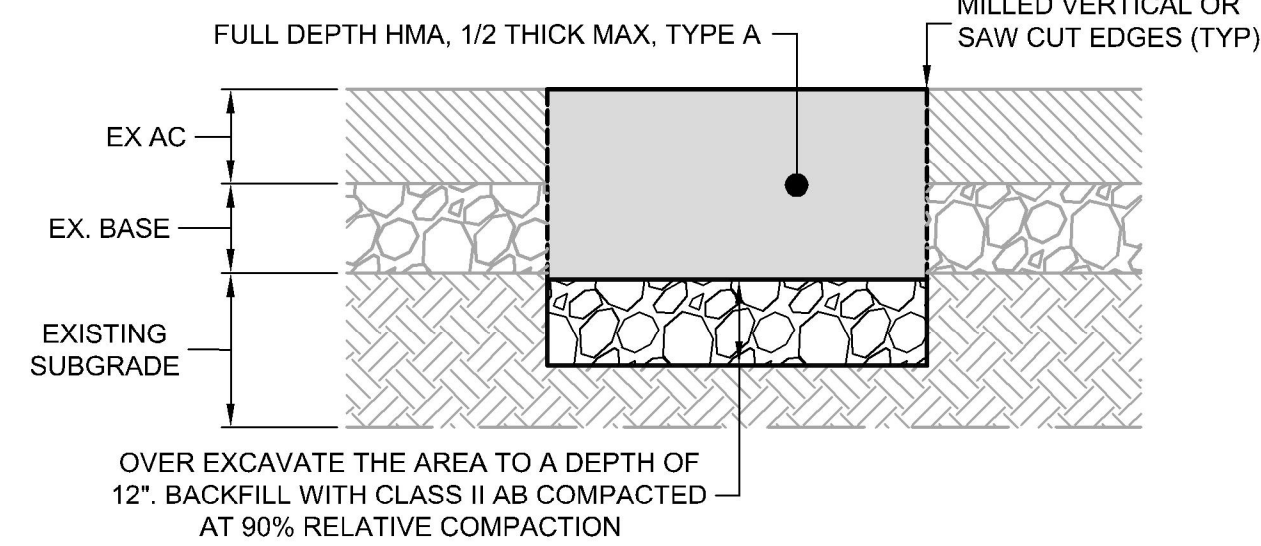
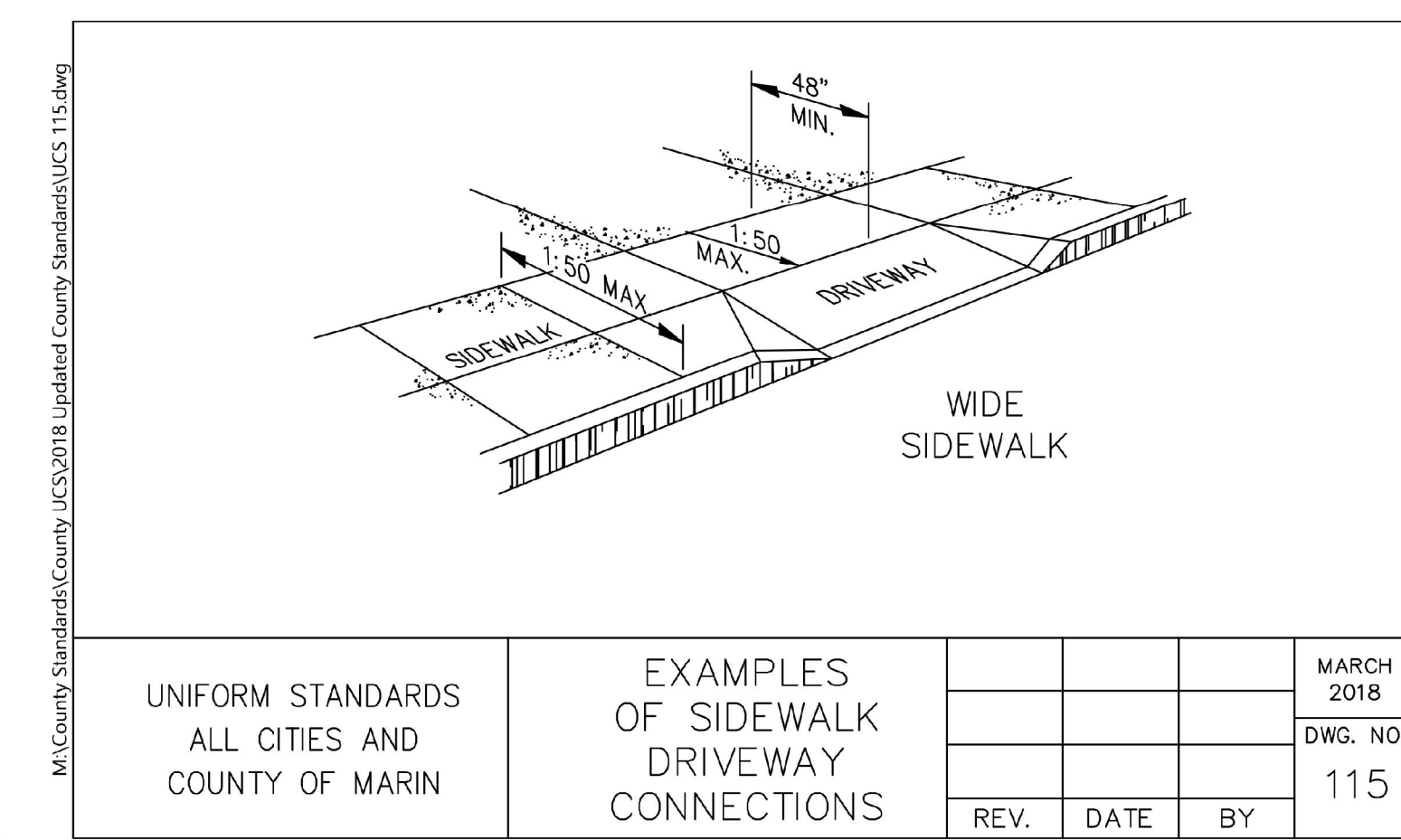
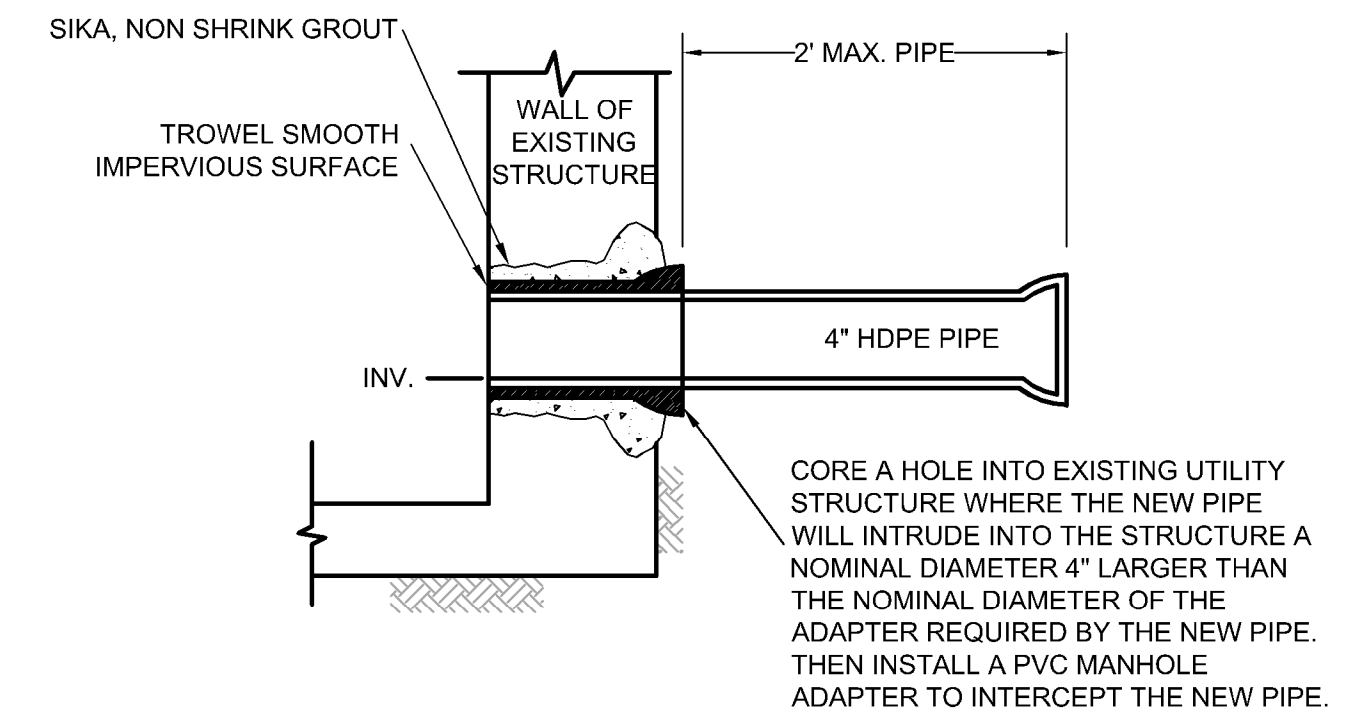

SOFT SUBGRADE REPAIR
NOT TO SCALE

8

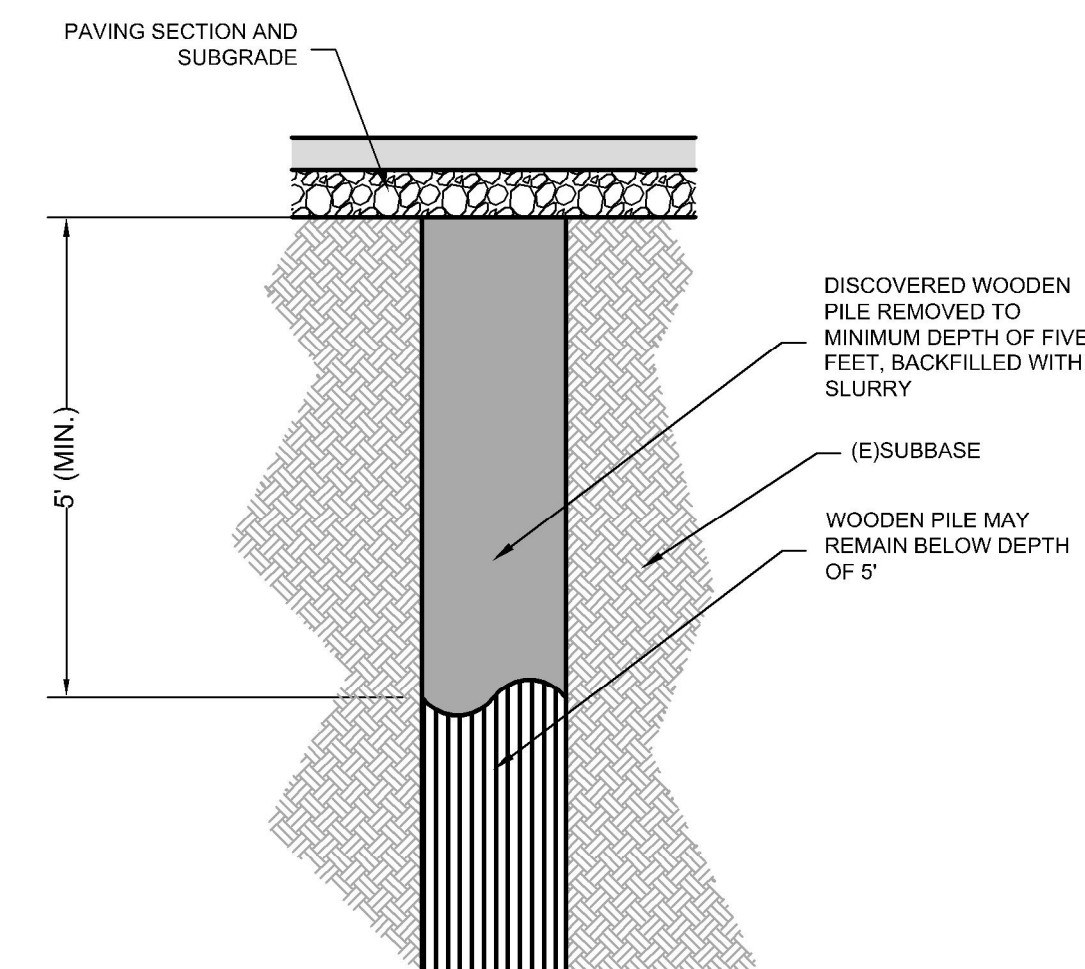

WOODEN PILE REMOVAL
NOT TO SCALE

9

MARIN COUNTY UCS DRAWING 115, EXCERPT
NOT TO SCALE

7

REVISIONS

NO.	DESCRIPTION	BY	DATE
1			9/04/19
2			
3			
4			
5			
6			
7			
8			
9			

4040 CIVIC CENTER DRIVE SUITE 530 SAN RAFAEL, CA 94903 415-330-7980 (TEL) 415-330-7979 (FAX)	DBJ	DBJ
BKF ENGINEERS / SURVEYORS / PLANNERS	DK	CL
CHECKED: DBJ	DESIGNED: CL	APPROVED: DBJ

MUNI LOT 2		CALIFORNIA
IMPROVEMENT PROJECT		MARIN COUNTY
CONSTRUCTION DETAILS		SAUSALITO
DATE	SCALE	
SEP 2019	AS SHOWN	
PROJECT NO.		
20165272		
CITY OF SAUSALITO		
SHEET NO.		
9 OF 11		
DRAWING NO.		
CD.01		

K:\2016\165272_Sausalito 2016-2019 Street Rehab\ENG SHEETS\Lot 2\06_Lot 2_CD.dwg 9-04-19 03:11:24 PM swif
PLOT SCALE: 1 = 1
VIEWPORT ROTATION: XX

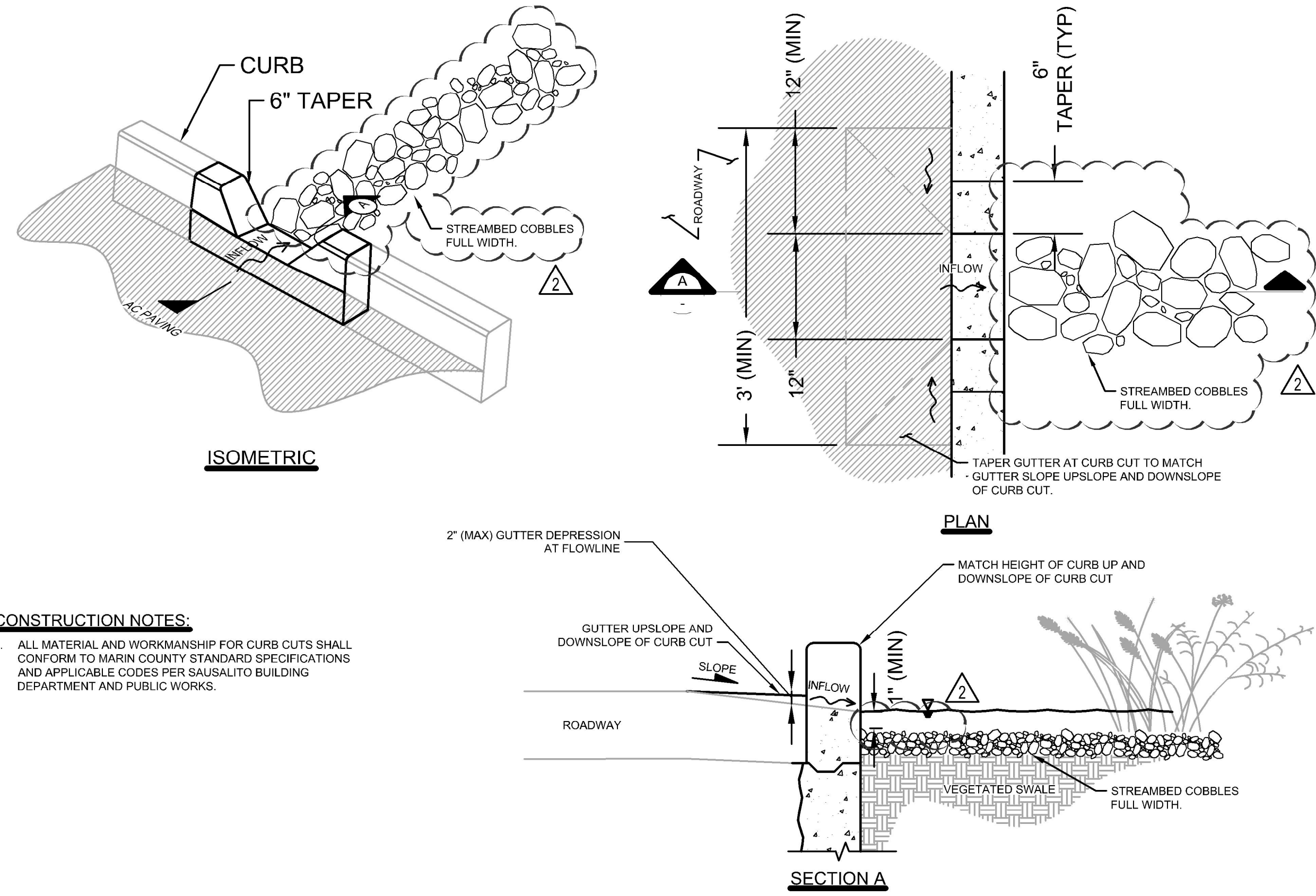

CONSTRUCTION NOTES:

1. ALL MATERIAL AND WORKMANSHIP FOR CURB CUTS SHALL CONFORM TO MARIN COUNTY STANDARD SPECIFICATIONS AND APPLICABLE CODES PER SAUSALITO BUILDING DEPARTMENT AND PUBLIC WORKS.

1. EXISTING CONCRETE SHALL BE REMOVED AT EXPANSION OR WEAKENED PLANE JOINTS OR AT SAWCUTS AS FIELD MARKED BY AGENCY ENGINEER. SAWCUTS MUST GO ENTIRELY THROUGH CONCRETE.
2. FOR NEW DEVELOPMENT, NO UTILITY BOXES OR POLES WILL BE PERMITTED IN THE SIDEWALK AREA WITHOUT THE PRIOR WRITTEN APPROVAL OF THE AGENCY ENGINEER.
3. WHERE UNDERCUT SUBGRADE OR UNSUITABLE SUBGRADE MATERIAL IS ENCOUNTERED, THE AGENCY ENGINEER MAY REQUIRE REMEDIAL WORK TO BE DONE, INCLUDING OVER EXCAVATION AND BACKFILLING WITH CRUSHED ROCK AND, WHEN DIRECTED BY THE ENGINEER, PLACING GEOTEXTILE FABRIC BENEATH THE NEW CONCRETE SECTION.
4. SUBGRADE SHALL BE COMPACTED TO AT LEAST 95% RELATIVE COMPACTION IN THE TOP SIX INCHES.
5. NEW WORK SHALL MATCH EXISTING AS CLOSELY AS POSSIBLE IN FINISH, SCORING AND COLOR. FOR NEW INSTALLATIONS PLACED ADJACENT TO EXISTING, 2LB. DAVIS BLACK #8084 (OR EQUIVALENT) PER CU. YD. CONCRETE SHALL BE ADDED TO MIX.
6. EXCEPT WHERE SPECIFIED OTHERWISE HEREIN, NO ADMIXTURES SHALL BE USED WITHOUT THE PERMISSION OF THE AGENCY ENGINEER.
7. FORMS SHALL MEET GRADE AND FORM FACES SHALL NOT VARY FROM THE DIMENSIONS SHOWN BY MORE THAN 1/2 INCH.
8. NO CONCRETE SHALL BE PLACED UNTIL THE AGENCY ENGINEER HAS INSPECTED AND APPROVED FORMS AND SUBGRADE/BASE.
9. SUBGRADE/BASE SHALL BE THOROUGHLY WETTED IMMEDIATELY PRIOR TO PLACING CONCRETE.
10. CONCRETE SHALL BE A MINIMUM CLASS B (S SACK MIX) WITH 1 INCH MAXIMUM AGGREGATE FROM AN APPROVED MIXING PLANT. NO BAGGED MIX IS PERMITTED.
11. CONCRETE SHALL HAVE A SLUMP OF NOT MORE THAN FOUR INCHES.
12. FOR SIDEWALKS AND DRIVEWAY APPROACHES, 1/4 INCH DEEP SCORE LINES SHALL BE PLACED AT FOUR FEET ON CENTER OR AS DIRECTED BY THE AGENCY ENGINEER.
13. WEAKENED PLANE JOINTS AT LEAST 3/4\"/>

UNIFORM STANDARDS ALL CITIES AND COUNTY OF MARIN	REQUIREMENTS FOR CONCRETE CURB, GUTTER, SIDEWALK, DRIVEWAY AND OTHER "FLATWORK"	REV.	DATE	BY	MARCH 2018 DWG. NO. 100
--	---	------	------	----	----------------------------------

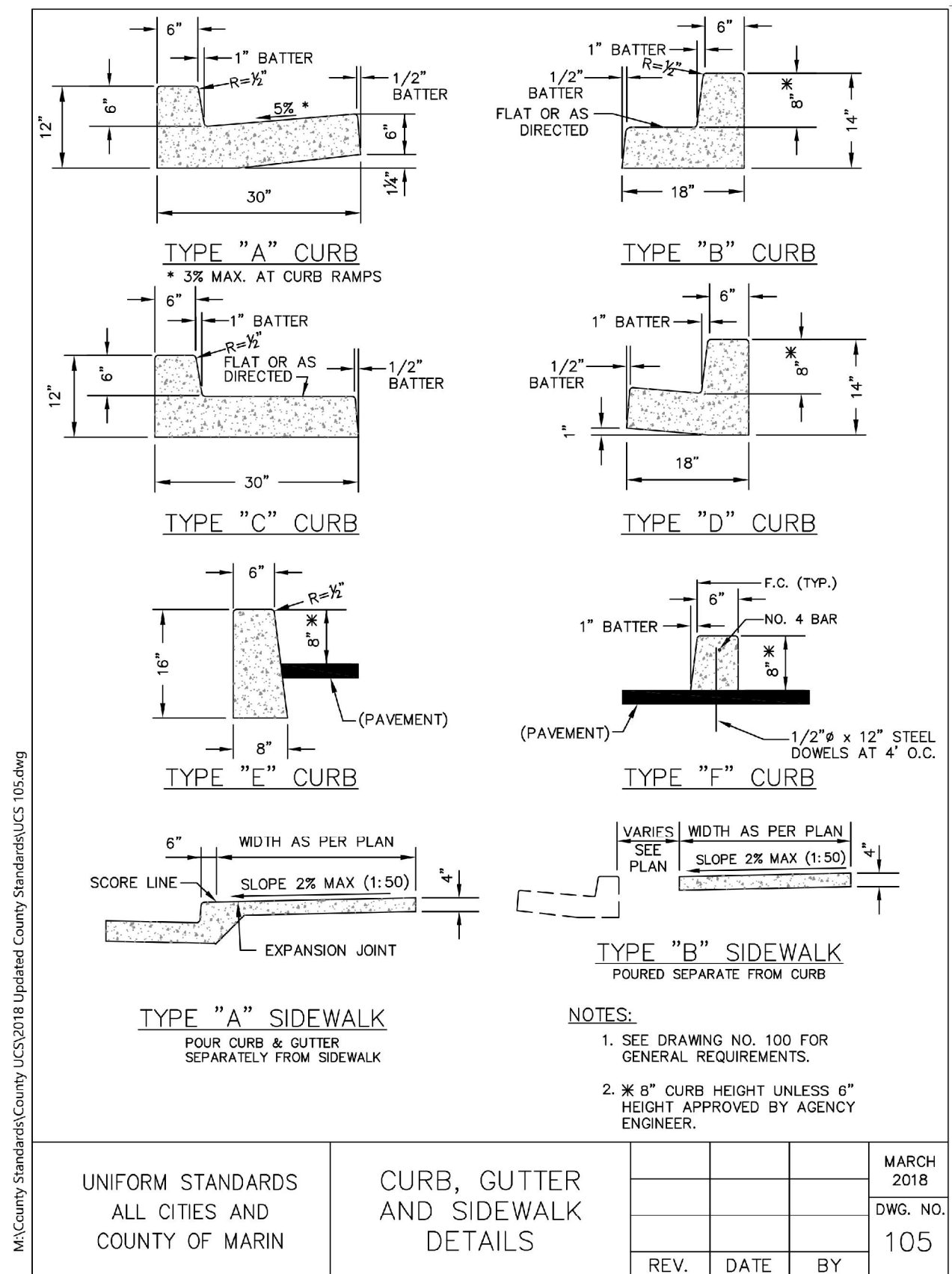

UNIFORM STANDARDS ALL CITIES AND COUNTY OF MARIN	CURB, GUTTER AND SIDEWALK DETAILS	REV.	DATE	BY	MARCH 2018 DWG. NO. 105
--	---	------	------	----	----------------------------------

SEGMENTED CURB AT VEGETATED SWALE DETAIL
NOT TO SCALE

1

COUNTY OF MARIN CURB, GUTTER, SIDEWALK DETAIL
NOT TO SCALE

2

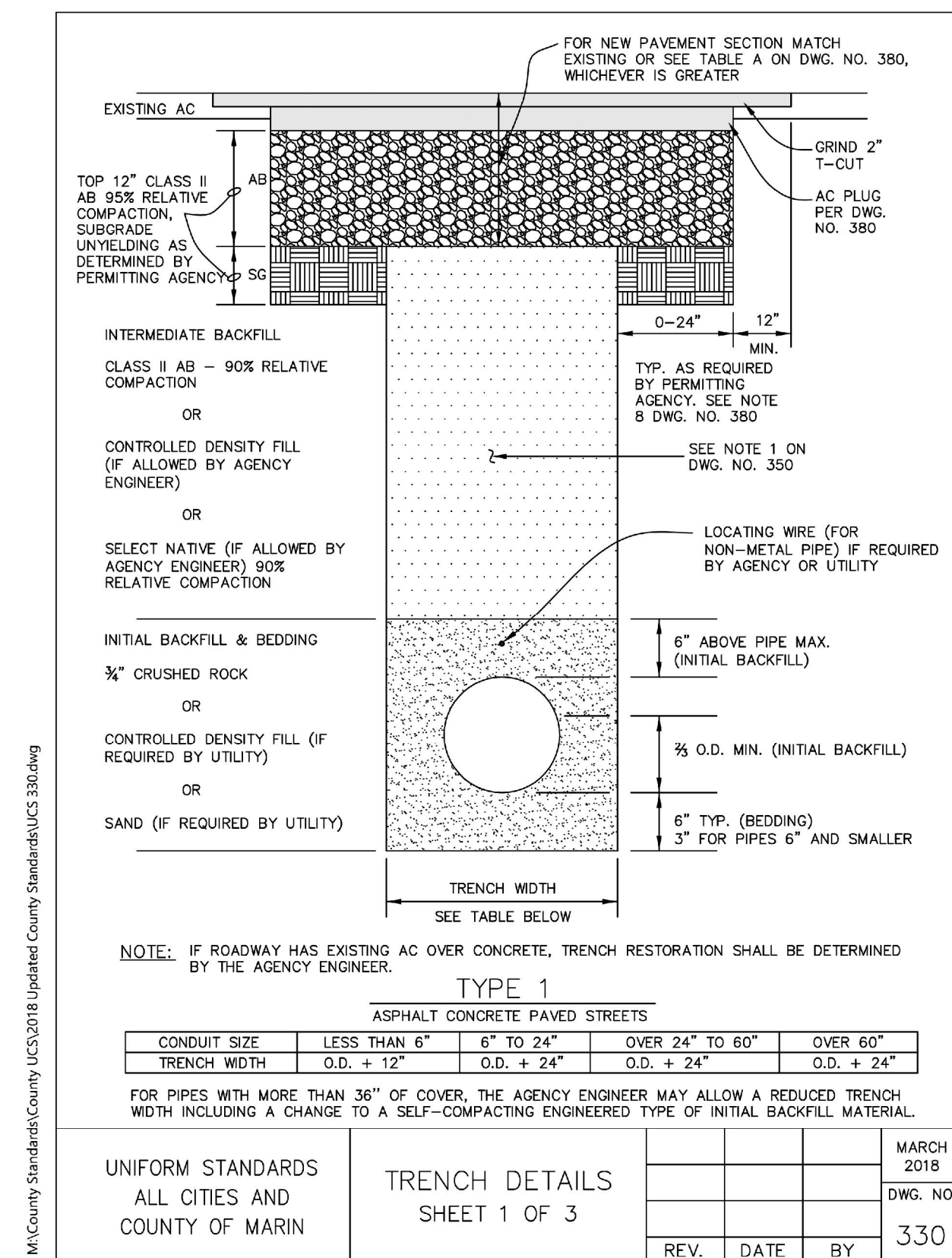

UNIFORM STANDARDS ALL CITIES AND COUNTY OF MARIN	TRENCH DETAILS SHEET 1 OF 3	REV.	DATE	BY	MARCH 2018 DWG. NO. 330
--	--------------------------------	------	------	----	----------------------------------

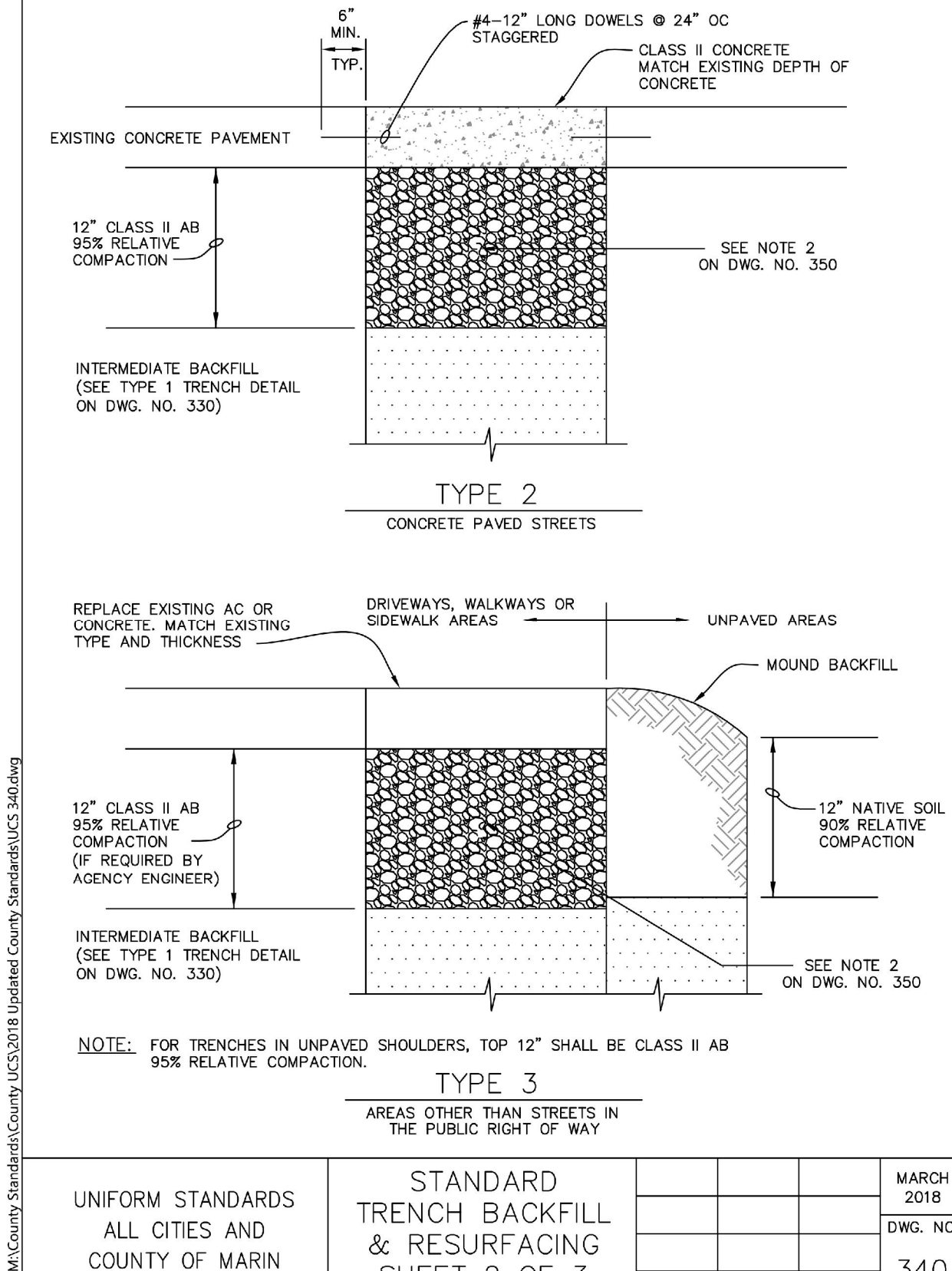

UNIFORM STANDARDS ALL CITIES AND COUNTY OF MARIN	STANDARD TRENCH BACKFILL & RESURFACING SHEET 2 OF 3	REV.	DATE	BY	MARCH 2018 DWG. NO. 340
--	--	------	------	----	----------------------------------

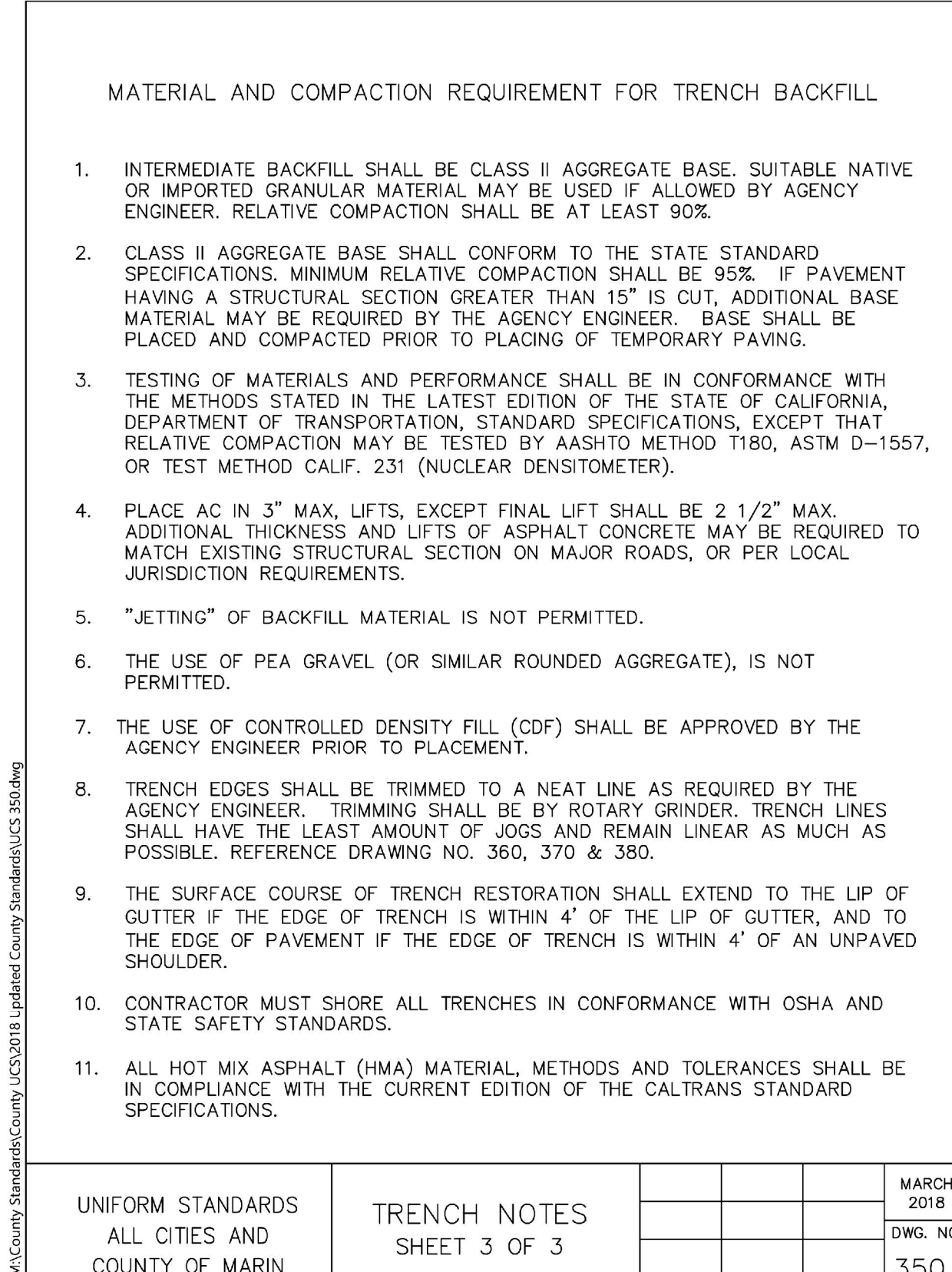

UNIFORM STANDARDS ALL CITIES AND COUNTY OF MARIN	TRENCH NOTES SHEET 3 OF 3	REV.	DATE	BY	MARCH 2018 DWG. NO. 350
--	------------------------------	------	------	----	----------------------------------

COUNTY OF MARIN TRENCH DETAIL
NOT TO SCALE

3

DATE		SEP 2019	SCALE	AS SHOWN
BKF PROJECT NO.		20165272		
CLIENT		CITY OF SAUSALITO		
SHEET NO.		10 OF 11		
DRAWING NO.		CD.02		
REVISIONS		ADDENDUM #2	DESCRIPTION	DATE
NO.				9/04/19
BY		DBJ	APPROVED	APP'VD
CHECKED		DK	DESIGNED	CL
DRAWN		DK	DESIGNED	CL
ENGINEERS / SURVEYORS / PLANNERS		DBJ	APPROVED	DBJ
4040 CIVIC CENTER DRIVE SUITE 530 SAN RAFAEL, CA 94903 415-330-7880 (TEL) 415-330-7879 (FAX)		CALIFORNIA		
MUNI LOT 2 IMPROVEMENT PROJECT COUNTY OF MARIN CONSTRUCTION DETAILS		MARIN COUNTY		
SAUSALITO		SAUSALITO		

k:\2016\165272_Sausalito\2016-2019 Street Rehab\ENG SHEETS\Lot 2\06_Lot 2_CD.dwg 9-04-19 03:11:42 PM swif
 PLOT SCALE: 1 = 1
 VIEWPORT ROTATION: XX

NOT USED
NOT TO SCALE

1

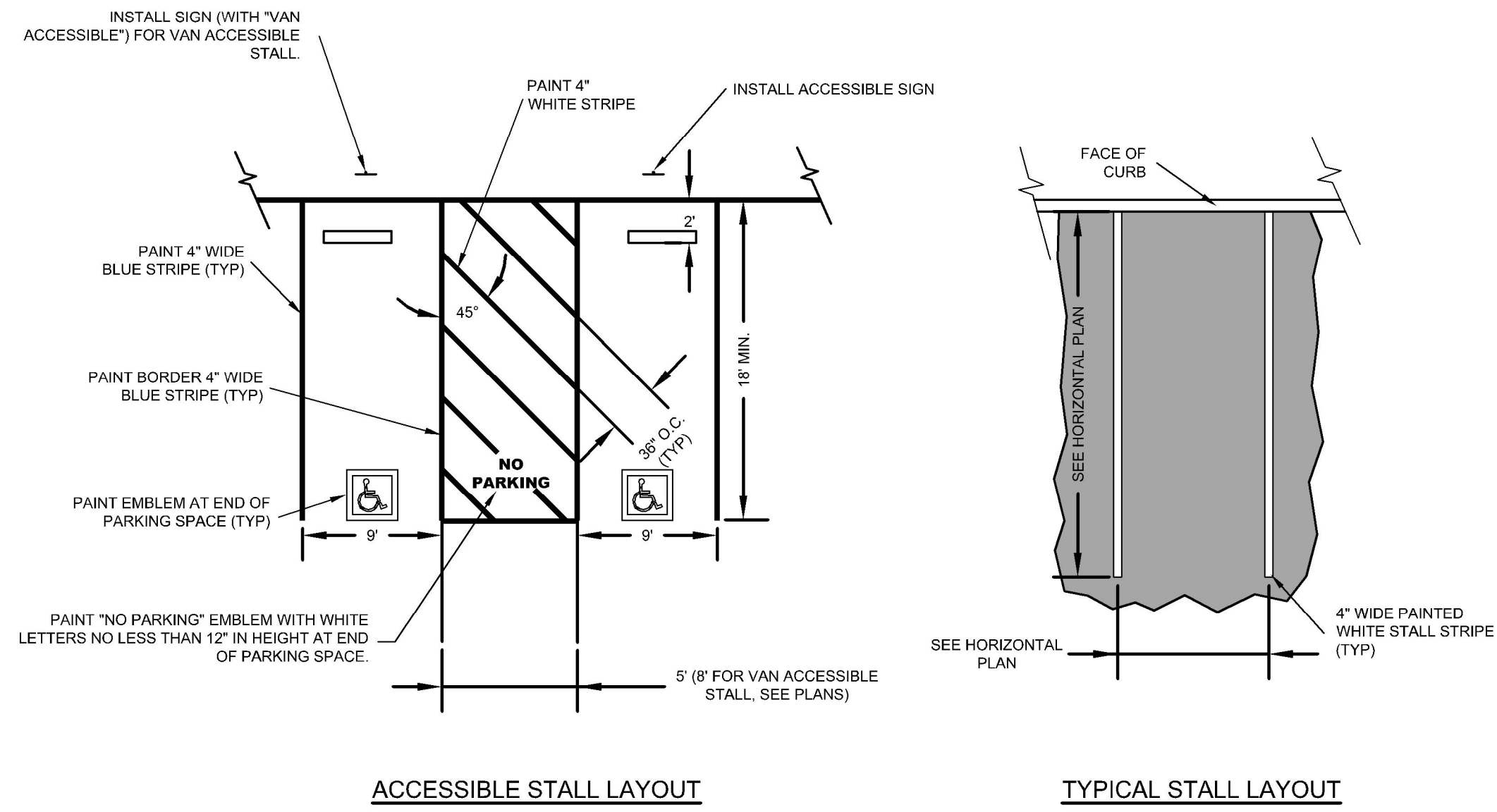

ACCESSIBLE STALL LAYOUT

TYPICAL STALL LAYOUT

PARKING LOT STRIPING DETAIL
NOT TO SCALE

2

R99-C ACCESSIBLE PARKING SIGN
NOT TO SCALE

4



NOT USED
NOT TO SCALE

5

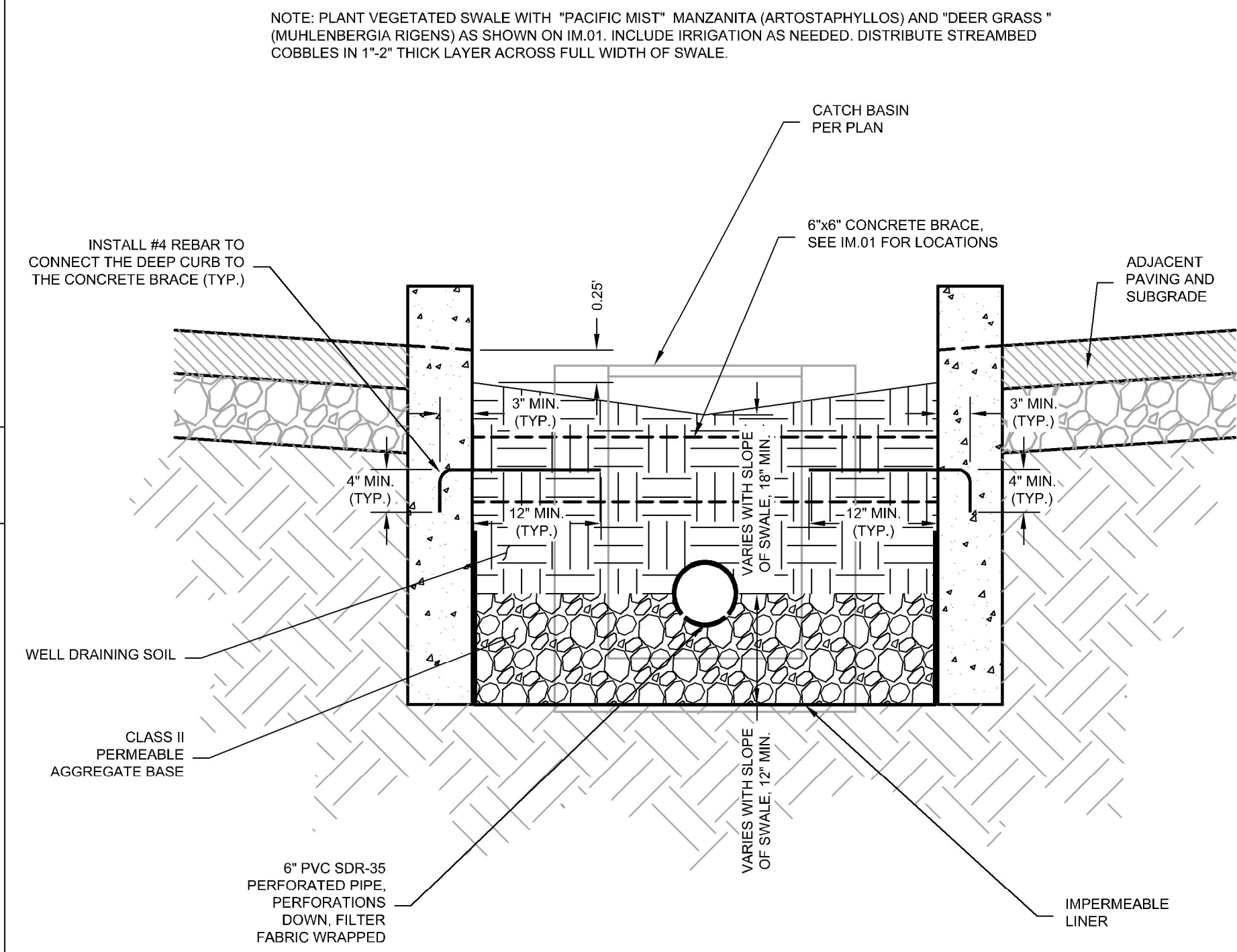

VEGETATED SWALE
NOT TO SCALE

6

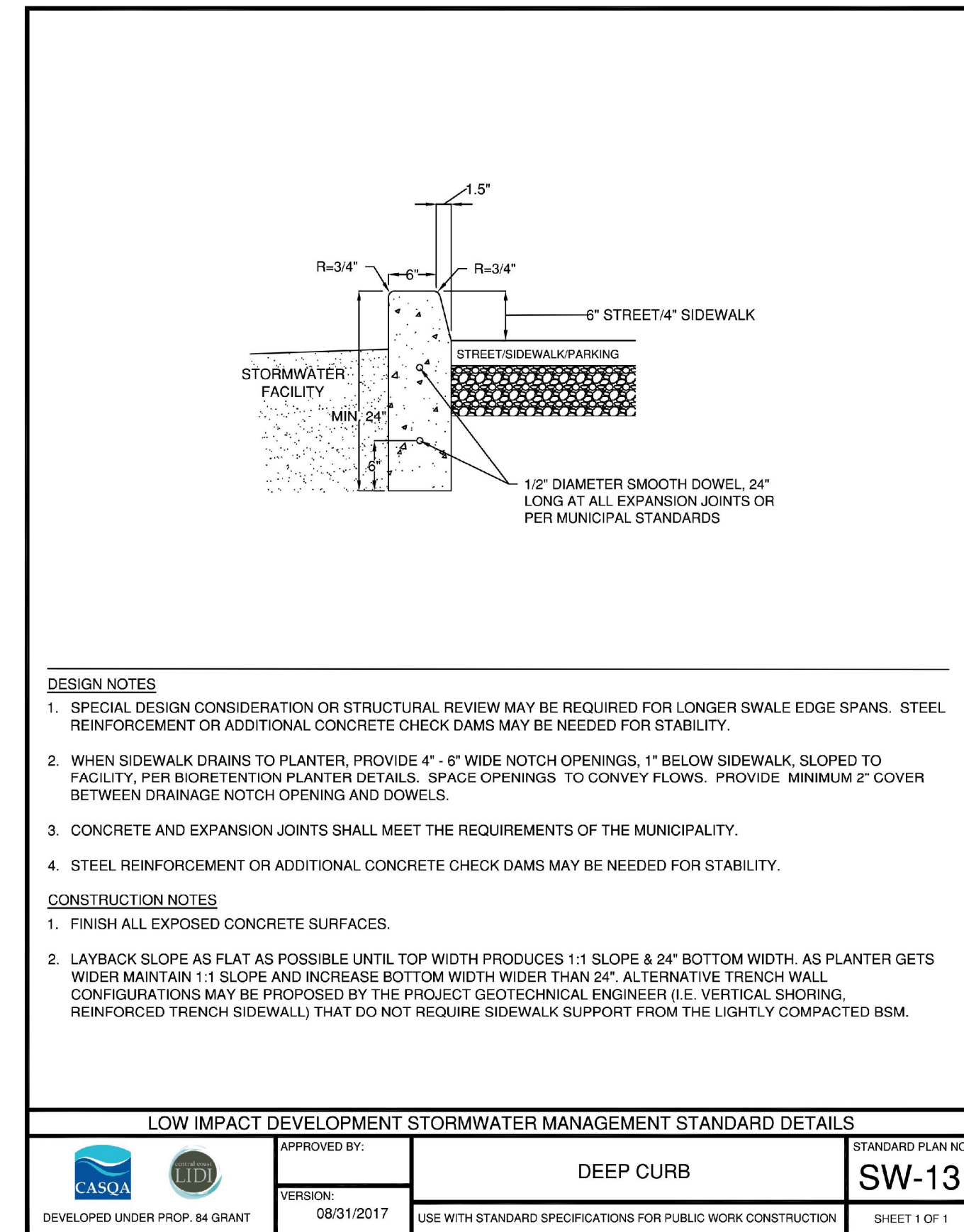

DEEP CURB AT VEGETATED SWALE
NOT TO SCALE

7

REVISIONS

NO.	DESCRIPTION	BY	DATE	APP'D
1				
2				
3				
4				

BKF
 ENGINEERS / SURVEYORS / PLANNERS
 4040 CIVIC CENTER DRIVE
 SUITE 530
 SAN RAFAEL, CA 94903
 415-390-7880 (TEL)
 415-390-7979 (FAX)

MUNI LOT 2
 IMPROVEMENT PROJECT
 COUNTY OF MARIN CONSTRUCTION DETAILS

SAUSALITO
 MARIN COUNTY
 CALIFORNIA

DATE	SCALE
SEP 2019	AS SHOWN
BKF PROJECT NO.	20165272
CLIENT	CITY OF SAUSALITO
SHEET NO.	11 OF 11
DRAWING NO.	CD.03