

CITY OF SAUSALITO DEPARTMENT OF PUBLIC WORKS PLANS FOR CONSTRUCTION OF BLOCK 303 SEWERAGE IMPROVEMENT PLANS CITY PROJECT NO: 12.02.003

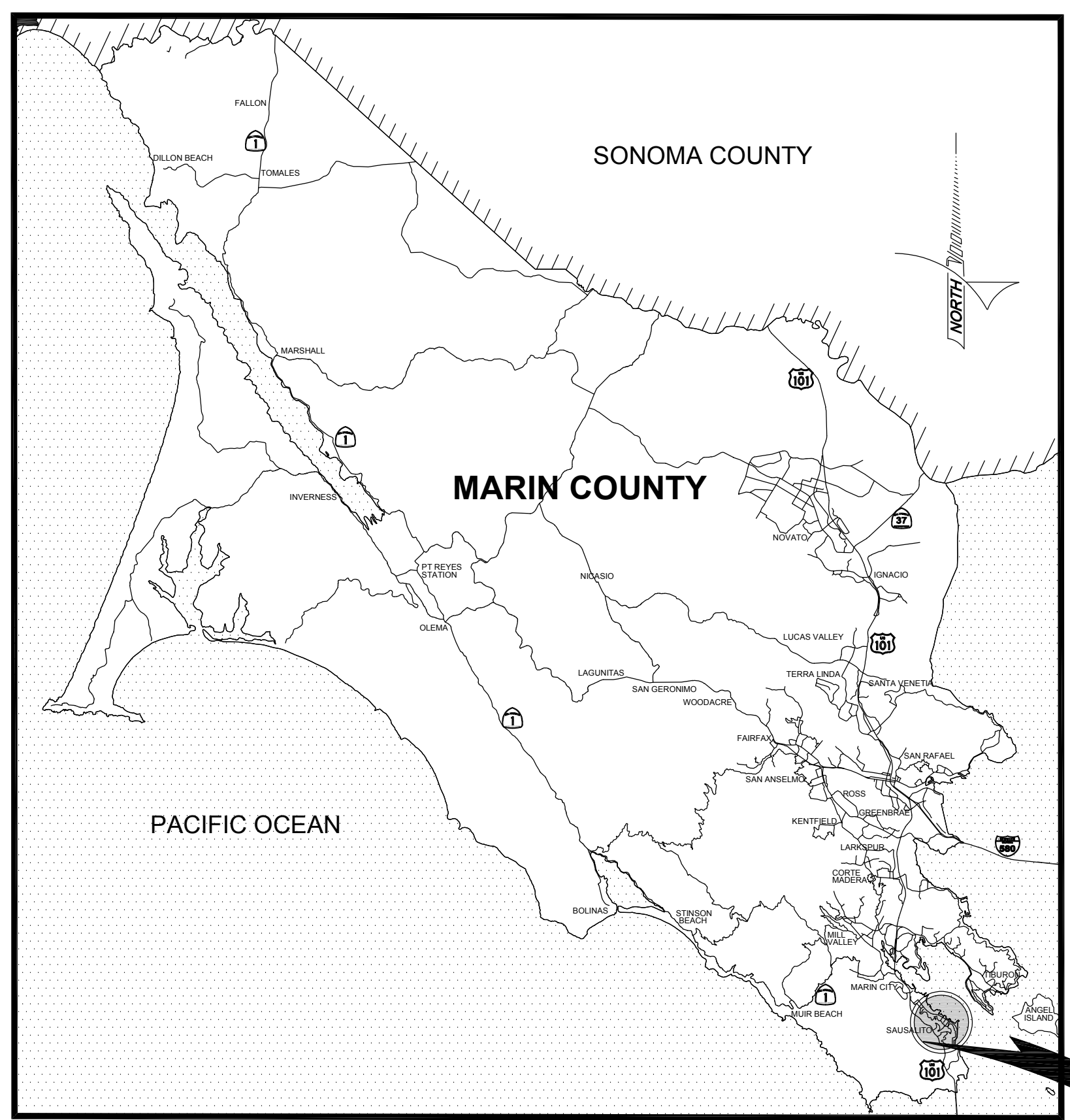

LOCATION MAP
 NOT TO SCALE

SHEET INDEX		
SHEET NO.	SHEET NO.	SHEET TITLE
SS1	1	COVER SHEET
SS2	2	GENERAL NOTES, ABBREVIATIONS, & SYMBOLS
SS3	3	LAYOUT PLAN - BASE BID
SS3.1	3	LAYOUT PLAN - ALTERNATE BID
SS4	4	DETAIL SHEET
SS5	5	DETAIL SHEET



PROJECT LOCATION
 1-INCH - 200 FT

Rev	Date	Description	Designed	Drawn	Checked

BLOCK 303 SEWER REHABILITATION
COVER SHEET
 SAUSALITO, CA
 ALEXANDER AVE

City Of
Sausalito
 County Of
Marin
 State Of
California

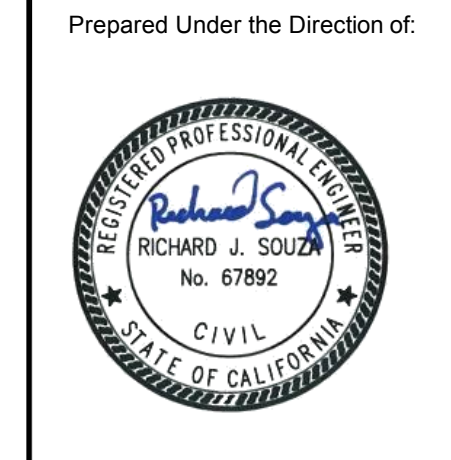

Sheet
SS1

Scale: as shown
 Date: MAY 18, 2024
 Project Number: 2300270
 Sheet Number: 1 of 6



ABBREVIATIONS

Table with 2 columns: Abbreviation and Description. Includes items like AB AGGREGATE BASE, AC ASPHALT CONCRETE, BAY CONSERVATION AND DEVELOPMENT COMMISSION, etc.

LINETYPES

Table showing existing and proposed linetypes for various infrastructure elements like sewer lines, retaining walls, fences, storm drains, gas lines, etc.

SYMBOLS

Table showing symbols for existing and proposed features like signs, streetlights, sanitary sewers, manholes, storm drainage catch basins, etc.

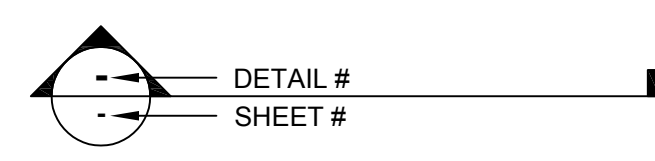
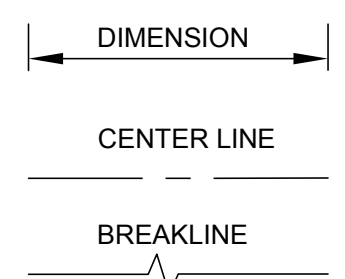

CONSTRUCTION NOTES:

- 1. SAWCUT EXISTING PAVEMENT AT LIMIT OF WORK, TYPICAL.
2. PROTECT ALL DRAINAGE AND SEWAGE STRUCTURES AND PIPES FROM INFILTRATION OF ALL CONSTRUCTION DEBRIS FOR THE DURATION OF THE WORK, PER THE WATER POLLUTION CONTROL PLAN (WPCP).

GENERAL NOTES:

- 1. ALL WORK SHOWN ON THESE PLANS SHALL BE ACCOMPLISHED IN ACCORDANCE WITH THE SPECIAL PROVISIONS, THE UNIFORM CONSTRUCTION STANDARDS OF THE CITIES OF MARIN AND THE COUNTY OF MARIN DATED JULY, 2018.
2. UTILITY LOCATIONS SHOWN ON THESE PLANS ARE APPROXIMATE ONLY AND MAY NOT BE COMPLETE.
3. PRIOR TO STARTING AN EXCAVATION, EXAMINE THE SITE FOR INDICATIONS THAT UNMARKED SUBSURFACE INSTALLATIONS EXIST.
4. THE CONTRACTOR IS RESPONSIBLE FOR MAINTAINING ADEQUATE DRAINAGE OF THE SITE, DURING INTERIM CONDITIONS OF CONSTRUCTION.
5. CONTRACTOR SHALL PROVIDE ALL MATERIAL, LABOR, EQUIPMENT, FOR INSTALLATION, IMPLEMENTATION, AND MAINTENANCE OF ALL SURFACE WATER POLLUTION PREVENTION MEASURES THROUGHOUT THE FULL EXTENT OF THE PROJECT.
6. PAVEMENT MARKINGS DISTURBED, DAMAGED IN ANY FORM, OR TO ANY DEGREE WHILE THE CONTRACTOR HAS CUSTODY OF THE SITE SHALL BE REPLACED IN THEIR ENTIRETY AT CONTRACTOR'S EXPENSE.
7. WHERE PARKING IS PERMITTED, THE CONTRACTOR SHALL POST "NO PARKING" SIGNS ON EACH PAVEMENT REHABILITATION STREET AND/OR WORK AREA.
8. CONTRACTOR TO PROVIDE NOTICE TO PROPERTY OWNERS AND RESIDENTS PRIOR TO MOBILIZATION TO THE SITE.
9. ALL EXISTING STREET SURFACE FEATURES (MAINTENANCE HOLES, CLEAN-OUTS, MONUMENTS, STRIPING, PAVEMENT MARKINGS, ETC.) SHALL BE REFERENCED BY THE CONTRACTOR PRIOR TO START OF ANY WORK.
10. TRAFFIC CONTROL SHALL BE SAFE AND PERFORMED IN ACCORDANCE WITH THE REQUIREMENTS OF THE LATEST "CA MANUAL OF UNIFORM TRAFFIC CONTROL".
11. PRIOR TO PERFORMING WORK THAT MAY DAMAGE SURVEY MONUMENTS (DISK, SPIKE, SHINER OR OTHER), CONTRACTOR SHALL OBTAIN CLEARANCE FROM COUNTY SURVEYOR.

POLLUTION CONTROL NOTES:

- 1. IF SIGNIFICANT SEDIMENT OR OTHER VISUAL SYMPTOMS OF IMPURITIES ARE NOTICED IN THE STORM WATER, CONTACT THE CITY ENGINEER IMMEDIATELY.
2. CONTRACTOR IS RESPONSIBLE FOR INSPECTION AND RESTORATION OF ALL ASPECTS OF THIS PLAN. SEDIMENT ON SIDEWALKS AND GUTTERS SHALL BE REMOVED BY SHOVEL AND/OR BROOM AND PLACED IN STOCKPILES.
3. ALL DUMPSTERS OR OTHER TRASH STORAGE ENCLOSURES SHALL BE UTILIZED SOLELY FOR NON-HAZARDOUS MATERIALS.
4. ALL EMPLOYEES, CONTRACTORS, AND SUBCONTRACTORS ARE RESPONSIBLE FOR CONFORMING TO THE ELEMENTS SHOWN ON THIS PLAN OR RELATED DOCUMENTS.
5. THE CONTRACTOR IS RESPONSIBLE FOR OBTAINING ALL PERMITS AND FILING ALL PLANS WITH RELATED AGENCIES ASSOCIATED WITH THEIR WORK.
6. CONTRACTOR SHALL LOCATE STORAGE, DELIVERY, OR WASH-OUT AREAS, TO SUIT THEIR OPERATIONS.
7. CONTRACTOR SHALL UTILIZE SILT FILTERS DURING CONCRETE CONSTRUCTION NEAR EXISTING STORM DRAINAGE SYSTEM.

EROSION CONTROL NOTES:

- 1. NO VEHICLES SHALL BE ALLOWED TO TRACK OR SPREAD SOIL FROM THE CONSTRUCTION AREAS ONTO EXISTING PAVED PUBLIC STREETS.
2. THE EROSION AND SEDIMENT CONTROL MEASURES WILL BE OPERABLE FOR DURATION OF PROJECT.
3. DURING THE RAINY SEASON, ALL PAVED AREAS WILL BE KEPT CLEAR OF EARTH MATERIAL AND DEBRIS.

URBAN RUNOFF POLLUTION NOTES:

- 1. STABILIZE ALL DENUDEED AREAS AND MAINTAIN EROSION CONTROL MEASURES CONTINUOUSLY FOR THE DURATION OF THE PROJECT.
2. REMOVE SPOILS PROMPTLY AND AVOID STOCKPILING OF FILL MATERIALS WHEN RAIN IS FORECAST.
3. STORE, HANDLE AND DISPOSE OF CONSTRUCTION MATERIALS AND WASTES SO AS TO PREVENT THEIR ENTRY TO THE STORM DRAIN SYSTEM.
4. USE FILTRATION OR OTHER MEASURES TO REMOVE SEDIMENT FROM DEWATERING EFFLUENT.
5. NO CLEANING, FUELING OR MAINTAINING VEHICLES ON SITE SHALL BE PERMITTED IN ANY MANNER THAT ALLOWS DELETERIOUS MATERIALS TO ENTER CATCH BASINS OR TO ENTER SITE RUNOFF.
6. CONTRACTOR TO RELOCATE CONCRETE WASHDOWN, VEHICLE STORAGE DELIVERY, AND NON HAZARDOUS WASTE AREAS AS NECESSARY TO FACILITATE THEIR OPERATION.

PRESERVATION OF SURVEY MONUMENTS

CONTRACTOR SHALL PRESERVE ALL SURVEY MONUMENTS WITHIN THE LIMITS OF WORK. MONUMENT(S) WITHIN THE LIMITS OF WORK SHALL BE REFERENCED, PRIOR TO WORK COMMENCING, BY A LICENSED LAND SURVEYOR AS REQUIRED BY SECTION 8771 OF THE BUSINESS AND PROFESSIONS CODE.

THE CONTRACTOR SHALL BE RESPONSIBLE FOR THE PRESERVATION OF EXISTING SURVEY MONUMENTS, BENCHMARKS, REFERENCE MARKS AND STAKES. SHOULD ANY SURVEY MONUMENTS, BENCHMARKS, REFERENCE POINTS, OR STAKES BE DAMAGED OR DESTROYED DURING THE PERFORMANCE OF THIS WORK, THE CONTRACTOR SHALL REPLACE SAID ITEMS PER CITY CONSTRUCTION STANDARDS.

SURVEY NOTES

- 1. DISTANCES SHOWN ARE IN FEET AND DECIMALS THEREOF.
2. FIELD SURVEY WITHIN ALEXANDER ROADWAY WAS PERFORMED IN AUGUST OF 2010 AND NOVEMBER OF 2023 BY CSW/STUBER-STROEH ENGINEERING GROUP, INC.

PROJECT STANDARD PLANS

SAUSALITO MARIN CITY SANITARY DISTRICT
SD17 RESIDENTIAL SEWAGE EJECTION SYSTEM

UNIFORM CONSTRUCTION STANDARDS (UCS) OF THE CITIES OF MARIN AND COUNTY OF MARIN, JULY 2018

UCS DWG. NO. 100 REQUIREMENTS FOR CONCRETE CURB, GUTTER, SIDEWALK, DRIVEWAY, AND OTHER "FLATWORK"
UCS DWG. NO. 105 CURB, GUTTER AND SIDEWALK DETAILS



CSW/Stuber-Stroeh Engineering Group, Inc.
45 Leveroni Court
Novato, CA 94949

http://www.cswst2.com

Revision table with columns: Rev, Date, Description, Designed, Drawn, Checked.

BLOCK 303 SEWER REHABILITATION
GENERAL NOTES,
ABBREVIATIONS, & SYMBOLS
SAUSALITO, CA

City Of Sausalito
County Of Marin
State Of California

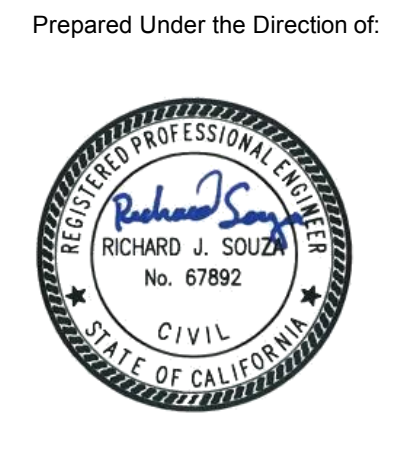

Sheet information table: Sheet SS2, Scale n/a, Date MAY 18, 2024, Project Number 2300270, Sheet Number 2 of 6.

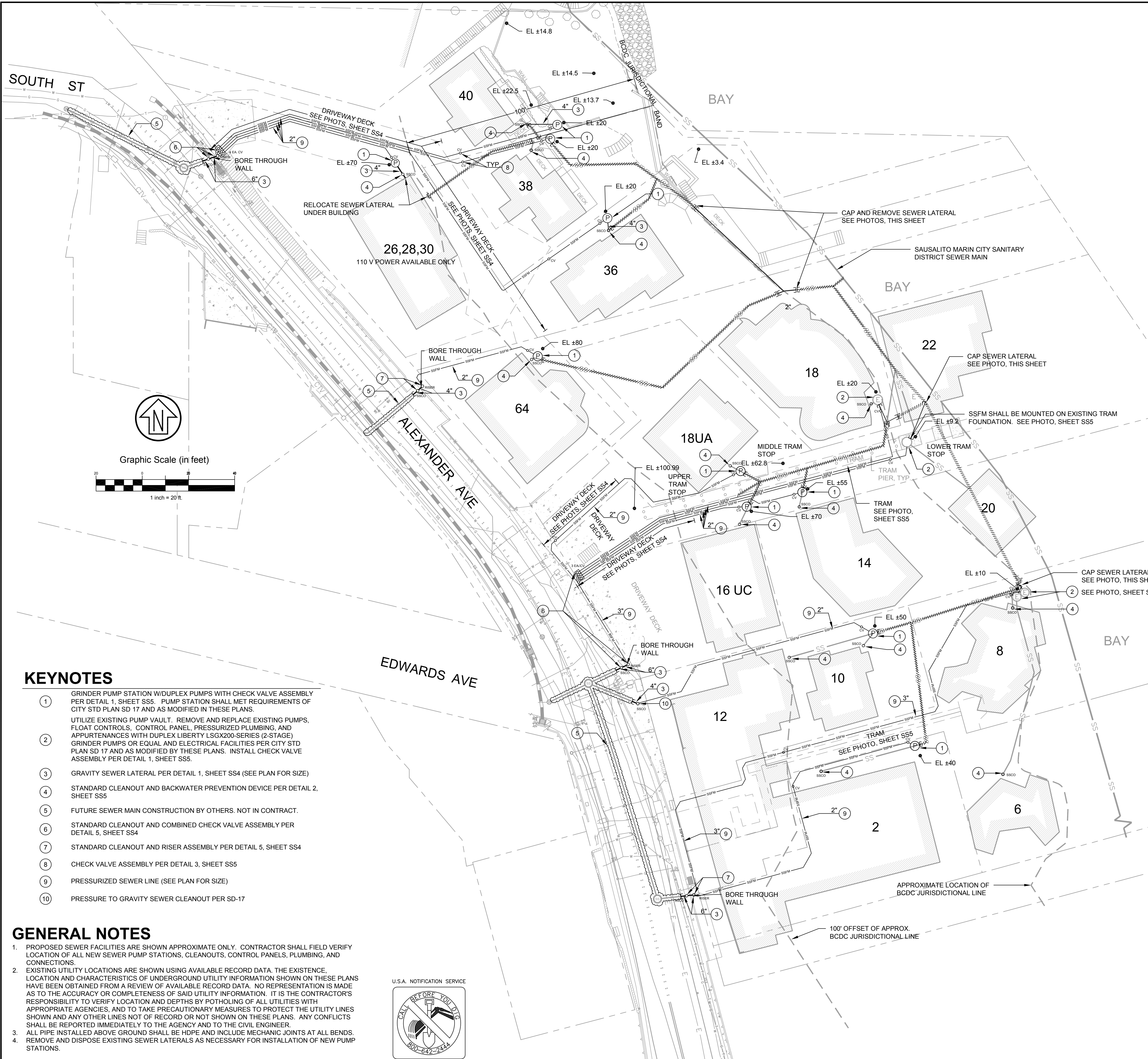

KEYNOTES

- ① GRINDER PUMP STATION W/DUPLEX PUMPS WITH CHECK VALVE ASSEMBLY PER DETAIL 1, SHEET SS5. PUMP STATION SHALL MET REQUIREMENTS OF CITY STD PLAN SD 17 AND AS MODIFIED IN THESE PLANS.
- ② UTILIZE EXISTING PUMP VAULT. REMOVE AND REPLACE EXISTING PUMPS, FLOAT CONTROLS, CONTROL PANEL, PRESSURIZED PLUMBING, AND APPURTENANCES WITH DUPLEX LIBERTY LSGX200-SERIES (2-STAGE) GRINDER PUMPS OR EQUAL AND ELECTRICAL FACILITIES PER CITY STD PLAN SD 17 AND AS MODIFIED BY THESE PLANS. INSTALL CHECK VALVE ASSEMBLY PER DETAIL 1, SHEET SS5.
- ③ GRAVITY SEWER LATERAL PER DETAIL 1, SHEET SS4 (SEE PLAN FOR SIZE)
- ④ STANDARD CLEANOUT AND BACKWATER PREVENTION DEVICE PER DETAIL 2, SHEET SS5
- ⑤ FUTURE SEWER MAIN CONSTRUCTION BY OTHERS. NOT IN CONTRACT.
- ⑥ STANDARD CLEANOUT AND COMBINED CHECK VALVE ASSEMBLY PER DETAIL 5, SHEET SS4
- ⑦ STANDARD CLEANOUT AND RISER ASSEMBLY PER DETAIL 5, SHEET SS4
- ⑧ CHECK VALVE ASSEMBLY PER DETAIL 3, SHEET SS5
- ⑨ PRESSURIZED SEWER LINE (SEE PLAN FOR SIZE)
- ⑩ PRESSURE TO GRAVITY SEWER CLEANOUT PER SD-17

GENERAL NOTES

1. PROPOSED SEWER FACILITIES ARE SHOWN APPROXIMATE ONLY. CONTRACTOR SHALL FIELD VERIFY LOCATION OF ALL NEW SEWER PUMP STATIONS, CLEANOUTS, CONTROL PANELS, PLUMBING, AND CONNECTIONS.
2. EXISTING UTILITY LOCATIONS ARE SHOWN USING AVAILABLE RECORD DATA. THE EXISTENCE, LOCATION AND CHARACTERISTICS OF UNDERGROUND UTILITY INFORMATION SHOWN ON THESE PLANS HAVE BEEN OBTAINED FROM A REVIEW OF AVAILABLE RECORD DATA. NO REPRESENTATION IS MADE AS TO THE ACCURACY OR COMPLETENESS OF SAID UTILITY INFORMATION. IT IS THE CONTRACTOR'S RESPONSIBILITY TO VERIFY LOCATION AND DEPTHS BY POTHOLING OF ALL UTILITIES WITH APPROPRIATE AGENCIES, AND TO TAKE PRECAUTIONARY MEASURES TO PROTECT THE UTILITY LINES SHOWN AND ANY OTHER LINES NOT OF RECORD OR NOT SHOWN ON THESE PLANS. ANY CONFLICTS SHALL BE REPORTED IMMEDIATELY TO THE AGENCY AND TO THE CIVIL ENGINEER.
3. ALL PIPE INSTALLED ABOVE GROUND SHALL BE HDPE AND INCLUDE MECHANIC JOINTS AT ALL BENDS.
4. REMOVE AND DISPOSE EXISTING SEWER LATERALS AS NECESSARY FOR INSTALLATION OF NEW PUMP STATIONS.

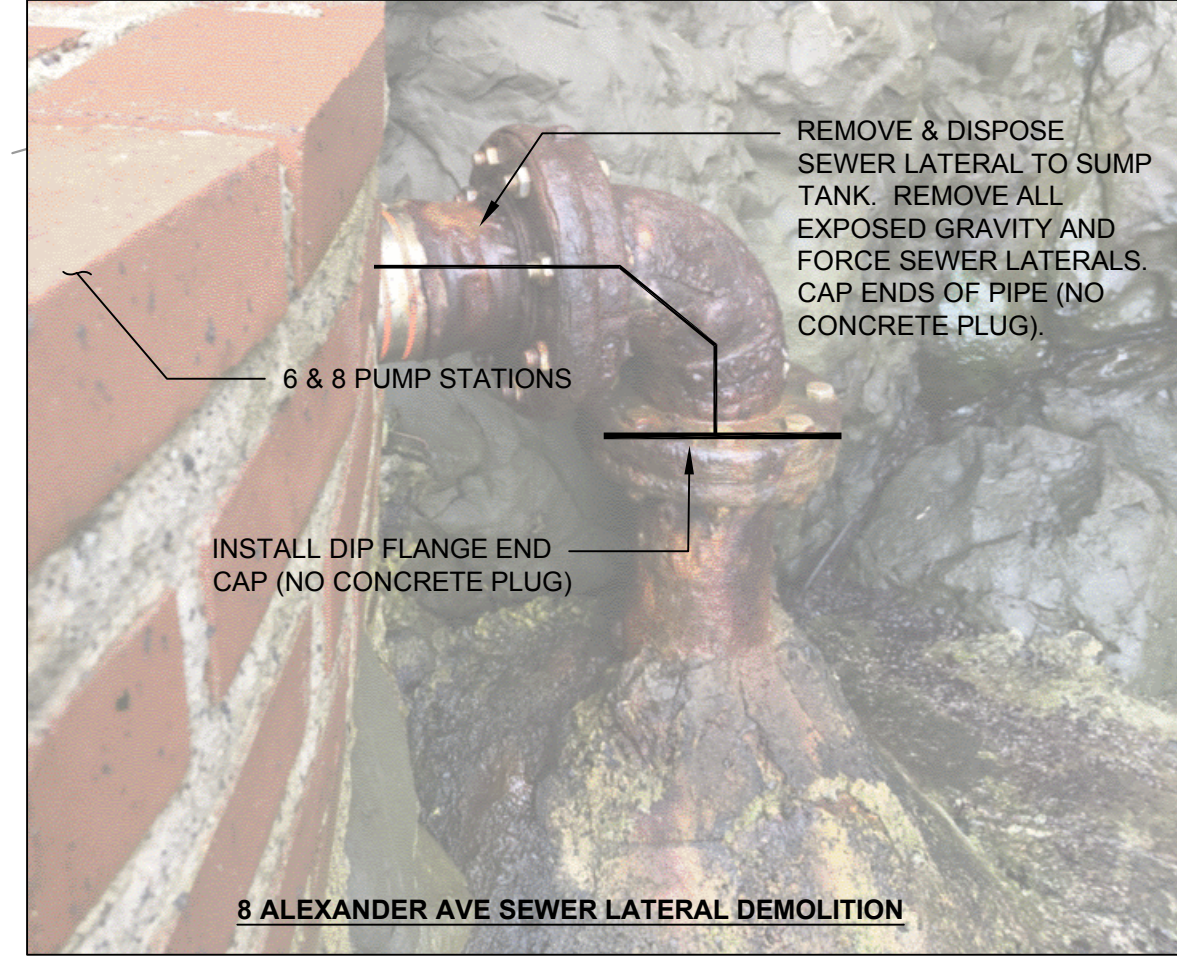
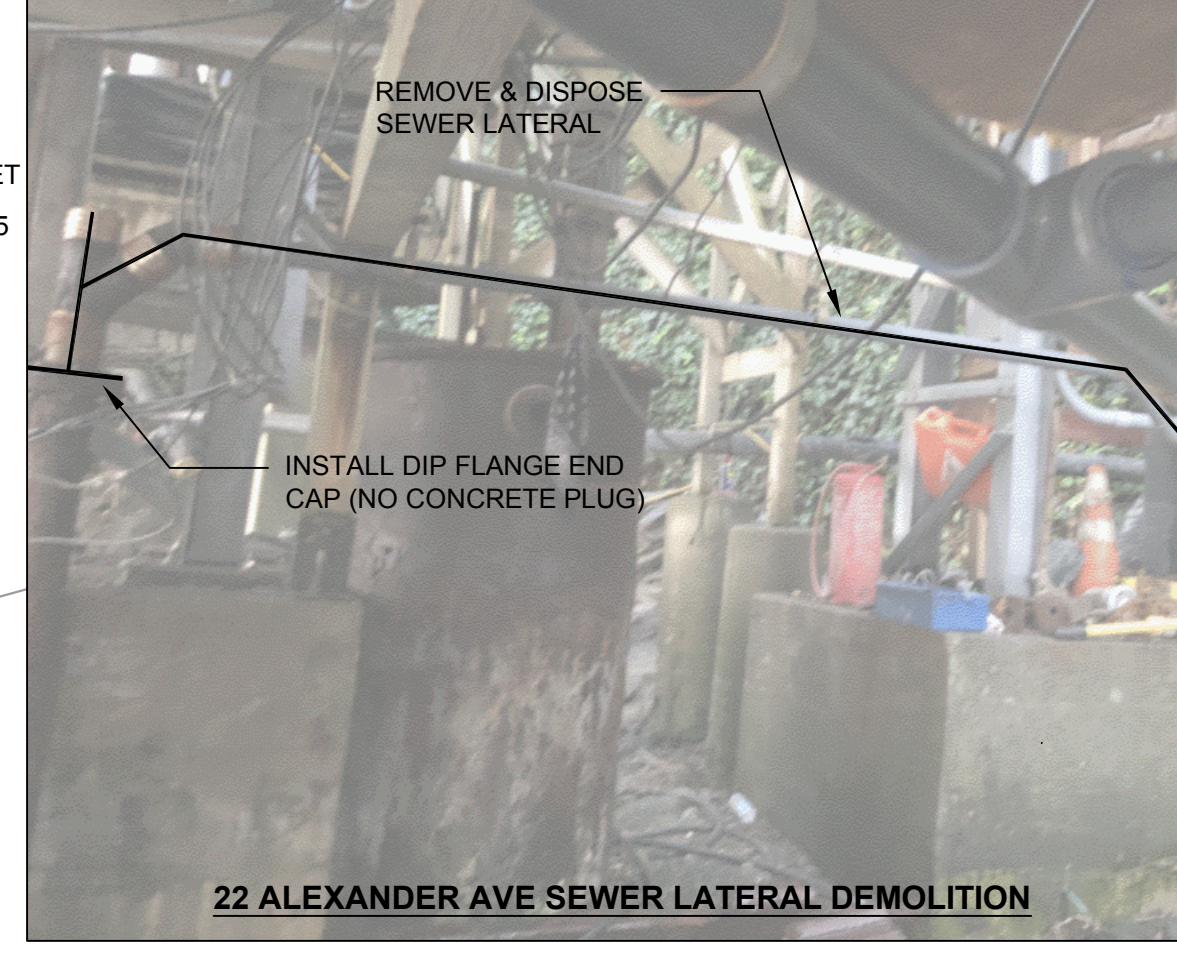
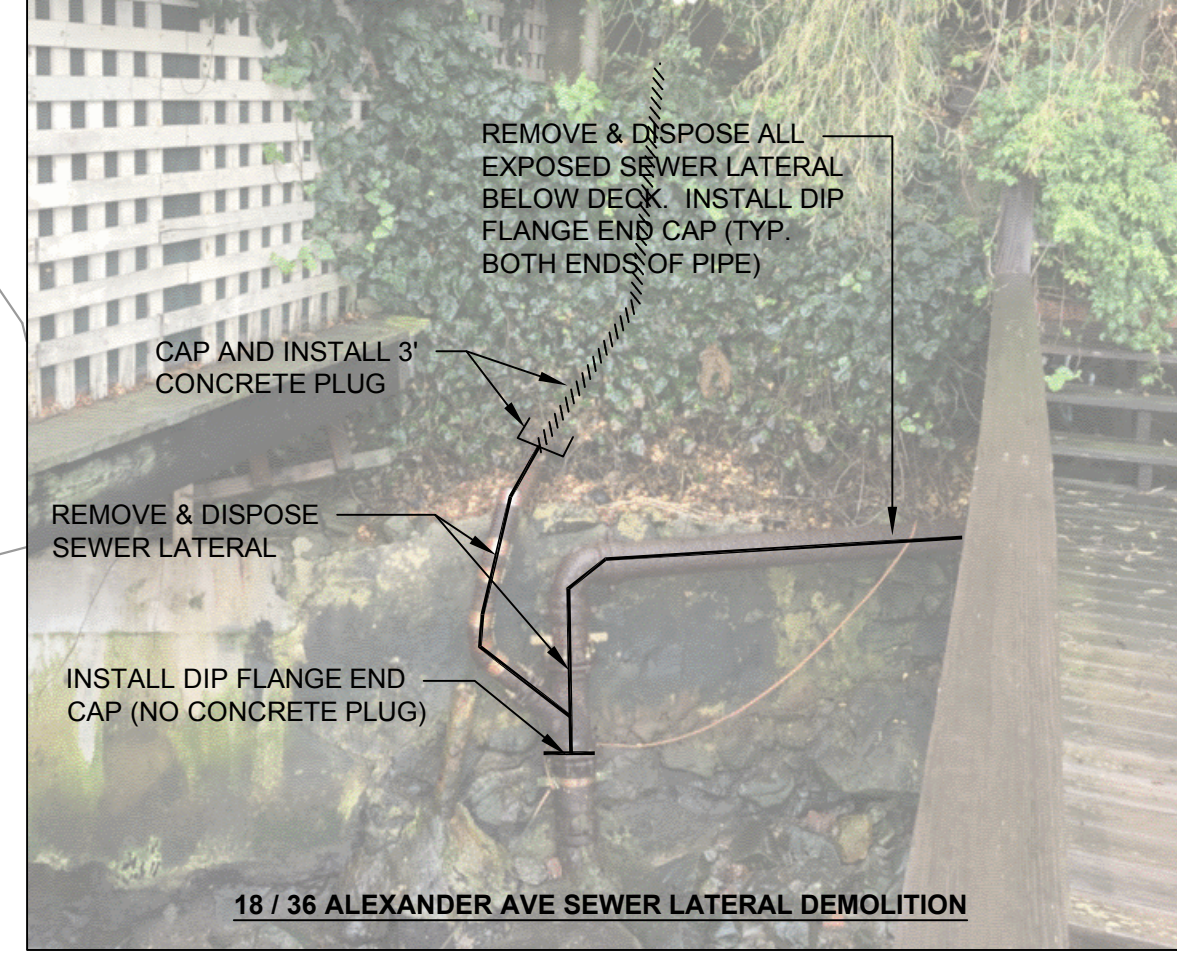
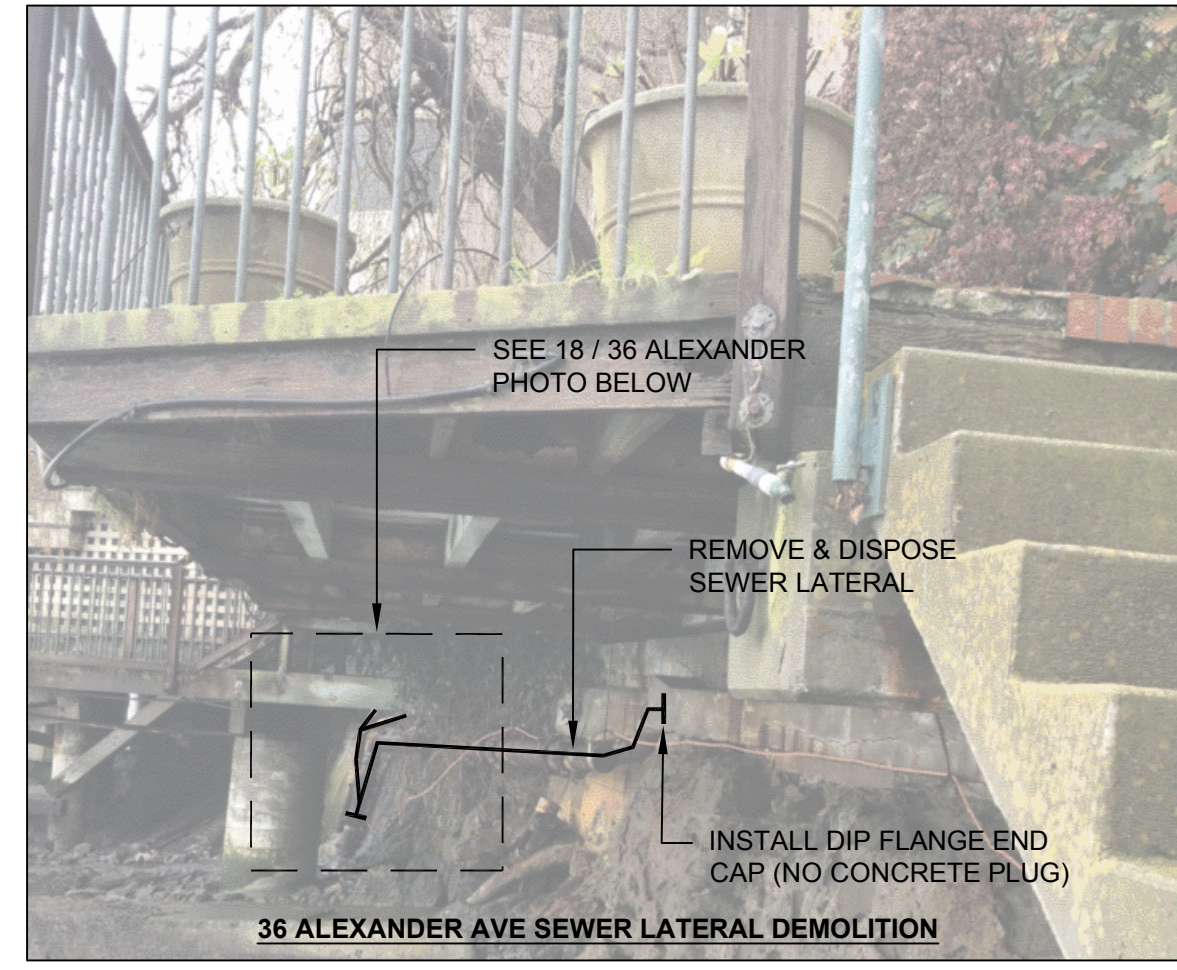

Rev	Date	Description

**BLOCK 303 SEWER REHABILITATION
 LAYOUT PLAN
 BASE BID
 SAUSALITO, CA**

City Of
Sausalito
 County Of
Marin
 State Of
California

Prepared Under the Direction of:

RICHARD J. SOUZA
 No. 67892
 CIVIL
 STATE OF CALIFORNIA

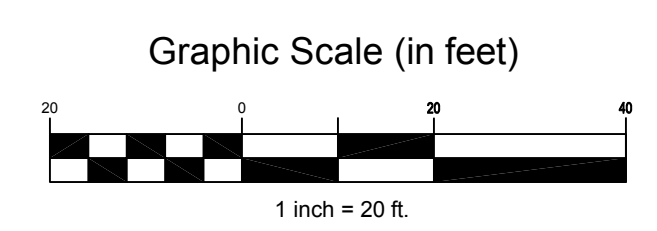
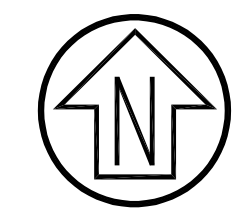

SOUTH ST

BAY

ALEXANDER AVE

EDWARDS AVE

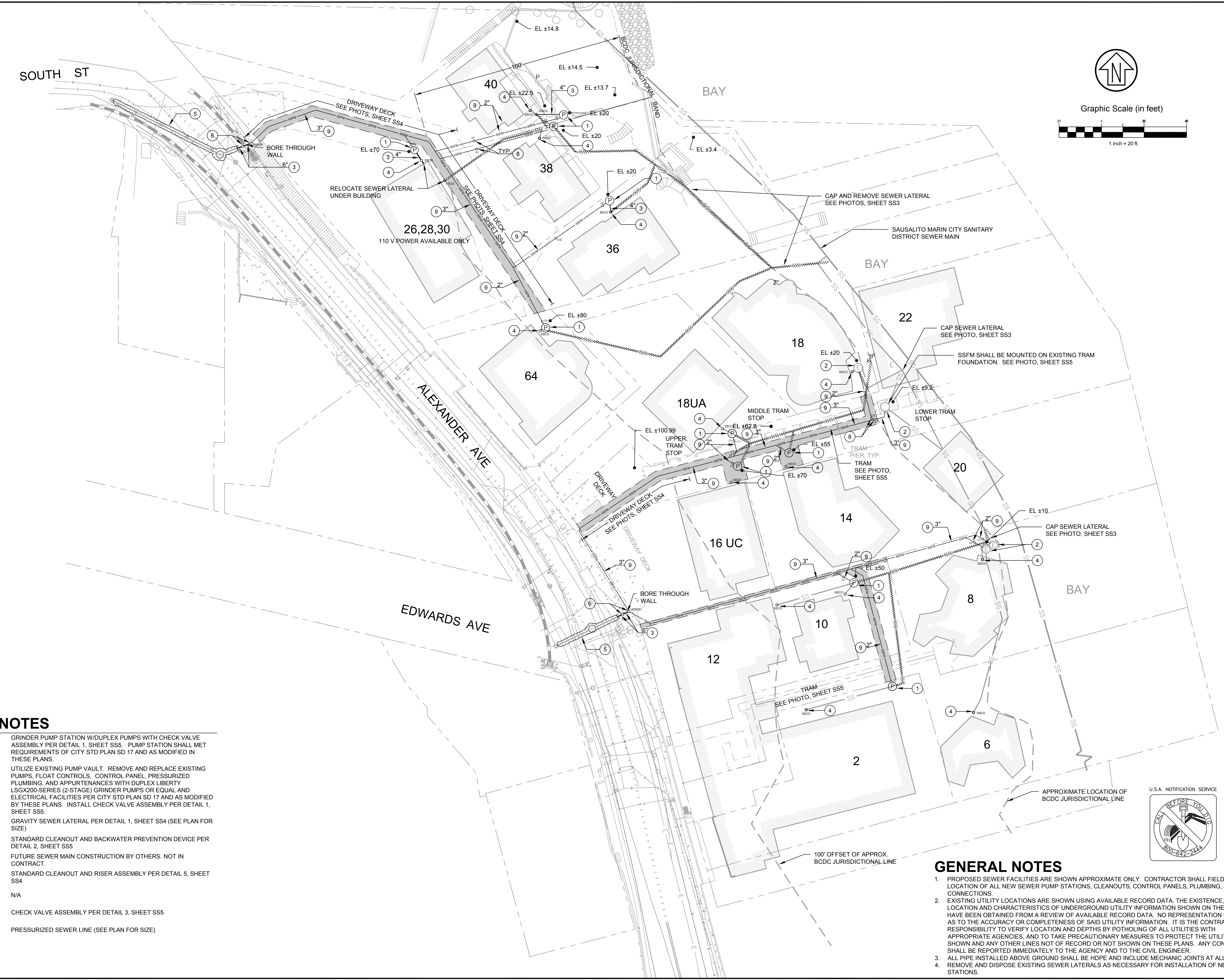

KEYNOTES

- ① GRINDER PUMP STATION W/DUPLEX PUMPS WITH CHECK VALVE ASSEMBLY PER DETAIL 1, SHEET SS5. PUMP STATION SHALL MET REQUIREMENTS OF CITY STD PLAN SD 17 AND AS MODIFIED IN THESE PLANS.
- ② UTILIZE EXISTING PUMP VAULT. REMOVE AND REPLACE EXISTING PUMPS, FLOAT CONTROLS, CONTROL PANEL, PRESSURIZED PLUMBING, AND APPURTENANCES WITH DUPLEX LIBERTY LSGX200-SERIES (2-STAGE) GRINDER PUMPS OR EQUAL AND ELECTRICAL FACILITIES PER CITY STD PLAN SD 17 AND AS MODIFIED BY THESE PLANS. INSTALL CHECK VALVE ASSEMBLY PER DETAIL 1, SHEET SS5.
- ③ GRAVITY SEWER LATERAL PER DETAIL 1, SHEET SS4 (SEE PLAN FOR SIZE)
- ④ STANDARD CLEANOUT AND BACKWATER PREVENTION DEVICE PER DETAIL 2, SHEET SS5
- ⑤ FUTURE SEWER MAIN CONSTRUCTION BY OTHERS. NOT IN CONTRACT.
- ⑥ STANDARD CLEANOUT AND RISER ASSEMBLY PER DETAIL 5, SHEET SS4
- ⑦ N/A
- ⑧ CHECK VALVE ASSEMBLY PER DETAIL 3, SHEET SS5
- ⑨ PRESSURIZED SEWER LINE (SEE PLAN FOR SIZE)

GENERAL NOTES

1. PROPOSED SEWER FACILITIES ARE SHOWN APPROXIMATE ONLY. CONTRACTOR SHALL FIELD VERIFY LOCATION OF ALL NEW SEWER PUMP STATIONS, CLEANOUTS, CONTROL PANELS, PLUMBING, AND CONNECTIONS.
2. EXISTING UTILITY LOCATIONS ARE SHOWN USING AVAILABLE RECORD DATA. THE EXISTENCE, LOCATION AND CHARACTERISTICS OF UNDERGROUND UTILITY INFORMATION SHOWN ON THESE PLANS HAVE BEEN OBTAINED FROM A REVIEW OF AVAILABLE RECORD DATA. NO REPRESENTATION IS MADE AS TO THE ACCURACY OR COMPLETENESS OF SAID UTILITY INFORMATION. IT IS THE CONTRACTOR'S RESPONSIBILITY TO VERIFY LOCATION AND DEPTHS BY POT-HOLING OF ALL UTILITIES WITH APPROPRIATE AGENCIES, AND TO TAKE PRECAUTIONARY MEASURES TO PROTECT THE UTILITY LINES SHOWN AND ANY OTHER LINES NOT OF RECORD OR NOT SHOWN ON THESE PLANS. ANY CONFLICTS SHALL BE REPORTED IMMEDIATELY TO THE AGENCY AND TO THE CIVIL ENGINEER.
3. ALL PIPE INSTALLED ABOVE GROUND SHALL BE HDPE AND INCLUDE MECHANIC JOINTS AT ALL BENDS.
4. REMOVE AND DISPOSE EXISTING SEWER LATERALS AS NECESSARY FOR INSTALLATION OF NEW PUMP STATIONS.

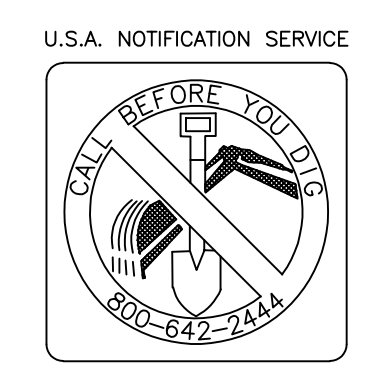

Rev	Date	Description	Designed	Drawn	Checked

**BLOCK 303 SEWER REHABILITATION
 LAYOUT PLAN
 ALTERNATE BID #1
 SAUSALITO, CA**

City Of
Sausalito
 County Of
Marin
 State Of
California

Prepared Under the Direction of:

Richard J. Souza
 No. 67892
 CIVIL
 STATE OF CALIFORNIA

Sheet
SS3.1
 Scale: 1 inch = 20 ft.
 Date: MAY 18, 2024
 Project Number: 2300270
 Sheet Number: 4 of 6

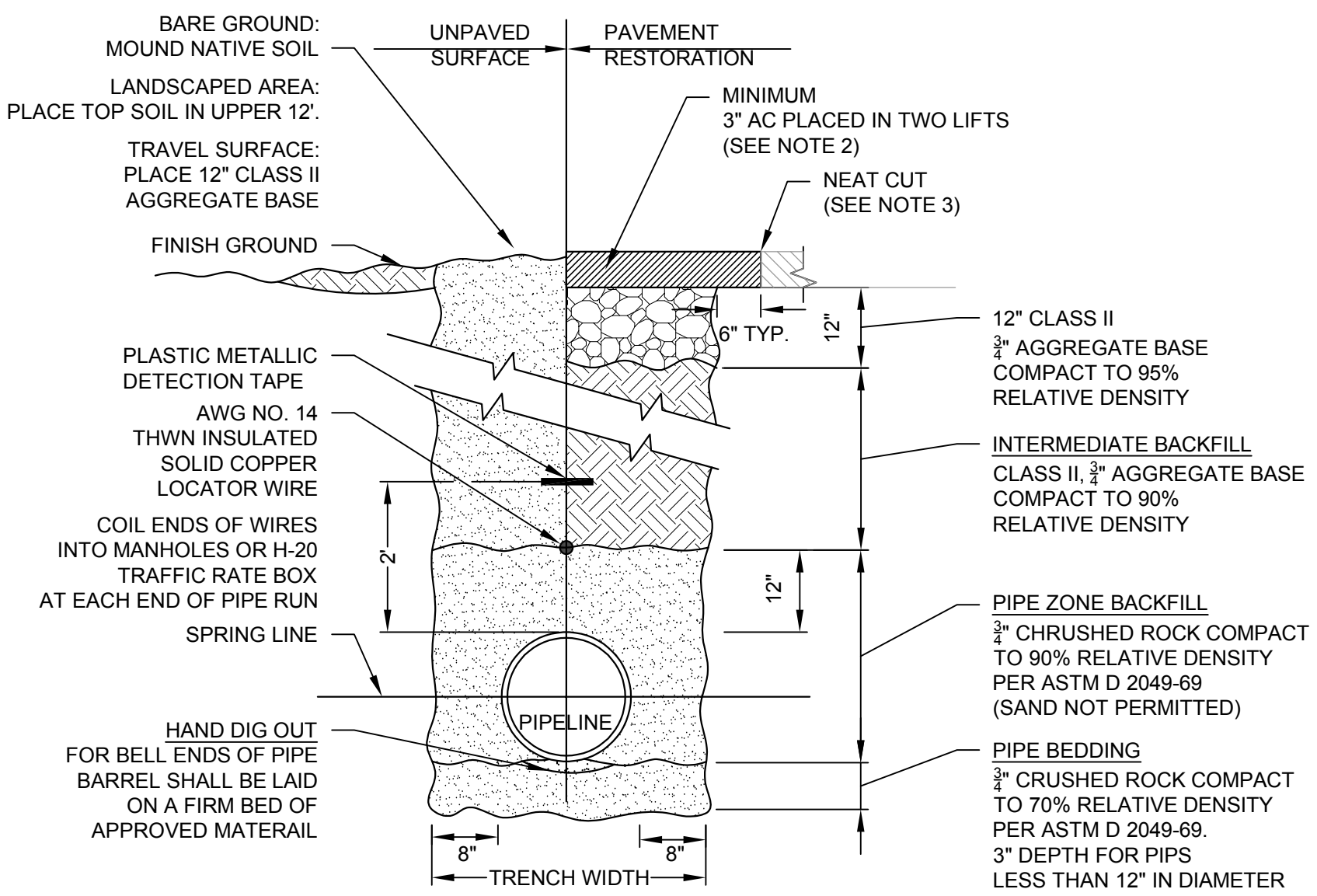

- NOTES:**
- INSTALL 4' LONG COMPACTED IMPERVIOUS CLAY OR SLURRY CEMENT PLUGS IN PIPE ZONE BACKFILL AND PIPE BEDDING AT 400' INTERVALS.
 - ASPHALT THICKNESS SHALL CONFORM TO THE REQUIREMENTS OF THE AGENCY WITH JURISDICTION OVER STREET.
 - CONSULT LOCAL JURISDICTION FOR ASPHALT CUTTING REQUIREMENTS.
 - FOR PIPE COVER LESS THAN 24", CONTRACTOR SHALL INSTALL:
 - 10-INCHES OF 2-SACK CONCRETE SLURRY BELOW PAVEMENT 6-INCHES BEYOND EDGE OF TRENCH WALLS
 - PROVIDE GEOTEXTILE FABRIC
 - INSTALL A SINGLE LAYER/BLANKET OF GEOTEXTILE FABRIC BENEATH THE SLURRY PROTRACTION SLAB

1 TYPICAL GRAVITY SEWER TRENCH DETAIL IN PUBLIC RIGHT-OF-WAY
 SCALE: N.T.S.

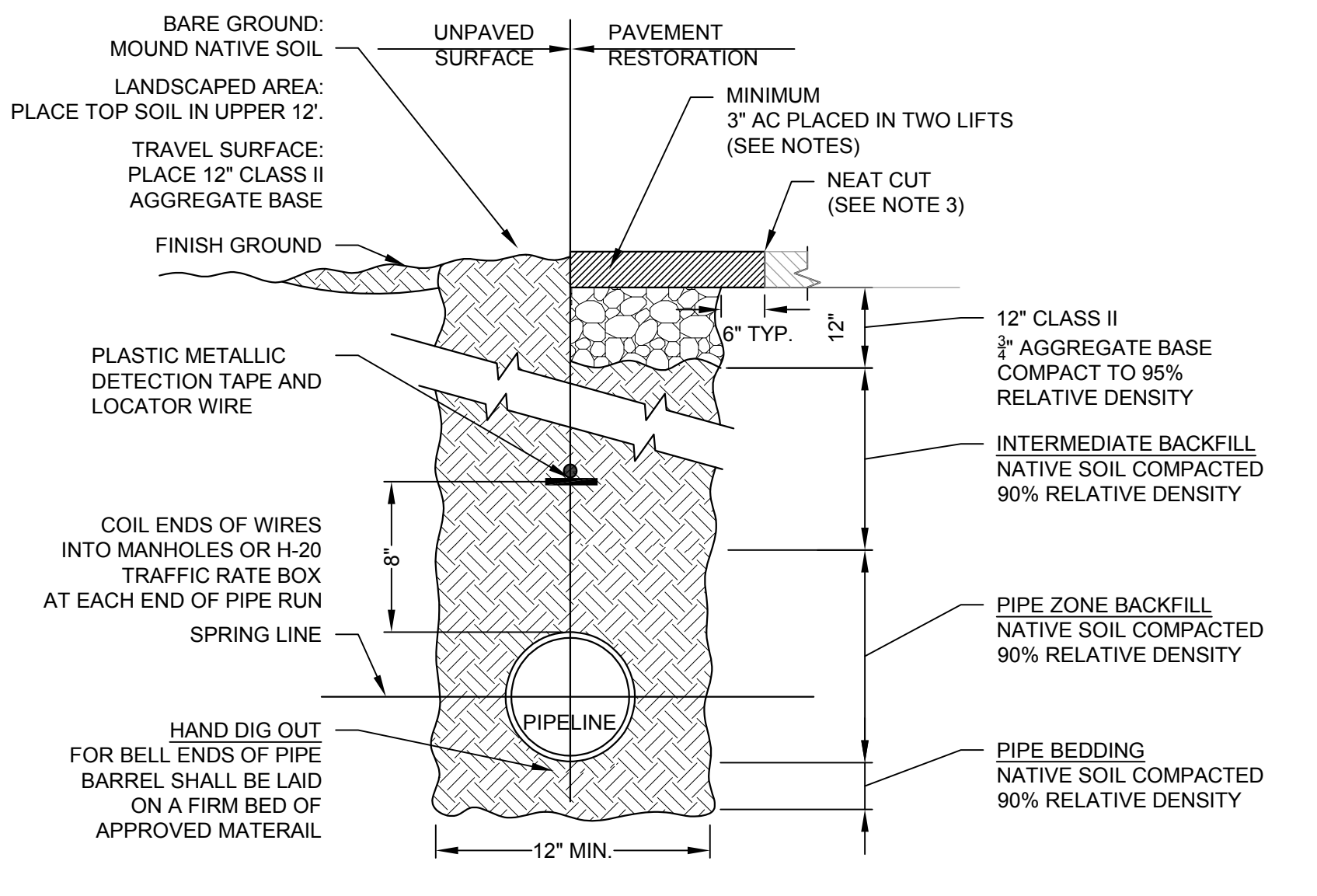

- NOTES:**
- ASPHALT THICKNESS SHALL CONFORM TO THE REQUIREMENTS OF THE AGENCY WITH JURISDICTION OVER STREET.
 - CONSULT LOCAL JURISDICTION FOR ASPHALT CUTTING REQUIREMENTS.
 - MINIMUM COVER OVER PIPE IN SOFTSCAPE AREAS IS 18-INCHES.
 - MINIMUM COVER OVER PIPE IN HARDSCAPE AREAS ARE 48-INCHES IN PUBLIC RIGHT-OF-WAY AND 24-INCHES OUTSIDE OF THE PUBLIC RIGHT-OF-WAY.

2 TYPICAL SEWER FORCE MAIN TRENCH DETAIL OUTSIDE RIGHT-OF-WAY
 SCALE: N.T.S.

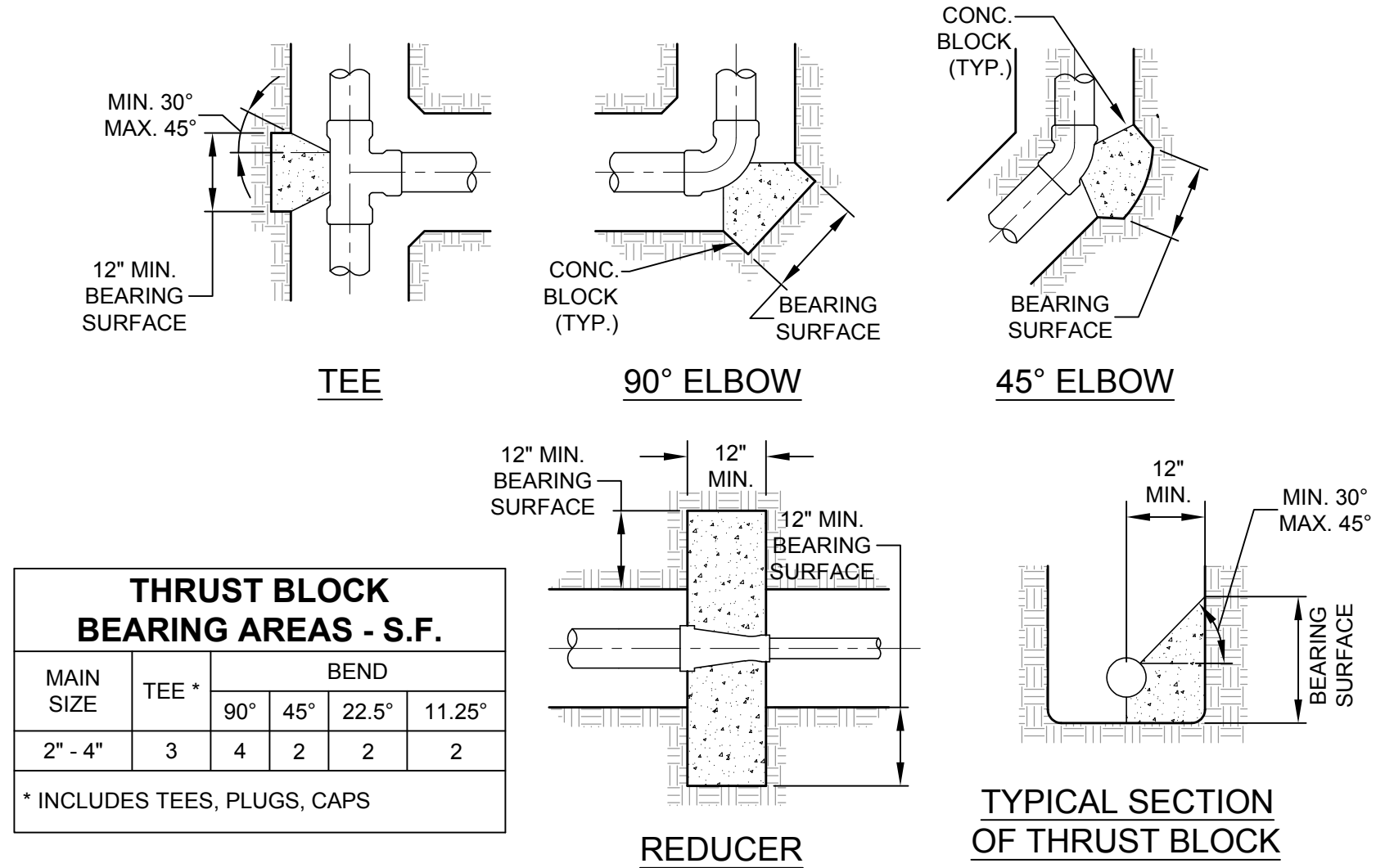

- GENERAL NOTES:**
- THRUST BLOCKS TO BE CONSTRUCTED PER N.F.P.A. 24.
 - ALL THRUST/ANCHOR BLOCKS SHALL BEAR AGAINST UNDISTURBED SOIL.
 - CONCRETE SHALL ATTAIN A MINIMUM COMPRESSIVE STRENGTH OF 3000 PSI.
 - ALL ANCHOR RODS AND ANCHOR BOLTS SHALL BE MINIMUM 5/8" DIA. & ANCHOR STRAPS SHALL BE 3" X 1/4".
 - THRUST BLOCK DESIGN IS BASED ON A WATER PRESSURE OF 200 P.S.I. AND A MINIMUM ALLOWABLE SOIL BEARING VALUE OF 2,000 P.S.F. THE CONTRACTOR SHALL BE RESPONSIBLE FOR VERIFYING SOIL BEARING VALUES AND THE POSITION AND SIZE OF BEARING AREAS BASED UPON N.F.P.A. 24.
 - THE HEIGHT OF THE BLOCK MUST BE LESS THAN HALF OF THE TOTAL DEPTH TO THE BOTTOM OF THE BLOCK.
 - THE RATIO OF WIDTH TO HEIGHT OF THRUST BLOCK SHALL NOT EXCEED 1.5 TO 1.

3 THRUST BLOCK AND ANCHOR DETAIL
 SCALE: 1" = 2'

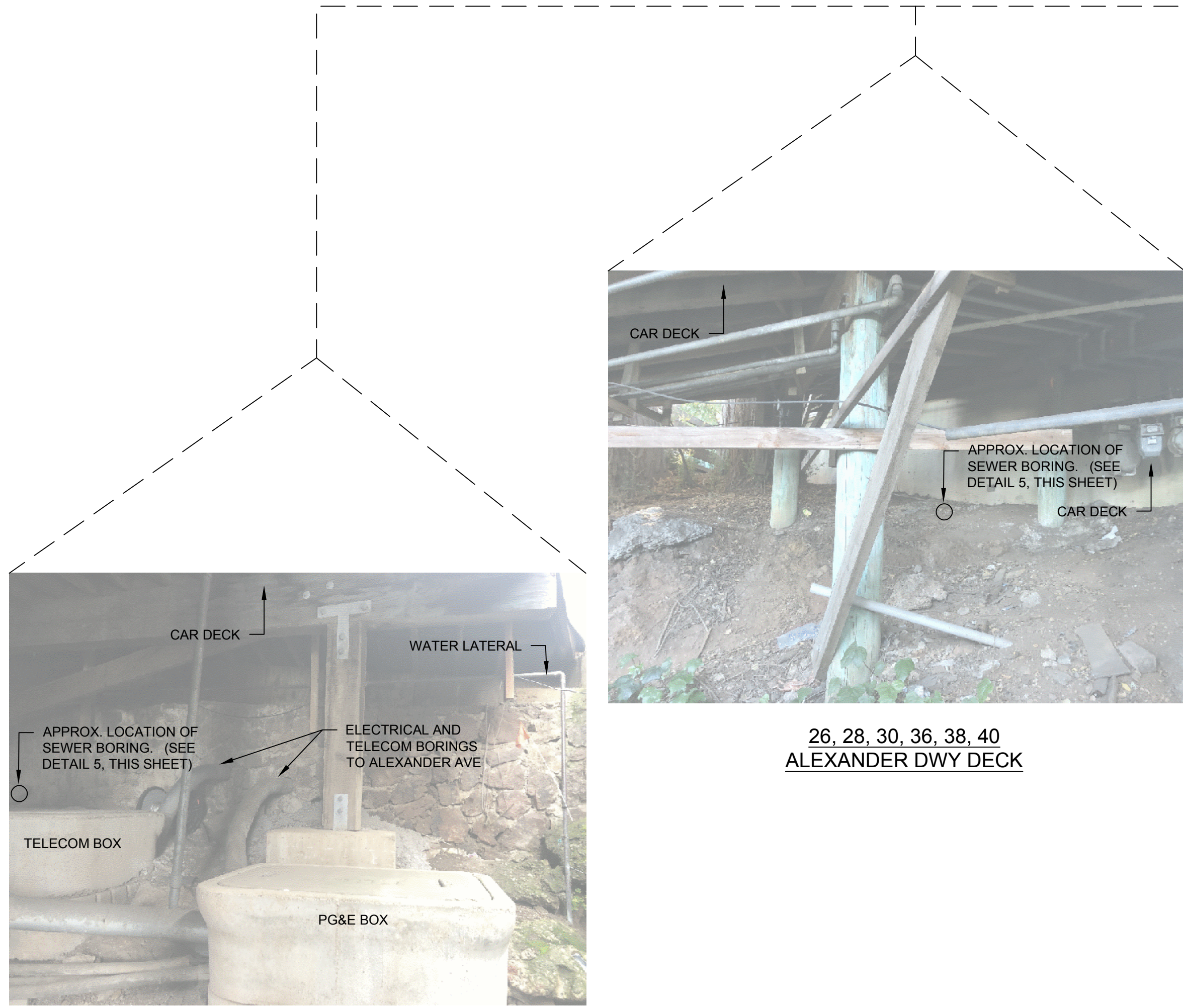

16 ALEXANDER DWY DECK

26, 28, 30, 36, 38, 40 ALEXANDER DWY DECK

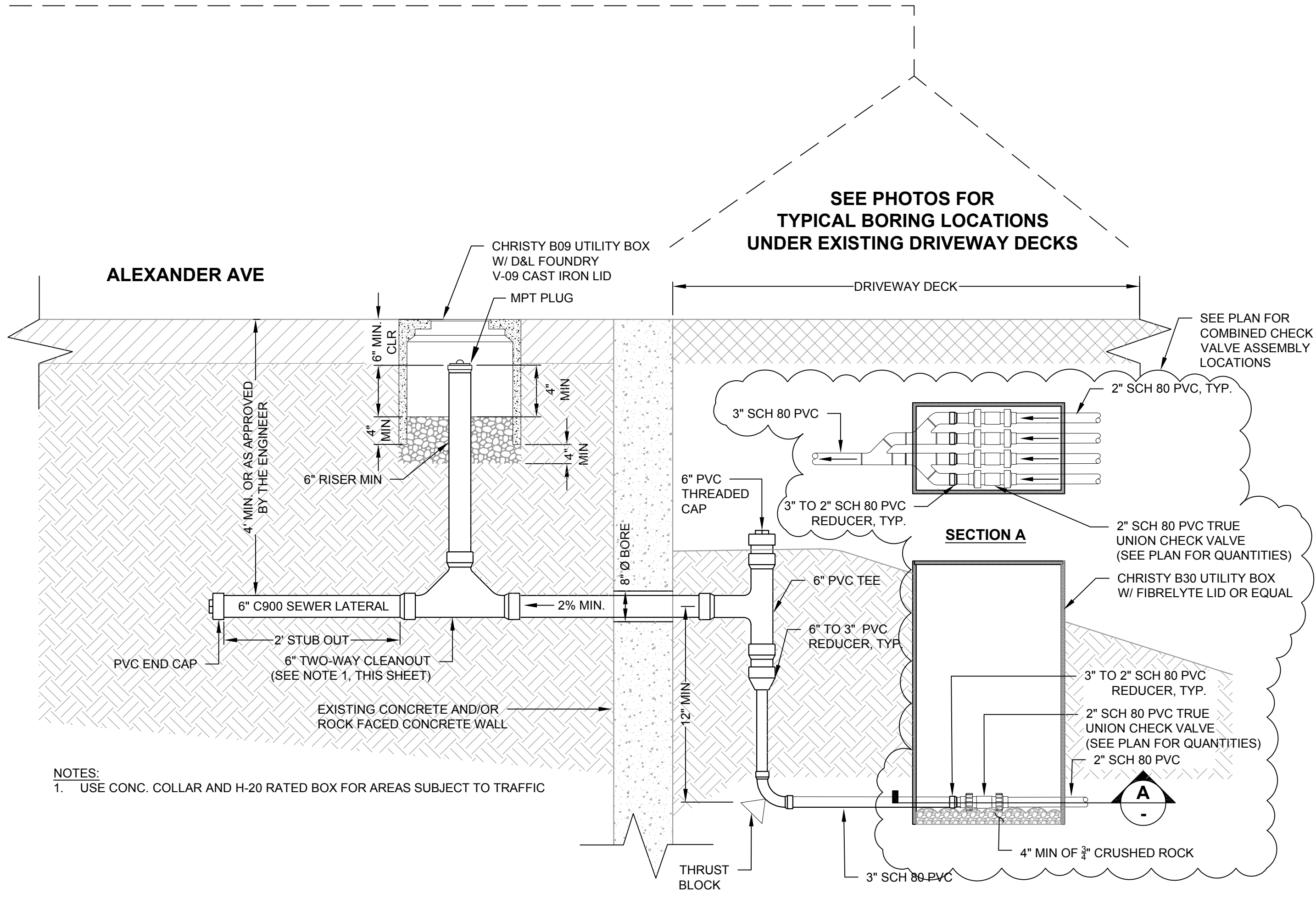

- NOTES:**
- USE CONC. COLLAR AND H-20 RATED BOX FOR AREAS SUBJECT TO TRAFFIC

5 STANDARD CLEANOUT AND BACKWATER PREVENTION DEVICE
 SCALE: N.T.S.

Rev	Date	Description	Designed	Drawn	Checked

**BLOCK 303 SEWER REHABILITATION
 DETAIL SHEET
 SAUSALITO, CA**

City Of Sausalito
 County Of Marin
 State Of California

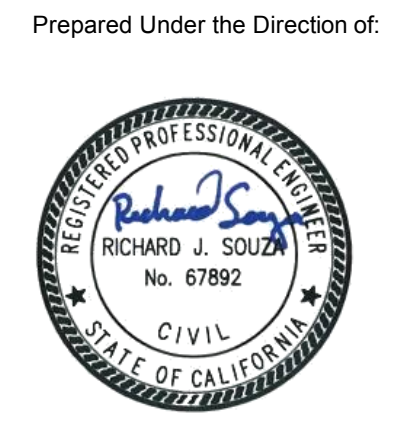

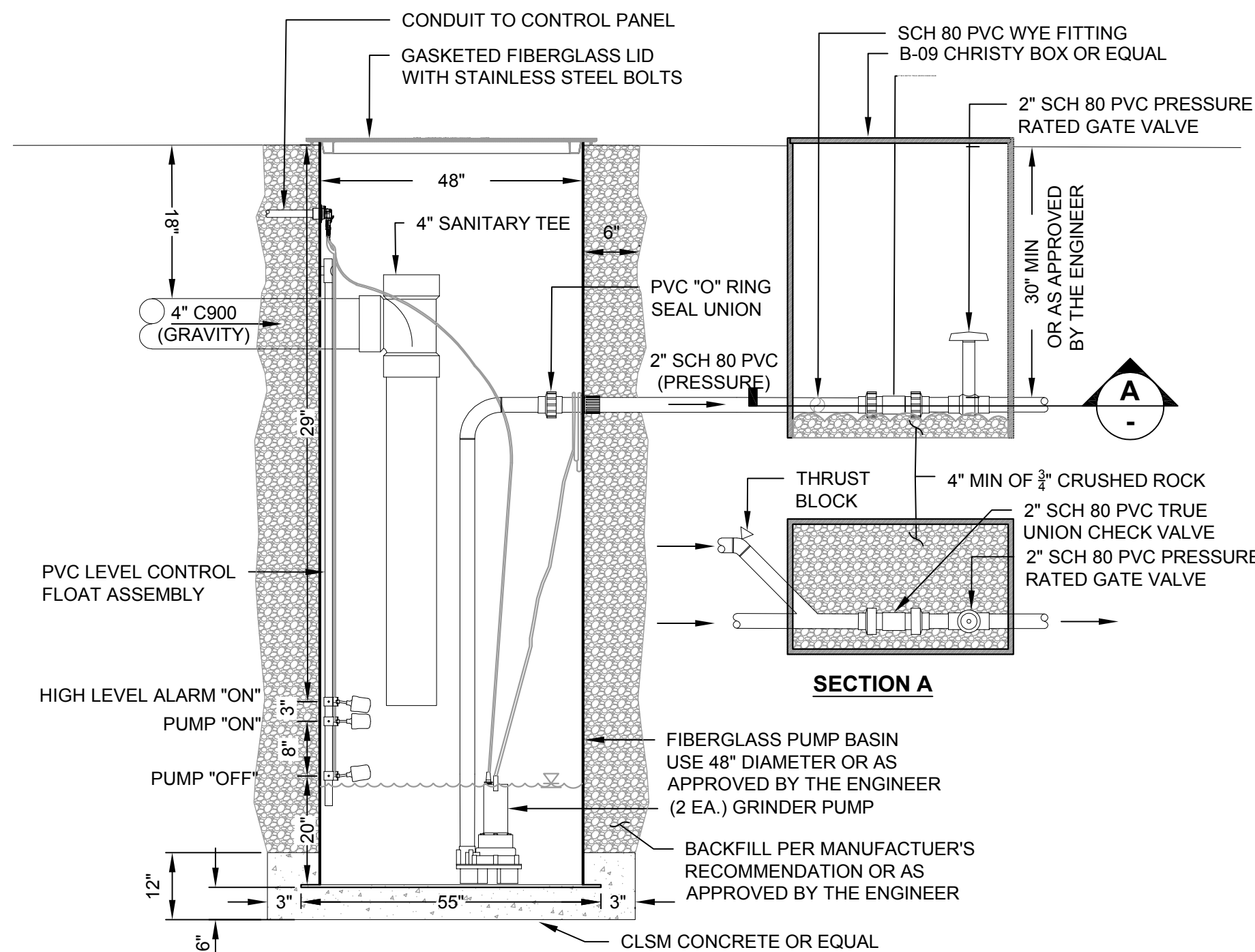

NOTES

- LIBERTY DUPLEX GRINDER PUMP, LSGX200-SERIES (2-STAGE, 2HP, 208-230V) OR EQUAL.
- PUMP STATION AT 26.28.30 HAS 110V BREAKER BOX. USE LIBERTY PRG-SERIES (1 PHASE, 115V, 1 HP) DUPLEX PUMPS OR EQUAL.
- AK INDUSTRIES FIBERGLASS PUMP VAULT, MODEL GB-48X-301 OR EQUAL.
- FIELD CUT AND GAS-TIGHT SEAL ALL PIPE AND ELECTRICAL CONDUIT CONNECTIONS
- CONTROL PANEL AND ELECTRICAL FACILITIES SHALL MEET SAUSALITO MARIN CITY SANITARY DISTRICT STANDARD PLAN SD17 FOR RESIDENTIAL SEWAGE EJECTION SYSTEM

1 SEWER LIFT EJECTOR STATION DETAIL

SCALE: N.T.S.

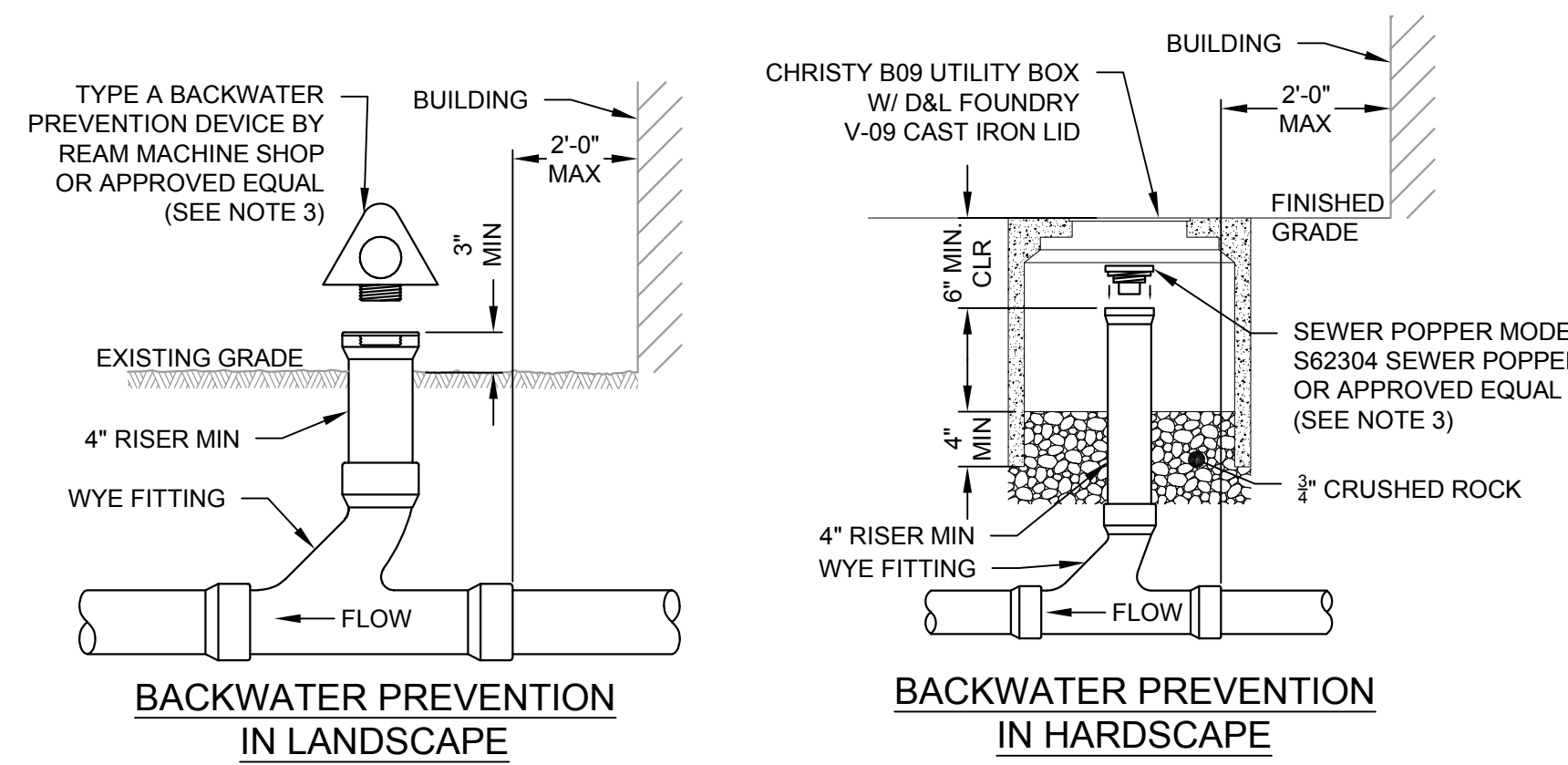

NOTES

- CLEANOUTS LOCATED UNDER PAVED DRIVEWAYS, WALKWAYS, ETC SHALL BE RAISED TO GRADE AND INSTALLED IN PRECAST CONC METER BOXES FLUSH FITTED TO PAVING W/ GALVANIZED STEEL CHECKERED PLATE TRAFFIC LIDS MARKED "SEWER", CHRISTY B16 OR EQUAL, AS DIRECTED BY THE DISTRICT.
- CLEANOUTS LOCATED IN LANDSCAPE AREAS SHALL BE RAISED 3" ABOVE GRADE AND INSTALLED IN PRECAST CONC METER BOXES FLUSH FITTED TO PAVING W/ GALVANIZED STEEL CHECKERED PLATE TRAFFIC LIDS MARKED "SEWER", CHRISTY B09 OR EQUAL, AS DIRECTED BY THE DISTRICT.
- SEWER POPPER OR TYPE A BACKWATER PREVENTION DEVICE SHALL BE INSTALLED NO LOWER THAN THE LOWEST DRAINED FIXTURE UNIT IN THE BUILDING (VIF). IF THE DIFFERENCE IN ELEVATION OF THE LOWEST FIXTURE AND THE BACKWATER PREVENTION DEVICE IS LESS THAN 6 INCHES, A BACKWATER CHECK VALVE SHALL BE INSTALLED AS SHOWN IN STD DETAIL SD7.

2 STANDARD CLEANOUT AND BACKWATER PREVENTION DEVICE

SCALE: N.T.S.

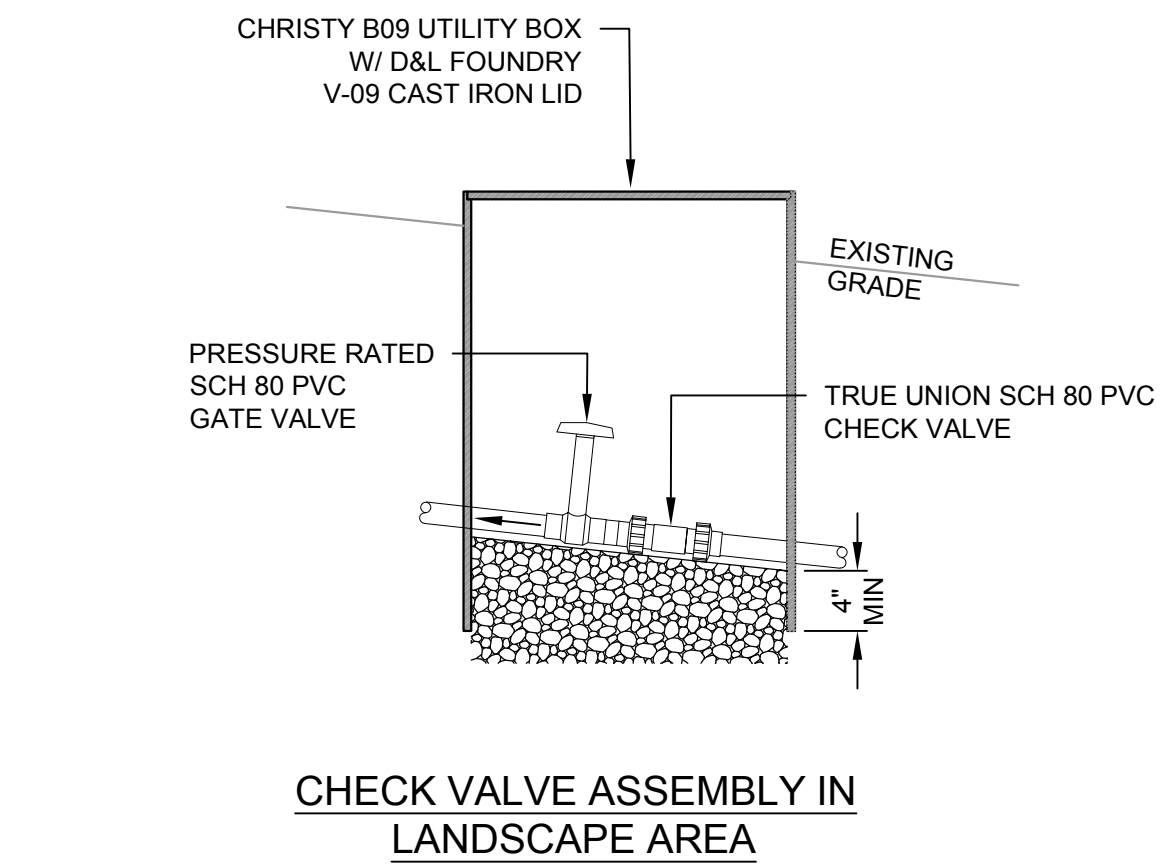

NOTES

- INSTALL CHECK VALVE ASSEMBLY EVERY 300-FT FOR 2" SEWER FORCE AND 200-FT FOR 3" SEWER FORCE MAIN

3 SEWER FORCE MAIN CHECK VALVE ASSEMBLY DETAIL

SCALE: N.T.S.

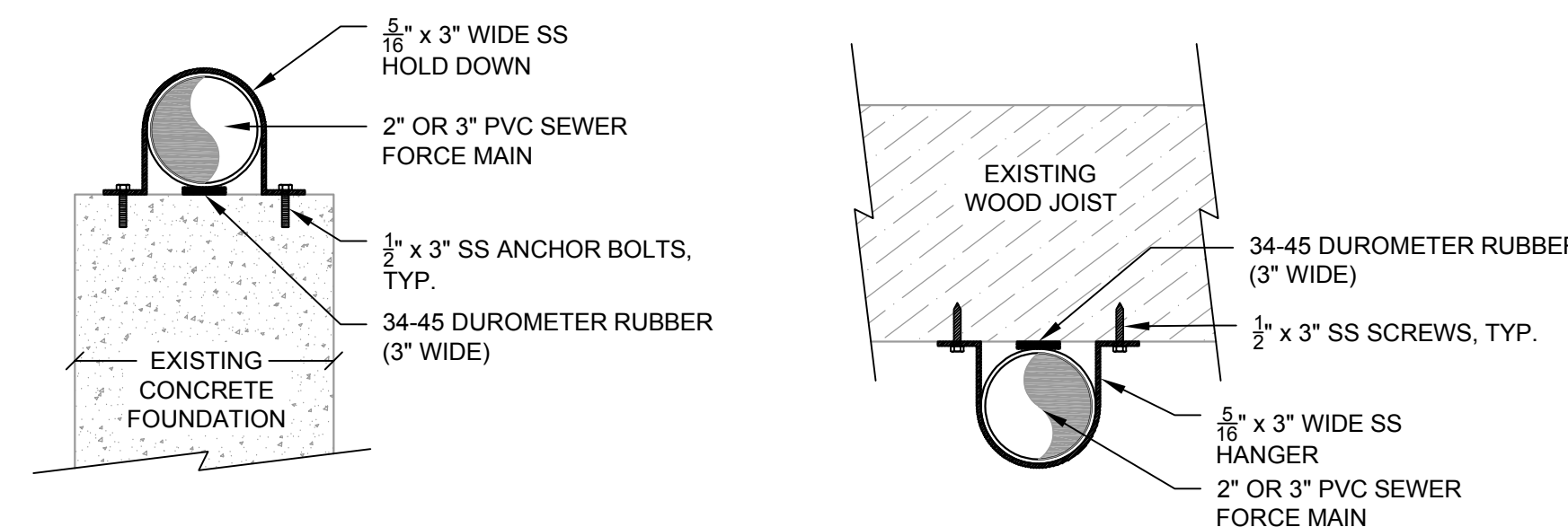

NOTES

- SEWER FORCE MAINS MOUNTED ABOVE GRADE ON EXISTING STRUCTURES SHALL BE AT 20-FT INTERVALS OR AS APPROVED BY THE ENGINEER.
- SEWER FORCE MAIN LOCATIONS MOUNTED ABOVE GRADE SHALL BE APPROVED BY THE ENGINEER.
- CONTRACTOR MAY UTILIZE SS UNISTRUT OR EQUAL ANCHORING SYSTEM

4 SPLICE BOX DETAIL

SCALE: N.T.S.

NOTE:
PUMP STATION AT 22 ALEXANDER ALSO SERVES 20 ALEXANDER

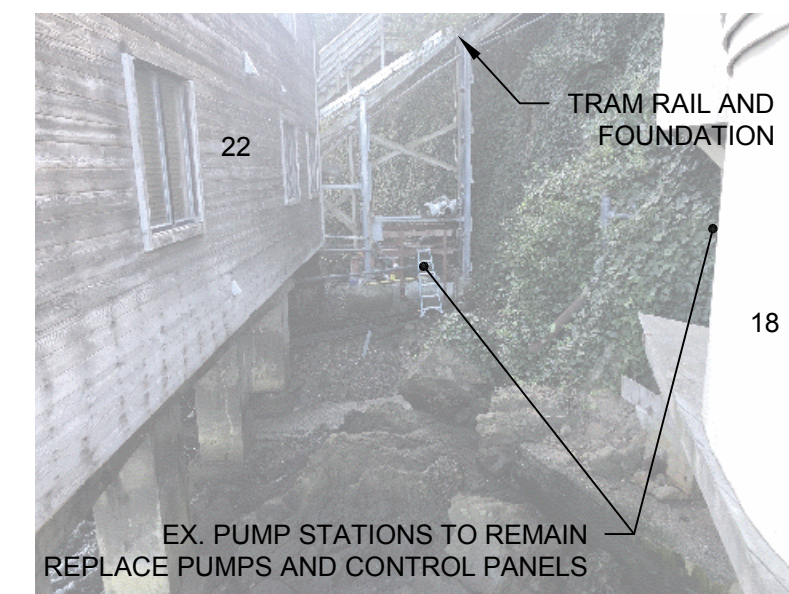

18 & 26 ALEXANDER PUMP STATIONS

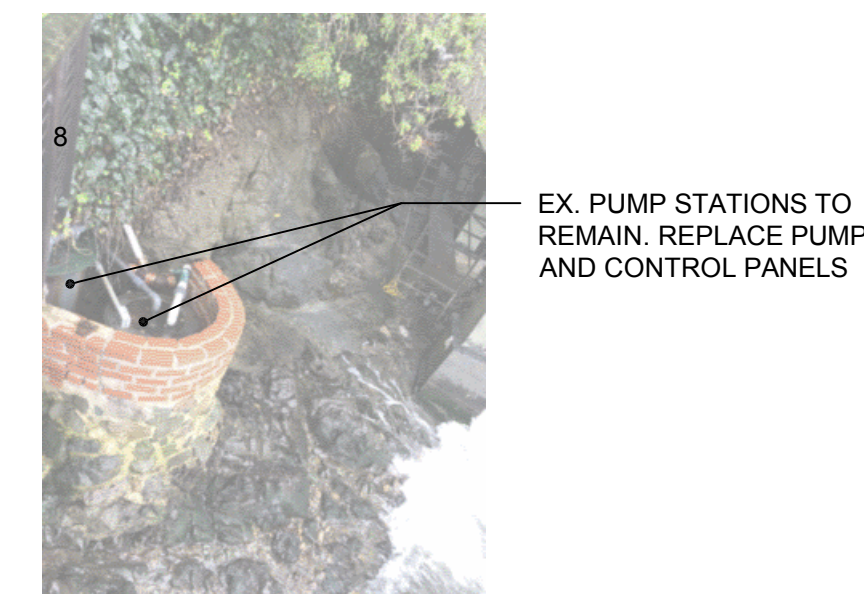

6 & 8 ALEXANDER PUMP STATIONS



TRAM RAIL AND FOUNDATION TO 14, 16UC, 18, 18UC, 20, 22 ALEXANDER



TRAM RAIL AND FOUNDATION TO 6, 8, 10, 12 ALEXANDER

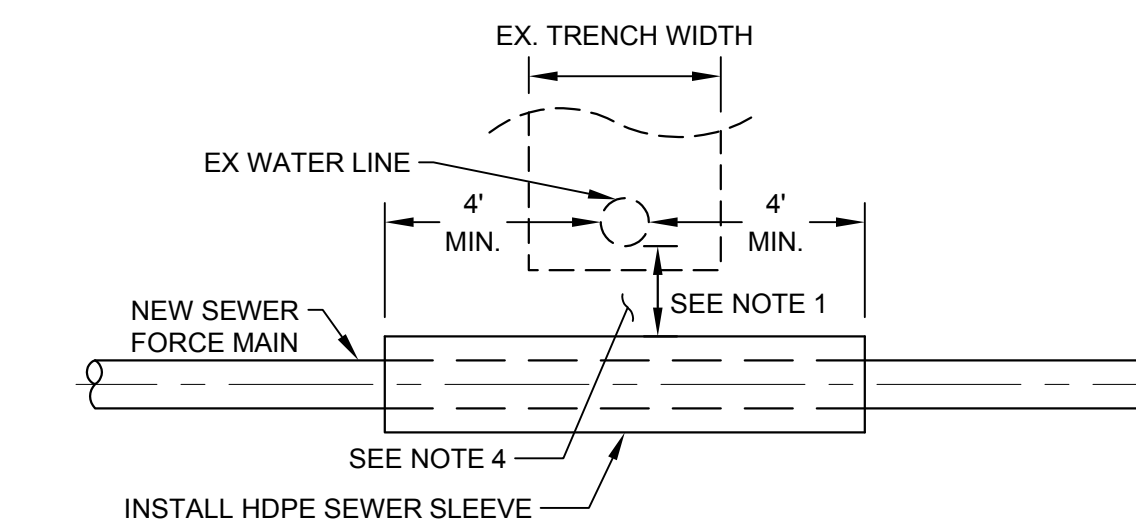

NOTES

- FOR OPEN TRENCH INSTALLATIONS, INSTALL HDPE SLEEVE WHERE VERTICAL CLEARANCE IS LESS THAN 12" BETWEEN NEW SEWER AND EXISTING WATER LINE. VERTICAL CLEARANCE BETWEEN UTILITY LINES SHALL NOT BE LESS THAN 4".
- IF SEWER CROSSES ABOVE EXISTING WATER LINE WITH LESS THAN 12" CLEARANCE, THEN HDPE SLEEVE SHALL EXTEND 10" MINIMUM FROM OUTSIDE O OF WATER LINE.
- FILL ANNUAL SPACE BETWEEN NEW PIPE AND SLEEVE WITH CLSM OR LDCC.
- BACKFILL WITH CLSM OR LDCC WHERE SPECIFIED COMPACTION CANNOT BE ACHIEVED BETWEEN UTILITIES.

5 SEWER FORCE MAIN CROSSING WATER LINE

SCALE: N.T.S.

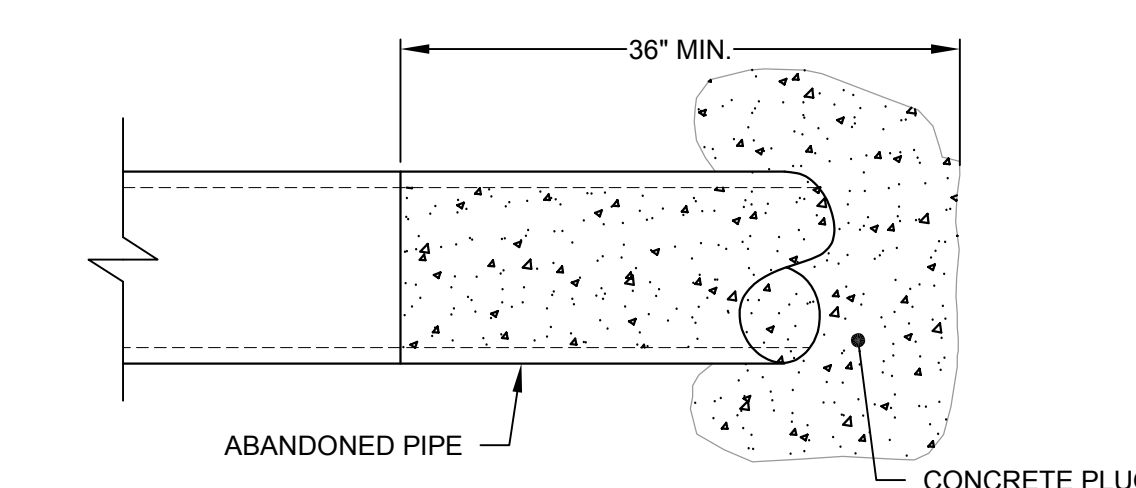

6 TYPICAL PIPE CONCRETE PLUG DETAIL

SCALE: 1" = 1'

Rev	Date	Description	Designed	Drawn	Checked

**BLOCK 303 SEWER REHABILITATION
DETAIL SHEET
SAUSALITO, CA**

City Of Sausalito
County Of Marin
State Of California

Prepared Under the Direction of:

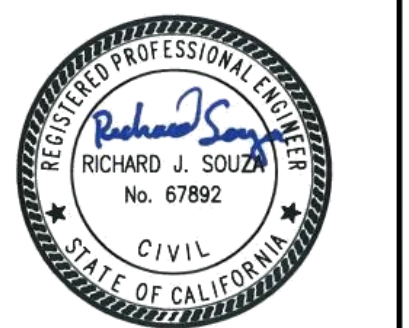

Sheet **SS5**
Scale: 1 inch = 20 ft.
Date: MAY 18, 2024
Project Number: 2300270
Sheet Number: 6 of 6