

DETAIL HEADER HEAD  
Scale: 1/2" = 1'-0"

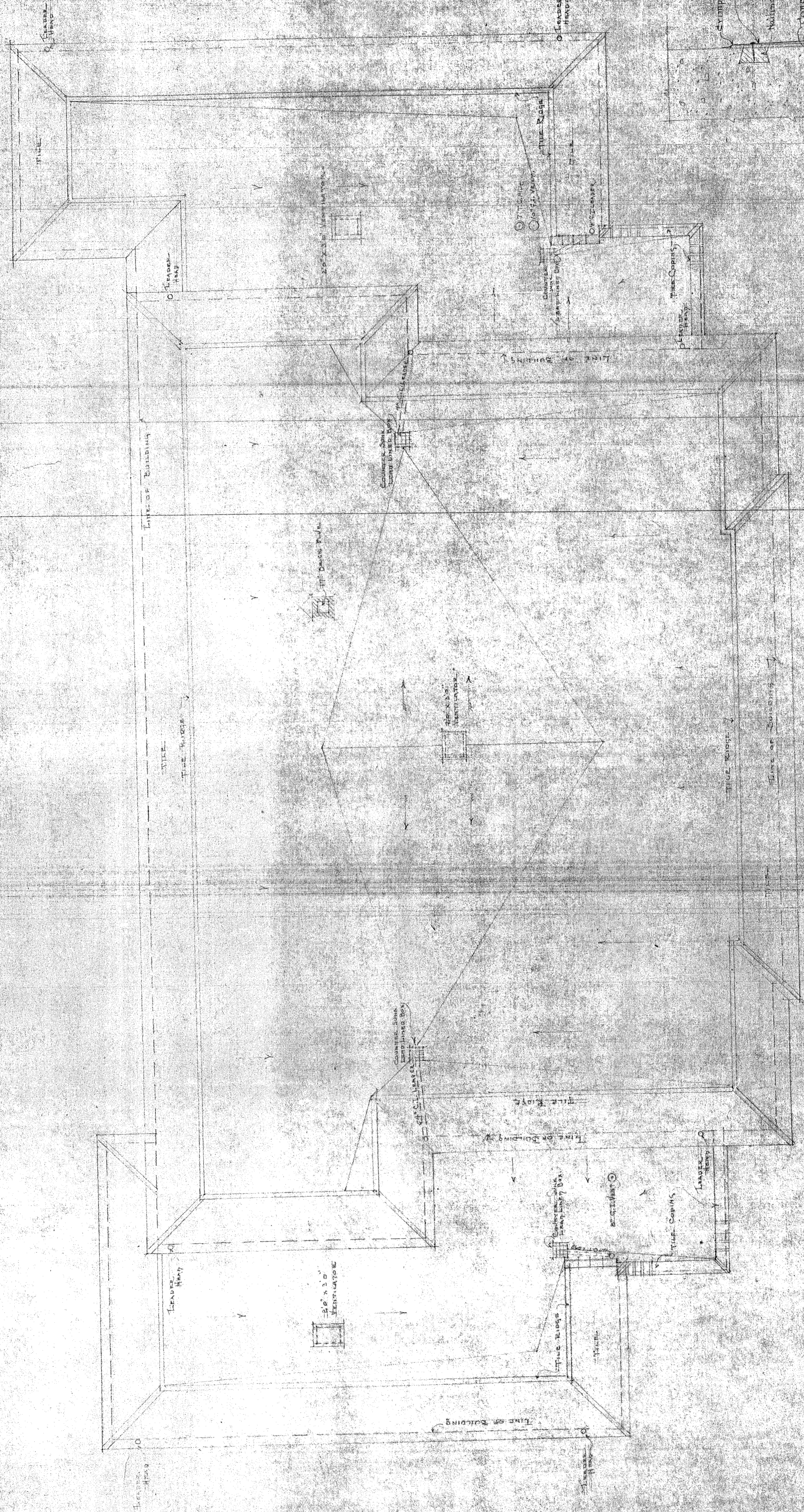

ROOF PLAN  
Scale: 1/8" = 1'-0"

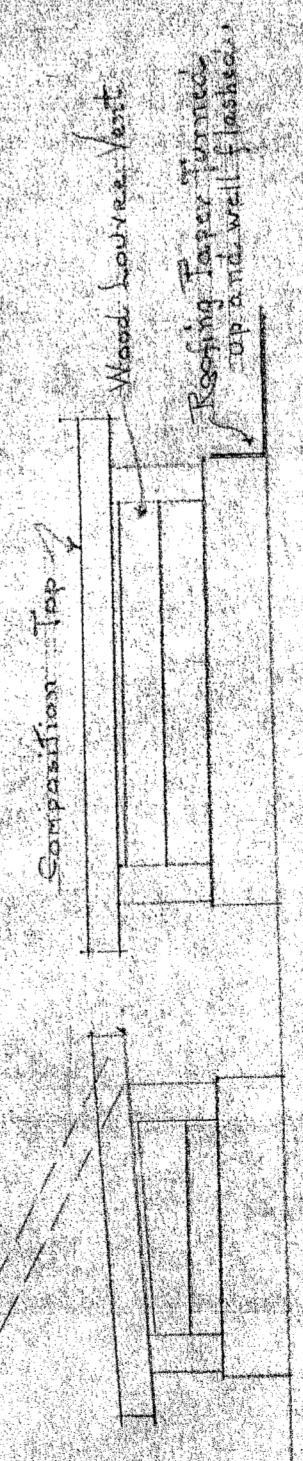

DETAIL OF ROOF VENTILATOR  
Scale: 1/2" = 1'-0"

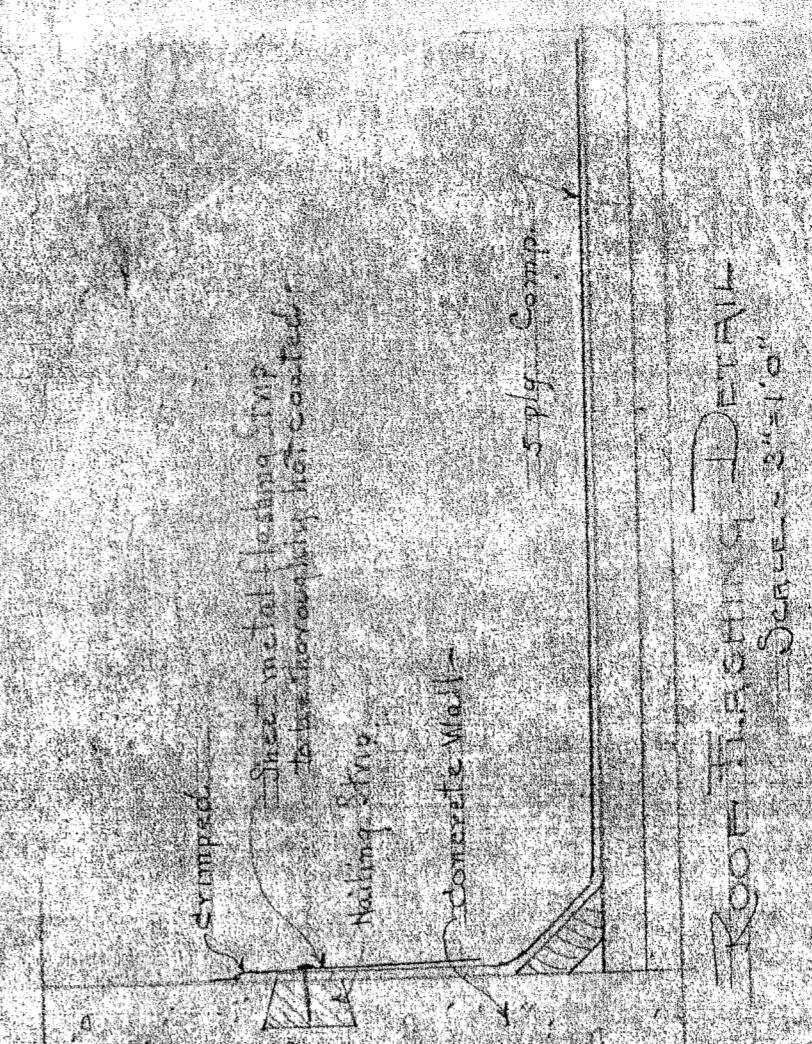

ROOF FLASHING DETAIL  
Scale: 1/2" = 1'-0"

NORMAN F. COULTER  
ARCHITECT  
MANSION BUILDING, 26 Kearny St.  
SAN FRANCISCO, CALIF.  
Drawn: May 20, 1926  
Revised:

CENTRAL SCHOOL - SAUSALITO SCHOOL DISTRICT  
SAUSALITO MARIN COUNTY, CALIF.